

PRELIMINARY PLAN SUBMITTAL
FOR
PANDA EXPRESS
WAUKESHA, WI

PROJECT TEAM

OWNER

Panda Restaurant Group Inc.
1683 Walnut Grove Avenue
Rosemead, CA 91770
626 799 9898

ENGINEER

V3 Companies of Illinois, Ltd.
7325 Janes Avenue
Woodridge, Illinois 60517
630 724 9200

Project Manager: Brad Prischman, P.E., LEED AP
Project Engineer: Matt Brolley, P.E., CFM

ARCHITECT

NORR, LLC
150 W. Jefferson Avenue Suite 1300
Detroit, MI 48226
313 324 3100
Contact: Amy Conti

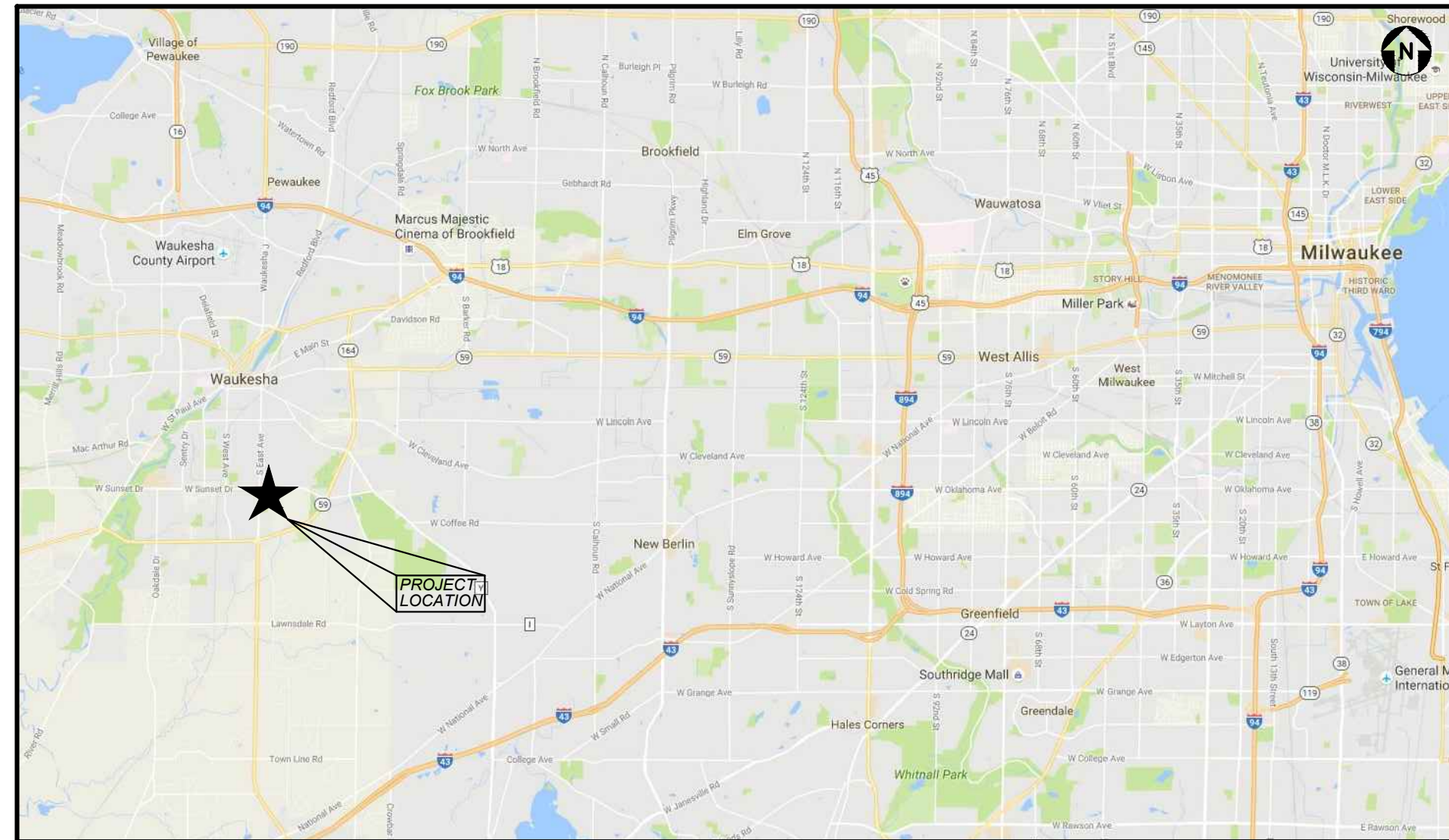

LOCATION MAP

NO SCALE

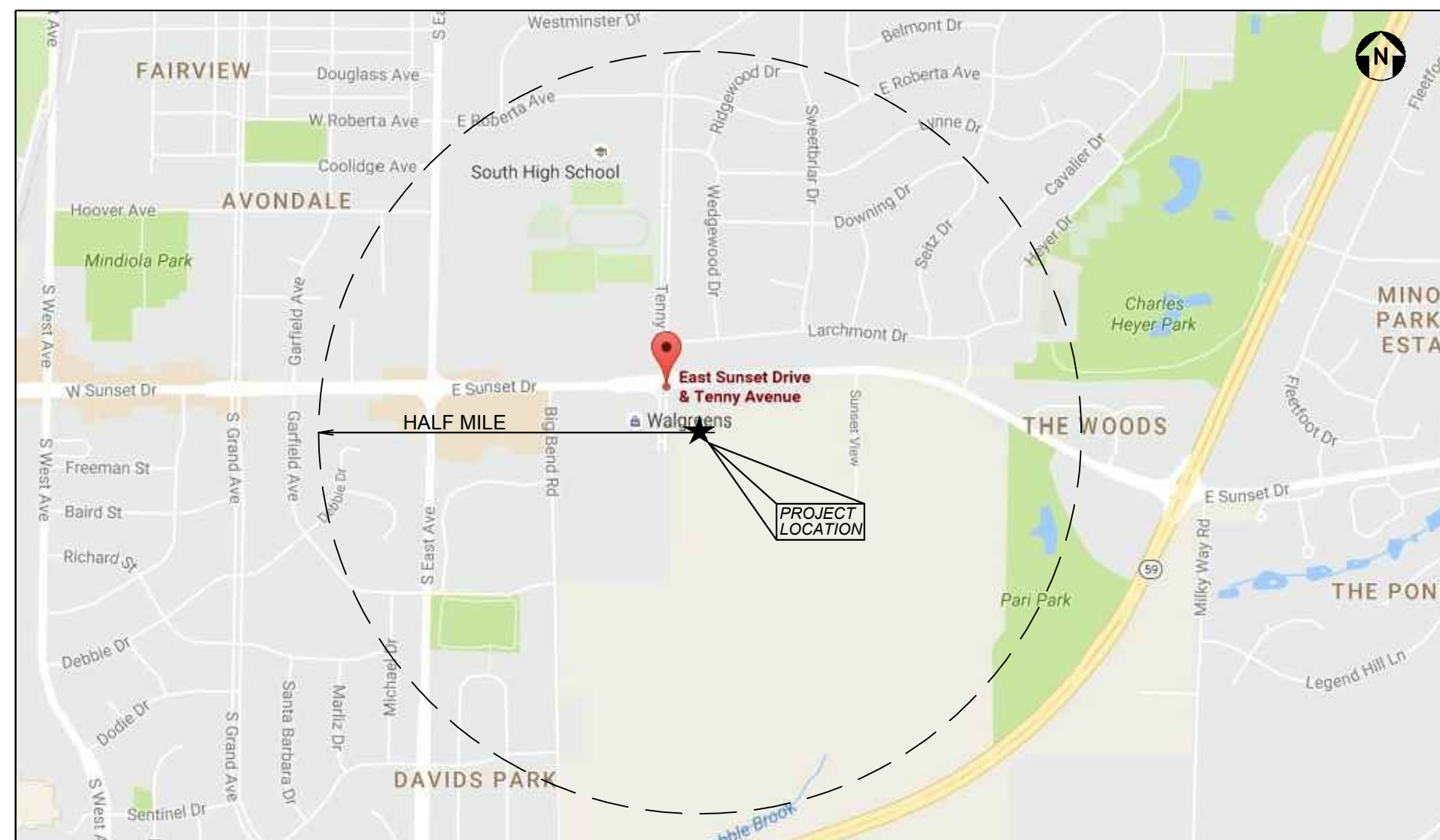

VICINITY MAP

NO SCALE

INDEX OF DRAWINGS

- C0.0 TITLE SHEET
C1.0 PRELIMINARY LAYOUT PLAN
C2.0 PRELIMINARY GRADING PLAN
C3.0 PRELIMINARY UTILITY PLAN

L1.0 PRELIMINARY LANDSCAPE PLAN

A101 SHARED PARKING SITE PLAN
A102 FLOOR PLAN
A103 EXTERIOR ELEVATIONS
A104 EXTERIOR ELEVATIONS



PANDA RESTAURANT GROUP INC.
1683 Walnut Grove Ave.
Rosemead, California
91770
Telephone: 626.799.9898
Facsimile: 626.372.8288

All ideas, designs, arrangement and plans indicated or represented by this drawing are the property of Panda Express Inc. and were created for use on this specific project. None of these ideas, designs, arrangements or plans may be used by or disclosed to any person, firm, or corporation without the written permission of Panda Express Inc.

REVISIONS:

ISSUE DATE:

PRELIMINARY PLAN	
COMMISSION REVIEW	10-05-16

DRAWN BY: BJD

PANDA PROJECT #: S8-17-D5072
ARCH PROJECT #: JCDT160128



V3 Companies
7325 Janes Avenue
Woodridge, IL 60517
630.724.9200 phone
630.724.9202 fax
www.v3co.com

PANDA EXPRESS

WARM & WELCOME V2
SUNSET DR. & TENNY AVE.
WAUKESHA, WI 53189

TITLE SHEET

C0.0

WARM & WELCOME V2



811 • (800) 242-8511
www.DiggersHotline.com