

IRRIGATION NOTES

1. A PLASTIC, AUTOMATIC, TIMER-ACTIVATED IRRIGATION SYSTEM SHALL BE PROVIDED FOR ALL LANDSCAPE AREAS. SEPARATE ZONES TO BE PROVIDED FOR LAWN AND PLANTED BEDS.
2. PROVIDE ROTARY AND MIST POP-UP SPRAYHEADS AS APPROPRIATE FOR THE PARTICULAR SIZE AND SHAPE OF LAWN OR PLANTING AREA, WITH 60% HEAD TO HEAD SPACING. THERE SHALL BE NO OVER SPRAY ON ROADS OR SIDEWALKS.
3. PROVIDE DRIP IRRIGATION WHERE NOTED ON THE PLANS. DRIP IRRIGATION TO PROVIDE PROPER MOISTURE LEVEL FOR SPECIFIED PLANTS (SEE PLANS).
4. PROVIDE WATER CONNECTION, BACKFLOW PREVENTER AND IRRIGATION CONTROLLER INSIDE THE BUILDING.
5. SIZE BOOSTER PUMP, IF REQUIRED, TO PROVIDE 50 GPM AND 40 PSI AT THE SPRINKLER HEADS.
6. PROVIDE SLEEVING AS NECESSARY AND COORDINATE SLEEVE INSTALLATION WITH THE GENERAL CONTRACTOR TO ELIMINATE FUTURE DAMAGE TO INSTALLED PAVEMENT.
7. ALL IRRIGATION EQUIPMENT SHALL BE BY TORO, RAINBIRD, NELSON OR APPROVED EQUAL.
8. THE IRRIGATION CONTRACTOR SHALL SUBMIT SHOP DRAWINGS SHOWING THE DESIGN OF THE SYSTEM, INDICATING LAYOUT, WATER CONNECTION, HEADS, VALVES, PIPING, CONTROLLER, OTHER RELATED EQUIPMENT AND THE ASSOCIATED ELECTRICAL DIAGRAMS FOR APPROVAL PRIOR TO CONSTRUCTION. PROVIDE CATALOGUE CUTS FOR ALL DRIP LINE EQUIPMENT FOR APPROVAL.
9. PROVIDE AN AUTOMATIC RAIN SHUT-OFF.
10. PROVIDE A QUICK COUPLER IN OR ADJACENT TO EACH VALVE BOX, AND AT INTERVALS ALONG THE MAIN WITHIN 100' OF ALL NEW PLANTS, OR AS INDICATED ON THE PLANS.
11. THE IRRIGATION CONTRACTOR SHALL BE RESPONSIBLE FOR BLOWING OUT THE SYSTEM BY AIR COMPRESSION IN THE FALL FOLLOWING INSTALLATION AND TURNING ON THE SYSTEM IN THE FOLLOWING SPRING.
12. THE ENTIRE IRRIGATION SYSTEM SHALL BE GUARANTEED BY THE CONTRACTOR AS TO MATERIAL AND WORKMANSHIP, INCLUDING SETTILING OF BACKFILLED AREAS BELOW GRADE FOR A PERIOD OF ONE YEAR FOLLOWING THE DATE OF FINAL ACCEPTANCE OF THE WORK.
13. ALL WORK SHALL BE IN ACCORDANCE WITH LOCAL MUNICIPALITY STANDARDS, CODES AND ORDINANCES.

LOCATE ALL UNDERGROUND UTILITIES PRIOR TO DIGGING. SHRUB PIT WIDTH TO BE EXTENDED 9" AROUND THE ENTIRE ROOT BALL AS SHOWN IN THE DETAIL BELOW. TEST SHRUB PIT FOR DRAINAGE PRIOR TO INSTALLING SHRUB. PRUNE OFF ALL DEAD, BROKEN OR SCARRED BRANCHES AND SHAPE PRUNE AS DIRECTED BY THE LANDSCAPE ARCHITECT. LOCATE ROOT FLARE IN ROOT BALL AND SET SHRUB HEIGHT SO THAT ROOT FLARE IS FLUSH WITH FINISH GRADE. WATER IN THE PLANTING MIX THOROUGHLY, WHILE KEEPING THE SHRUB PLUMB. STRAIGHTEN SHRUB IF SETTILING OCCURS. MULCH LIMITS FOR SHRUBS TO EXTEND TO ALL EDGES OF PLANTING BEDS, SEE PLANS FOR BED LAYOUTS. CONTRACTOR TO UN-TIE AND REMOVE TWINE FROM AROUND ROOT FLARE AT THE TIME OF PLANTING.

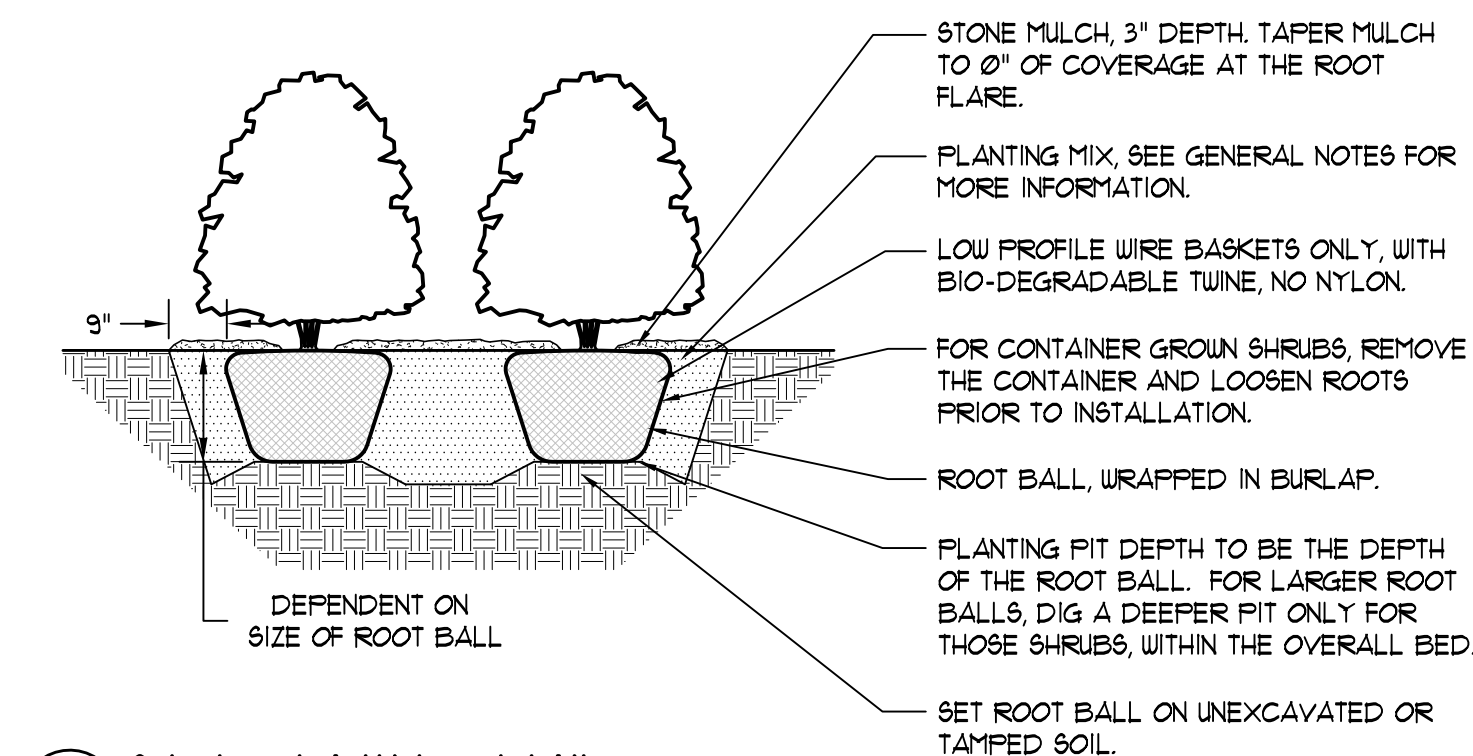

5 SHRUB PLANTING DETAIL
NOT TO SCALE

LOCATE ALL UNDERGROUND UTILITIES PRIOR TO DIGGING. TREE PIT WIDTH TO BE EXTENDED 12" AROUND THE ENTIRE ROOT BALL AS SHOWN IN THE DETAIL BELOW. TEST TREE PIT FOR DRAINAGE PRIOR TO INSTALLING TREE. PRUNE OFF ALL DEAD, BROKEN OR SCARRED BRANCHES, AND SHAPE PRUNE AS DIRECTED BY THE LANDSCAPE ARCHITECT. FOR TREES UP TO 4" CALIFER OR 12' HEIGHT, REMOVE APPROXIMATELY 5% -10% OF THE OVERALL BRANCHING. FOR TREES OVER 4" CALIFER OR 12' HEIGHT, REMOVE APPROXIMATELY 15%-20% OF THE OVERALL BRANCHING. LOCATE ROOT FLARE IN ROOT BALL AND SET TREE HEIGHT SO THAT ROOT FLARE IS FLUSH WITH FINISH GRADE. WATER IN THE PLANTING MIX THOROUGHLY, WHILE KEEPING THE TREE PLUMB. STRAIGHTEN TREE IF SETTILING OCCURS. CONTRACTOR TO UN-TIE AND REMOVE TWINE FROM AROUND ROOT FLARE OF TREE AT THE END OF THE WARRANTY PERIOD.

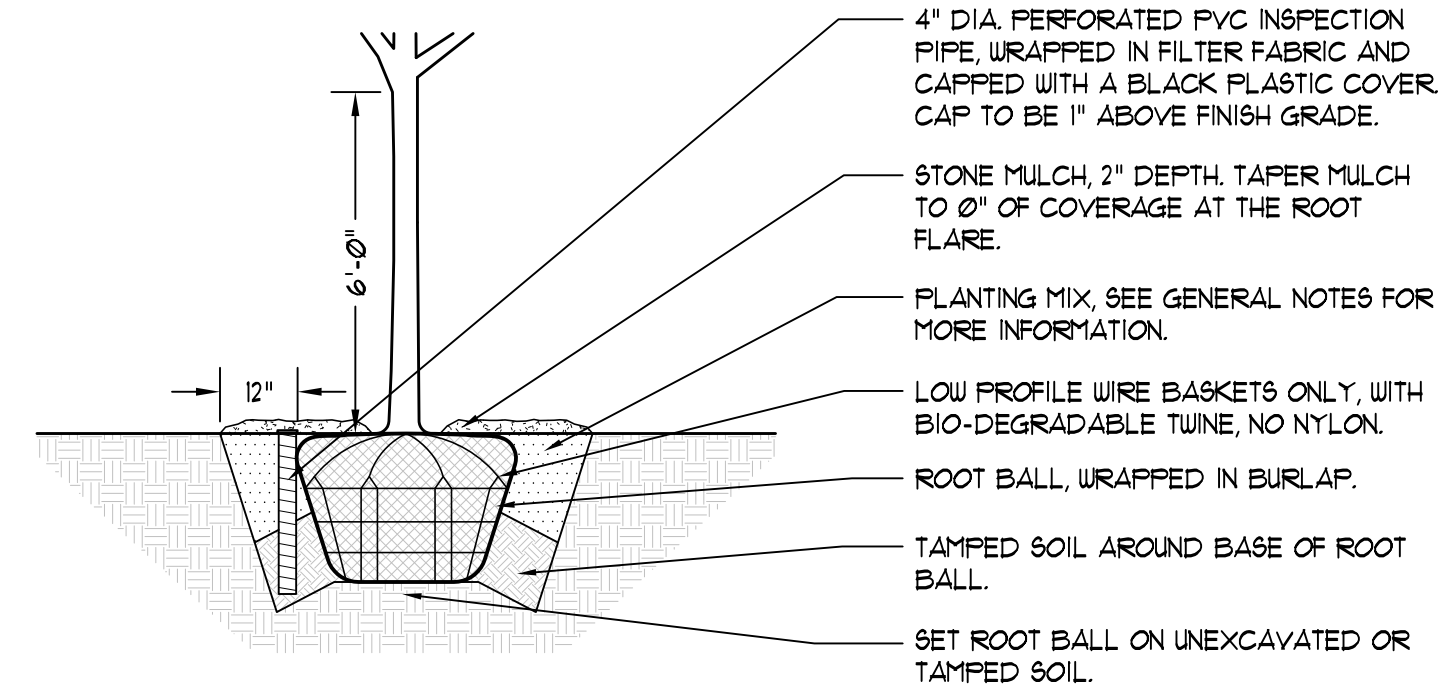

1 DECIDUOUS TREE PLANTING DETAIL
NOT TO SCALE

LOCATE ALL UNDERGROUND UTILITIES PRIOR TO DIGGING. TREE PIT WIDTH TO BE EXTENDED 12" AROUND THE ENTIRE ROOT BALL AS SHOWN IN THE DETAIL BELOW. TEST TREE PIT FOR DRAINAGE PRIOR TO INSTALLING TREE. PRUNE OFF ALL DEAD, BROKEN OR SCARRED BRANCHES, AND SHAPE PRUNE AS DIRECTED BY THE LANDSCAPE ARCHITECT. FOR TREES UP TO 12' HEIGHT, REMOVE APPROXIMATELY 5% -10% OF THE OVERALL BRANCHING. FOR TREES OVER 12' HEIGHT, REMOVE APPROXIMATELY 15%-20% OF THE OVERALL BRANCHING. LOCATE ROOT FLARE IN ROOT BALL AND SET TREE HEIGHT SO THAT ROOT FLARE IS FLUSH WITH FINISH GRADE. WATER IN THE PLANTING MIX THOROUGHLY, WHILE KEEPING THE TREE PLUMB. STRAIGHTEN TREE IF SETTILING OCCURS. CONTRACTOR TO UN-TIE AND REMOVE TWINE FROM AROUND ROOT FLARE OF TREE AT THE END OF THE WARRANTY PERIOD.

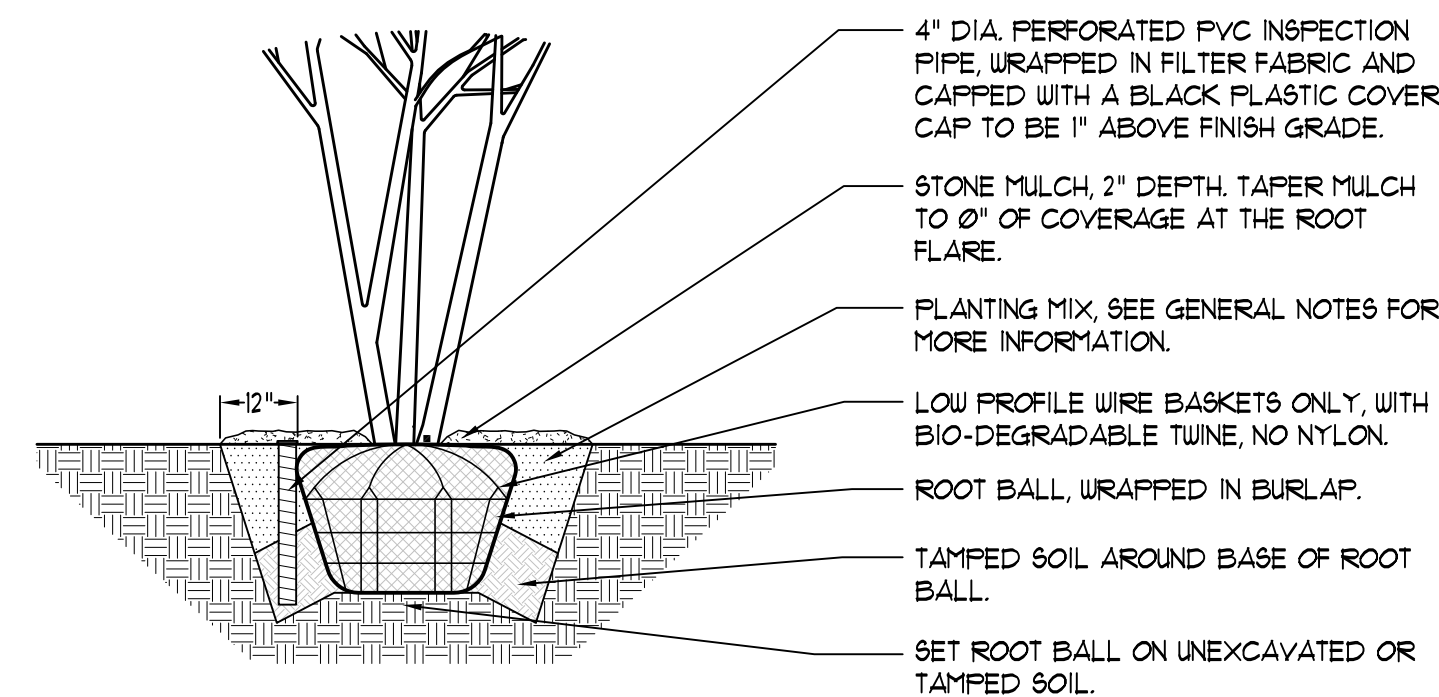

3 MULTI-STEM TREE PLANTING DETAIL
NOT TO SCALE

LOCATE ALL UNDERGROUND UTILITIES PRIOR TO DIGGING. EXCAVATE ENTIRE PERENNIAL / GROUNDCOVER BED, AND BACKFILL WITH PLANTING MIX AS SPECIFIED. BED HEIGHT IS TO BE 2" ABOVE FINISH GRADE AND WELL DRAINED. MULCH LIMITS FOR PERENNIAL BEDS TO EXTEND TO ALL EDGES OF THE BEDS, SEE PLANS FOR BED LAYOUTS. SEE PLANT LIST FOR PLANT SPACING. GAPS BETWEEN PLANTS SHALL BE NO GREATER THAN THE SPECIFIED SPACING FOR THAT PARTICULAR PLANT.

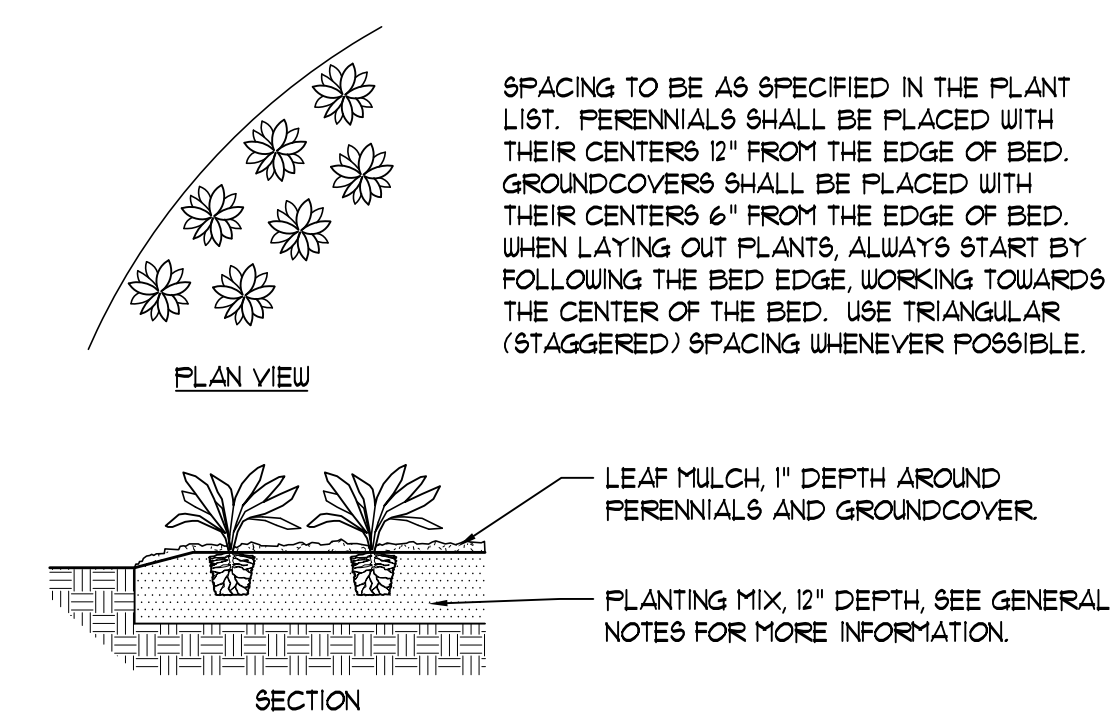

6 PERENNIAL AND GROUNDCOVER PLANTING DETAIL
NOT TO SCALE

EXCAVATE ALL PARKING LOT ISLANDS TO A DEPTH OF 18" FROM TOP OF CURB. BACK FILL ISLANDS TO BE PLANTED WITH 12" OF TOPSOIL AND 12" OF PLANTING MIX. SEE GENERAL NOTES FOR TOPSOIL AND PLANTING MIX REQUIREMENTS. PLACE TREE IN CENTER OF ISLAND AS SHOWN. SEE DECIDUOUS TREE, SHRUB AND PERENNIAL PLANTING DETAILS FOR ADDITIONAL INFORMATION.

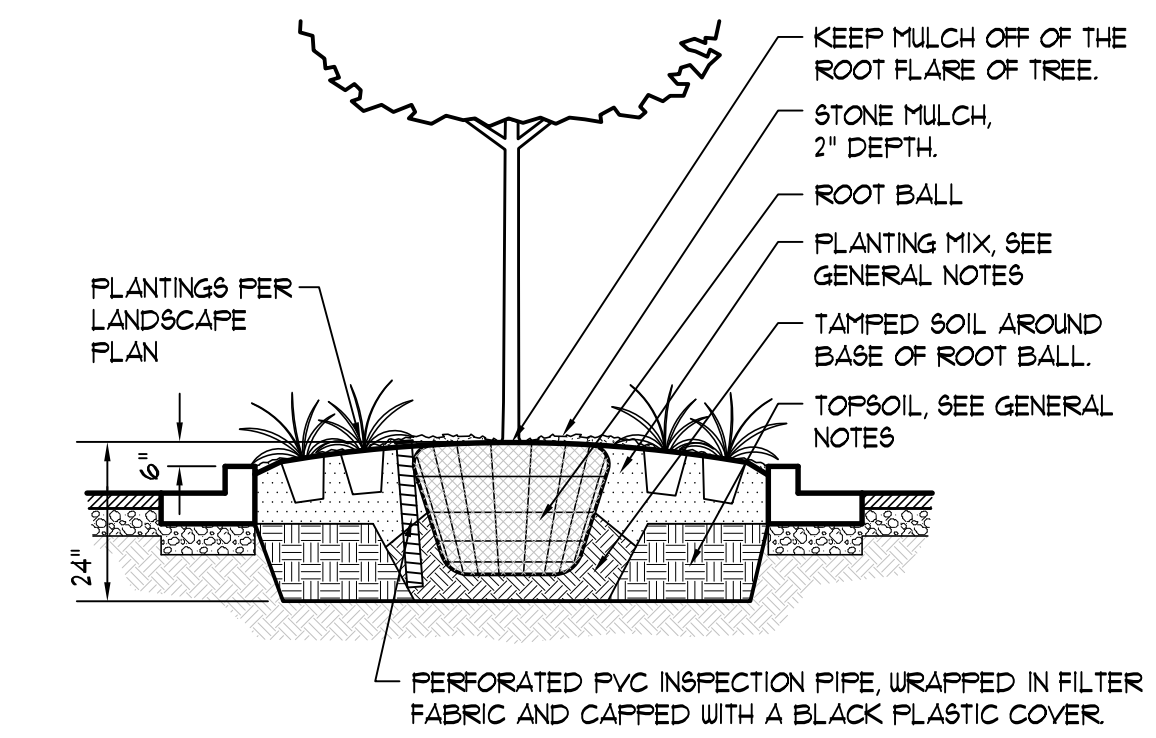

2 PARKING LOT ISLAND SECTION - PLANTED
NOT TO SCALE

LOCATE ALL UNDERGROUND UTILITIES PRIOR TO DIGGING. TREE PIT WIDTH TO BE EXTENDED 12" AROUND THE ENTIRE ROOT BALL AS SHOWN IN THE DETAIL BELOW. TEST TREE PIT FOR DRAINAGE PRIOR TO INSTALLING TREE. PRUNE OFF ALL DEAD, BROKEN OR SCARRED BRANCHES, AND REMOVE ANY DOUBLE LEADERS. LOCATE ROOT FLARE IN ROOT BALL AND SET TREE HEIGHT SO THAT ROOT FLARE IS FLUSH WITH FINISH GRADE. WATER IN THE PLANTING MIX THOROUGHLY, WHILE KEEPING THE TREE PLUMB. STRAIGHTEN TREE IF SETTILING OCCURS. CONTRACTOR TO UN-TIE AND REMOVE TWINE FROM AROUND THE ROOT FLARE AT THE END OF THE WARRANTY PERIOD.

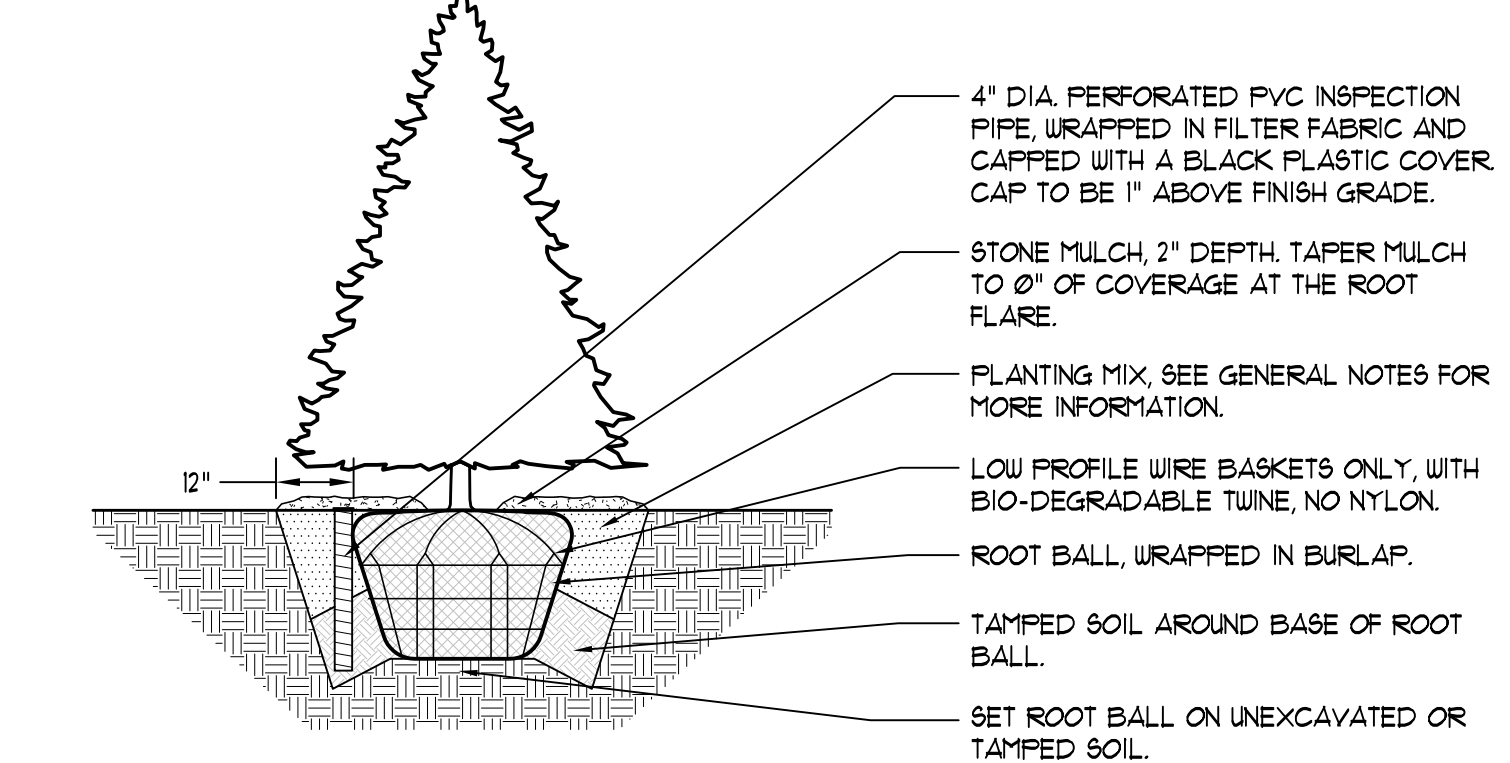

4 EVERGREEN TREE PLANTING DETAIL
NOT TO SCALE

HOLE IS PRESENT ONLY WHEN GALVANIZED OPTION IS SPECIFIED. BIKE RACK PROVIDED BY VICTOR STANLEY, PH: 888-368-2513, MODEL # BRUBS-101, OR EQUIVALENT. EMBEDDED INSTALLATION, TO BE INSTALLED DURING SIDEWALK INSTALLATION. INSTALL PER MANUFACTURERS SPECIFICATIONS.

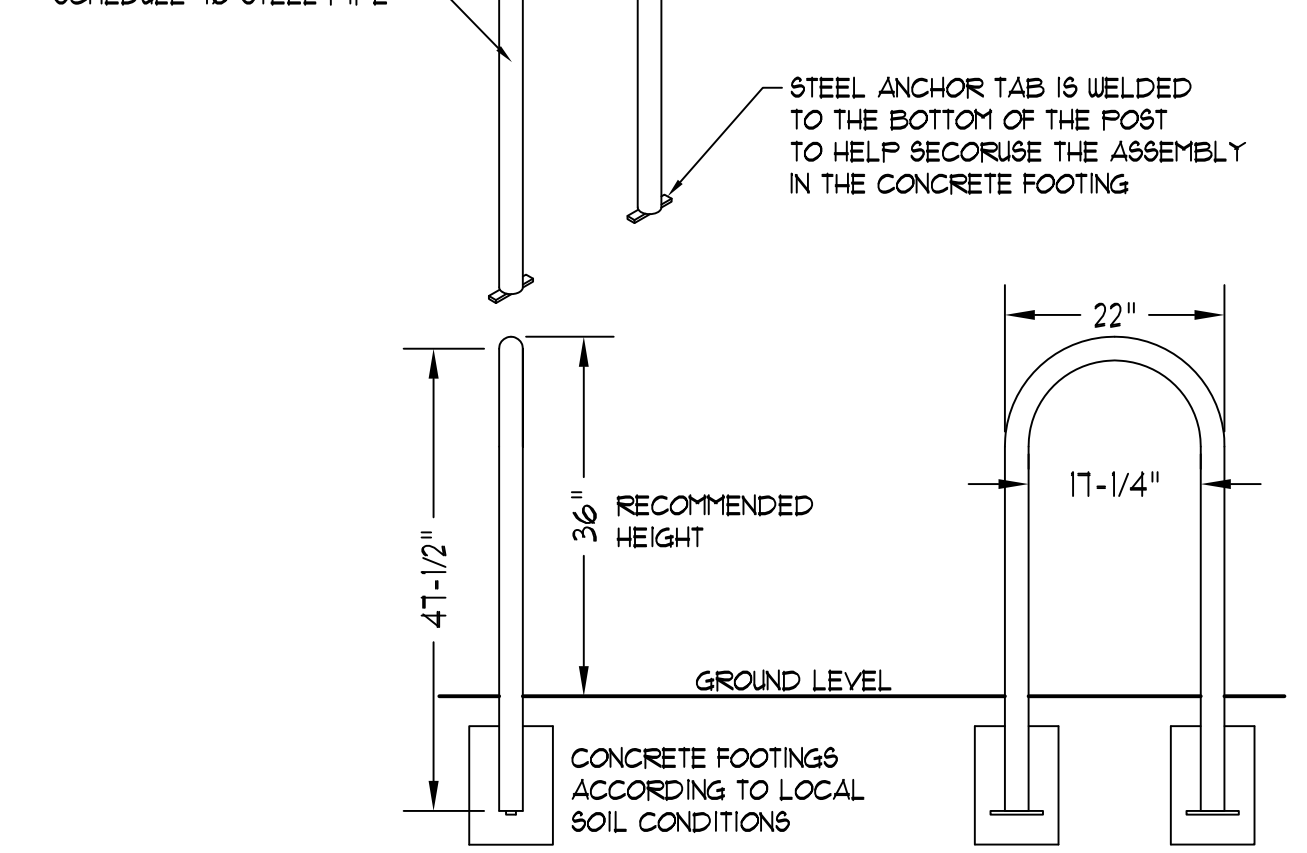

7 BIKE RACK DETAIL
NOT TO SCALE



Wendy Schuenberg



PANDA RESTAURANT GROUP INC.
1683 Walnut Grove Ave.
Rosemead, California
91770
Telephone: 626.799.9898
Facsimile: 626.372.8288

All ideas, designs, arrangement and plans indicated or represented by this drawing are the property of Panda Express Inc. and were created for use on this specific project. None of these ideas, designs, arrangements or plans may be used by or disclosed to any person, firm, or corporation without the written permission of Panda Express Inc.

REVISIONS:

PLAN COMMISSION REVISION	DATE
02222017	

ISSUE DATE:

PRELIMINARY PLAN COMMISSION REVIEW	10-05-16
PANDA DRIVEWAY DIMENSIONS	11-23-16
FINAL PLAN COMMISSION REVIEW	01-17-17

DRAWN BY: EH

PANDA PROJECT #: S8-17-D5072
ARCH PROJECT #: JCDT160128

DANIEL WEINBACH & PARTNERS, LTD.
Landscape Architects

53 W. Jackson Blvd., Suite 250
Chicago, Illinois 60604
312.427.2888

NOT FOR CONSTRUCTION

V3 Companies
7325 Jones Avenue
Woodridge, IL 60517
630.724.9200 phone
630.724.9202 fax
www.v3co.com

PANDA EXPRESS

WARM & WELCOME V2
SUNSET DR. & TENNY AVE.
WAUKESHA, WI 53189

LANDSCAPE DETAILS & NOTES

L2.0

WARM & WELCOME V2