

PROJECT

PROJECT:
Operations Center

0 Chapman Drive, Waukesha, WI 53158

Issue Description

OWNER:
Waukesha Water Utility

PROJECT ISSUE DATE:
January 23, 2025



10505 Corporate Drive, Pleasant Prairie, WI 53158
phone: 262.857.8101 web: www.kuenyarch.com

©2025 Kueny Architects L.L.C. - All Rights Reserved

CONSULTANTS

ARCHITECT

Kueny Architects
Phone: 262.857.8101
Address: 10505 Corporate Drive, Suite 100
Pleasant Prairie, Wisconsin 53158

Architect of Record - Jon P. Wallenkamp
P-14,690,3197

Project Manager - Lee Anderson
P-262,945,7709

CIVIL

TerraTee Engineering
Phone: 262.377.8905
Address: W67N222 Evergreen Blvd., Suite 205
Cedarburg, WI 53012

Engineer of Record - Linda Johnson

MEP

RTM Engineering Consultants
Phone: 414.273.1432
Address: 316 N. Milwaukee Street, Suite 560
Milwaukee, WI 53202

Engineer of Record - Timothy Larsen, PE

Landscape Architect

The Sigma Group
Phone: 414.543.4200
Address: 1300 W. Canal Street
Milwaukee, WI 53233

Landscape Architect of Record - Rosheen Styczinski

REVISIONS

REV #	DESCRIPTION	DATE

KEY PLAN

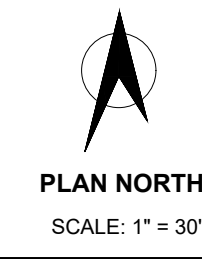
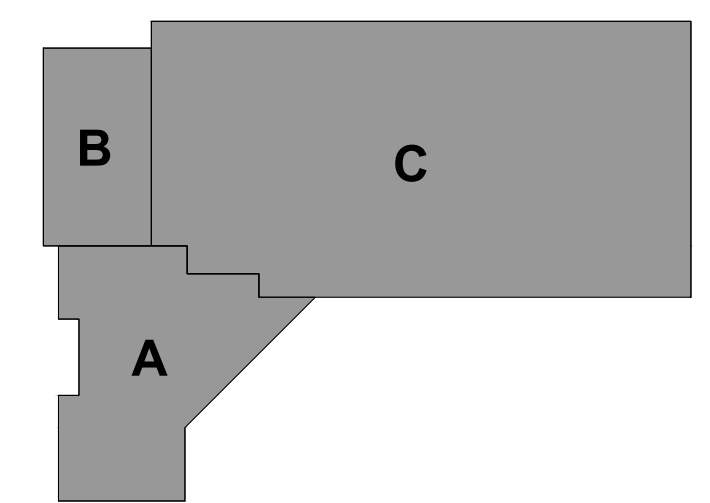

SHEET

SHEET TITLE:
Landscape Plan

L100

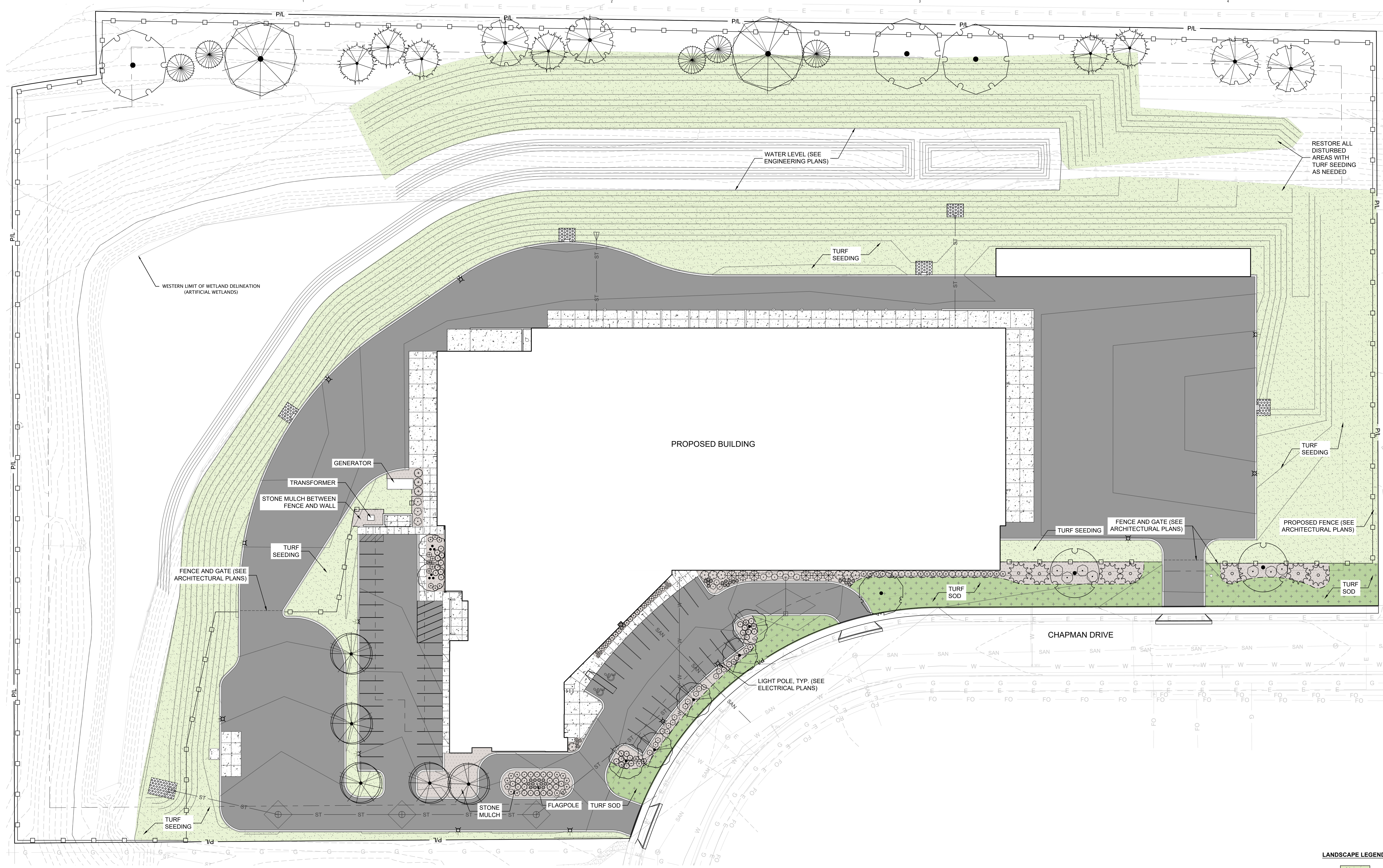

PLANT SCHEDULE					
SYMBOL	CODE	BOTANICAL / COMMON NAME	SIZE	CONTAINER	QTY
DECIDUOUS TREES					
	AC	Acer x freemanii 'Celzam' / Celebration® Freeman Maple	2.5' Cal.	B&B	2
	GS	Gleditsia triacanthos inermis 'Shademaker' / Shademaker Honey Locust	2.5' Cal.	B&B	5
	GD	Gymnocladus dioica 'Espresso' / Kentucky Coffeetree	2.5' Cal.	B&B	4
	QB	Quercus bicolor / Swamp White Oak	2.5' Cal.	B&B	2
	QS	Quercus x schuettei / Swamp Bur Oak	2.5' Cal.	B&B	3
	TA	Tilia americana 'Kromm' / Sweet Street™ American Linden	2.5' Cal.	B&B	5
	TG	Tilia cordata 'Greenspire' / Greenspire Littleleaf Linden	2.5' Cal.	B&B	1

EVERGREEN TREES					
	AC2	Abies concolor / White Fir	6' Ht.	B&B	5
	PB	Pinus cembra 'Big Blue' / Big Blue Swiss Stone Pine	6' Ht.	B&B	7
	PS	Pinus strobus / White Pine	6' Ht.	B&B	6
ORNAMENTAL TREES					
	AG	Amelanchier x grandiflora 'Autumn Brilliance' / Autumn Brilliance Apple Serviceberry	1.5' Cal (Multi-Stem)	B&B	2
DECIDUOUS SHRUBS					
	AM	Aronia melanocarpa elata / Glossy Black Chokeberry	2' Ht.	Cont.	17
	CS	Cornus sericea 'Alleman's Compact' / Dwarf Red Twig Dogwood	2' Ht.	Cont.	3
	CA	Corylus americana / American Hazelnut	3' Ht.	Cont.	7
	SL	Diervilla lonicera 'Jewel' / Jewel Bush Honeysuckle	1.5' Ht.	Cont.	19
	FB	Fothergilla gardenii 'Beaver Creek' / Beaver Creek Dwarf Fothergilla	3 gal.	Cont.	15
	HL	Hydrangea paniculata 'SMHPLQF' / Little Quick Fire® Panicle Hydrangea	1.5' Ht.	Cont.	3
	RG	Rhus aromatica 'Gro-Low' / Gro-Low Fragrant Sumac	3 gal.	Cont.	46
	SM	Syringa meyeri 'Palibin' / Dwarf Korean Lilac	2' Ht.	Cont.	7

EVERGREEN SHRUBS					
	JP	Juniperus chinensis 'Kallays Compact' / Kallay Compact Pfitzer Juniper	3 gal.	Cont.	30
	JF	Juniperus chinensis 'Sea Green' / Sea Green Juniper	2' Ht.	Cont.	3
	JB	Juniperus sabina 'Blue Forest' / Blue Forest Juniper	3 gal.	Cont.	14
	TB	Thuja occidentalis 'Bail John' / Technito® Arborvitae	4' Ht.	B&B	6
ORNAMENTAL GRASSES					
	CK	Calamagrostis x acutiflora 'Karl Foerster' / Karl Foerster Feather Reed Grass	1 gal.	Cont.	33
	ST	Sporobolus heterolepis 'Tara' / Tara Prairie Dropseed	1 gal.	Cont.	10

LANDSCAPE LEGEND:

	TURFGRASS SEED
	TURFGRASS SOD
	STONE MULCH
	PROPERTY LINE
	METAL PLANT BED EDGING

- LANDSCAPE GENERAL NOTES:**
- VERIFY EXISTING AND PROPOSED CONDITIONS, UTILITIES, PIPES, AND STRUCTURES, ETC. PRIOR TO BIDDING AND CONSTRUCTION.
 - INSPECT THE SITE PRIOR TO COMMENCING WORK. DOCUMENT IN WRITING AND PHOTOGRAPH EXISTING CONDITIONS WITHIN, AND IN AREAS ADJACENT TO THE LIMITS OF CONSTRUCTION. THE LANDSCAPE CONTRACTOR IS RESPONSIBLE FOR ANY DAMAGES NOT DOCUMENTED IN THE PHOTOGRAPHS PRIOR TO COMMENCEMENT OF DEMOLITION ACTIVITIES.
 - COORDINATE THE INSTALLATION OF PLANT MATERIAL WITH INSTALLATION OF ADJACENT PAVEMENTS, DRAINAGE, CURB RELATED STRUCTURES WITH OTHER TRADES.
 - RESTORE AREAS OF THE SITE, OR ADJACENT AREAS, WHERE DISTURBED. DAMAGE CAUSED DURING LANDSCAPE INSTALLATION TO EXISTING CONDITIONS AND IMPROVEMENTS IS THE RESPONSIBILITY OF THE LANDSCAPE CONTRACTOR.
 - CONTRACTOR SHALL THOROUGHLY REVIEW ALL SPECIFICATIONS RELATED TO TREE PROTECTION, SOIL PREPARATION, TURF, GRASSES AND PLANTS. THESE SECTIONS PROVIDE ADDITIONAL INFORMATION ON MATERIALS AND SET STANDARDS FOR QUALITY AND INSTALLATION REQUIREMENTS.
 - PROVIDE 3" DOUBLE SHREDDED BARK MULCH FOR ALL PLANTED TREES, SHRUBS AND LANDSCAPE BEDS.



CALL DIGGERS HOTLINE
1-800-242-8511
TOLL FREE
WE STATE: RESIDENTS
NEED NOT BE NOTICED
BEFORE YOU EXCAVATE
MILW. AREA 259-1181

THE UNDERGROUND UTILITY INFORMATION SHOWN ON THIS MAP IS BASED ON FIELD MARKINGS AND INFORMATION FURNISHED BY UTILITY COMPANIES AND THE LOCAL MUNICIPALITY. WHILE THIS INFORMATION IS BELIEVED TO BE RELIABLE, ITS ACCURACY AND COMPLETENESS CANNOT BE GUARANTEED.

