

PLANT LIST

KEY	QTY.	SIZE	ROOT	TYPE:
A	2	2"	BB	FLOWERING CRAB - SPRING SNOW
B	3	4-5'	BB	LILAC - COMMON PURPLE : HEAVY BRANCHED SPECIMEN
C	1	2"	BB	CALLERY PEAR - AUTUMN BLAZE
D	12	15-18"	POT	HYDRANGEA - LITTLE LIME
E	11	3-4'	BB	BURNING BUSH - DWARF
F	2	4-5'	BB	VIBURNUM - AUTUMN JAZZ
G	14	18-24"	POT	RUSSIAN CYPRESS
H	19	1 GAL.	POT	HOSTA - SUM & SUBSTANCE
I	27	1 GAL.	POT	GRASS - KARL FOERSTER
J	30	1 GAL.	POT	SEDUM - AUTUMN FIRE
K	10	24-30"	BB	LILAC - DWARF KOREAN
L	64	1 GAL.	POT	DAYLILLY - HYPERION
M	6	15-18"	POT	SPIREA - NEON FLASH

NOTES:

- 1) ALL PLANTS MUST MEET A.A.N. STANDARDS
- 2) NO SUBSTITUTIONS
- 3) SIZES SHOWN ARE MINIMUM ACCEPTABLE

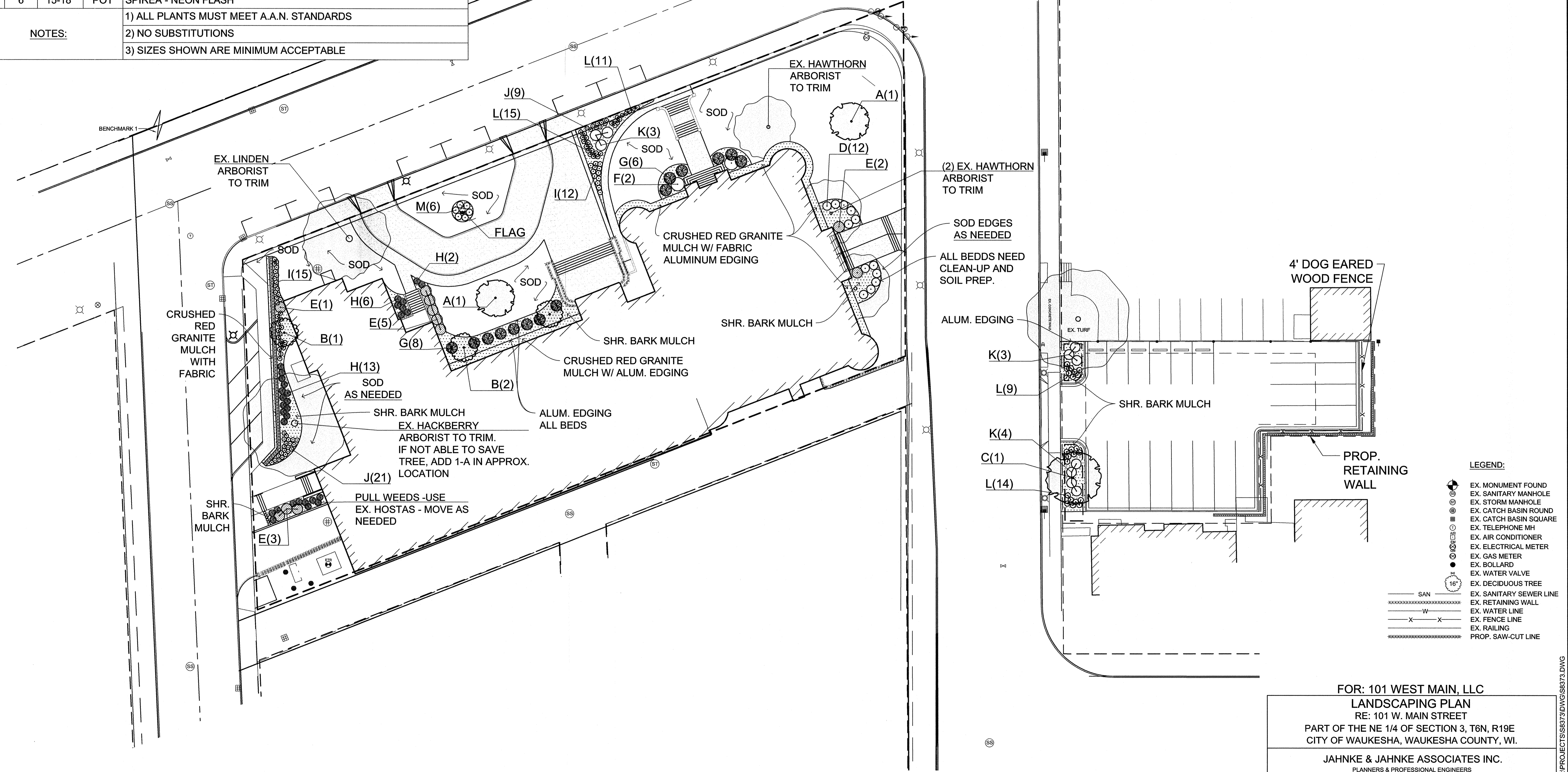
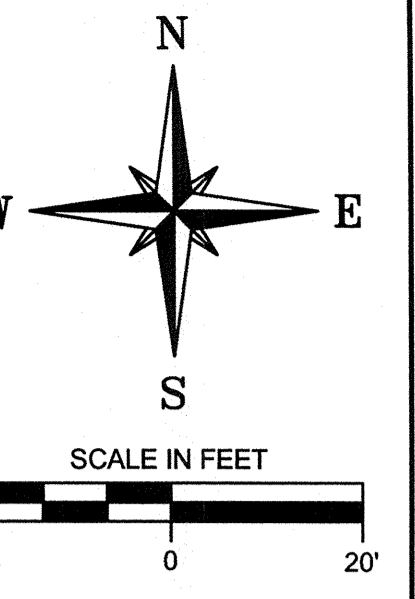

LEGEND:

	EX. MONUMENT FOUND
	EX. SANITARY MANHOLE
	EX. CATCH BASIN ROUND
	EX. CATCH BASIN SQUARE
	EX. TELEPHONE MH
	EX. AIR CONDITIONER
	EX. ELECTRICAL METER
	EX. GAS METER
	EX. BOLLARD
	EX. WATER VALVE
	EX. DECIDUOUS TREE
	EX. SANITARY SEWER LINE
	EX. RETAINING WALL
	EX. WATER LINE
	EX. FENCE LINE
	EX. RAILING
	PROP. SAW-CUT LINE

FOR: 101 WEST MAIN, LLC
LANDSCAPING PLAN
 RE: 101 W. MAIN STREET
 PART OF THE NE 1/4 OF SECTION 3, T6N, R19E
 CITY OF WAUKESHA, WAUKESHA COUNTY, WI.

JAHNKE & JAHNKE ASSOCIATES INC.
 PLANNERS & PROFESSIONAL ENGINEERS
 711 W. MORELAND BLVD - WAUKESHA, WI 53188
 TEL. No. (262) 542-5797 FAX (262) 542-7698

SCALE: 1" = 20'	DATE: MAY 26, 2015
DRAWN BY: _____	CHECKED BY: PJJ
FILE NO.: WAUKESHA 1167	
REVISED: SEPTEMBER 18TH, 2017	BOOK NO.: WAUKESHA 194
JOB: S-8373	SHEET 5 OF 5

FILE NAME: S:\PROJECTS\S8373\DWG\S8373.DWG