

**DEMOLITION PLAN**

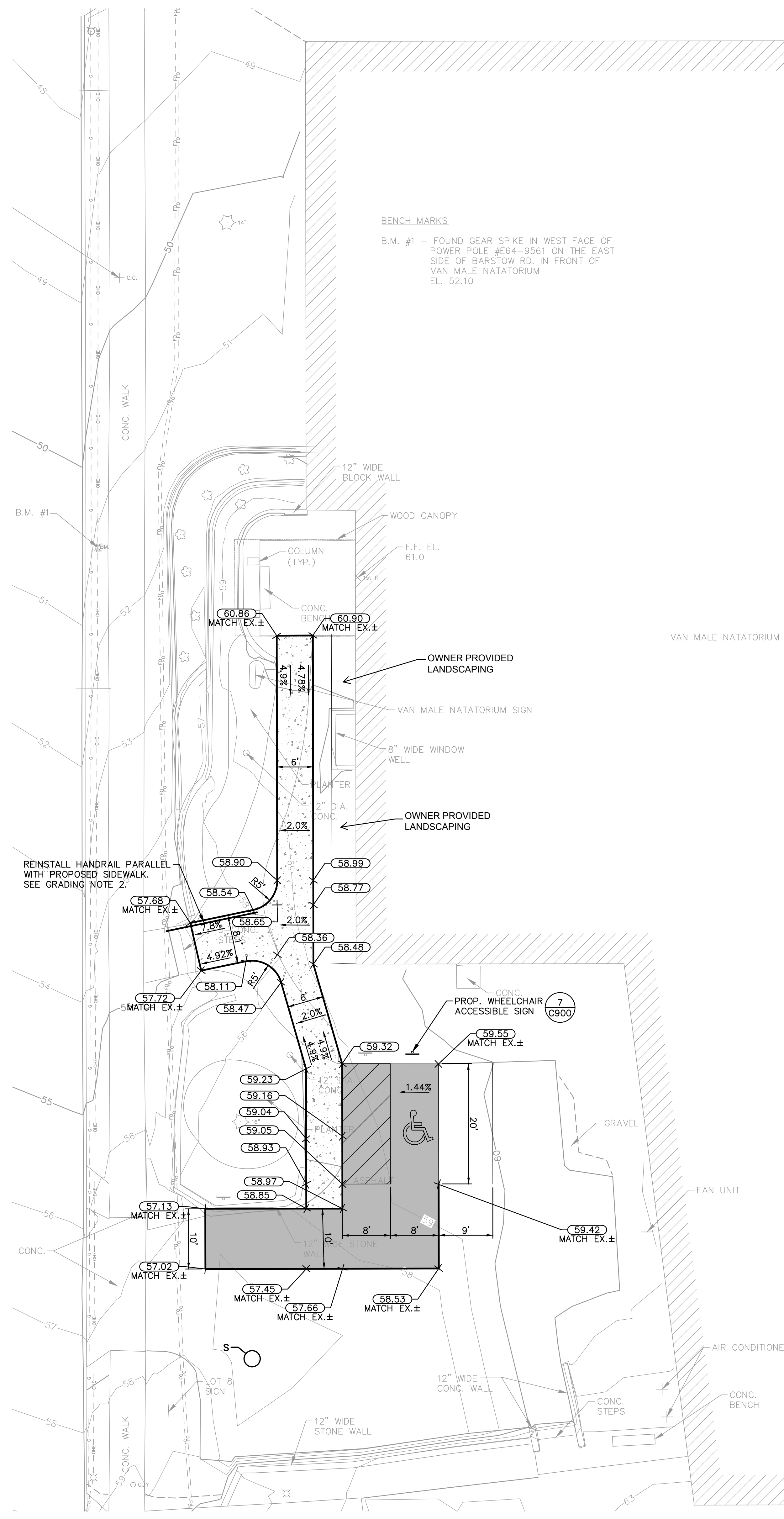

**PROPOSED SITE LAYOUT, GRADING AND EROSION CONTROL PLAN**

**GENERAL NOTES**

1. ALL UNDERGROUND STRUCTURES AND UTILITIES HAVE BEEN SHOWN TO A REASONABLE DEGREE OF ACCURACY. IT SHALL BE THE CONTRACTORS RESPONSIBILITY TO VERIFY THE EXACT LOCATION AND DEPTH.

**EROSION CONTROL NOTES**

1. CONSTRUCTION SITE EROSION CONTROL AND SEDIMENTATION CONTROL SHALL COMPLY WITH THE REQUIREMENTS OF THE CITY OF WAUKESHA, AND SHALL EMPLOY EROSION CONTROL METHODS AS SHOWN AND SPECIFIED IN THE WISCONSIN DEPARTMENT OF NATURAL RESOURCES (WDNR) "CONSTRUCTION SITE EROSION AND SEDIMENT CONTROL TECHNICAL STANDARDS".
2. ALL EROSION CONTROL MEASURES SHALL BE ADJUSTED TO MEET FIELD CONDITIONS AT THE TIME OF CONSTRUCTION AND SHALL BE INSTALLED PRIOR TO ANY GRADING OR DISTURBANCE OF EXISTING SURFACE MATERIAL ON THE SITE.
3. ALL EROSION AND SEDIMENT CONTROL MEASURES WILL BE CHECKED FOR STABILITY AND OPERATION AFTER A RAINFALL OF 0.5 INCHES OR MORE, BUT NO LESS THAN ONCE EVERY WEEK. MAINTENANCE OF ALL EROSION CONTROL STRUCTURES SHALL BE PROVIDED TO INSURE INTENDED PURPOSE IS ACCOMPLISHED. REPAIRS AND MAINTENANCE SHALL BE COMPLETED WITHIN 24 HOURS OF INSPECTION. CONTRACTOR SHALL BE RESPONSIBLE FOR CLEANUP AND REMOVAL OF ALL SEDIMENT WHEN LEAVING PROPERTY. EROSION CONTROL MEASURES MUST BE IN WORKING CONDITION AT END OF EACH WORK DAY.
4. SILT FENCE SHALL BE INSTALLED IN THE LOCATIONS SHOWN ON THE CONSTRUCTION PLANS. SEDIMENT DEPOSITS WILL BE REMOVED FROM BEHIND THE SILT FENCE WHEN DEPOSITS REACH A DEPTH OF 6 INCHES. THE SILT FENCE WILL BE REPAIRED OR REPLACED AS NECESSARY TO MAINTAIN A BARRIER.
5. FILTER FABRIC SHALL BE INSTALLED BENEATH INLET COVERS TO TRAP SEDIMENT AS PER INLET PROTECTION DETAIL IN THE LOCATIONS SHOWN ON THE CONSTRUCTION PLANS.
6. EROSION CONTROL MEASURES SHALL BE MAINTAINED ON A CONTINUING BASIS UNTIL SITE IS FULLY STABILIZED.
7. PERIODIC STREET SWEEPING SHALL BE COMPLETED TO MAINTAIN THE PUBLIC STREET FREE OF DUST AND DIRT.
8. CONSTRUCTION SEQUENCE FOR EROSION CONTROL INCLUDES:
  1. INSTALL INLET PROTECTION.
  2. REMOVE EROSION CONTROL MEASURES ONLY WHEN SITE IS FULLY STABILIZED.
9. WASTE AND MATERIAL DISPOSAL: ALL WASTE AND UNUSED BUILDING MATERIALS (INCLUDING GARBAGE, DEBRIS, CLEANING WASTES, WASTEWATER, TOXIC MATERIALS, OR HAZARDOUS MATERIALS) SHALL BE PROPERLY DISPOSED AND NOT ALLOWED TO BE CARRIED OFF-SITE BY RUNOFF OR WIND.
10. SEDIMENT CLEANUP: ALL OFF-SITE SEDIMENT DEPOSITS OCCURRING AS A RESULT OF A STORM EVENT SHALL BE CLEANED UP BY THE END OF THE NEXT WORK DAY. ALL OTHER OFF-SITE SEDIMENT DEPOSITS OCCURRING AS A RESULT OF CONSTRUCTION ACTIVITIES SHALL BE CLEANED UP BY THE END OF THE WORK DAY.
11. ALL DISTURBED GROUND LEFT INACTIVE FOR SEVEN OR MORE DAYS SHALL BE STABILIZED BY TEMPORARY OR PERMANENT SEEDING, AND MULCHING SODDING, COVERING WITH TARPS, OR EQUIVALENT BEST MANAGEMENT PRACTICES. IF TEMPORARY SEEDING IS USED, A PERMANENT COVER SHALL ALSO BE REQUIRED AS PART OF THE FINAL SITE STABILIZATION. SEEDING OR SODDING SHALL BE REQUIRED AS PART OF THE FINAL SITE STABILIZATION.

**DEMOLITIONS NOTES**

1. REMOVE EXISTING CONCRETE LIGHT POLE BASE COMPLETELY AND CAP ELECTRICAL CONDUIT TO REMAIN IN PLACE (WATER TIGHT).
2. CAREFULLY REMOVE ANGLE SECTION OF EXISTING PIPE HANDRAIL. THE TWO POSTS WITHIN THE EXISTING STAIRS TO REMAIN MUST REMAIN IN PLACE. CLEARLY CUT THE PIPE SECTIONS TO BE REATTACHED TO UPPER STAIR POST IN PARALLEL ALIGNMENT TO THE NEW SIDEWALK. RAILS AND POSTS SHALL BE GROUND/SANDED SMOOTH TO RECEIVE NEW WELDS, PRIME COAT, AND PAINT.

**GRADING NOTES**

1. ADA REGULATIONS REQUIRE A MAXIMUM SLOPE OF 1:20 (5%) ALONG THE LENGTH OF THE ACCESSIBLE ROUTE AND A MAXIMUM SLOPE OF 1:50 (2%) ACROSS THE WIDTH OF THE ACCESSIBLE ROUTE. ADA REGULATIONS REQUIRE A MAXIMUM SLOPE OF 1:50 (2%) IN ALL DIRECTIONS WITHIN AN ADA PARKING STALL AND ADJACENT UNLOADING ZONE.
2. REINSTALLED HANDRAIL POST SHALL BE INSTALLED IN A 12-INCH DIAMETER CONCRETE FOOTING TO A DEPTH OF 4 FEET. PROVIDE A FOOTING SLEEVE EXTENDING FLUSH WITH THE SURFACE OF THE CONCRETE SIDEWALK WITH EXPANSION MATERIAL AROUND FOOTING. WELD RAILS TO UPPER STAIR POST. ENTIRE HANDRAIL SHALL BE PRIMED AND PAINTED TO MATCH EXISTING COLOR.

**PROPOSED LEGEND**

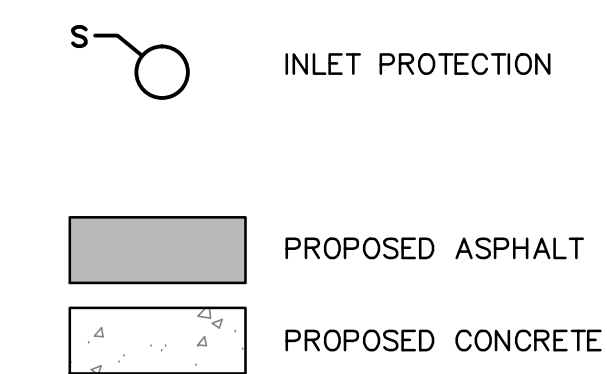

**DEMOLITION LEGEND**

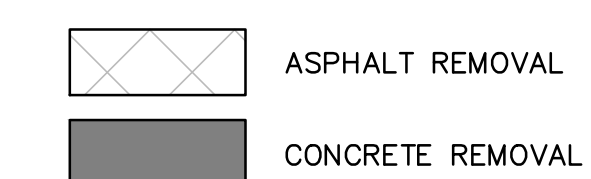

Revisions

INTERIOR RENOVATION AND REMODEL - PLAN COMMISSION SET

Drawing Date  
04/30/2014

VAN MALE FIELD HOUSE LOCKER ROOM RENOVATION

100 N. East Ave.  
Waukesha, WI 53186

Project No. CARROL UNIVERSITY  
214004.00

Sheet Title

SITE LAYOUT, GRADING, EROSION CONTROL & DEMOLITION PLAN

111 West Wisconsin Avenue, Milwaukee, Wisconsin 53203  
Telephone 414.272.2000 Fax 414.272.2001

44 East Millin Street, Suite 700, Madison, Wisconsin 53703  
Telephone 608.283.6300 Fax 608.283.6317

Sheet No.

C1.01

**NOTICE:**  
In accordance with Wisconsin statute 182.0175, damage to transmission facilities, excavator shall be solely responsible to provide advance notice to the designated "ONE CALL SYSTEM" not less than three working days prior to commencement of any excavation required to perform work contained on this drawing, and further, excavator shall comply with all other requirements of this statute relative to excavator's work.

**DISCLAIMER:**  
The underground utilities shown have been located from field survey information and existing drawings. The surveyor makes no guarantee that the underground utilities shown comprise all such utilities in the area, either in service or abandoned. The surveyor further does not warrant that the underground utilities shown are in the exact location indicated although he does certify that they are located as accurately as possible from information available. The surveyor has not physically located the underground utilities.