

NORTH

DEMO FLOOR PLAN
 1/8" = 1'-0"

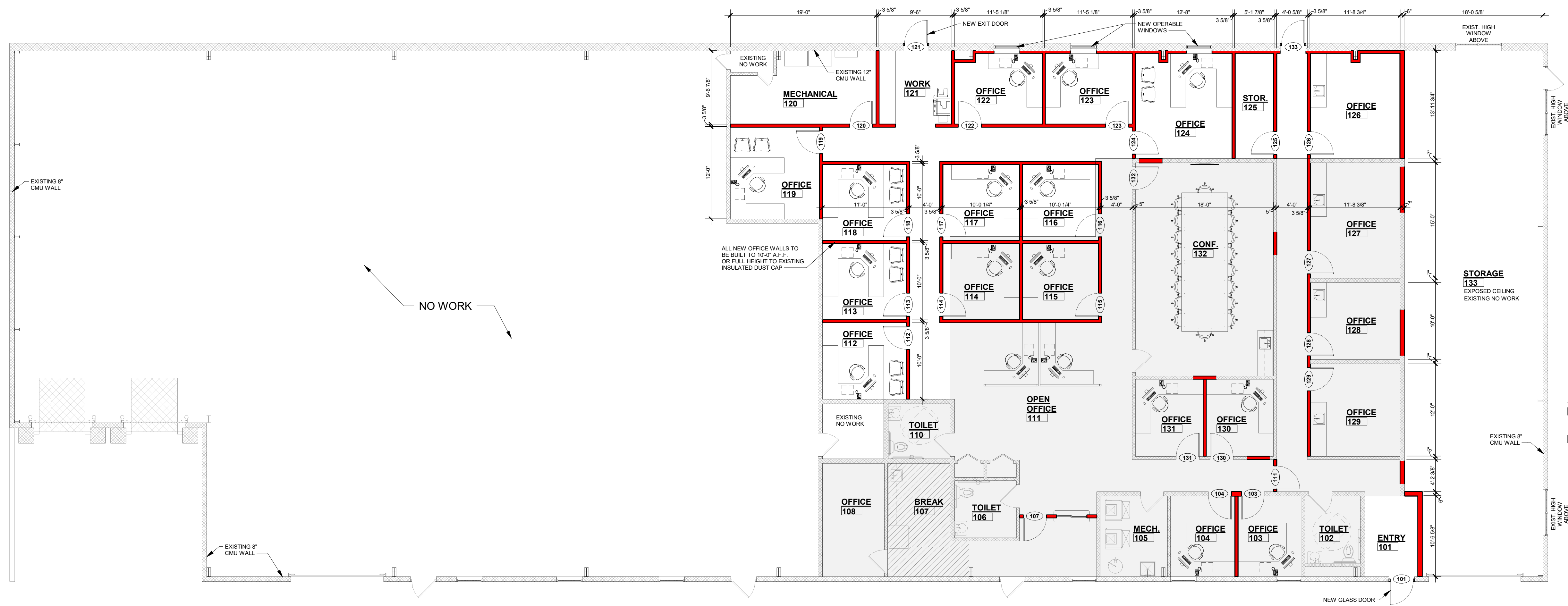

NORTH

FLOOR PLAN
 1/8" = 1'-0"

- NOTES:
- EXISTING INSULATED DUST CAP
 - 9'-0" A.C.T. CEILING THROUGHOUT
 - EXISTING GYP. BD. CLG. TO REMAIN

WALL KEY

	NEW WALL/FURRING
	TYPICAL EXISTING WALL
	DEMO WALLS



Keller

PLANNERS | ARCHITECTS | BUILDERS

FOX CITIES
 N216 State Road 55
 P.O. Box 620
 Kaukauna, WI 54130
 PHONE (920) 766-5795 /
 1-800-236-2534
 FAX (920) 766-5004

MADISON
 711 Lodi Dr.
 Sun Prairie, WI 53590
 PHONE (608) 318-2336
 FAX (608) 318-2337

MILWAUKEE
 W204 N11509
 Coltondale Rd
 Germantown, WI 53022
 PHONE (262) 250-9710
 1-800-236-2534
 FAX (262) 250-9740

WAUSAU
 5605 Libac Ave
 Wausau, WI 54401
 PHONE (715) 849-3141
 1-800-236-2534
 FAX (715) 849-3181

www.kellerbuilds.com

PROPOSED FOR:

THERMTECH

WISCONSIN

WAUKESHA,

"COPYRIGHT NOTICE"
 This design, drawing and detail is the copyrighted property of KELLER, INC. No part hereof shall be copied, duplicated, distributed, disclosed or made available to anyone without the expressed written consent of KELLER, INC.

PRELIMINARY - NOT FOR CONSTRUCTION

REVISIONS

1	12.16.2021	C. TEAFOE
2		
3		
4		
5		
6		

PROJECT MANAGER:
 M. QUEOFF

DESIGNER:
 T. TISLAU

DRAWN BY:
 C. TEAFOE

EXPEDITOR:

SUPERVISOR:

PRELIMINARY NO:
 P21284

CONTRACT NO:

DATE:
 09.21.2021

SHEET:
A1.0