

**SURVEY NOTE:**  
THE EXISTING BOUNDARY & TOPOGRAPHIC SURVEY SHOWN HEREON WAS PROVIDED BY SEH, DATED AUGUST 2017.

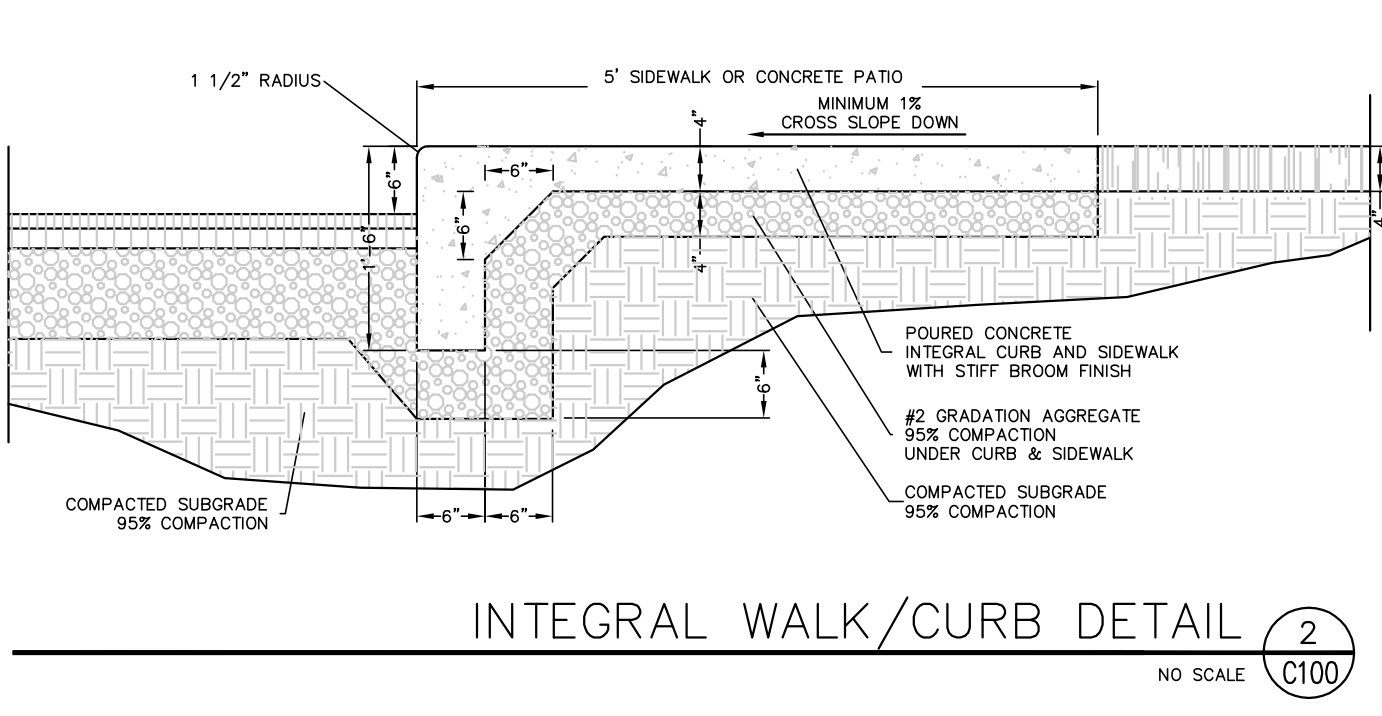
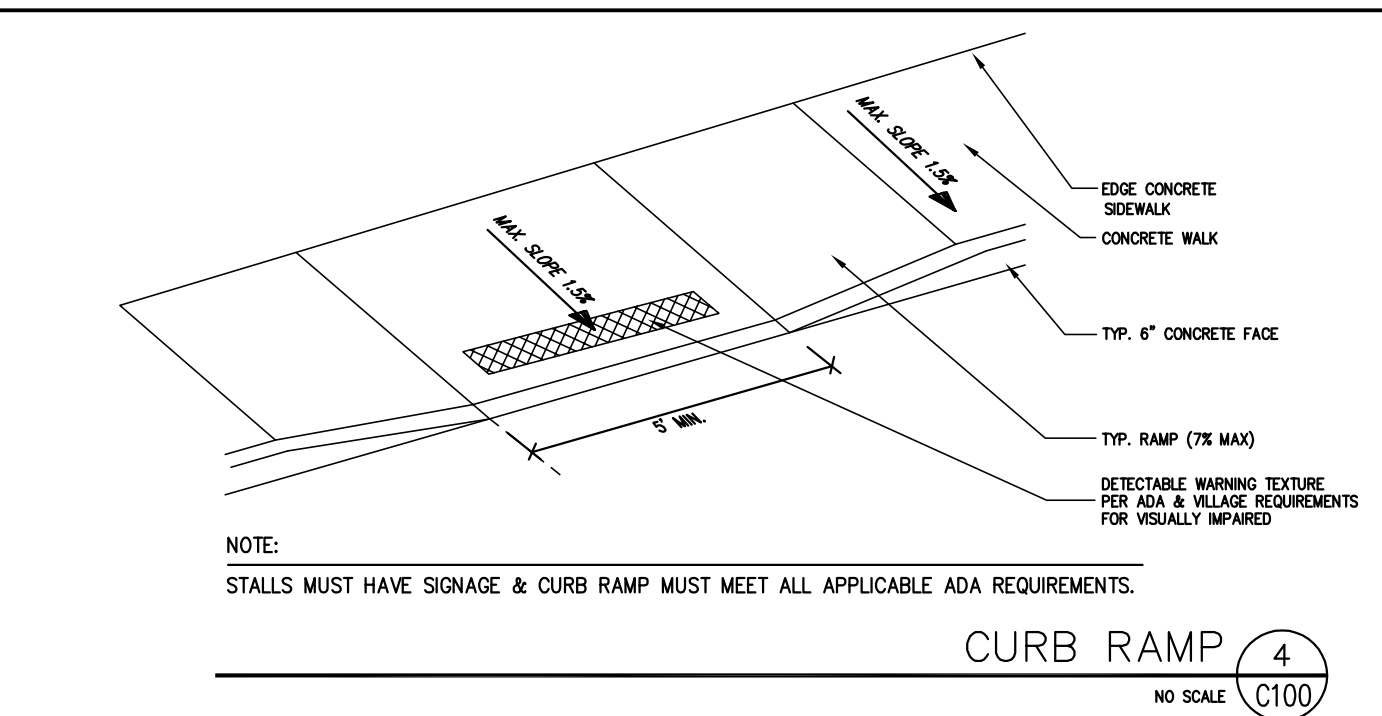
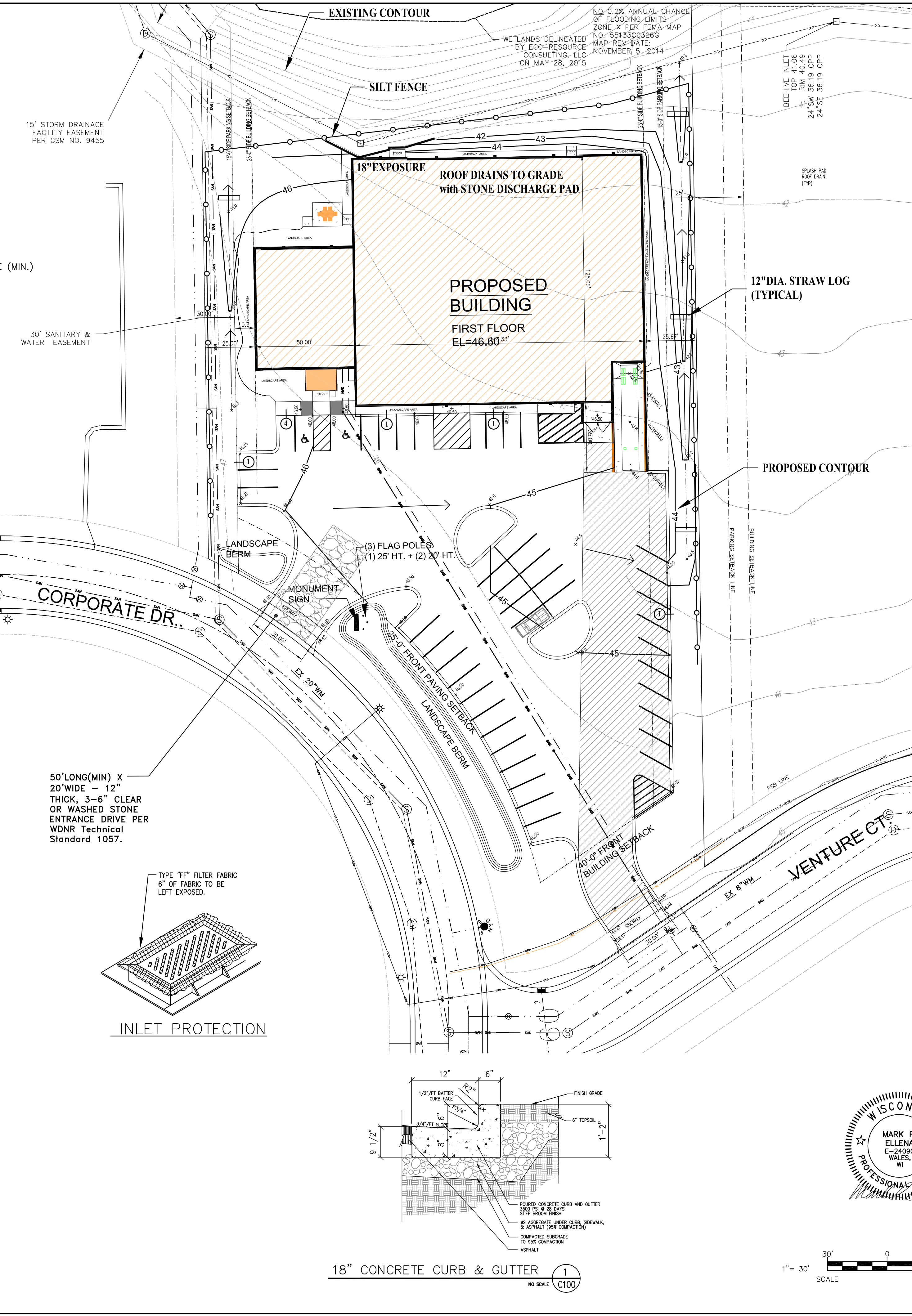

**CONSTRUCTION PHASING SEQUENCING:**  
THE CONTRACTOR MUST FOLLOW THE FOLLOWING CONSTRUCTION SEQUENCE AS REQUIRED BY THE WDNR AND THE CITY OF WAUKESHA.

1. INSTALL GRAVEL CONSTRUCTION ENTRANCE AS SHOWN ON THE PLAN (TRACKING PAD).
2. INSTALL SILT FENCE AND INLET PROTECTION IN ALL EXISTING INLETS ADJACENT TO SITE AND PROPOSED INLETS ON SITE. INLET PROTECTION SHALL BE IN ACCORDANCE WITH THE WDNR TECHNICAL STANDARD 1060 (TYPE B & D).
3. STRIP TOPSOIL FROM THE STRUCTURAL AREAS AND STOCKPILE AS SHOWN WITH SILT FENCE BOUNDARY. THE TOPSOIL PILE REQUIRES TEMPORARY STABILIZATION IF LEFT INACTIVE FOR MORE THAN 14 DAYS.
4. CONSTRUCT STORM SEWER AND SAN/WM LATERALS.
5. COMPLETE BUILDING, PARKING LOT, WALKS & LANDSCAPE AREAS.
6. TOPSOIL RE-VEGETATE AND STABILIZE ALL REMAINING DISTURBED AREAS.
7. AFTER ALL DISTURBED AREAS ARE WELL-ESTABLISHED AND FOLLOWING FINAL AS-BUILT ACCEPTANCE BY THE VILLAGE, REMOVE ALL SILT FENCE AND ANY OTHER TEMPORARY BMP'S.

**CONSTRUCTION SCHEDULE: START DATE: JUNE 2018  
COMPLETION DATE: NOVEMBER 2018**

NOTE: 2018 CITY STANDARD SPECIFICATIONS SHALL BE FOLLOWED FOR ALL WORK IN THE PUBLIC RIGHT OF WAY. LIMITS OF FINAL CITY STREET PAVEMENT AND CURB AND GUTTER REMOVAL AND REPLACEMENTS TO BE MARKED BY CITY ENGINEERING STAFF IN THE FIELD.

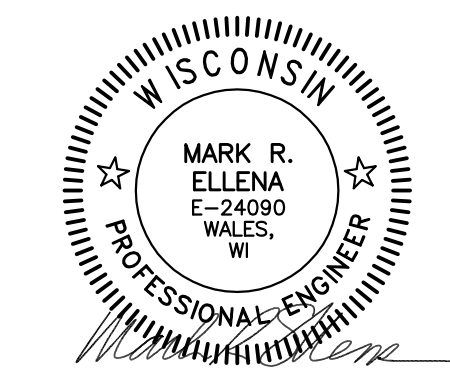
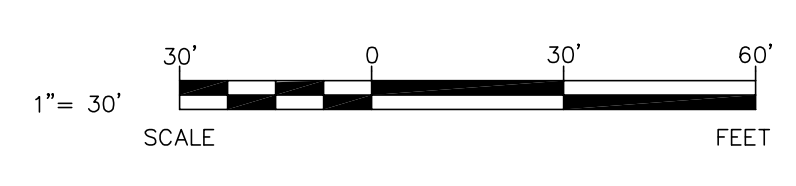
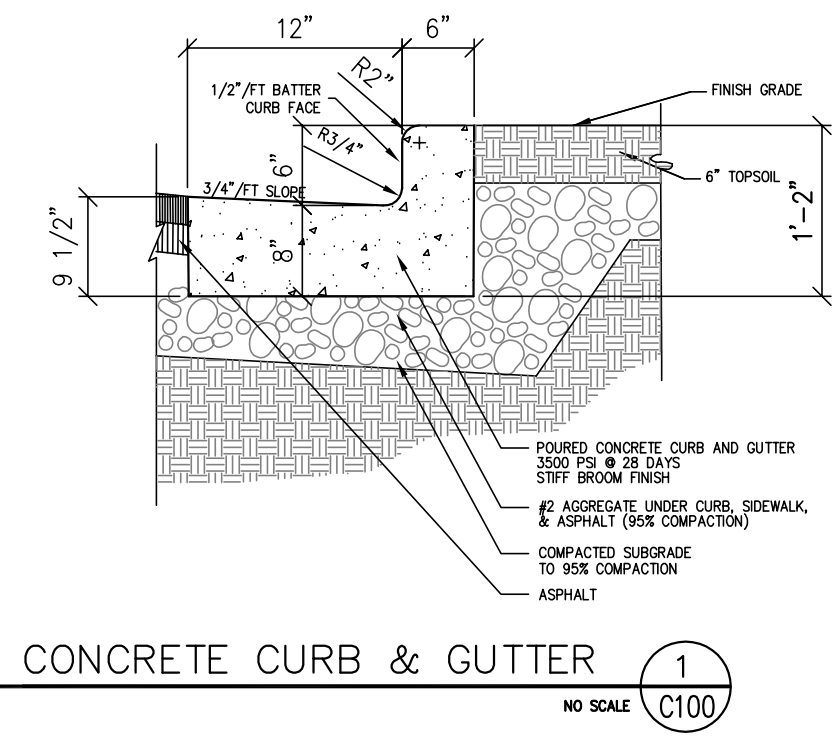
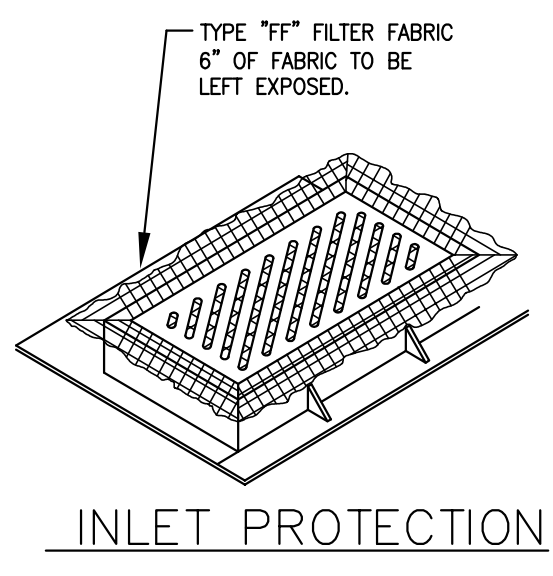

**ELLENA ENGINEERING CONSULTANTS, LLC**  
SITE CIVIL ENGINEERING & STORMWATER MANAGEMENT

Ellena Engineering Consultants, LLC • 700 Pilgrim Parkway - Suite 100 • Elm Grove, WI 53122  
Phone: 262-719-6183 • Fax: 866-457-2584 • Email: mellen@eoceng.com

**EROSION CONTROL & DETAIL PLAN**

**Keller**  
PLANNERS | ARCHITECTS | BUILDERS

**FOX CITIES**  
N216 State Road 55 P.O. Box 620  
Kaukauna, WI 54130  
PHONE (920) 766-5795 or 1-800-236-2534  
FAX (920) 766-5004

**MILWAUKEE**  
W177 N9856 Rivercrest Dr.  
Suite 104  
Germantown, WI 53022  
PHONE (262) 250-9710  
1-800-236-2534  
FAX (262) 250-9740

**WAUSAU**  
2620 Stewart Avenue  
Suite 314  
Wausau, WI 54401  
PHONE (715) 849-3141  
1-800-236-2534  
FAX (715) 849-3181

www.kellerbuilds.com

**PROPOSED FOR:**

**SOFTWATER**

**CITY OF WAUKESHA**

**"COPYRIGHT NOTICE"**  
This design, drawing and detail is the copyrighted property of KELLER, INC. No part hereof shall be copied, duplicated, distributed, disclosed or made available to anyone without the expressed written consent of KELLER, INC.

PROJECT MANAGER: J. DALLAS

ARCHITECT:

DRAWN BY:

EXPEDITOR:

SUPERVISOR:

PRELIMINARY NO:

CONTRACT NO:

DATE: 05-03-18

SHEET: C200