

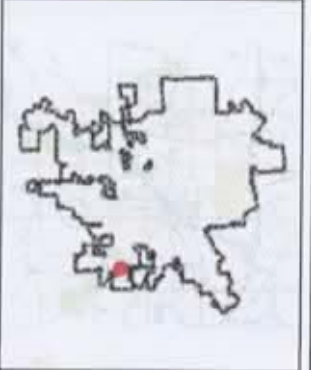

City of Waukesha Property Map



1: 1,248



- Legend**
- Parcels
 - City Limits
 - Railroads
 - Water Bodies
 - Landmarks**
 - Cemetery
 - County
 - Municipal
 - Hospital
 - Parks
 - School
 - State/federal

Notes:

This map is a user generated static output from an internet mapping site and is for reference only. The data found on this site is considered to be correct, but should not be used for engineering or survey applications without verifying the information from officially recorded sources.

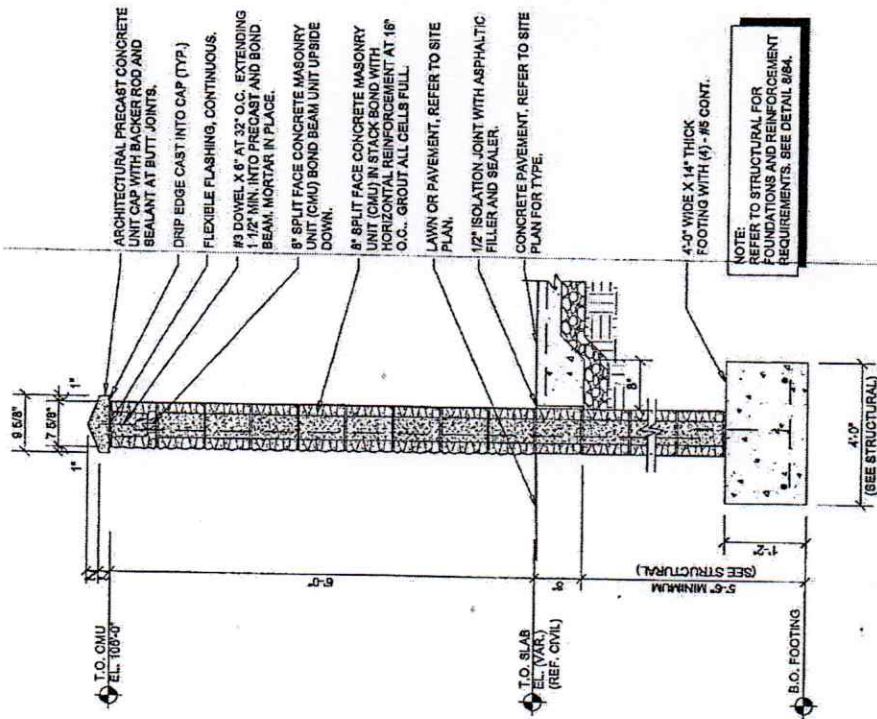

ARCHITECTURAL PRECAST CONCRETE UNIT CAP WITH BACKER ROD AND SEALANT AT BUTT JOINTS.

DRIP EDGE CAST INTO CAP (TYP.)

FLEXIBLE FLASHING, CONTINUOUS.

#3 DOWEL X 8" AT 32" O.C. EXTENDING 1 1/2" MIN. INTO PRECAST AND BOND BEAM. MORTAR IN PLACE.

8" SPLIT FACE CONCRETE MASONRY UNIT (CMU) BOND BEAM UNIT UPSIDE DOWN.

8" SPLIT FACE CONCRETE MASONRY UNIT (CMU) IN STACK BOND WITH HORIZONTAL REINFORCEMENT AT 16" O.C.. GROUT ALL CELLS FULL.

LAWN OR PAVEMENT, REFER TO SITE PLAN.

1/2" ISOLATION JOINT WITH ASPHALTIC FILLER AND SEALER.

CONCRETE PAVEMENT, REFER TO SITE PLAN FOR TYPE.

4-3" WIDE X 14" THICK FOOTING WITH (4) - #4 CONT.

NOTE:
REFER TO STRUCTURAL FOR FOUNDATIONS AND REINFORCEMENT REQUIREMENTS. SEE DETAIL 3/84.

2 MASONRY SCREEN FENCE SECTION

C2.3 SCALE 3/4" = 1'-0"

Crosscore Masonry

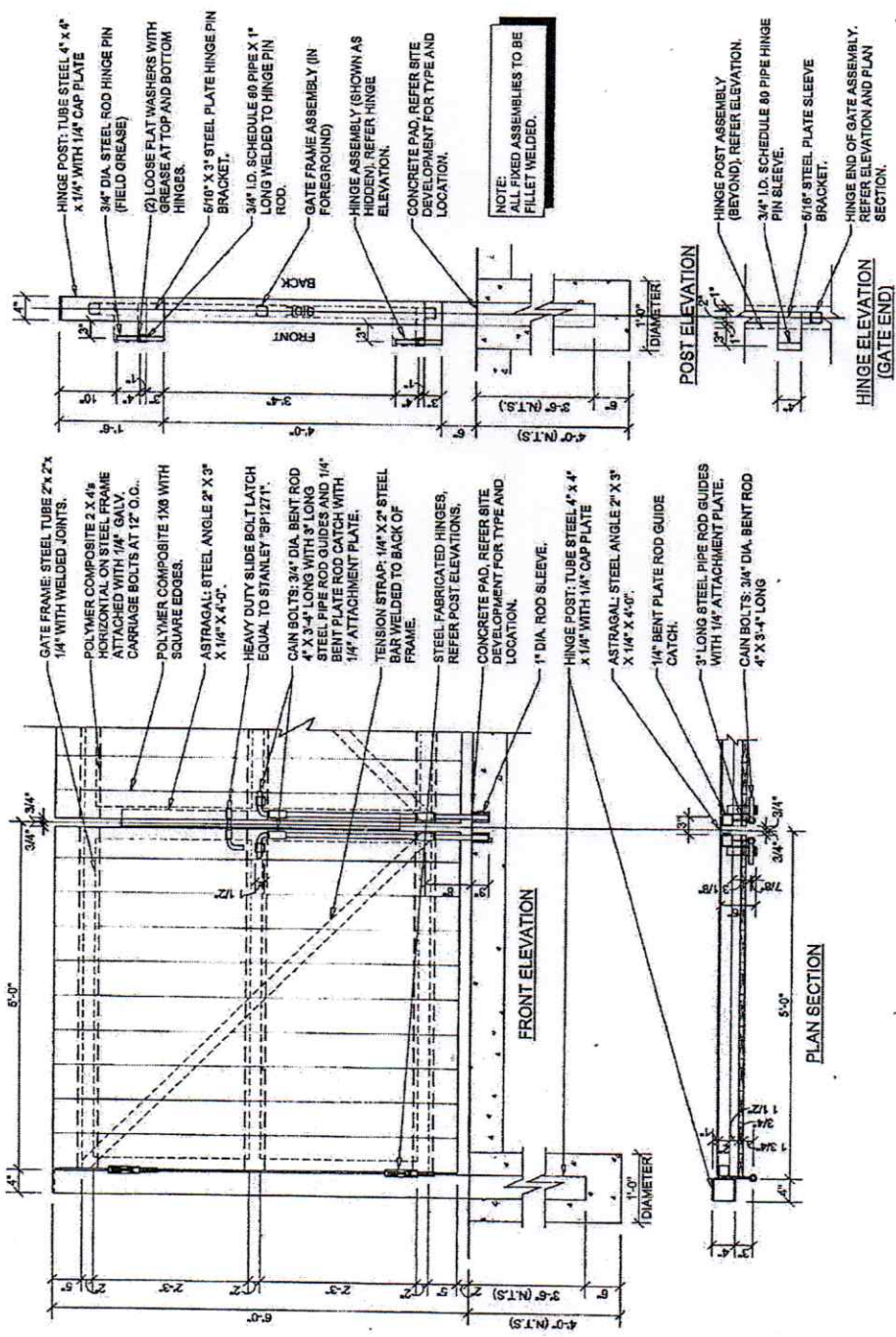

3 SCREEN FENCE GATE DETAILS

SCALE: 3/4" = 1'-0"

ms
 Masam work
 \$9500

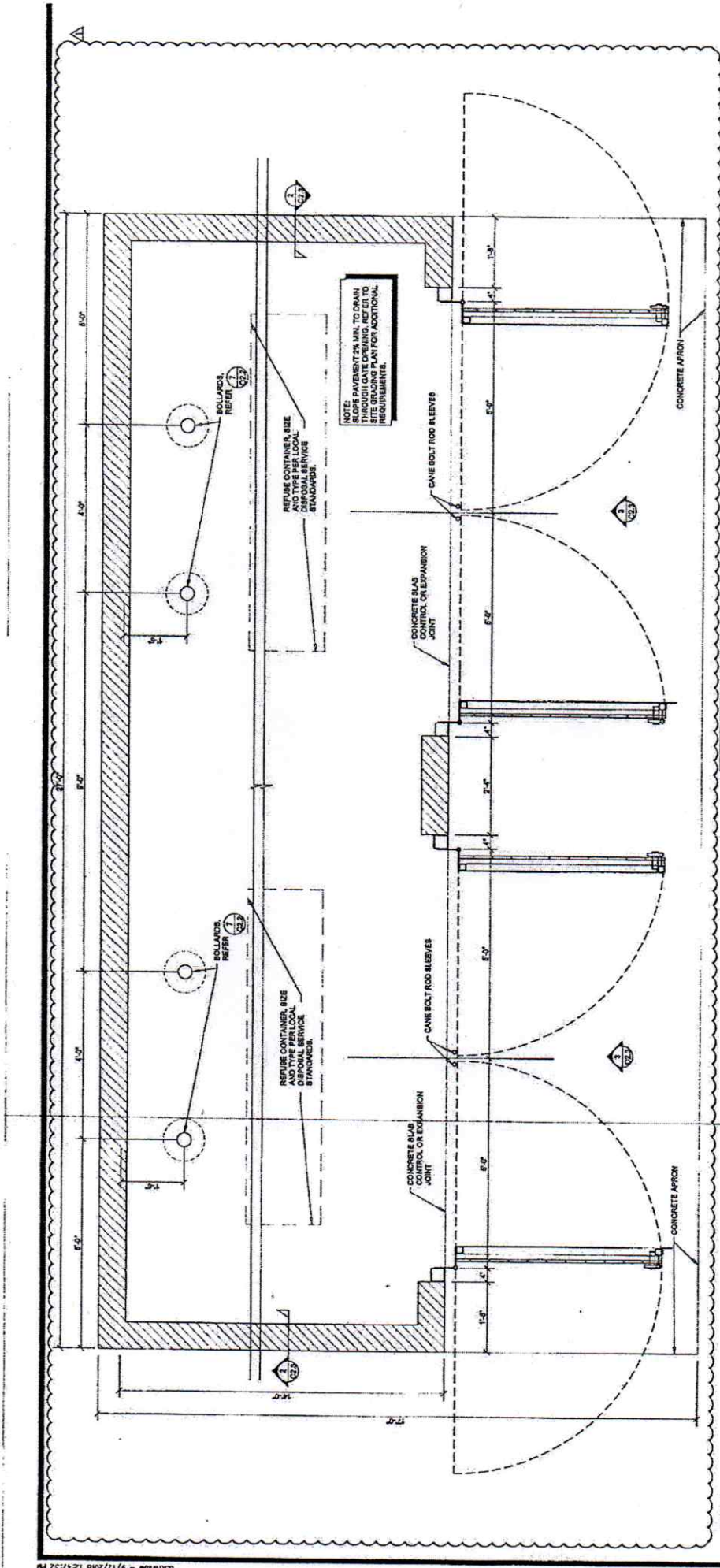

1 MASONRY SCREEN FENCE REFUSE ENCLOSURE PLAN

SCALE: 3/4" = 1'-0"

02.3

Crossed Masam





CROUSORE MASONRY LLC
1095 Meadow Drive
Silver Lake, WI 53170

crousoremasonry@gmail.com

PROPOSAL

DATE	PROPOSAL #
4/14/2020	13083

SUBMITTED TO:	JOB LOCATION:
Janice Wickman	Wyndwood Condos 1029 Guthrie Road Waukesha, WI
<i>WE HEREBY PROPOSE TO FURNISH :</i>	
	<i>TOTAL</i>
Labor & Material for new dumpster enclosure @ Wyndwood Condos as follows:	
Excavation for new dumpster enclosure. Backfill.	3,000.00
Concrete footings (2' X 12") with CMU (block) foundation. Bottom of footing to be 5' below top of floor. Poured 6" concrete floor with reinforcing mesh wire installed in floor & 4 steel bollards installed. Expansion joint to be installed between block & floor.	12,000.00
8" Split-face standard grey CMU enclosure with limestone cap. (Approximate dimension=26' X 14' X 6'4" high) Vertical reinforcement every 32" with grout & 1/2" rebar. Continuous flexible flashing @ top course.	9,500.00
(4) new gate doors (two doors for each opening) for masonry enclosure out of Slate Gray Azek maintenance free boards with green treated frame behind it. Hinges will be mounted to masonry posts.	2,500.00
5% discount	-1,350.00
***Removal of existing enclosure to be Time + Dumpster rental for debris removal. Time billed @ \$75/hour per man. Approximate cost = \$1,000.	
Option: Extra course of block to make overall height of 7' ... Add \$900. to proposed price	
30% Downpayment to start project. References gladly provided upon request.	
PAYMENT IN FULL DUE PROMPTLY UPON COMPLETION	TOTAL \$25,650.00

ACCEPTANCE OF PROPOSAL: The above prices, specifications and conditions are satisfactory and are hereby accepted. You are authorized to do the work as specified. Payment will be made as outlined above. All work per plan is subject to site verification. Any alteration or deviation from above specifications involving extra costs will become an extra charge over and above the estimate. Our workers are fully covered by Workmen's Compensation Insurance. All described work will be performed in best accordance of OSHA regulations. Balance not paid when due shall bear service charge of 1-1/2% per month (18% per year). Note: This proposal may be withdrawn by us if not accepted within 60 days.



Accepted by _____

Date _____