

THE BOUNDARY & TOPOGRAPHIC SURVEY WAS PROVIDED BY PLM. UNDERGROUND UTILITY INFORMATION AS SHOWN HEREON IS BASED, IN PART, UPON INFORMATION FURNISHED BY UTILITY COMPANIES AND THE LOCAL MUNICIPALITY. WHILE THIS INFORMATION IS BELIEVED TO BE RELIABLE, ITS ACCURACY AND COMPLETENESS CANNOT BE GUARANTEED NOR CERTIFIED TO.



PROPERTY LINE

PROPOSED ASPHALT PARKING LOT (13,000SF)  
SITE DISTURBANCE AREA (0.3 Ac)

PROPOSED LANDSCAPED BERM (4'-2" HIGH) SEE LANDSCAPING LEGEND FOR PLANTINGS

SILT FENCE LINE

NOTE:  
SILT FENCE AND TRACKING PAD SHALL CONFORM TO TECHNICAL STANDARDS 1056 & 1057 RESPECTIVELY.  
GENERAL CONTRACTOR IS RESPONSIBLE FOR INSPECTING AND MAINTAINING ALL EROSION CONTROL MEASURES SHOWN HEREON PURSUANT TO NR216 & NR215. AT A MINIMUM, INSPECTIONS SHALL BE PERFORMED WEEKLY AND WITHIN 24 HOURS OF EVERY 0.5 INCH RAINFALL EVENT. REPAIRS ARE REQUIRED WITHIN 24 HOURS OF DOCUMENTING ISSUE IN THE INSPECTION REPORT OR OTHERWISE NOTIFIED BY THE CITY.

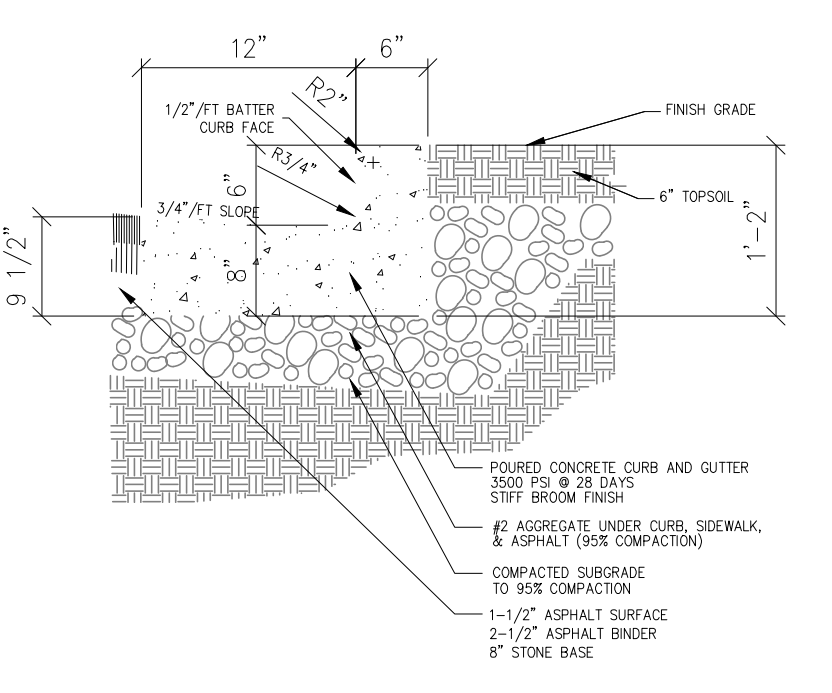

18" CONCRETE CURB & GUTTER  
1R = REJECT CURB  
NO SCALE  
C100

170'-8" HDPE @ S=0.5%

STORM SIZING CALCS:  
DA=13,170/32.5(pavmt)=405gpm  
[8" @ 0.5%-MIN]

EX PRIVATE STORM INLET  
RIM 50.98  
12"S 46.88  
CORE & GROUT  
8"N 46.90

TYPE D INLET PROTECTION

SITE PARKING ADDITION DATA TABLE		
PROPOSED PARKING AREA :	13,000 S.F.	REQUIRED
INTERIOR PARKING LOT LANDSCAPE AREA REQUIRED	650 S.F.	5% MINIMUM
INTERIOR PARKING LOT LANDSCAPE AREA PROVIDED	785 S.F.	--

**GENERAL SPECIFICATIONS FOR PRIVATE STORM SEWER:**  
1. All work shall be in accordance with the Standard Specifications for Highway and Structure Construction, State of Wisconsin, Latest Edition, and the City of Waukesha Ordinances and the State of Wisconsin Standard Specifications for Sewer and Water Construction in Wisconsin.  
2. The private storm sewer design, permitting, construction, installation, supervision, maintenance, inspection AND testing shall be in accordance with the City of Waukesha Plumbing Inspection Department and the State of Wisconsin, Chapter SPS 382. All permits must be obtained by the contractor prior to commencing work.  
3. Private Storm Sewers shall be PVC (solid wall), DR-26 OR HDPE, per the State of Wisconsin Plumbing Code, Chapter SPS 382. Storm inlets shall be precast concrete box structures in accordance with File No. 29 of the Standard Specifications for Sewer & Water Construction in Wisconsin with a Neenah No. R3227-C frame & grate or EQUAL.

**NOTE: NO WORK SHALL BE CONDUCTED IN THE PUBLIC RIGHT OF WAY.**  
**GENERAL CONSTRUCTION SPECIFICATIONS:**  
1. All work shall be in accordance with the Standard Specifications for Highway and Structure Construction, State of Wisconsin, Latest Edition, and the City of Waukesha Ordinances and the State of Wisconsin Standard Specifications for Sewer and Water Construction in Wisconsin and the design, construction, installation, supervision, maintenance and inspection of plumbing in accordance with State of Wisconsin, Chapter SPS 382. All permits must be obtained by the contractor prior to commencing work.  
2. All erosion control measures specified on the project Erosion Control Plan shall meet the design criteria, standards and specifications as set forth in the Department of Natural Resources Wisconsin Technical Standards.  
3. All erosion control devices (i.e., silt fence, gravel entrance, inlet protection, etc.) shall be installed prior to commencing mass grading or utility construction.  
4. All activities on the site shall be conducted in a logical sequence to minimize the area of bare soil exposed at any one time.  
5. The general contractor shall provide all surveying and construction staking for this contract. All contractors shall exercise care and diligence in protecting the same.  
6. The contractor shall notify Diggers Hotline, the local municipality and all government agencies that may be affected by the contractor's operations at least three (3) days before breaking ground. Diggers Hotline number is 811.  
7. Public roads shall not be closed to traffic at any time. All ingress and egress traffic to the project shall be limited to the legal entrance to the property.  
8. Contractor shall be responsible for maintaining the Public Roadways. The Public Roadways adjacent to this project shall be kept free of silt or dirt tracked from areas under construction by sweeping at the end of each work day or more often, as required. Dust generated by construction activities shall be minimized by use of watering, construction scheduling or other appropriate methods.  
9. Upon completion of the work as specified, respread four (4") inches of salvaged topsoil over all disturbed open space areas outside of the proposed roadway and provide seed, fertilizer and mulch per the Standard Specifications.  
10. All disturbed areas shall be revegetated within seven days of no disturbance. Highway mix #40 shall be used for seeding with an application rate of 4.0 lbs/1000 sf.  
11. All erosion control devices shall be routinely inspected every seven days or within 24 hours of a rainfall greater than 0.5 inches. (By GENERAL CONTRACTOR).  
12. If permanent seeding is not completed by September 15, apply temporary seeding. If temporary seeding is not completed by October 15, erosion control matting or other Village approved method shall be applied to inactive disturbed soils between October 15th and May 1st as a temporary soil stabilization measure during the non-growing season.

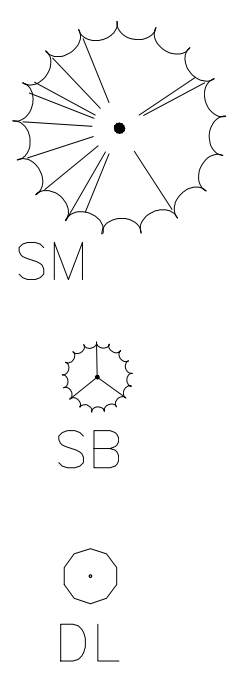

LANDSCAPING LEGEND:

KEY	COMMON NAME	QTY	SIZE	SPACING
SM	SUGAR MAPLE	4	2-1/2"	AS SHOWN
SB	SPIREA SHRUB	15	18-24"	AS SHOWN
DL	STELLA D'ORA DAYLILLY	10	N/A	AS SHOWN

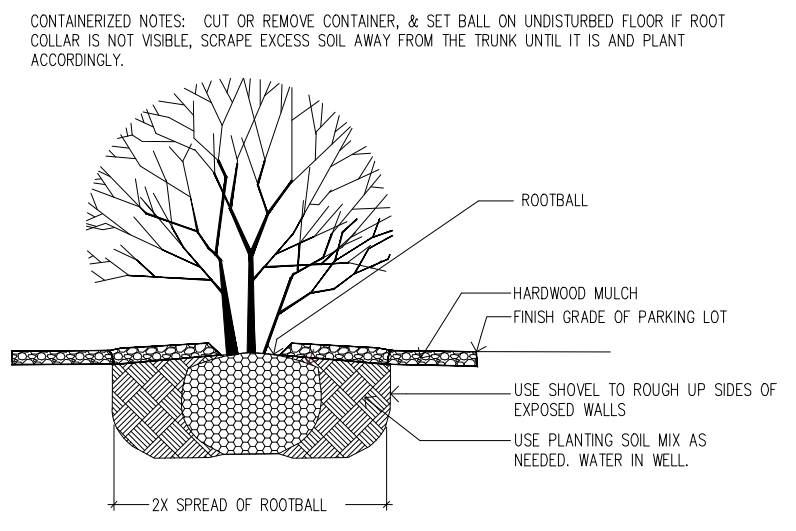

SHRUB PLANTING  
NTS

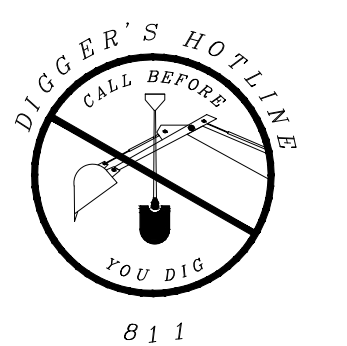

REVISIONS		DATE		DESC.	

**ELLENA ENGINEERING CONSULTANTS, LLC**  
SITE CIVIL ENGINEERING & STORMWATER MANAGEMENT  
Ellena Engineering Consultants, LLC • 700 Pilgrim Parkway • Suite 100 • Elm Grove, WI 53122  
Phone: 262-719-6183 • Fax: 866-457-2584 • Email: mellenae@eeceng.com

Ethnos360 Bible Institute  
915 N Hartwell Ave, Waukesha, Wisconsin

**PARKING LOT PLAN**

SCALE: 1"=20'      JOB NO.:      DATE: 06-22-20

CHECKED BY:      C1

NOTE: THIS PLAN MUST BE REVIEWED AND APPROVED BY THE CITY OF WAUKESHA. PLAT OF SURVEY AND STAKEOUT BY A REGISTERED LAND SURVEYOR AS REQUIRED TO ADHERE TO PLAN AND MEET SETBACKS SHOWN ON THE PLAN.

