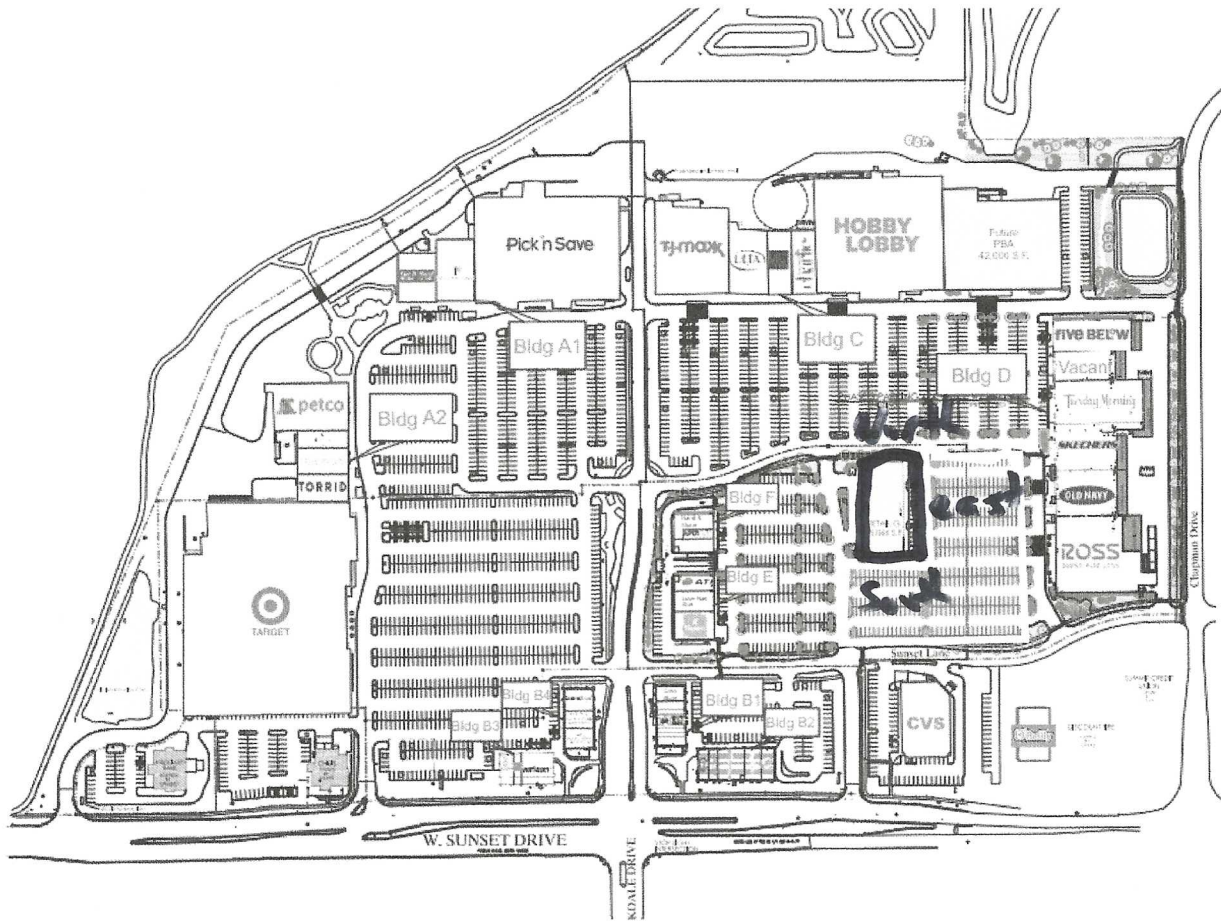

EXHIBIT A

Premises



Premises

Non-exclusive parking area

EXHIBIT C

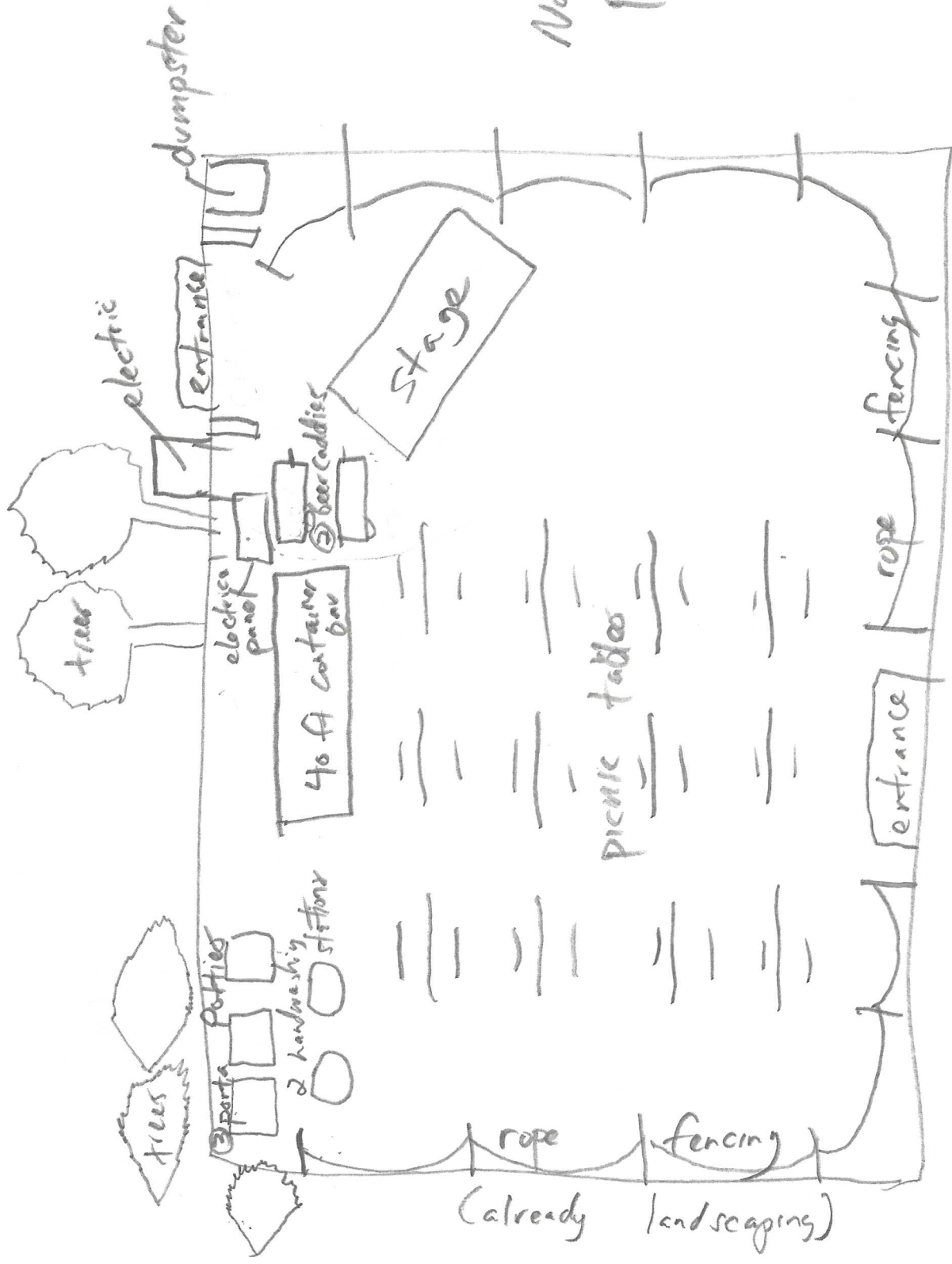

North parking

East parking

South parking

(already landscaping)

⊛ will be grading, and adding mulch



CITY OF WAUKESHA
DEPARTMENT OF COMMUNITY DEVELOPMENT
 City Hall, 201 Delafield Street, Room 200
 Waukesha, WI 53188
 Phone (262) 524-3750 Fax (262) 524-3751

CONDITIONAL USE PERMIT APPLICATION

This application must accompany a Plan Commission Application along with the required fee.
 The Plan Commission may not make a decision on this request if the property owner is not present at the meeting.

DATE: 2/9/2021

NEW APPLICATION

AMENDMENT TO EXISTING CONDITIONAL USE PERMIT

NAME OF PROJECT OR BUSINESS: The Tap Yard - Waukesha

LOCATION OF USE: 1166 West Sunset Drive

TYPE OF USE: Beer Garden

Is this a NEW use or is this use being relocated from somewhere else? New

If you are relocating a use, where are you relocating it from? _____

Do you operate a use in other locations? ? (Circle one) YES NO

If yes, please explain: will have 2 beer gardens in Milwaukee & Bayshore

Will the use be occupying an existing building or will you be building a new building? EXISTING NEW

Hours and days of operation: Wed: 4-9pm Thu: 4-9pm Fri: 4-10pm Sat: 11-10pm Sun: 11-9pm

Number of Employees: 8

Number of on-site parking stalls available: many

Length of permit requested (6 month, 1 year, 2 year, permanent): permanent (seasonal though) May - Oct 31

Current zoning: Commercial

Is a License required to operate this use? (Circle one) YES NO If yes, please attach a copy.

Name of licensing authority: _____

Will any hazardous materials be used? No

The following information must be attached to process the permit:

A site map showing the location of the proposed site.

A site plan showing the location of building(s), parking, landscaping, etc.

A floor plan of the building showing how it will be used for the proposed use.

N/A If an existing building, a photo of the building.

If new, complete development plans must be submitted per the development guidelines.

If facade changes are proposed, plans must be submitted showing changes.

A business plan if there is one; otherwise answer the questions on the back.

Please Note: If approved, this permit will be issued to the applicant only and will not be transferrable. This application will become null and void if required fees and materials are not submitted at time of application. Any physical changes made to the building may require the installation of additional fire protection systems. Please contact the Fire Marshal for further discussion.

Please attach a copy of your Business Plan if you have one.

If you do not have written Business Plan or choose not to share it, please answer the following questions:

1. What business will you be in? Beer garden
2. Explain your business' daily operations. on business plan
3. How will business be managed on a daily basis? Manager on premise at all times
4. What are your products or services? Beer, hard seltzer
5. Will your employees need additional parking? no
6. Are employees required to have any certification(s)? Yes Serusak
7. Who is the owner of the building or premises where your business will be conducted?
NICHOLAS Marking
8. If you are not owner of the building or premises where your business will be conducted, do you have a lease agreement with the owner? _____
9. Are there any insurance requirements for your business? Yes on lease
10. Will you have property insurance? Yes
11. Are there any noise considerations/concerns with your business operations?
Yes live music

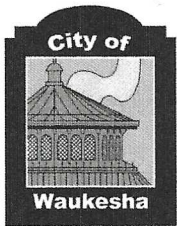

City of Waukesha Application for Development Review

Last Revision
Date:
Dec. 2019

City of Waukesha Community Development Department - 201 Delafield Street, Suite 200, Waukesha, WI 53188 262-524-3750
City of Waukesha Department of Public Works Engineering Division—130 Delafield Street, Waukesha, WI 53188 262-524-3600
www.waukesha-wi.gov

APPLICANT INFORMATION

Applicant Name: Michael Marking
Applicant Company Name: The Top Yard - Waukesha
Address: 8073 S River Lane
City, State: Franklin WI Zip: 53132
Phone: 773-220-3227
E-Mail: amarking@gmail.com

ARCHITECT/ENGINEER/SURVEYOR INFORMATION

Name: _____
Company Name: _____
Address: _____
City, State: _____ Zip: _____
Phone: _____
E-Mail: _____

PROPERTY OWNER INFORMATION

Applicant Name: Fox River LLC
Applicant Company Name: _____
Address: 160 W. Pond Drive Suite F
City, State: Walled Lake MI Zip: 48390
Phone: 248-960-7600
E-Mail: _____

PROJECT & PROPERTY INFORMATION

Project Name: The Top Yard - Waukesha
Property Address: 1166 W Sunset Drive
Tax Key Number(s): _____
Zoning: _____
Total Acreage: 13,800 square feet Existing Building Square Footage 0
Proposed Building/Addition Square Footage: _____
Current Use of Property: N/A

PROJECT SUMMARY (Please provide a brief project description.)

Bees Garden with container bee operating
May 1 - Oct 31 Wed - Sunday

All submittals require a complete scaled set of digital plans (Adobe PDF) and shall include a project location map showing a 1/2 mile radius, a COLOR landscape plan, COLOR building elevation plans, and exterior lighting photometric maps and cut sheets. A pre-application meeting is required prior to submittal of any applications for Subdivisions, Planned Unit Developments, and Site and Architectural Plan Review. **The deadline for all applications requiring Plan Commission Reviews is Monday at 4:00 P.M, 30 days prior to the meeting date. The Plan Commission meets the Fourth Wednesday of each month.**

APPLICATION ACKNOWLEDGEMENT AND SIGNATURES

I hereby certify that I have reviewed the City of Waukesha Development Handbook, City Ordinances, Submittal Requirements and Checklists and have provided one PDF of all required information. Any missing or incomplete information may result in a delay of the review of your application. By signing this I also authorize The City of Waukesha or its agents to enter upon the property for the purpose of reviewing this application.

Applicant Signature: [Signature]
Applicant Name (Please Print): Michael E Marking
Date: 2/9/2021

For Internal Use Only:

Amount Due (total from page 2): _____ Amount Paid: _____ Check #: _____
Trakit ID(s) _____ Date Paid: _____

City of Waukesha Application for Development Review

TYPE OF APPLICATION & FEES (CHECK ALL THAT APPLY) Please note that each application type has different submittal requirements. Detailed submittal checklists can be found in Appendix A of the Development Handbook.

FEES

- Plan Commission Consultation **\$200** _____
- Traffic Impact Analysis _____
 - Commercial, Industrial, Institutional, and Other Non-Residential **\$480**
 - Residential Subdivision or Multi-Family **\$480**
 - Resubmittal (3rd and all subsequent submittals) **\$480**

ONE OF THE THREE FOLLOWING ITEMS IS REQUIRED FOR SITE PLAN & ARCHITECTURAL REVIEWS (*):

- * **Preliminary Site Plan & Architectural Review** _____
 - Level 1: Buildings/additions less than 10,000 sq.ft. or sites less than 1 acre **\$2,200**
 - Level 2: Buildings/additions between 10,001-50,000 sq.ft. or sites between 1.01 and 10 acres **\$2,320**
 - Level 3: Buildings/additions between 50,001-100,000 sq.ft. or sites between 10.01 and 25 acres **\$2,440**
 - Level 4: Buildings/additions over 100,001 sq.ft. or sites greater than 25.01 acres. **\$2,560**
 - Resubmittal Fees (after 2 permitted reviews) **\$750**
- * **Final Site Plan & Architectural Review** _____
 - Level 1: Buildings/additions less than 10,000 sq.ft. or sites less than 1 acre **\$1,320**
 - Level 2: Buildings/additions between 10,001-50,000 sq.ft. or sites between 1.01 and 10 acres **\$1,440**
 - Level 3: Buildings/additions between 50,001-100,000 sq.ft. or sites between 10.01 and 25 acres **\$1,560**
 - Level 4: Buildings/additions over 100,001 sq.ft. or sites greater than 25.01 acres. **\$1,680**
 - Resubmittal Fees (3rd and all subsequent submittals) **\$750**
- * **Minor Site Plan & Architectural Review (total site disturbance UNDER 3,000 total square feet)** _____
 - Projects that do not require site development plans **\$330**
 - Resubmittal Fees (3rd and all subsequent submittals) **\$330**
- Certified Survey Map (CSM) _____
 - 1-3 Lots **\$500**
 - 4 lots or more **\$560**
 - Resubmittal (3rd and all subsequent submittals) **\$180**
 - Extra-territorial CSM **\$260**
- Preliminary Subdivision Plat (Preliminary Site Plan Review is also required.) _____
 - Up to 12 lots **\$1,270**
 - 13 to 32 lots **\$1,390**
 - 36 lots or more **\$1,510**
 - Resubmittal (3rd and all subsequent submittals) **\$630**
- Final Subdivision Plat (Final Site Plan Review is also required.) _____
 - Up to 12 lots **\$660**
 - 13 to 32 lots **\$780**
 - 36 lots or more **\$900**
 - Resubmittal (3rd and all subsequent submittals) **\$480**
 - Extra-territorial Plat **\$540**
- Rezoning and/or Land Use Plan Amendment _____
 - Rezoning **\$630**
 - Land Use Plan Amendment: **\$630**
- Conditional Use Permit
 - Conditional Use Permit with no site plan changes **\$480**
 - Conditional Use Permit with site plan changes **\$480** plus applicable preliminary and final site plan fees above 480
- Planned Unit Development or Developer's Agreement (Site Plan Review is also required) _____
 - New Planned Unit Development or Developer's Agreement **\$1,760**
 - Planned Unit Development or Developer's Agreement Amendment **\$610**
- Annexation **NO CHARGE**
- House/Building Move **\$150**
- Street or Alley Vacations **\$150**

TOTAL APPLICATION FEES:

\$ 480