

SEE SHEET 6-2-A

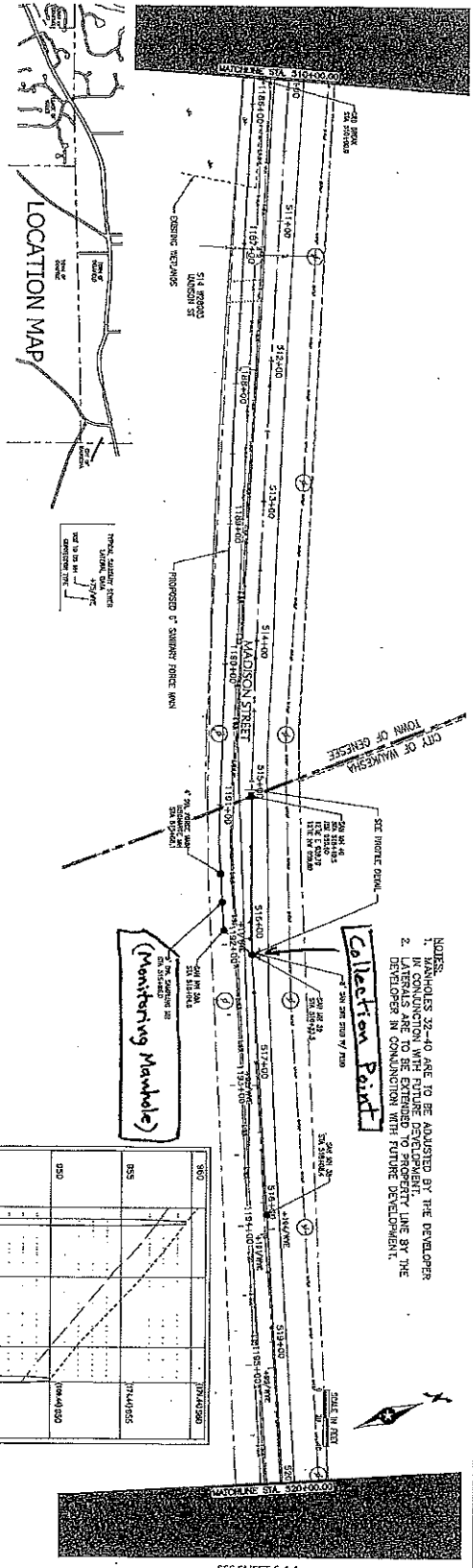

SEE SHEET 6-4-A

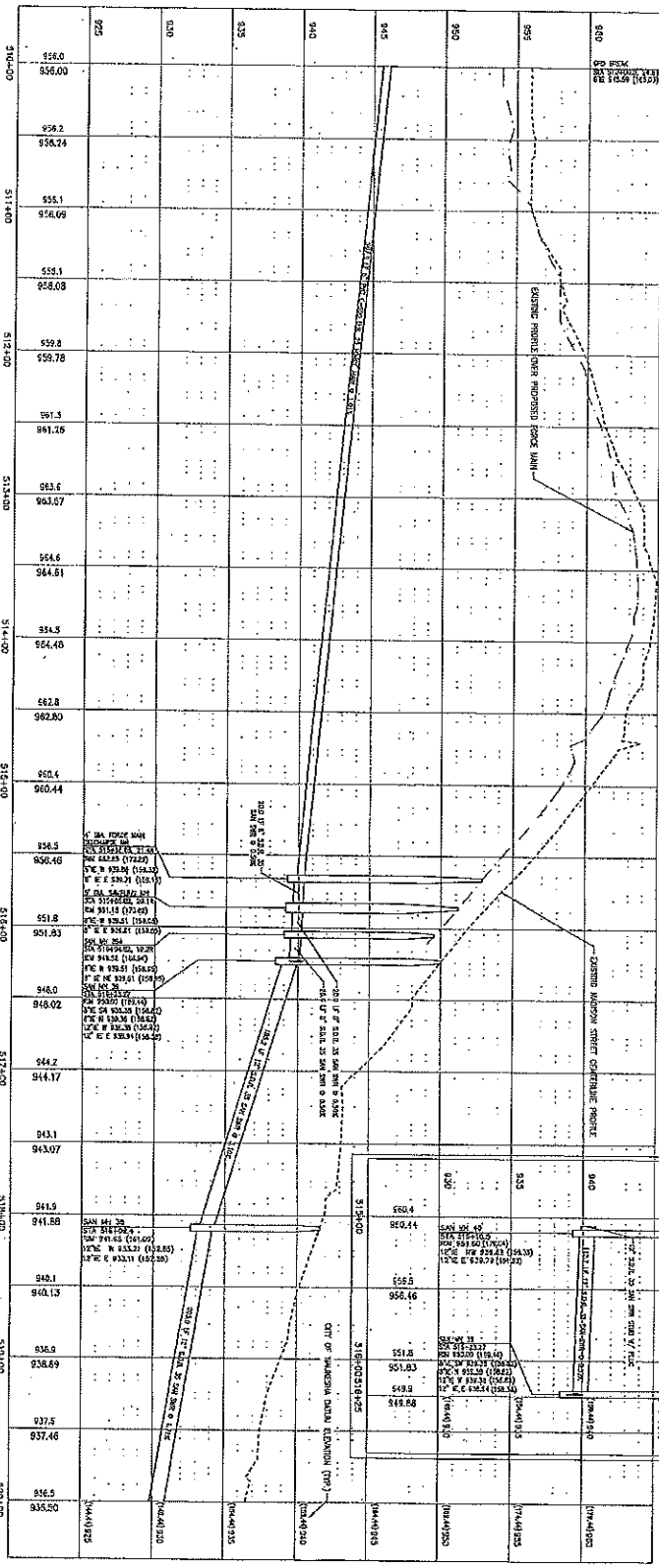
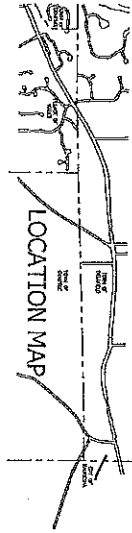

- NOTES:
1. MANHOLES 32-40 ARE TO BE ADJUSTED BY THE DEVELOPER IN CONJUNCTION WITH FUTURE DEVELOPMENT.
 2. THE COVER FOR THE COLLECTION POINT LINE BY THE DEVELOPER IN CONJUNCTION WITH FUTURE DEVELOPMENT.

VILLAGE OF WALES SAN SWR & FORCE MAIN PROJECT
 MADISON ST - PHASE 6 - ALTERNATE
 VILLAGE OF WALES, WISCONSIN
 MADISON ST STA. 510+00 TO STA. 520+00

GREEN TIER
 ENGINEERING • ARCHITECTURE
 PLANNING • SERVICES
 311 MARKET AVENUE
 DEARBORN, WISCONSIN 53007
 WWW.GREENTIER.COM



PROJECT NUMBER	2011150
DATE	JUNE 2015
DRAWN BY	PA
CHECKED BY	S. J. DUBOIS / J. DUBOIS
DESIGNED BY	REVISION
SHEET NUMBER	
6-3-A	