

TDI ASSOCIATES, INC.
ARCHITECTS, ENGINEERS, PLANNERS

N8 W22350 JOHNSON DRIVE, SUITE B4
WAUKESHA, WISCONSIN 53186
PHONE 262-437-0400 FAX 262-437-0401

Venture
DEVELOPMENT

General Contractor
1930-D Bluemound Road
Waukesha, WI 53186
Phone: (262) 524-6000
Fax: (262) 524-6001

MARINE BANK / 4 PIS IN A POD

1930-D WEST BLUEMOUND ROAD
WAUKESHA, WISCONSIN

TDI ASSOCIATES, INC
All Rights Reserved

OWNERSHIP OF DOCUMENTS

This document, and the ideas and design incorporated herein, as an instrument of professional service, is the sole property of TDI Associates, Inc., and is not to be used in whole or in part for any other project or purpose without the expressed written authorization of TDI Associates, Inc.

Sheet Title
DEMO PLAN

Issued For:	Date:
PERMIT SET	04-01-2010
CONST. SET	04-27-2010

Date: **08-25-2010**

Job NO.: **02-457.003**

Drawn By: **RJH**

Sheet No.

A1.0

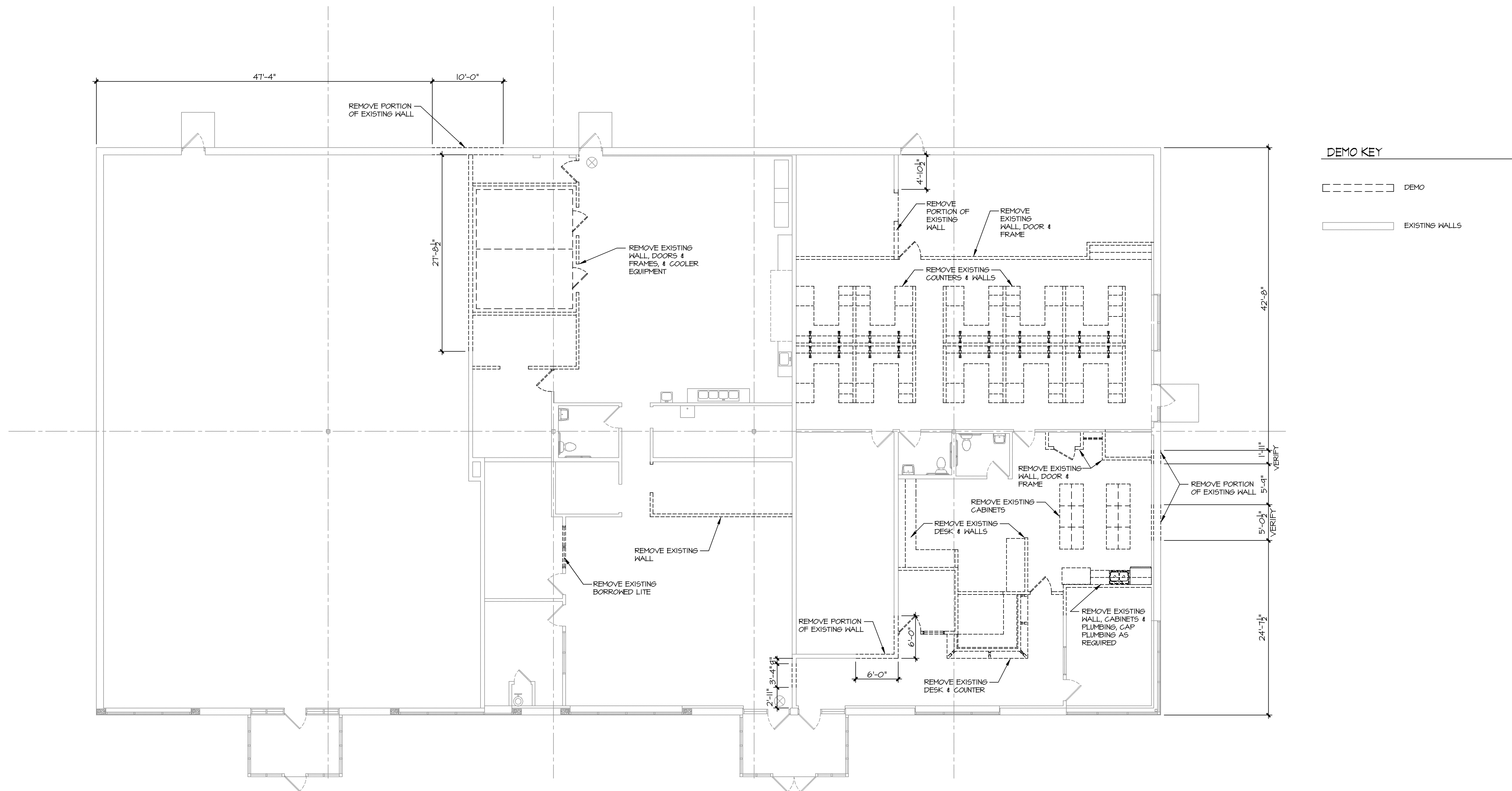

DEMO PLAN
1/8"=1'-0"

