

LEGEND

- PROPOSED ASPHALT PAVEMENT
- PROPOSED CONCRETE PAVEMENT
- PROPOSED CONCRETE SIDEWALK
- PROPOSED CONCRETE CURB AND GUTTER
- PROPOSED HIGHSIDE CONCRETE CURB AND GUTTER
- PROPOSED HIGHSIDE FLUSH CONCRETE CURB AND GUTTER
- PROPOSED FLUSH CONCRETE CURB AND GUTTER

GENERAL NOTES

1. THE BASE SURVEY WAS PREPARED BY JAHNKE & JAHNKE ASSOCIATES, INC. EXISTING CONDITIONS HAVE CHANGED SINCE THE INITIAL JAHNKE & JAHNKE SURVEY. ADDITIONAL SYMBOLS AND FEATURES HAVE BEEN ADDED TO REPRESENT APPROXIMATE EXISTING CONDITIONS. ALL UNDERGROUND UTILITIES AND STRUCTURES HAVE BEEN SHOWN TO A REASONABLE DEGREE OF ACCURACY AND IT SHALL BE THE CONTRACTOR'S RESPONSIBILITY TO VERIFY THEIR EXACT LOCATION AND TO AVOID DAMAGE THERETO.
2. REFER TO JAHNKE & JAHNKE ASSOCIATES, INC. SURVEY FOR BENCHMARKS, DATUM, AND TOPOGRAPHIC ELEMENTS.
3. CONTRACTOR SHALL VERIFY LOCATION OF WORK AND REPORT ANY DISCREPANCIES TO THE ENGINEER PRIOR TO COMMENCING WORK.

LAYOUT NOTES

1. THE BUILDING OUTLINES SHOWN ARE FOR REFERENCE PURPOSES ONLY AND SHALL NOT BE USED FOR STAKING PURPOSES. THE CONTRACTOR SHALL COORDINATE WITH THE ARCHITECT AND STRUCTURAL ENGINEER ON THE STAKING OF THE BUILDING.
2. ALL DIMENSIONS SHOWN ARE TO THE EDGE OF PAVEMENT OR FACE OF CURB WHERE CONCRETE CURB IS SHOWN.
3. STANDARD CURB RADIUS IS 5' UNLESS INDICATED OTHERWISE.
4. ALL PAVEMENT STRIPING SHALL BE YELLOW IN COLOR UNLESS OTHERWISE NOTED.
5. REFER TO LANDSCAPING PLANS FOR SITE RESTORATION INFORMATION AND DETAILS.
6. CONTRACTOR SHALL SUBMIT A CONCRETE JOINTING PLAN TO THE ENGINEER FOR REVIEW AND APPROVAL PRIOR TO COMMENCING CONSTRUCTION. JOINTING PLAN SHALL INDICATE: FOUR SEQUENCE, LOCATION OF CONSTRUCTION, ISOLATION, CONTRACTION JOINTS, AND TYPE OF REINFORCEMENT.
7. BLOCK RETAINING WALLS SHALL BE "RECON BLOCK", AS SPECIFIED. COLOR SHALL BE SELECTED BY ARCHITECT AND OWNER. WALL ENGINEER TO COORDINATE WALL DESIGN WITH INSTALLATION OF PROPOSED GUARDRAIL.
8. WALL CONTRACTOR AND DESIGN ENGINEER SHALL PROVIDE ALTERNATIVE FOR RECON BLOCK WALL TO INCLUDE PROPRIETARY VEHICLE GUARDRAIL SYSTEM IN LIEU OF WOOD RAIL SYSTEM.

PROJECT INFORMATION

WAUKESHA MEMORIAL HOSPITAL - NORTH WING RENOVATIONS

725 AMERICAN AVENUE, WAUKESHA, WI 53188

GRÄEF

ISSUANCE AND REVISIONS

DATE	DESCRIPTION
12/20/2018	PLAN COMMISSION SUBMITTAL

KEY PLAN

SHEET INFORMATION

PROGRESS DOCUMENTS NOT FOR CONSTRUCTION

These documents reflect progress and intent and may be subject to change, including additional detail. These are not final construction documents and shall not be used for final bidding or construction-related purposes.

PROJECT MANAGER

PROJECT NUMBER 418190

DETAILED SITE LAYOUT PLAN

C200

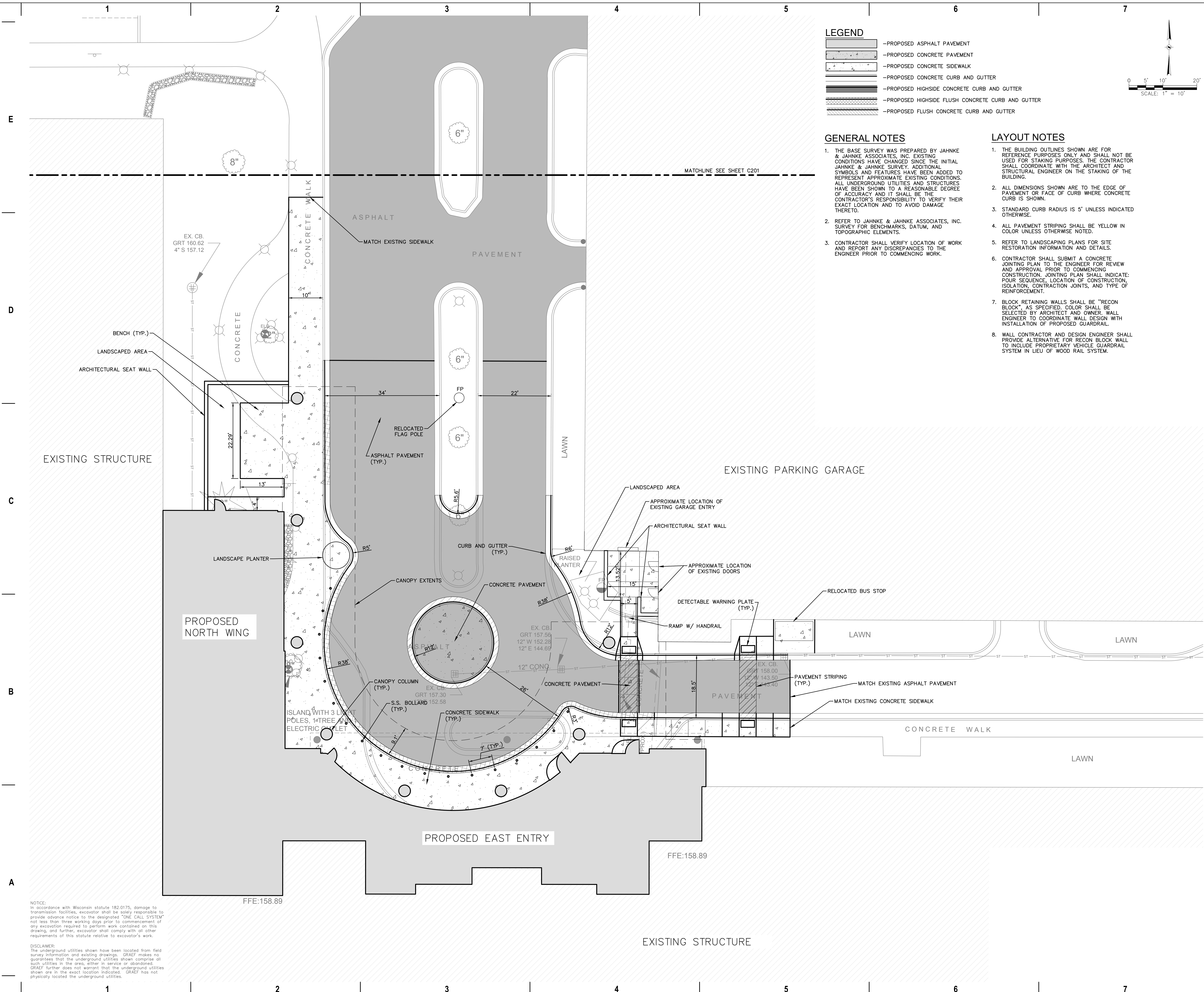

NOTICE:
In accordance with Wisconsin statute 182.0175, damage to transmission facilities, excavator shall be solely responsible to provide advance notice to the designated "ONE CALL SYSTEM" not less than three working days prior to commencement of any excavation required to perform work contained on this drawing, and further, excavator shall comply with all other requirements of this statute relative to excavator's work.

DISCLAIMER:
The underground utilities shown have been located from field survey information and existing drawings. GRAEF makes no guarantee that the underground utilities shown comprise all such utilities in the area, either in service or abandoned. GRAEF further does not warrant that the underground utilities shown are in the exact location indicated. GRAEF has not physically located the underground utilities.

X:\ML\2018\20180420\CAD\Site\dwg\00C_00_C200_Layout_420 12/19/2018 4:49 PM