

DESCRIPTION

The Prevail™ LED pole and fixture combination makes selection and installation of poles and fixtures simple. Included is the die-cast Prevail area, site and roadway luminaire with standard mounting arm, square straight steel pole, anchor bolts, base cover, template and hardware. Stock configurations are available in single and dual fixture combinations. The Prevail luminaire delivers a new level of versatility and value in patent pending, architectural design that delivers energy savings greater than 62% and replaces 150-400W metal halide fixtures. The Prevail fixture and pole combo is ideal for general area/site lighting applications.

SPECIFICATION FEATURES

Construction

Construction is comprised of a heavy-duty, single-piece die-cast aluminum housing in dark bronze polyester powder paint. The die-cast aluminum door is tethered to provide easy access to the driver if replacement is required. The optics is mounted on a versatile, aluminum plate that dissipates heat from the LEDs resulting in longer life of the fixture. The fixture is IP66 and 3G vibration rated (ANSI C136.31).

Optics

Available in Type III and IV distributions with lumen packages ranging from 6,173 to 15,203 nominal lumens. Light engine configurations consist of 1 or 2 high-efficacy LEDs mounted to metal-core circuit boards to maximize heat dissipation and promote long life (up to L92/60,000 hours at 25°C) per IESNA TM-21. For the ultimate level of spill light control, an optional house side shield accessory can be field or factory installed.

Electrical

Available in 120-277V 50/60Hz. 10kV/10kA surge protection standard. 0-10V dimming driver is standard with leads external to the fixture to accommodate controls capability such as dimming and occupancy. Suitable for ambient temperatures from -40°C to 40°C.

Controls

An integrated dimming and occupancy sensor is available in bi-level dimming (MSP/DIM) operation.

Mounting

The versatile, patent pending, standard mount arm accommodates multiple drill patterns ranging from 1-1/2" to 4-7/8". Removal of the door on the standard mounting arm enables wiring of the fixture without having to access the driver compartment. A knock-out on the standard mounting arm enables round pole mounting.

Catalog #		Type
Project		
Comments		Date
Prepared by		

Pole

Shaft is one-piece construction ASTM A500 grade "B" steel, shot blasted and finished in dark bronze polyester powder coat. Anchor base is fabricated from ASTM grade steel. ASTM A366 steel full base cover is provided to enclose base plate and anchor bolts. Anchor bolts are per ASTM A576 with two nuts, two flat washers, and one lock washer. Hardware and threaded portion of bolt are hot dip galvanized. 3" hook for 3/4" bolt. 4" hook for 1" bolt.

Finish

Housing and cast parts finished in five-stage super TGIC polyester bronze powder coat paint, 2.5 mil nominal thickness for superior protection against fade and wear.

Warranty

Five-year warranty.



PFPRV PREVAIL POLE AND FIXTURE COMBO

LED

POLE AND FIXTURE COMBO

DIMENSIONS

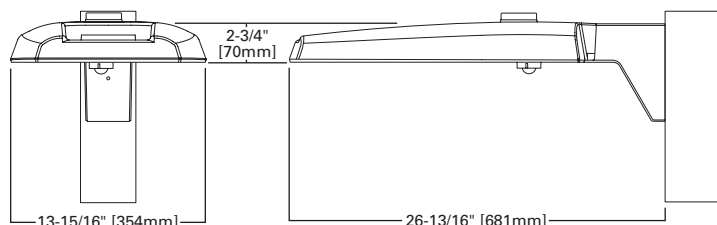

POLE MOUNT ARM

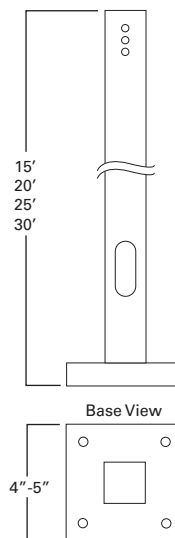
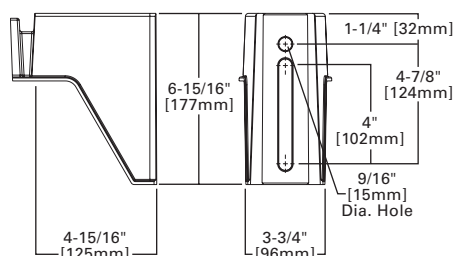

CERTIFICATION DATA

UL and cUL Wet Location Listed
IP66-Rated
3G Vibration Rated
ISO 9001
DesignLights Consortium™ Qualified*

ENERGY DATA

Electronic LED Driver
0.9 Power Factor
<20% Total Harmonic Distortion
120-277V/50 and 60Hz,
347V/60Hz, 480V/60Hz
-40°C Minimum Temperature Rating
+40°C Ambient Temperature Rating

EPA

Effective Projected Area (Sq. Ft.): 0.75
(1 fixture)

SHIPPING DATA

Approximate Net Weight:
20lbs. [9.09 kgs.] (1 fixture)

ORDERING INFORMATION

Sample Number: PFPRV-1-A25-T3-15-N/AB

Series ^{1,2,3}	Number of Fixtures	Light Engine	Distribution	Pole Height	Maximum Wind Zone (MPH)	Options (Add as Suffix)	Accessories (Order Separately)
PFPRV=Prevail Pole and Fixture Combo	1=1 2=2 3=3 4=4	A15=(1 LED) 6,100 Nominal Lumens A25=(2 LED) 10,200 Nominal Lumens A40=(2 LED) 15,100 Nominal Lumens	T3=Type III T4=Type IV	15=15' 20=20' 25=25' 30=30'	Blank=80 9=90 0=100	N/AB=No Anchor Bolts (Used when ordered separately) HSS=House Side Shield	HS/VERD=House Side Shield MSP/DIM-L12=Integrated Sensor for Dimming Operation, 8' - 12' Mounting Height MSP/DIM-L30=Integrated Sensor for Dimming Operation, 12' - 30' Mounting Height PER=NEMA 3PIN Twistlock Photocontrol Receptacle ⁴ PER7=NEMA 7PIN Twistlock Photocontrol Receptacle ⁴

NOTES: 1 4000K CCT, standard bronze, 120-277V, 0-10V dimming. 2 Standard mount arm included with fixture. Supplied with straight steel shaft, anchor bolts, template, base cover and hardware. 3 DesignLights Consortium™ Qualified and classified for both DLC standard and DLC Premium, refer to www.designlights.org for details. 4 Not available with MSP options.

ONE FIXTURE CONFIGURATION

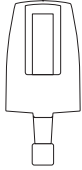
	Mounting Height (Feet)	Lumens (Nominal)	Distribution	Maximum Wind Zone (MPH)			HID Equivalent (Wattage)
				80	90	100	
 <p>EPA=0.75</p>	15'	6,192	Type III	PFPRV-1-A15-T3-15 ²	PFPRV-1-A15-T3-15-9 ²	PFPRV-1-A15-T3-15-0 ²	150W
		6,173	Type IV	PFPRV-1-A15-T4-15 ²	PFPRV-1-A15-T4-15-9 ²	PFPRV-1-A15-T4-15-0 ²	150W
		10,292	Type III	PFPRV-1-A25-T3-15 ²	PFPRV-1-A25-T3-15-9 ²	PFPRV-1-A25-T3-15-0 ²	250W
		10,261	Type IV	PFPRV-1-A25-T4-15 ²	PFPRV-1-A25-T4-15-9 ²	PFPRV-1-A25-T4-15-0 ²	250W
		15,203	Type III	PFPRV-1-A40-T3-15 ²	PFPRV-1-A40-T3-15-9 ²	PFPRV-1-A40-T3-15-0 ²	400W
		15,157	Type IV	PFPRV-1-A40-T4-15 ²	PFPRV-1-A40-T4-15-9 ²	PFPRV-1-A40-T4-15-0 ²	400W
	20'	6,192	Type III	PFPRV-1-A15-T3-20 ²	PFPRV-1-A15-T3-20-9 ²	PFPRV-1-A15-T3-20-0 ²	150W
		6,173	Type IV	PFPRV-1-A15-T4-20 ²	PFPRV-1-A15-T4-20-9 ²	PFPRV-1-A15-T4-20-0 ²	150W
		10,292	Type III	PFPRV-1-A25-T3-20 ²	PFPRV-1-A25-T3-20-9 ²	PFPRV-1-A25-T3-20-0 ²	250W
		10,261	Type IV	PFPRV-1-A25-T4-20 ²	PFPRV-1-A25-T4-20-9 ²	PFPRV-1-A25-T4-20-0 ²	250W
		15,203	Type III	PFPRV-1-A40-T3-20 ²	PFPRV-1-A40-T3-20-9 ²	PFPRV-1-A40-T3-20-0 ²	400W
		15,157	Type IV	PFPRV-1-A40-T4-20 ²	PFPRV-1-A40-T4-25-9 ²	PFPRV-1-A40-T4-20-0 ²	400W
	25'	6,192	Type III	PFPRV-1-A15-T3-25 ²	PFPRV-1-A15-T3-25-9 ²	PFPRV-1-A15-T3-25-0 ²	150W
		6,173	Type IV	PFPRV-1-A15-T4-25 ²	PFPRV-1-A15-T4-25-9 ²	PFPRV-1-A15-T4-25-0 ²	150W
		10,292	Type III	PFPRV-1-A25-T3-25 ²	PFPRV-1-A25-T3-25-9 ²	PFPRV-1-A25-T3-25-0 ²	250W
		10,261	Type IV	PFPRV-1-A25-T4-25 ²	PFPRV-1-A25-T4-25-9 ²	PFPRV-1-A25-T4-25-0 ²	250W
		15,203	Type III	PFPRV-1-A40-T3-25 ²	PFPRV-1-A40-T3-25-9 ²	PFPRV-1-A40-T3-25-0 ²	400W
		15,157	Type IV	PFPRV-1-A40-T4-25 ²	PFPRV-1-A40-T4-25-9 ²	PFPRV-1-A40-T4-25-0 ²	400W
	30'	6,192	Type III	PFPRV-1-A15-T3-30 ³	PFPRV-1-A15-T3-30-9 ³	PFPRV-1-A15-T3-30-0 ⁴	150W
		6,173	Type IV	PFPRV-1-A15-T4-30 ³	PFPRV-1-A15-T4-30-9 ³	PFPRV-1-A15-T4-30-0 ⁴	150W
		10,292	Type III	PFPRV-1-A25-T3-30 ³	PFPRV-1-A25-T3-30-9 ³	PFPRV-1-A25-T3-30-0 ⁴	250W
		10,261	Type IV	PFPRV-1-A25-T4-30 ³	PFPRV-1-A25-T4-30-9 ³	PFPRV-1-A25-T4-30-0 ⁴	250W
		15,203	Type III	PFPRV-1-A40-T3-30 ³	PFPRV-1-A40-T3-30-9 ³	PFPRV-1-A40-T3-30-0 ⁴	400W
		15,157	Type IV	PFPRV-1-A40-T4-30 ³	PFPRV-1-A40-T4-30-9 ³	PFPRV-1-A40-T4-30-0 ⁴	400W

- NOTES:
- Customer is responsible for engineering analysis to confirm pole and fixture compatibility for all applications. Refer to installation instructions IB500002EN and pole white paper WP513001EN for additional support information.
 - Supplied with 4A Square Straight Steel Shaft (SSS), Anchor Bolts (AB1), Template (TMP1), hardware and base cover. 15' combo SS4A15SFM4, 20' combo SS4A20SFM4, and 25' combo SS4A25SFM4.
 - Supplied with 5A Square Straight Steel Shaft (SSS), Anchor Bolts (AB1), Template (TMP1), hardware and base cover. 30' combo SS5A30SFM4.
 - Supplied with 5M Square Straight Steel Shaft (SSS), Anchor Bolts (AB1), Template (TMP1), hardware and base cover. 30' combo SS5M30SFM4.
 - Refer to In Stock Guide for stocked configurations and availability.

POWER AND LUMENS

Light Engine	A15	A25	A40	
Nominal Power (Watts)	57W	87W	143W	
Input Current @ 120V (A)	0.49	0.76	1.23	
Input Current @ 277V (A)	0.22	0.35	0.54	
Input Current @ 347V (A)	0.18	0.28	0.45	
Input Current @ 480V (A)	0.13	0.21	0.33	
Type III	Lumens	6,192	10,292	15,203
	BUG Rating	B1-U0-G2	B2-U0-G3	B2-U0-G3
Type IV	Lumens	6,173	10,261	15,157
	BUG Rating	B1-U0-G3	B2-U0-G3	B2-U0-G4

NOTE: Lumen output for standard bronze fixture color.

LUMEN MAINTENANCE

Ambient Temperature	25,000 Hours*	50,000 Hours*	60,000 Hours*	Theoretical 100,000 Hours	Theoretical L70 (Hours)*
25°C	> 96%	> 93%	> 92%	> 87%	> 260,000
40°C	> 96%	> 93%	> 92%	> 87%	> 255,000
50°C	> 95%	> 92%	> 91%	> 86%	> 250,000

* Per IESNA TM-21 data.

LUMEN MULTIPLIER

Ambient Temperature	Lumen Multiplier
10°C	1.02
15°C	1.01
25°C	1.00
40°C	0.99

TWO FIXTURE CONFIGURATION

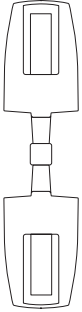
	Mounting Height (Feet)	Lumens (Nominal)	Distribution	Maximum Wind Zone (MPH)			HID Equivalent (Wattage)
				80	90	100	
 <p>EPA=1.50</p>	15'	6,192	Type III	PFPRV-2-A15-T3-15 ²	PFPRV-2-A15-T3-15-9 ²	PFPRV-2-A15-T3-15-0 ²	150W
		6,173	Type IV	PFPRV-2-A15-T4-15 ²	PFPRV-2-A15-T4-15-9 ²	PFPRV-2-A15-T4-15-0 ²	150W
		10,292	Type III	PFPRV-2-A25-T3-15 ²	PFPRV-2-A25-T3-15-9 ²	PFPRV-2-A25-T3-15-0 ²	250W
		10,261	Type IV	PFPRV-2-A25-T4-15 ²	PFPRV-2-A25-T4-15-9 ²	PFPRV-2-A25-T4-15-0 ²	250W
		15,203	Type III	PFPRV-2-A40-T3-15 ²	PFPRV-2-A40-T3-15-9 ²	PFPRV-2-A40-T3-15-0 ²	400W
		15,157	Type IV	PFPRV-2-A40-T4-15 ²	PFPRV-2-A40-T4-15-9 ²	PFPRV-2-A40-T4-15-0 ²	400W
	20'	6,192	Type III	PFPRV-2-A15-T3-20 ²	PFPRV-2-A15-T3-20-9 ²	PFPRV-2-A15-T3-20-0 ²	150W
		6,173	Type IV	PFPRV-2-A15-T4-20 ²	PFPRV-2-A15-T4-20-9 ²	PFPRV-2-A15-T4-20-0 ²	150W
		10,292	Type III	PFPRV-2-A25-T3-20 ²	PFPRV-2-A25-T3-20-9 ²	PFPRV-2-A25-T3-20-0 ²	250W
		10,261	Type IV	PFPRV-2-A25-T4-20 ²	PFPRV-2-A25-T4-20-9 ²	PFPRV-2-A25-T4-20-0 ²	250W
		15,203	Type III	PFPRV-2-A40-T3-20 ²	PFPRV-2-A40-T3-20-9 ²	PFPRV-2-A40-T3-20-0 ²	400W
		15,157	Type IV	PFPRV-2-A40-T4-20 ²	PFPRV-2-A40-T4-25-9 ²	PFPRV-2-A40-T4-20-0 ²	400W
	25'	6,192	Type III	PFPRV-2-A15-T3-25 ²	PFPRV-2-A15-T3-25-9 ²	PFPRV-2-A15-T3-25-0 ³	150W
		6,173	Type IV	PFPRV-2-A15-T4-25 ²	PFPRV-2-A15-T4-25-9 ²	PFPRV-2-A15-T4-25-0 ³	150W
		10,292	Type III	PFPRV-2-A25-T3-25 ²	PFPRV-2-A25-T3-25-9 ²	PFPRV-2-A25-T3-25-0 ³	250W
		10,261	Type IV	PFPRV-2-A25-T4-25 ²	PFPRV-2-A25-T4-25-9 ²	PFPRV-2-A25-T4-25-0 ³	250W
		15,203	Type III	PFPRV-2-A40-T3-25 ²	PFPRV-2-A40-T3-25-9 ²	PFPRV-2-A40-T3-25-0 ³	400W
		15,157	Type IV	PFPRV-2-A40-T4-25 ²	PFPRV-2-A40-T4-25-9 ²	PFPRV-2-A40-T4-25-0 ³	400W
	30'	6,192	Type III	PFPRV-2-A15-T3-30 ³	PFPRV-2-A15-T3-30-9 ³	PFPRV-2-A15-T3-30-0 ⁴	150W
		6,173	Type IV	PFPRV-2-A15-T4-30 ³	PFPRV-2-A15-T4-30-9 ³	PFPRV-2-A15-T4-30-0 ⁴	150W
		10,292	Type III	PFPRV-2-A25-T3-30 ³	PFPRV-2-A25-T3-30-9 ³	PFPRV-2-A25-T3-30-0 ⁴	250W
		10,261	Type IV	PFPRV-2-A25-T4-30 ³	PFPRV-2-A25-T4-30-9 ³	PFPRV-2-A25-T4-30-0 ⁴	250W
		15,203	Type III	PFPRV-2-A40-T3-30 ³	PFPRV-2-A40-T3-30-9 ³	PFPRV-2-A40-T3-30-0 ⁴	400W
		15,157	Type IV	PFPRV-2-A40-T4-30 ³	PFPRV-2-A40-T4-30-9 ³	PFPRV-2-A40-T4-30-0 ⁴	400W

- NOTES:**
- Customer is responsible for engineering analysis to confirm pole and fixture compatibility for all applications. Refer to installation instructions IB500002EN and pole white paper WP513001EN for additional support information.
 - Supplied with 4A Square Straight Steel Shaft (SSS), Anchor Bolts (AB1), Template (TMP1), hardware and base cover. 15' combo SS4A15SFM4, 20' combo SS4A20SFM4, and 25' combo SS4A25SFM4.
 - Supplied with 5A Square Straight Steel Shaft (SSS), Anchor Bolts (AB1), Template (TMP1), hardware and base cover. 25' combo SS5A25SFM4 and 30' combo SS5A30SFM4.
 - Supplied with 5M Square Straight Steel Shaft (SSS), Anchor Bolts (AB1), Template (TMP1), hardware and base cover. 30' combo SS5M30SFM4.
 - Refer to In Stock Guide for stocked configurations and availability.

POWER AND LUMENS

Light Engine		A15	A25	A40
Nominal Power (Watts)		57W	87W	143W
Input Current @ 120V (A)		0.49	0.76	1.23
Input Current @ 277V (A)		0.22	0.35	0.54
Input Current @ 347V (A)		0.18	0.28	0.45
Input Current @ 480V (A)		0.13	0.21	0.33
Type III	Lumens	6,192	10,292	15,203
	BUG Rating	B1-U0-G2	B2-U0-G3	B2-U0-G3
Type IV	Lumens	6,173	10,261	15,157
	BUG Rating	B1-U0-G3	B2-U0-G3	B2-U0-G4

NOTE: Lumen output for standard bronze fixture color.

LUMEN MAINTENANCE

Ambient Temperature	25,000 Hours*	50,000 Hours*	60,000 Hours*	Theoretical 100,000 Hours	Theoretical L70 (Hours)*
25°C	> 96%	> 93%	> 92%	> 87%	> 260,000
40°C	> 96%	> 93%	> 92%	> 87%	> 255,000
50°C	> 95%	> 92%	> 91%	> 86%	> 250,000

* Per IESNA TM-21 data.

LUMEN MULTIPLIER

Ambient Temperature	Lumen Multiplier
10°C	1.02
15°C	1.01
25°C	1.00
40°C	0.99

THREE FIXTURE CONFIGURATION

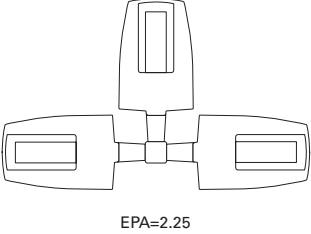
	Mounting Height (Feet)	Lumens (Nominal)	Distribution	Maximum Wind Zone (MPH)			HID Equivalent (Wattage)
				80	90	100	
 <p>EPA=2.25</p>	15'	6,192	Type III	PFPRV-3-A15-T3-15-2	PFPRV-3-A15-T3-15-9-2	PFPRV-3-A15-T3-15-0-2	150W
		6,173	Type IV	PFPRV-3-A15-T4-15-2	PFPRV-3-A15-T4-15-9-2	PFPRV-3-A15-T4-15-0-2	150W
		10,292	Type III	PFPRV-3-A25-T3-15-2	PFPRV-3-A25-T3-15-9-2	PFPRV-3-A25-T3-15-0-2	250W
		10,261	Type IV	PFPRV-3-A25-T4-15-2	PFPRV-3-A25-T4-15-9-2	PFPRV-3-A25-T4-15-0-2	250W
		15,203	Type III	PFPRV-3-A40-T3-15-2	PFPRV-3-A40-T3-15-9-2	PFPRV-3-A40-T3-15-0-2	400W
		15,157	Type IV	PFPRV-3-A40-T4-15-2	PFPRV-3-A40-T4-15-9-2	PFPRV-3-A40-T4-15-0-2	400W
	20'	6,192	Type III	PFPRV-3-A15-T3-20-2	PFPRV-3-A15-T3-20-9-2	PFPRV-3-A15-T3-20-0-2	150W
		6,173	Type IV	PFPRV-3-A15-T4-20-2	PFPRV-3-A15-T4-20-9-2	PFPRV-3-A15-T4-20-0-2	150W
		10,292	Type III	PFPRV-3-A25-T3-20-2	PFPRV-3-A25-T3-20-9-2	PFPRV-3-A25-T3-20-0-2	250W
		10,261	Type IV	PFPRV-3-A25-T4-20-2	PFPRV-3-A25-T4-20-9-2	PFPRV-3-A25-T4-20-0-2	250W
		15,203	Type III	PFPRV-3-A40-T3-20-2	PFPRV-3-A40-T3-20-9-2	PFPRV-3-A40-T3-20-0-2	400W
		15,157	Type IV	PFPRV-3-A40-T4-20-2	PFPRV-3-A40-T4-25-9-2	PFPRV-3-A40-T4-20-0-2	400W
	25'	6,192	Type III	PFPRV-3-A15-T3-25-2	PFPRV-3-A15-T3-25-9-3	PFPRV-3-A15-T3-25-0-3	150W
		6,173	Type IV	PFPRV-3-A15-T4-25-2	PFPRV-3-A15-T4-25-9-3	PFPRV-3-A15-T4-25-0-3	150W
		10,292	Type III	PFPRV-3-A25-T3-25-2	PFPRV-3-A25-T3-25-9-3	PFPRV-3-A25-T3-25-0-3	250W
		10,261	Type IV	PFPRV-3-A25-T4-25-2	PFPRV-3-A25-T4-25-9-3	PFPRV-3-A25-T4-25-0-3	250W
		15,203	Type III	PFPRV-3-A40-T3-25-2	PFPRV-3-A40-T3-25-9-3	PFPRV-3-A40-T3-25-0-3	400W
		15,157	Type IV	PFPRV-3-A40-T4-25-2	PFPRV-3-A40-T4-25-9-3	PFPRV-3-A40-T4-25-0-3	400W
	30'	6,192	Type III	PFPRV-3-A15-T3-30-3	PFPRV-3-A15-T3-30-9-4	PFPRV-3-A15-T3-30-0-4	150W
		6,173	Type IV	PFPRV-3-A15-T4-30-3	PFPRV-3-A15-T4-30-9-4	PFPRV-3-A15-T4-30-0-4	150W
		10,292	Type III	PFPRV-3-A25-T3-30-3	PFPRV-3-A25-T3-30-9-4	PFPRV-3-A25-T3-30-0-4	250W
		10,261	Type IV	PFPRV-3-A25-T4-30-3	PFPRV-3-A25-T4-30-9-4	PFPRV-3-A25-T4-30-0-4	250W
		15,203	Type III	PFPRV-3-A40-T3-30-3	PFPRV-3-A40-T3-30-9-4	PFPRV-3-A40-T3-30-0-4	400W
		15,157	Type IV	PFPRV-3-A40-T4-30-3	PFPRV-3-A40-T4-30-9-4	PFPRV-3-A40-T4-30-0-4	400W

NOTES:

- Customer is responsible for engineering analysis to confirm pole and fixture compatibility for all applications. Refer to installation instructions IB500002EN and pole white paper WP513001EN for additional support information.
- Supplied with 4A Square Straight Steel Shaft (SSS), Anchor Bolts (AB1), Template (TMP1), hardware and base cover. 15' combo SS4A15SFM4, 20' combo SS4A20SFM4, and 25' combo SS4A25SFM4.
- Supplied with 5A Square Straight Steel Shaft (SSS), Anchor Bolts (AB1), Template (TMP1), hardware and base cover. 25' combo SS5A25SFM4 and 30' combo SS5A30SFM4.
- Supplied with 5M Square Straight Steel Shaft (SSS), Anchor Bolts (AB1), Template (TMP1), hardware and base cover. 30' combo SS5M30SFM4.
- Refer to In Stock Guide for availability.

POWER AND LUMENS

Light Engine		A15	A25	A40
Nominal Power (Watts)		57W	87W	143W
Input Current @ 120V (A)		0.49	0.76	1.23
Input Current @ 277V (A)		0.22	0.35	0.54
Input Current @ 347V (A)		0.18	0.28	0.45
Input Current @ 480V (A)		0.13	0.21	0.33
Type III	Lumens	6,192	10,292	15,203
	BUG Rating	B1-U0-G2	B2-U0-G3	B2-U0-G3
Type IV	Lumens	6,173	10,261	15,157
	BUG Rating	B1-U0-G3	B2-U0-G3	B2-U0-G4

NOTE: Lumen output for standard bronze fixture color.

LUMEN MAINTENANCE

Ambient Temperature	25,000 Hours*	50,000 Hours*	60,000 Hours*	Theoretical 100,000 Hours	Theoretical L70 (Hours)*
25°C	> 96%	> 93%	> 92%	> 87%	> 260,000
40°C	> 96%	> 93%	> 92%	> 87%	> 255,000
50°C	> 95%	> 92%	> 91%	> 86%	> 250,000

* Per IESNA TM-21 data.

LUMEN MULTIPLIER

Ambient Temperature	Lumen Multiplier
10°C	1.02
15°C	1.01
25°C	1.00
40°C	0.99

FOUR FIXTURE CONFIGURATION

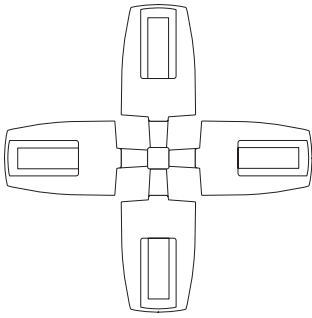
	Mounting Height (Feet)	Lumens (Nominal)	Distribution	Maximum Wind Zone (MPH)			HID Equivalent (Wattage)
				80	90	100	
 <p>EPA=3.00</p>	15'	6,192	Type III	PFPRV-4-A15-T3-15 ²	PFPRV-4-A15-T3-15-9 ²	PFPRV-4-A15-T3-15-0 ²	150W
		6,173	Type IV	PFPRV-4-A15-T4-15 ²	PFPRV-4-A15-T4-15-9 ²	PFPRV-4-A15-T4-15-0 ²	150W
		10,292	Type III	PFPRV-4-A25-T3-15 ²	PFPRV-4-A25-T3-15-9 ²	PFPRV-4-A25-T3-15-0 ²	250W
		10,261	Type IV	PFPRV-4-A25-T4-15 ²	PFPRV-4-A25-T4-15-9 ²	PFPRV-4-A25-T4-15-0 ²	250W
		15,203	Type III	PFPRV-4-A40-T3-15 ²	PFPRV-4-A40-T3-15-9 ²	PFPRV-4-A40-T3-15-0 ²	400W
		15,157	Type IV	PFPRV-4-A40-T4-15 ²	PFPRV-4-A40-T4-15-9 ²	PFPRV-4-A40-T4-15-0 ²	400W
	20'	6,192	Type III	PFPRV-4-A15-T3-20 ²	PFPRV-4-A15-T3-20-9 ²	PFPRV-4-A15-T3-20-0 ²	150W
		6,173	Type IV	PFPRV-4-A15-T4-20 ²	PFPRV-4-A15-T4-20-9 ²	PFPRV-4-A15-T4-20-0 ²	150W
		10,292	Type III	PFPRV-4-A25-T3-20 ²	PFPRV-4-A25-T3-20-9 ²	PFPRV-4-A25-T3-20-0 ²	250W
		10,261	Type IV	PFPRV-4-A25-T4-20 ²	PFPRV-4-A25-T4-20-9 ²	PFPRV-4-A25-T4-20-0 ²	250W
		15,203	Type III	PFPRV-4-A40-T3-20 ²	PFPRV-4-A40-T3-20-9 ²	PFPRV-4-A40-T3-20-0 ²	400W
		15,157	Type IV	PFPRV-4-A40-T4-20 ²	PFPRV-4-A40-T4-25-9 ²	PFPRV-4-A40-T4-20-0 ²	400W
	25'	6,192	Type III	PFPRV-4-A15-T3-25 ²	PFPRV-4-A15-T3-25-9 ³	PFPRV-4-A15-T3-25-0 ³	150W
		6,173	Type IV	PFPRV-4-A15-T4-25 ²	PFPRV-4-A15-T4-25-9 ³	PFPRV-4-A15-T4-25-0 ³	150W
		10,292	Type III	PFPRV-4-A25-T3-25 ²	PFPRV-4-A25-T3-25-9 ³	PFPRV-4-A25-T3-25-0 ³	250W
		10,261	Type IV	PFPRV-4-A25-T4-25 ²	PFPRV-4-A25-T4-25-9 ³	PFPRV-4-A25-T4-25-0 ³	250W
		15,203	Type III	PFPRV-4-A40-T3-25 ²	PFPRV-4-A40-T3-25-9 ³	PFPRV-4-A40-T3-25-0 ³	400W
		15,157	Type IV	PFPRV-4-A40-T4-25 ²	PFPRV-4-A40-T4-25-9 ³	PFPRV-4-A40-T4-25-0 ³	400W
	30'	6,192	Type III	PFPRV-4-A15-T3-30 ³	PFPRV-4-A15-T3-30-9 ⁴	PFPRV-4-A15-T3-30-0 ⁴	150W
		6,173	Type IV	PFPRV-4-A15-T4-30 ³	PFPRV-4-A15-T4-30-9 ⁴	PFPRV-4-A15-T4-30-0 ⁴	150W
		10,292	Type III	PFPRV-4-A25-T3-30 ³	PFPRV-4-A25-T3-30-9 ⁴	PFPRV-4-A25-T3-30-0 ⁴	250W
		10,261	Type IV	PFPRV-4-A25-T4-30 ³	PFPRV-4-A25-T4-30-9 ⁴	PFPRV-4-A25-T4-30-0 ⁴	250W
		15,203	Type III	PFPRV-4-A40-T3-30 ³	PFPRV-4-A40-T3-30-9 ⁴	PFPRV-4-A40-T3-30-0 ⁴	400W
		15,157	Type IV	PFPRV-4-A40-T4-30 ³	PFPRV-4-A40-T4-30-9 ⁴	PFPRV-4-A40-T4-30-0 ⁴	400W

NOTES:

- Customer is responsible for engineering analysis to confirm pole and fixture compatibility for all applications. Refer to installation instructions IB500002EN and pole white paper WP513001EN for additional support information.
- Supplied with 4A Square Straight Steel Shaft (SSS), Anchor Bolts (AB1), Template (TMP1), hardware and base cover. 15' combo SS4A15SFM4, 20' combo SS4A20SFM4, and 25' combo SS4A25SFM4.
- Supplied with 5A Square Straight Steel Shaft (SSS), Anchor Bolts (AB1), Template (TMP1), hardware and base cover. 25' combo SS5A25SFM4 and 30' combo SS5A30SFM4.
- Supplied with 5M Square Straight Steel Shaft (SSS), Anchor Bolts (AB1), Template (TMP1), hardware and base cover. 30' combo SS5M30SFM4.
- Refer to In Stock Guide for availability.

POWER AND LUMENS

Light Engine	A15	A25	A40	
Nominal Power (Watts)	57W	87W	143W	
Input Current @ 120V (A)	0.49	0.76	1.23	
Input Current @ 277V (A)	0.22	0.35	0.54	
Input Current @ 347V (A)	0.18	0.28	0.45	
Input Current @ 480V (A)	0.13	0.21	0.33	
Type III	Lumens	6,192	10,292	15,203
	BUG Rating	B1-U0-G2	B2-U0-G3	B2-U0-G3
Type IV	Lumens	6,173	10,261	15,157
	BUG Rating	B1-U0-G3	B2-U0-G3	B2-U0-G4

NOTE: Lumen output for standard bronze fixture color.

LUMEN MAINTENANCE

Ambient Temperature	25,000 Hours*	50,000 Hours*	60,000 Hours*	Theoretical 100,000 Hours	Theoretical L70 (Hours)*
25°C	> 96%	> 93%	> 92%	> 87%	> 260,000
40°C	> 96%	> 93%	> 92%	> 87%	> 255,000
50°C	> 95%	> 92%	> 91%	> 86%	> 250,000

* Per IESNA TM-21 data.

LUMEN MULTIPLIER

Ambient Temperature	Lumen Multiplier
10°C	1.02
15°C	1.01
25°C	1.00
40°C	0.99