

Issuance and Revisions:		
Date	Number	Description
05/11/16		Plan Commission Submittal

Copyright Insite Landscape Design Inc. 2012
ALL RIGHTS RESERVED
THIS DRAWING IS THE PROPERTY OF INSITE LANDSCAPE DESIGN INC. AND IS TO BE USED ONLY FOR THE PROJECT AND SITE SPECIFICALLY IDENTIFIED HEREON. ANY REUSE, REPRODUCTION, OR TRANSMISSION OF THIS DRAWING IN ANY FORM OR MANNER WITHOUT THE WRITTEN CONSENT OF INSITE LANDSCAPE DESIGN INC. IS STRICTLY PROHIBITED. THE LANDSCAPE ARCHITECT HAS NOT CONDUCTED A VISUAL QUALITY ANALYSIS OF THE PROPOSED DEVELOPMENT. THE LANDSCAPE ARCHITECT HAS CONDUCTED VISUAL QUALITY ANALYSIS OF THE PROPOSED DEVELOPMENT AND HAS IDENTIFIED AREAS WHERE VISUAL QUALITY IMPACTS MAY OCCUR. THE LANDSCAPE ARCHITECT HAS IDENTIFIED AREAS WHERE VISUAL QUALITY IMPACTS MAY OCCUR AND HAS IDENTIFIED AREAS WHERE VISUAL QUALITY IMPACTS MAY OCCUR.

Sheet Title:
PROPOSED PARTIAL PHOTOMETRIC LIGHT LEVEL CALCULATIONS PLAN, GENERAL NOTES, AND FIXTURE TABLE

Date of Drawing: 05/11/16
Scale: 1" = 20'-0"
Drawn By: MCD
Job Number: LG-024
Sheet Number: 1

LUMINAIRE SCHEDULE								
Symbol	Qty	Catalog Number	Description	Lamp	File	Lumens	LLF	Watts
○	3	SOVARD-175-PSM-C073	SOVEREIGN SERIES CANOPY FIXTURE TYPE V 175 W PULSE START METAL HALIDE LAMP 8 X 4 DIFFUSED FLAT TEMPERED GLASS LENS W/ DRIVING ELECTRONIC BALLAST (175 WATTAGE) (COLOR TO BE DETERMINED)	BU	SOVARD-175-PSM-C073.xls	17500	1.00	208
□	5	CHWS-FT-100-4H-	CHALLENGER WALL SCONCE SERIES MEDIA TYPE II FORWARD THROUGH W/ 100 W PSW & FLAT CLEAR TEMPERED GLASS LENS W/ DRIVING ELECTRONIC BALLAST (100 WATTAGE) (COLOR TO BE DETERMINED)	CHWS-FT-100-4H-F	CHWS-FT-100-4H-F.xls	9000	1.00	129

STATISTICS						
Calc-Zone #2	Symbol	Avg	Max	Min	Max/Min	Avg/Min
	+	2.61c	47.51c	0.01c	N/A	N/A

EXISTING POLE MOUNTED FIXTURES IN THE PARKING LOT FIELD ARE SHOWN FOR REFERENCE.
THIS LIGHTING PLAN REPRESENTS ILLUMINATION LEVELS CALCULATED FROM LABORATORY DATA TAKEN UNDER CONTROLLED CONDITIONS IN ACCORDANCE WITH THE ILLUMINATING ENGINEERING SOCIETY (IES) APPROVED METHODS. ACTUAL PERFORMANCE OF ANY MANUFACTURER'S LUMINAIRES MAY VARY DUE TO CHANGES IN ELECTRICAL VOLTAGE TOLERANCE IN LAMP/STAYS AND OTHER VARY DUE TO CHANGES IN ELECTRICAL VOLTAGE TOLERANCE IN LAMP/STAYS AND OTHER ARCHITECTURAL ELEMENTS UNLESS NOTED. CONDITIONS: CALCULATIONS DO NOT INCLUDE OBSTRUCTIONS SUCH AS BUILDINGS CURBS, LANDSCAPING, OR ANY OTHER ARCHITECTURAL ELEMENTS UNLESS NOTED.

PHOTOMETRIC GENERAL NOTES:
1. BASED ON THE INFORMATION PROVIDED, ALL DIMENSIONS AND LUMINAIRE LOCATIONS SHOWN REPRESENT RECOMMENDED POLE PLACEMENTS AND LUMINAIRE ORIENTATION. THE ENGINEER AND/OR ARCHITECT DOES NOT WARRANT THE ACCURACY OF THE LAYOUT OR RELEVANT FIELD CONDITIONS. INDEPENDENT LABORATORY, LUMINAIRE CHARACTERISTICAL DATA WAS MEASURED UNDER CONTROLLED CONDITIONS IN ACCORDANCE WITH APPROVED ILLUMINATION ENGINEERING SOCIETY METHODS. ACTUAL ON-SITE PERFORMANCE OF ANY MANUFACTURER'S LUMINAIRES MAY VARY FROM LABORATORY TEST RESULTS DUE TO VARIATIONS IN ELECTRICAL VOLTAGE, TOLERANCE IN LAMP/STAYS, AND OTHER VARIABLE FIELD CONDITIONS.
2. IF EXISTING LUMINAIRES ARE INCLUDED IN THIS REPORT, THEIR ILLUMINATION CHARACTERISTICS ARE BASED UPON A COMBINATION OF CUSTOMER'S PROVIDED SPECIFICATIONS & OUR BEST ESTIMATIONS.
3. EXISTING CONDITIONS GENERAL NOTES:

EXISTING CONDITIONS GENERAL NOTES:
1. INFORMATION PERTAINING TO EXISTING CONDITIONS GIVEN ON THESE ARCHITECTURAL DRAWINGS REPRESENTS TO THE BEST OF OUR KNOWLEDGE THE ACTUAL EXISTING FIELD CONDITIONS. INSITE LANDSCAPE DESIGN, INC. MAKES NO WARRANTY AS TO THEIR ACCURACY. CONTRACTOR TO FIELD VERIFY EXISTING CONDITIONS IMPERATIVE TO THEIR NEW WORK. REPORT ANY DISCREPANCIES BETWEEN THE DRAWINGS AND FIELD CONDITIONS TO THE LANDSCAPE ARCHITECT FOR REVIEW. ANY WORK PERFORMED PRIOR TO RESOLUTION OF DISCREPANCIES BY THE LANDSCAPE ARCHITECT IS SUBJECT TO REMOVAL AND REPLACEMENT AT NO ADDITIONAL COST TO THE CONTRACT.
2. CONSTRUCTION BEGINS.
3. VERIFY LOCATION OF ACCESS PANELS W/ MECHANICAL AND ELECTRICAL EQUIPMENT FOR ACCESSIBILITY OF MECHANICAL & ELECTRICAL ITEMS.

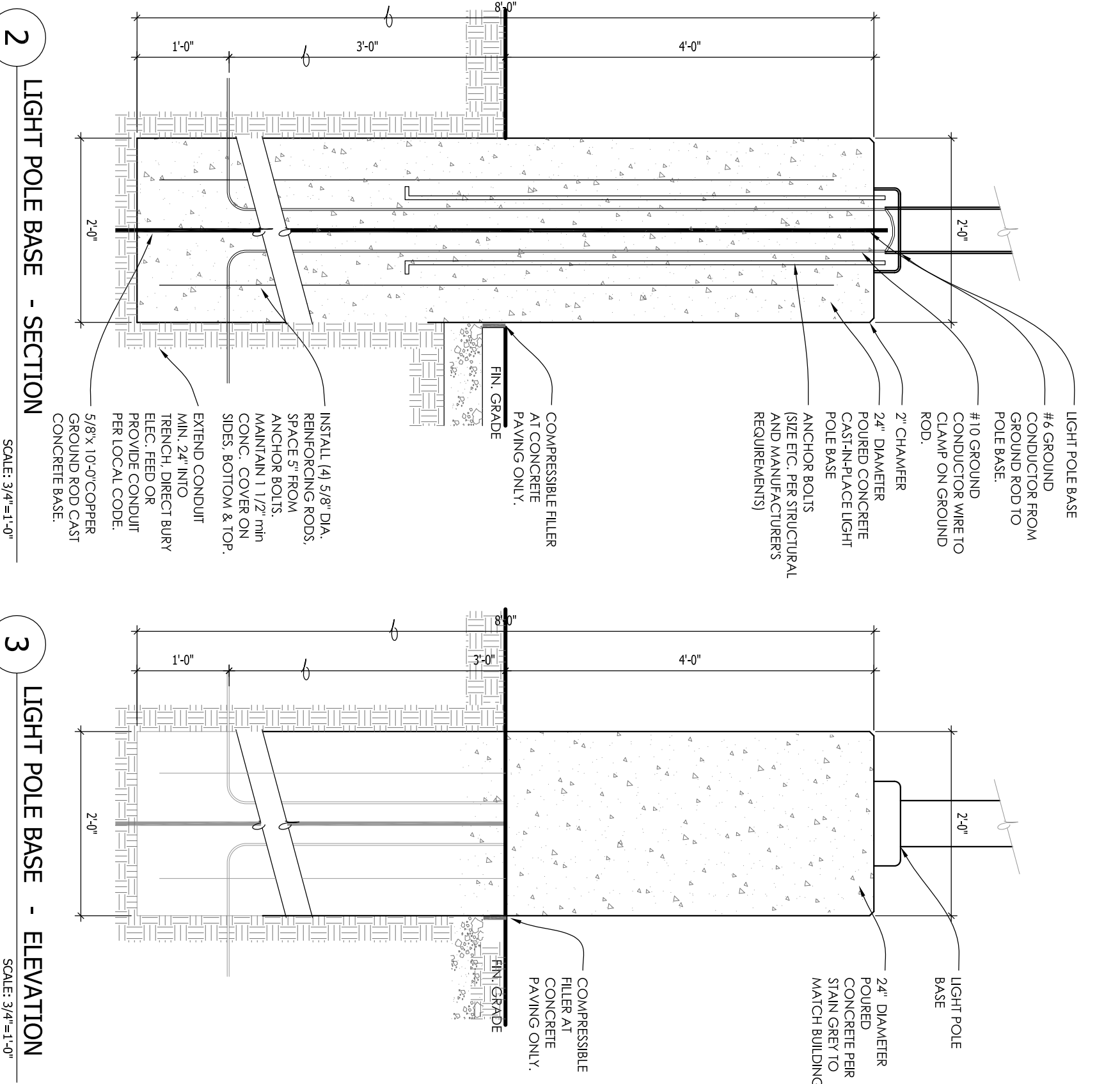
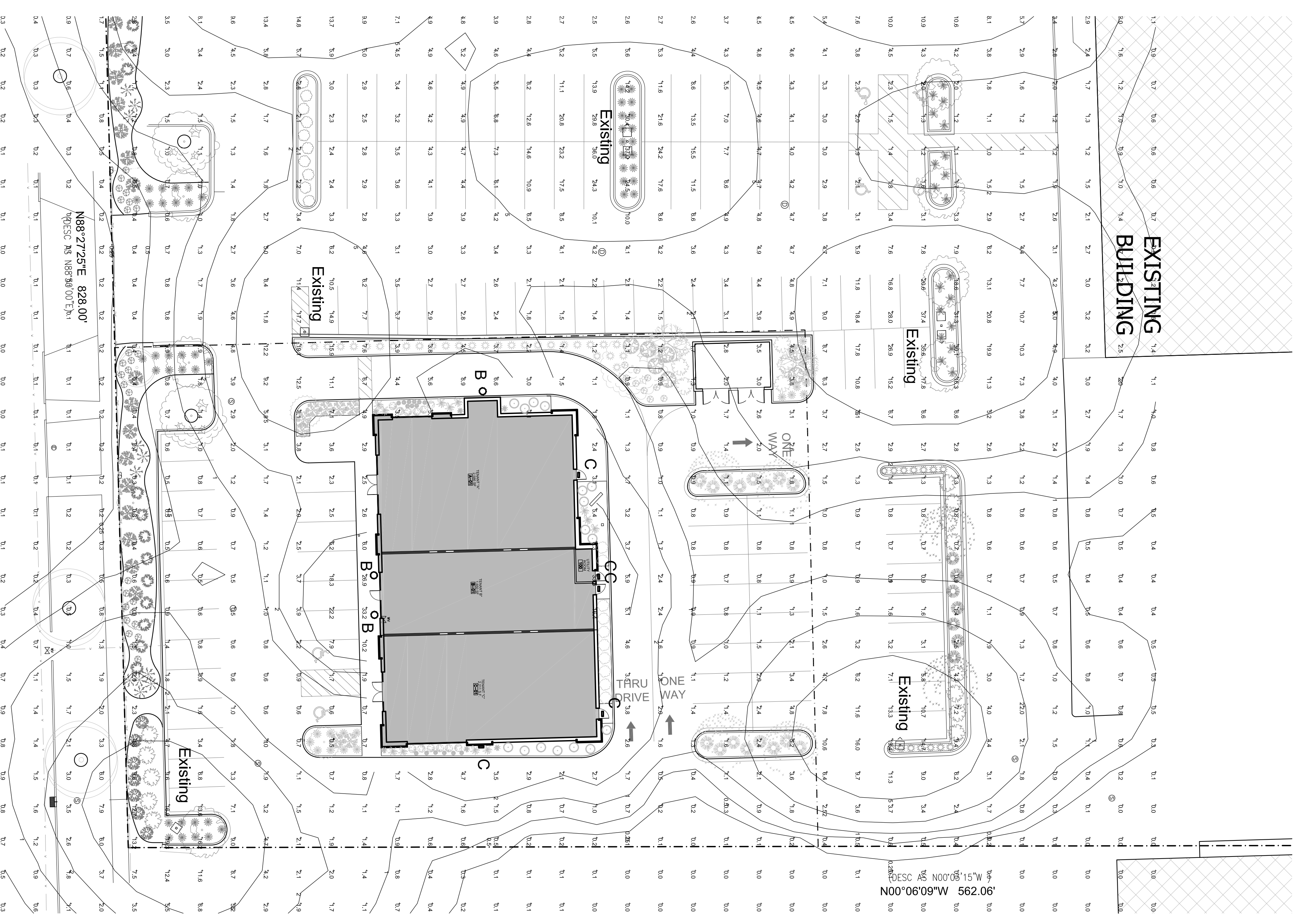

TO OBTAIN LOCATION OF PARTICIPANT'S UNDERGROUND FACILITIES BEFORE YOU DIG IN WISCONSIN
DIGGERS HOTLINE
WISCONSIN STATUTE (RS.2075) (1974) REQUIRES A MINIMUM OF 3 DAYS NOTICE BEFORE YOU EXCAVATE (NOT INCLUDING SUNDAY, SUNDAY OR LEGAL HOLIDAYS)

TO OBTAIN LOCATION OF PARTICIPANT'S UNDERGROUND FACILITIES BEFORE YOU DIG IN WISCONSIN
811
Know what's below.
Call before you dig.