



I. I. Kennedy, Inc.
 architecture
 interior design
 consulting services

2025 west southbranch boulevard
 oak creek, wisconsin 53154
 phone (414) 302-5630
 fax (414) 302-5675
 ikennedy@iikcompanies.com

1260 WEST SUNSET DRIVE
 WAUKESHA, WISCONSIN 53189

chili's

DO NOT SCALE DRAWINGS
 CONTRACTOR TO VERIFY
 ALL EXISTING CONDITIONS AND
 DIMENSIONS-NOTIFY ARCHITECT
 OF ANY DISCREPANCIES PRIOR
 TO BEGINNING CONSTRUCTION

PARKING STATISTICS	
STANDARD PARKING STALLS	90
ACCESSIBLE PARKING STALLS	4
TOTAL PARKING SPACES	94

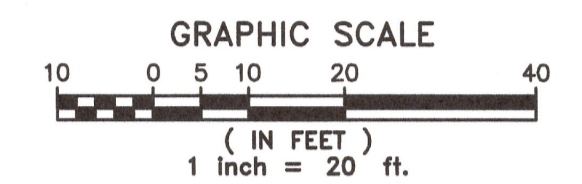

LEGEND

- EXISTING PROPERTY LINE
- PROPOSED 18" CURB AND GUTTER
- PROPOSED LOW SIDE CURB (SEE GRADING PLAN FOR ADDITIONAL INFORMATION)
- PROPOSED ACCESSIBLE PARKING STALL
- PROPOSED PARKING STALL COUNT
- PROPOSED SIGN (SEE SHEET C-4)
- PROPOSED DETECTABLE WARNING FIELD
- EXISTING LIGHT POLES (BY DEVELOPER)
- PROPOSED LIGHT POLES (BY CHILI'S)
- PROPOSED CONCRETE WALK (REFER TO GEOTECHNICAL REPORT FOR DESIGN INFORMATION)
- PROPOSED HEAVY DUTY CONCRETE (REFER TO GEOTECHNICAL REPORT FOR DESIGN INFORMATION)

GENERAL NOTES:

- EXISTING TOPOGRAPHY PROVIDED BY R.A. SMITH NATIONAL, DATED MAY 5, 2009.
- THE LOCATIONS OF EXISTING UTILITY INSTALLATIONS AS SHOWN ON THIS PLAN ARE APPROXIMATE. THERE MAY BE OTHER UNDERGROUND UTILITY INSTALLATIONS WITHIN THE PROJECT AREA THAT ARE NOT SHOWN. THE CONTRACTOR SHALL BE RESPONSIBLE FOR VERIFYING THE EXISTENCE AND LOCATION OF ALL UNDERGROUND UTILITIES.
- R.A. SMITH NATIONAL ASSUMES NO RESPONSIBILITY FOR DAMAGES, LIABILITY OR COSTS RESULTING FROM CHANGES OR ALTERATIONS MADE TO THIS PLAN WITHOUT THE EXPRESSED WRITTEN CONSENT OF R.A. SMITH NATIONAL.
- CONTRACTOR SHALL REFER TO ARCHITECTURAL PLANS FOR EXACT LOCATION AND DIMENSION OF ENTRANCES, VESTIBULES, STAIRS, RETAINING WALLS, RAMPS, PRECISE BUILDING DIMENSIONS AND EXACT BUILDING UTILITY ENTRANCE LOCATIONS.
- CONTRACTOR SHALL PROVIDE EROSION CONTROL FACILITIES IN ACCORDANCE WITH THE CITY OF WAUKESHA EROSION CONTROL ORDINANCE AND THE WISCONSIN DNR TECHNICAL STANDARDS.
- ALL DIMENSIONS SHOWN ARE TO PROPERTY LINES, EXTERIOR BUILDING WALLS, OR FACE OF CURB UNLESS OTHERWISE NOTED.
- ALL CURB IS HIGH SIDE CURB UNLESS OTHERWISE NOTED.

DIGGERS HOTLINE
 Toll Free (800) 242-8871
 Milwaukee Area (414) 259-1181
 Hearing Impaired TDD (800) 642-2289
 www.DiggersHotline.com

R.A. SMITH NATIONAL, INC. ASSUMES NO RESPONSIBILITY FOR DAMAGES, LIABILITY OR COSTS RESULTING FROM CHANGES OR ALTERATIONS MADE TO THIS PLAN WITHOUT THE EXPRESSED WRITTEN CONSENT OF R.A. SMITH NATIONAL.

THE LOCATIONS OF EXISTING UTILITY INSTALLATIONS AS SHOWN ON THIS PLAN ARE APPROXIMATE. THERE MAY BE OTHER UNDERGROUND UTILITY INSTALLATIONS WITHIN THE PROJECT AREA THAT ARE NOT SHOWN.

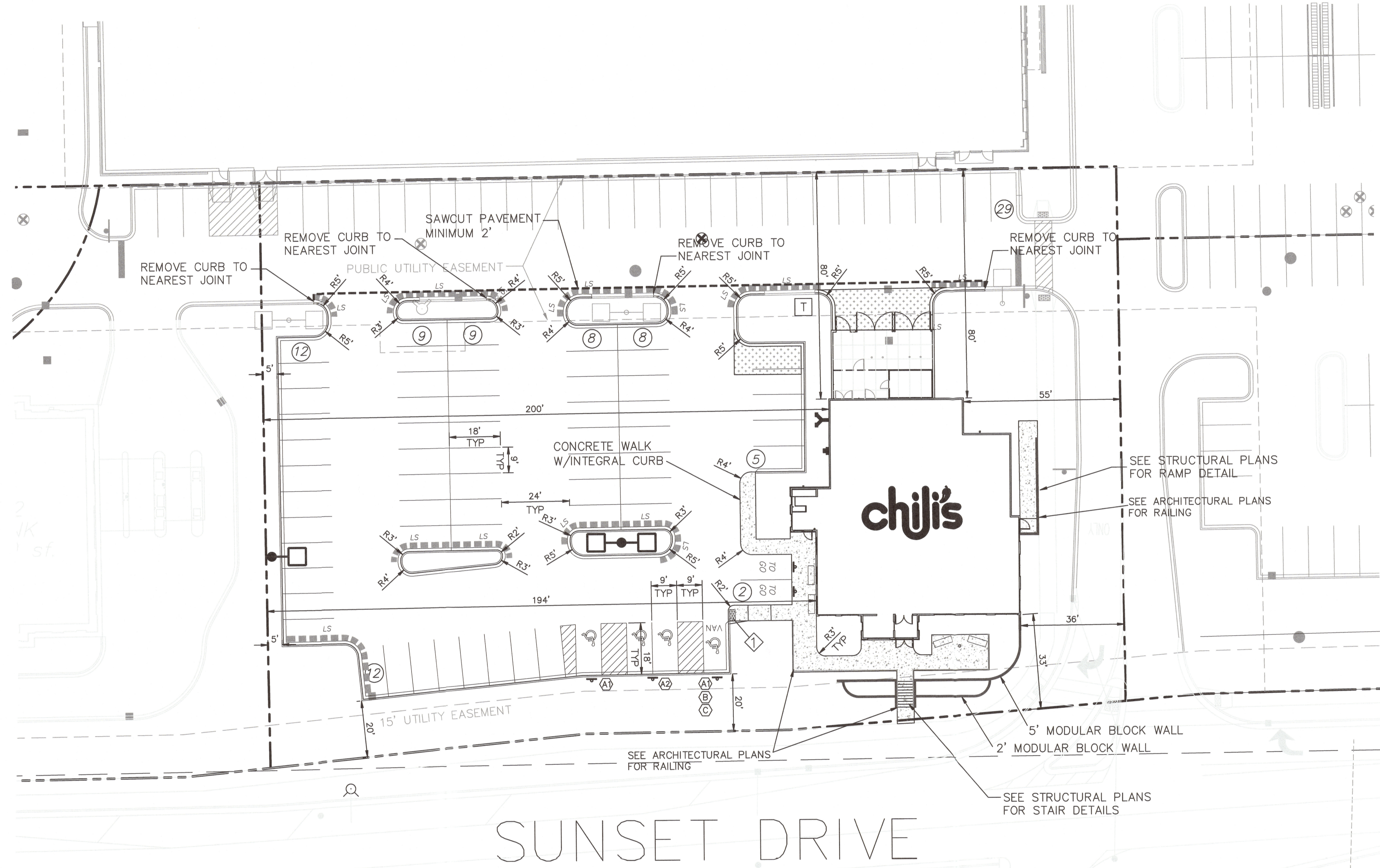

- PAVING NOTES:**
1. THE PROPOSED IMPROVEMENTS SHALL BE CONSTRUCTED ACCORDING TO THE WISCONSIN D.O.T. STANDARD SPECIFICATIONS FOR HIGHWAY AND STRUCTURE CONSTRUCTION, LATEST EDITION, AND THE LOCAL ORDINANCES AND SPECIFICATIONS.
 2. THE CONTRACTOR SHALL NOTIFY THE OWNER AND THE MUNICIPALITY FORTY- EIGHT (48) HOURS PRIOR TO THE START OF CONSTRUCTION.
 3. THE MUNICIPALITY SHALL HAVE THE RIGHT TO INSPECT, APPROVE, AND REJECT THE CONSTRUCTION OF THE IMPROVEMENTS DETAILED BY THIS PROJECT.
 4. THE CONTRACTOR SHALL INDEMNIFY THE OWNER, THE ENGINEER, AND THE MUNICIPALITY, THEIR AGENTS, ETC, FROM ALL LIABILITY INVOLVED WITH THE CONSTRUCTION, INSTALLATION, AND TESTING OF THE WORK ON THIS PROJECT.
 5. SITE SAFETY SHALL BE THE SOLE RESPONSIBILITY OF THE CONTRACTOR.
 6. THE BIDDER WILL BE SOLELY RESPONSIBLE FOR DETERMINING QUANTITIES AND SHALL STATE SUCH QUANTITIES IN HIS PROPOSAL. HE SHALL BASE HIS BID ON HIS OWN ESTIMATE OF THE WORK REQUIRED AND SHALL NOT RELY ON THE ENGINEER'S ESTIMATE.
 7. THE CONTRACTOR SHALL OBTAIN AND PAY FOR ALL PERMITS REQUIRED FOR EXECUTION OF THE WORK. THE CONTRACTOR SHALL CONDUCT HIS WORK ACCORDING TO THE REQUIREMENTS OF THE PERMITS.

8. THE CONTRACTOR IS RESPONSIBLE FOR FIELD VERIFYING ALL UTILITY INFORMATION SHOWN ON THE PLANS PRIOR TO THE START OF CONSTRUCTION. THE CONTRACTOR SHALL CALL DIGGER'S HOTLINE AT 1-800-242-8871 TO NOTIFY THE UTILITIES OF HIS INTENTIONS, AND TO REQUEST FIELD STAKING OF EXISTING UTILITIES.
9. THE CONTRACTOR IS RESPONSIBLE FOR VERIFYING SOIL CONDITIONS PRIOR TO COMMENCEMENT OF CONSTRUCTION. A GEOTECHNICAL REPORT MAY BE AVAILABLE FROM THE OWNER.
10. SILT FENCE AND OTHER EROSION CONTROL FACILITIES MUST BE INSTALLED PRIOR TO CONSTRUCTION OR ANY OTHER LAND DISTURBING ACTIVITY. THE CONTRACTOR SHALL BE RESPONSIBLE FOR REMOVING ALL EROSION CONTROL FACILITIES ONCE THE THREAT OF EROSION HAS PASSED WITH THE APPROVAL OF THE GOVERNING AGENCY.
11. PAVING SHALL CONSIST OF FINE GRADING PAVEMENT AREAS, INSTALLATION OF CRUSHED STONE BASE, CONCRETE AND/OR BITUMINOUS PAVEMENT, PAVEMENT MARKING, AND CLEANUP. ALL MATERIALS SHALL BE PROVIDED BY THE CONTRACTOR.
12. THE CONTRACTOR SHALL MAINTAIN SITE DRAINAGE THROUGHOUT CONSTRUCTION. THIS MAY INCLUDE THE EXCAVATION OF TEMPORARY DITCHES OR PUMPING TO ALLEVIATE WATER PONDING.
13. CONTRACTOR IS ADVISED THAT ALL MUD AND DEBRIS MUST NOT BE DEPOSITED ONTO THE ADJACENT ROADWAYS PER THE REQUIREMENT OF THE MUNICIPALITY OR OTHER APPROPRIATE GOVERNMENT AGENCIES.

14. AGGREGATES USED IN THE CRUSHED STONE BASE SHALL CONFORM TO THE GRADATION REQUIREMENTS OF SECTION 305 OF THE STANDARD SPECIFICATIONS AND AS DESCRIBED IN THE GEOTECHNICAL REPORT.
15. AGGREGATES USED IN THE ASPHALT BINDER AND SURFACE COURSES SHALL BE IN ACCORDANCE WITH THE GEOTECHNICAL REPORT.
16. BITUMINOUS MATERIAL SHALL BE IN ACCORDANCE WITH THE GEOTECHNICAL REPORT.
17. TACK COAT SHALL BE AN MS-2 EMULSIFIED ASPHALT IN ACCORDANCE WITH SECTION 402 OF THE STANDARD SPECIFICATIONS AND SHALL BE APPLIED AT A RATE OF 0.10 GALLONS PER SQUARE YARD.
18. CONCRETE AND ASSOCIATED REINFORCING FOR CURB, DRIVEWAY, WALKS AND NON-FLOOR SLABS SHALL BE IN ACCORDANCE WITH THE GEOTECHNICAL REPORT.
19. ANY ADJACENT PROPERTIES OR ROAD RIGHT-OF-WAYS WHICH ARE DAMAGED DURING CONSTRUCTION MUST BE RESTORED BY THE CONTRACTOR. THE COST OF THE RESTORATION IS CONSIDERED INCIDENTAL, AND SHOULD BE INCLUDED IN THE BID PRICES.
20. CONTRACTOR SHALL REFER TO OTHER PLANS AS NOTED FOR ADDITIONAL DESIGN INFORMATION. CONTRACTOR SHALL EXAMINE ALL APPROPRIATE PLANS AND NOTIFY ENGINEER IMMEDIATELY OF ANY DISCREPANCIES SO THAT PROPER MODIFICATIONS CAN BE MADE TO THE DESIGN.

NO REVISION

PROJECT NUMBER
 2009049

SHEET NUMBER

C-1

ISSUED FOR CONSTRUCTION
 ISSUE DATE - 8/3/09