

File: O:\2021\110640A\DWG\Civil Sheets\12110640 - Mindiola Park Con Docs.dwg Layout: C2.0 SITE User: newman Plotted: Feb 03, 2023 - 11:44am Xrefs:

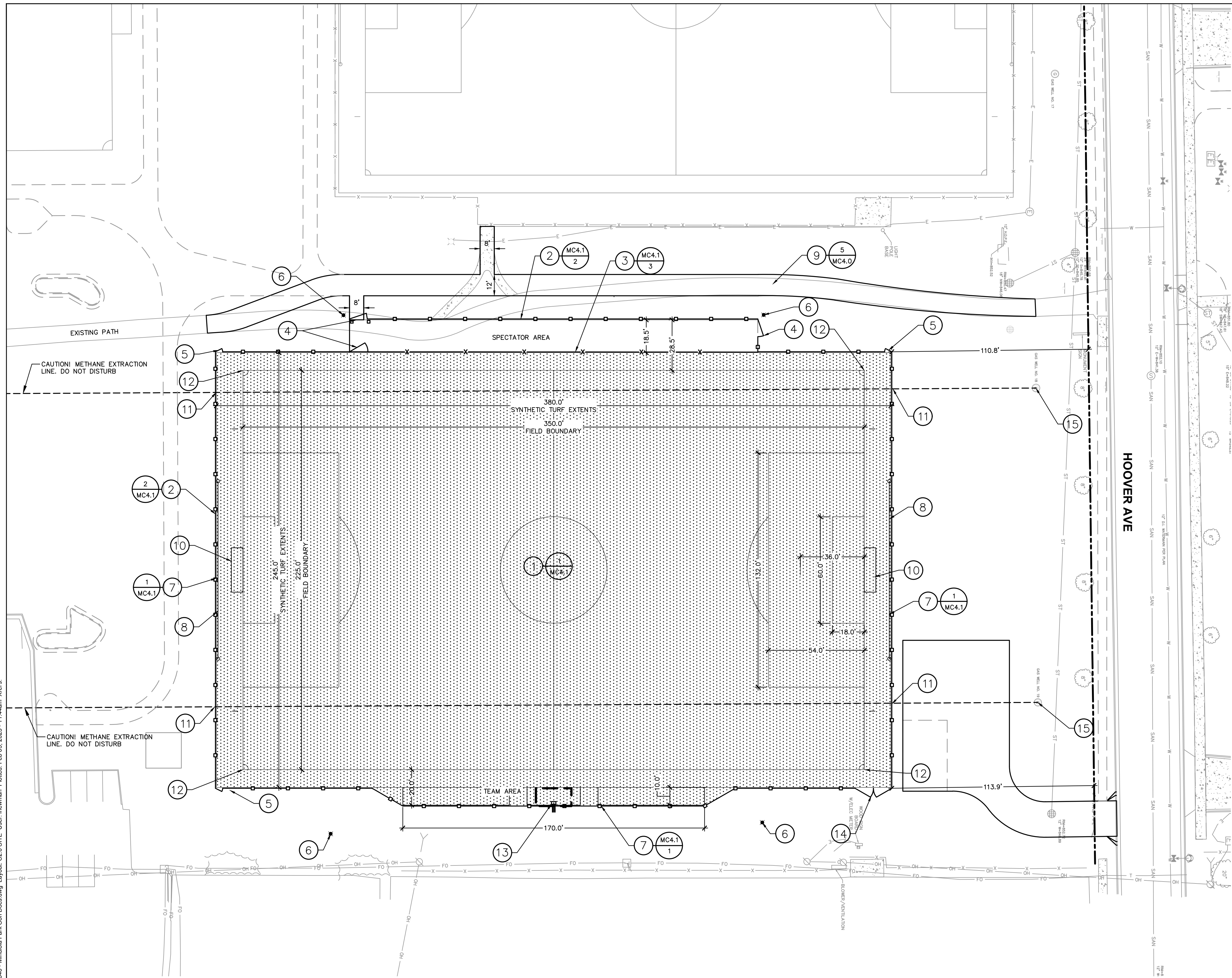

LEGEND

| | |
|--|--------------------------------------|
| | PROPERTY LINE |
| | 6" X 12" CURB AND NAILER |
| | SYNTHETIC TURF SURFACING |
| | 4' HT. BLACK COATED CHAIN-LINK FENCE |
| | 8' HT. BLACK COATED CHAIN-LINK FENCE |
| | LIGHT POLE (BY OTHERS) |
| | EXISTING METHANE EXTRACTION LINE |
| | FUTURE BUILDING |
| | ELECTRICAL CONDUIT (BY OTHERS) |

- KEYNOTES**
1. SYNTHETIC TURF. REFER TO DETAILS AND SPECIFICATIONS.
 2. 8' HEIGHT BLACK COATED CHAIN-LINK FENCE. REFER TO DETAILS AND SPECIFICATIONS.
 3. 4' HEIGHT BLACK COATED CHAIN-LINK FENCE. REFER TO DETAILS AND SPECIFICATIONS.
 4. 10' WIDE FENCE GATE. GATE SHALL EXTEND TO FULL HEIGHT OF FENCE. REFER TO SPECIFICATIONS.
 5. 4' WIDE FENCE GATE. GATE SHALL EXTEND TO FULL HEIGHT OF FENCE. REFER TO SPECIFICATIONS.
 6. FIELD LIGHTING. BY OTHERS.
 7. 6" X 12" CONCRETE CURB AND NAILER. REFER TO DETAIL.
 8. FREE-STANDING, 20' HEIGHT BACKSTOP NETTING. REFER TO PRODUCT LIST.
 9. CONCRETE SIDEWALK. SEE DETAIL.
 10. SOCCER GOALS. REFER TO PRODUCT LIST.
 11. ADJUST POST SPACING AS SUCH THAT NO POSTS ARE DRIVEN WITHIN 4' ON EITHER SIDE OF EXISTING METHANE EXTRACTION LINE.
 12. CORNER FLAGS. INSTALL IN TURF PER MANUFACTURER'S RECOMMENDATIONS.
 13. COMBOX. OFFSET 1" FROM CONCRETE CURB, CENTERED ON THE FIELD. CONTRACTOR TO PROVIDE 3 CONDUIT STUBS FROM COMBOX TO 3 FEET OUTSIDE OF CONCRETE CURB. CONDUIT SHALL BE STEEL RIGID METAL AND INSTALLED AS A MINIMUM STUB-UP IN THE BOX TO ALLOW FOR SEAL-OFF'S TO BE INSTALLED AT A LATER TIME. INSTALL RIGID COUPLING'S WITH METAL PLUGS TO PREVENT CONDUITS FROM FILLING WITH DEBRIS. DUCT TAPE IS NOT ACCEPTABLE.
 14. 20' WIDE GATE. GATE SHALL EXTEND TO FULL HEIGHT OF FENCE. REFER TO SPECIFICATIONS.
 15. PRESERVE, PROTECT, AND MAINTAIN EXISTING LANDFILL GAS INFRASTRUCTURE.

PRODUCT LIST

CONTRACTOR IS RESPONSIBLE FOR THE PURCHASE AND INSTALLATION OF ALL PRODUCTS. SUBMIT PRODUCT INFORMATION INCLUDING COLORS AND FINISHES TO OWNER'S REPRESENTATIVE PRIOR TO PURCHASE AND INSTALLATION.

| ITEM | ITEM/MODEL | MANUFACTURER | QUANTITY | COMMENTS |
|---------------------------|------------|-------------------------|----------|--|
| BACKSTOP SYSTEM | CUSTOM | KEEPER GOALS | 2 | 20'H X 90'L FREESTANDING BACKSTOP NETTING. INSTALLATION BY MANUFACTURER. |
| CORNER FLAGS | CFO-SL | KEEPER GOALS | SET OF 4 | CONTRACTOR TO INSTALL USING DRIVEN ANCHORS |
| COMBOX FOR SYNTHETIC TURF | CB11830 | SPORTSFIELD SPECIALTIES | 1 | CONTRACTOR TO INSTALL. CONNECT TO CONDUIT. |

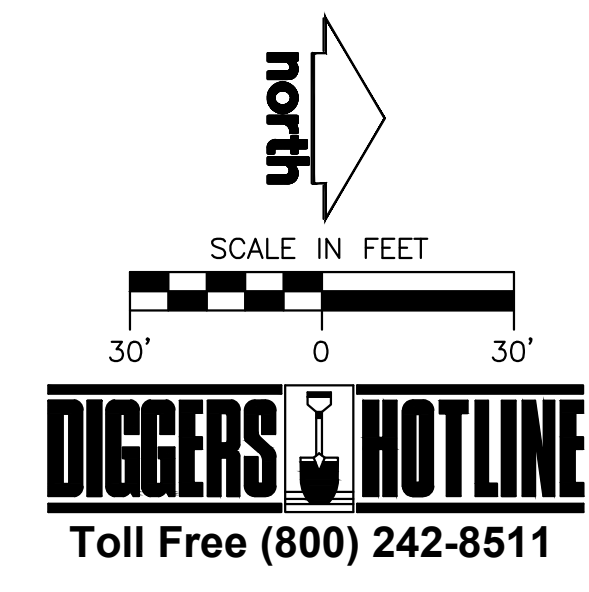

CREATE THE VISION TELL THE STORY

jsdinc.com

MILWAUKEE REGIONAL OFFICE
W238 N1610 BUSSE ROAD, SUITE 100
WAUKESHA, WISCONSIN 53188
P. 262.513.0666

CLIENT:
**CITY OF WAUKESHA
PARKS, RECREATION &
FORESTRY DEPARTMENT**

CLIENT ADDRESS:
**130 DELAFIELD STREET
WAUKESHA, WI 53188**

PROJECT:
**MINDIOLA PARK
PHASE II**

PROJECT LOCATION:
**WAUKESHA, WI
WAUKESHA COUNTY**

PLAN MODIFICATIONS:

| # | Date: | Description: |
|----|-------|--------------|
| 1 | | |
| 2 | | |
| 3 | | |
| 4 | | |
| 5 | | |
| 6 | | |
| 7 | | |
| 8 | | |
| 9 | | |
| 10 | | |
| 11 | | |
| 12 | | |
| 13 | | |
| 14 | | |
| 15 | | |

Designed By:
Reviewed By:
Approved By:

SHEET TITLE:
SITE PLAN

SHEET NUMBER:
M-C2.0

JSD PROJECT NO: 19-9387

THESE PLANS AND DESIGNS ARE COPYRIGHT PROTECTED AND MAY NOT BE USED IN WHOLE OR IN PART WITHOUT THE WRITTEN CONSENT OF JSD PROFESSIONAL SERVICES, INC.

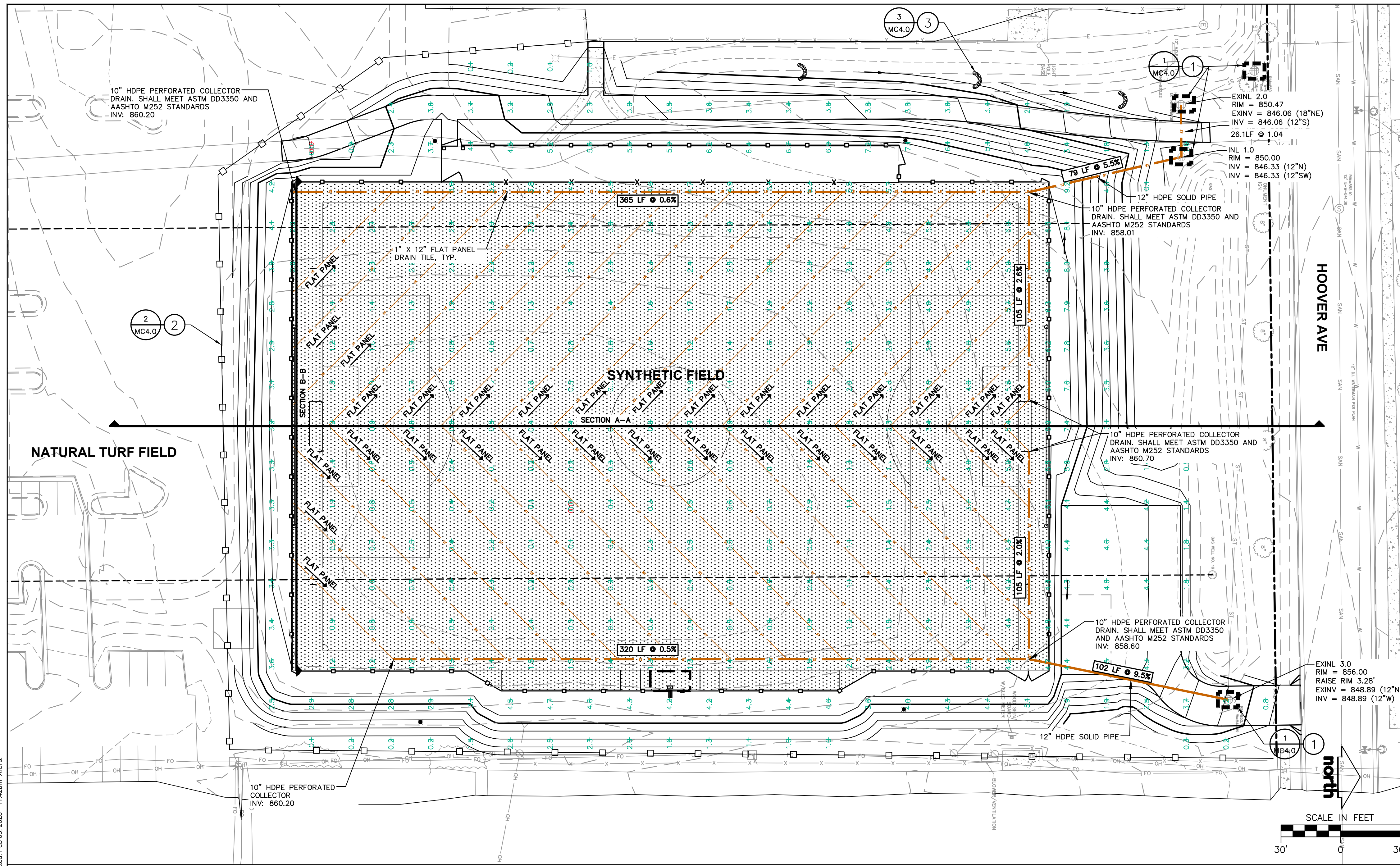

LEGEND

- PROPERTY LINE
- 6" X 12" CURB AND NAILER
- SYNTHETIC TURF SURFACING
- 4' HT. BLACK COATED CHAIN-LINK FENCE
- 8' HT. BLACK COATED CHAIN-LINK FENCE
- LIGHT POLE (REFER TO PHOTOMETRIC PLAN)
- EXISTING METHANE EXTRACTION LINE
- SOIL BORING LOCATIONS
- PROPOSED 5 FOOT CONTOUR
- PROPOSED 1 FOOT CONTOUR
- EXISTING 5 FOOT CONTOUR
- EXISTING 1 FOOT CONTOUR
- 10" HDPE PERFORATED COLLECTOR DRAIN
- 1" X 12" PERFORATED FLAT PANEL DRAIN TILE
- SILT FENCE
- CUT INTO CAP
- RIP-RAP
- SPOT ELEVATION
FG - FINISH GRADE
EC - EDGE OF CONCRETE
MATCH - MATCH EXISTING GRADE
- INLET PROTECTION
- DITCH CHECK
- 0.6' CUT
+1.4' FILL
- ELECTRICAL CONDUIT
- ABANDONED GAS/LEACHATE EXTRACTION WELL
- FLAG POLE

NOTE: CUT/FILL MARKERS SHOWN WITHIN SYNTHETIC FIELD LIMITS REPRESENT VALUES FROM PROPOSED FIELD SUBGRADE ELEVATION TO TOP OF CAP ELEVATION (EXISTING GRADE MINUS 6" OF TOPSOIL). ALL OTHER CUT/FILL MARKERS SHOWN REPRESENT VALUES FROM FINISHED GRADE TO EXISTING GRADE.

- ### KEYNOTES
1. INLET PROTECTION. REFER TO DETAIL.
 2. SILT FENCE. REFER TO DETAIL.
 3. TEMPORARY DITCH CHECK. REFER TO DETAIL.
 4. APRON ENDWALL. REFER TO DETAIL.

JSD

CREATE THE VISION TELL THE STORY

jsdinc.com

MILWAUKEE REGIONAL OFFICE
W238 N41610 BUSSE ROAD, SUITE 100
WAUKESHA, WISCONSIN 53188
P. 262.513.0666

CLIENT:
**CITY OF WAUKESHA
PARKS, RECREATION &
FORESTRY DEPARTMENT**

CLIENT ADDRESS:
**130 DELAFIELD STREET
WAUKESHA, WI 53188**

PROJECT:
**MINDIOLA PARK
PHASE II**

PROJECT LOCATION:
**WAUKESHA, WI
WAUKESHA COUNTY**

PLAN MODIFICATIONS:

| # | Date | Description |
|----|------|-------------|
| 1 | | |
| 2 | | |
| 3 | | |
| 4 | | |
| 5 | | |
| 6 | | |
| 7 | | |
| 8 | | |
| 9 | | |
| 10 | | |
| 11 | | |
| 12 | | |
| 13 | | |
| 14 | | |
| 15 | | |

Designed By:
Reviewed By:
Approved By:

SHEET TITLE:
**GRADING AND EROSION
CONTROL PLAN**

SHEET NUMBER:
M-C3.0

JSD PROJECT NO: 19-9387

SECTION A-A - CENTERLINE OF FIELD - SOUTH TO NORTH

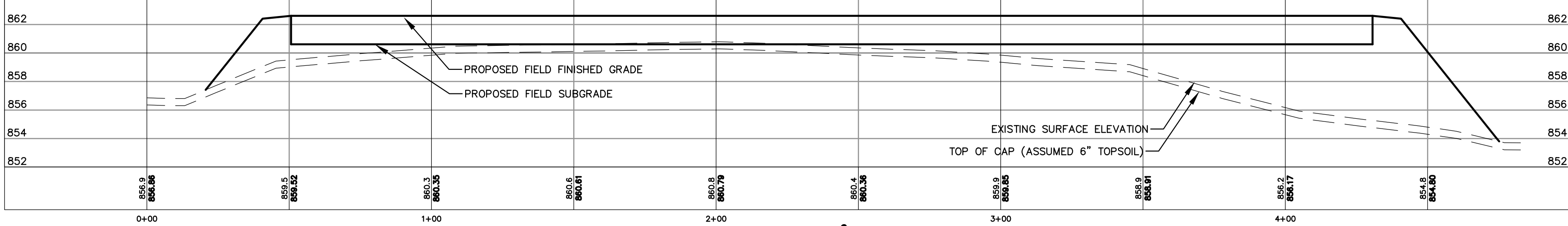

SECTION B-B - SOUTH SIDE OF FIELD - WEST TO EAST

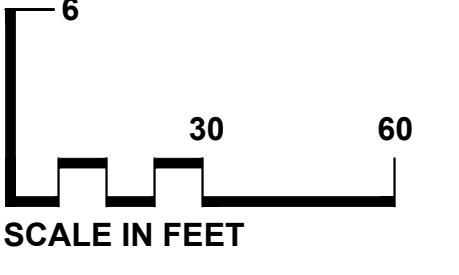
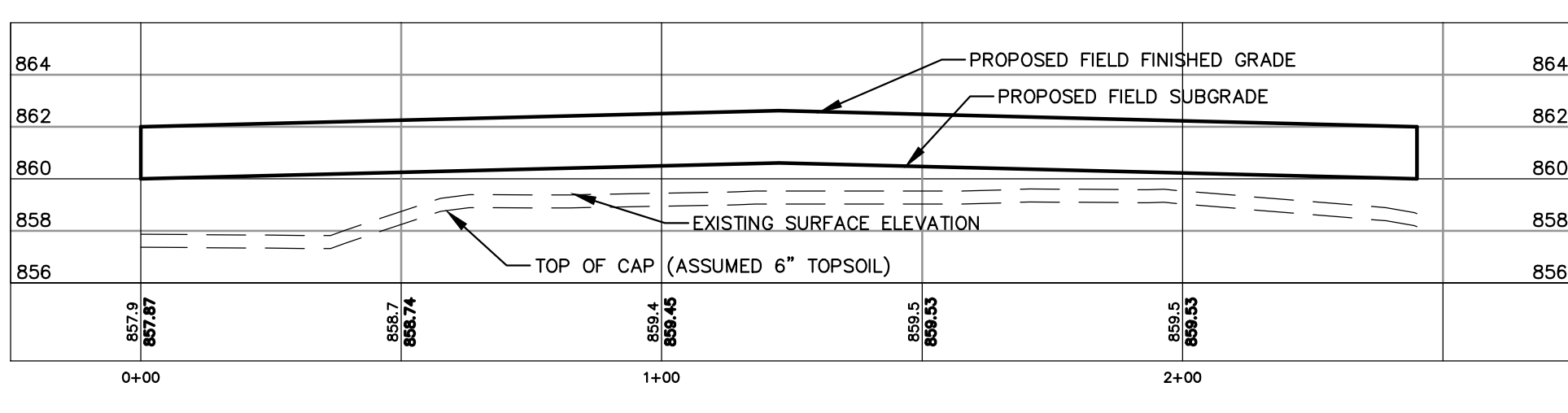

Cut/Fill Summary

| Name | Cut Factor | Fill Factor | 2d Area | Cut | Fill | Net |
|---------------------------------------|------------|-------------|--------------------------|------------------------|-------------------------|-------------------------------------|
| SYNTHETIC FIELD - STRIP TOPSOIL | 1.000 | 1.200 | 99128.25 Sq. Ft. | 1835.71 Cu. Yd. | 0.00 Cu. Yd. | 1835.71 Cu. Yd.<Cut> |
| SURROUNDING AREA - SURFACE TO SURFACE | 1.000 | 1.200 | 58774.24 Sq. Ft. | 2.63 Cu. Yd. | 8386.61 Cu. Yd. | 8383.98 Cu. Yd.<Fill> |
| SYNTHETIC FIELD - SUBGRADE TO CAP | 1.000 | 1.200 | 99128.25 Sq. Ft. | 0.02 Cu. Yd. | 9254.70 Cu. Yd. | 9254.68 Cu. Yd.<Fill> |
| Totals | | | 257030.73 Sq. Ft. | 1838.36 Cu. Yd. | 17641.31 Cu. Yd. | 15802.96 Cu. Yd.<Fill> |



File: O:\2021\110640A\DWG\Civil Sheets\2110640 - Mindiola Park Docs.dwg Layout: C3.0 G&EC User: newman Plotted: Feb 03, 2023 - 11:42am Xref's:

THESE PLANS AND DESIGNS ARE COPYRIGHT PROTECTED AND MAY NOT BE USED IN WHOLE OR IN PART WITHOUT THE WRITTEN CONSENT OF JSD PROFESSIONAL SERVICES, INC.