

THE LOCATION OF UNDERGROUND STRUCTURES OR FACILITIES SHOWN ON THE PLANS ARE BASED ON AVAILABLE RECORDS AT THE TIME OF PLAN PREPARATION & ARE NOT GUARANTEED TO BE COMPLETE OR CORRECT. THE CONTRACTOR IS RESPONSIBLE FOR CONTACTING ALL UTILITIES 72 HOURS PRIOR TO CONSTRUCTION TO DETERMINE THE EXACT LOCATION OF ALL FACILITIES AND TO PROVIDE ADEQUATE PROTECTION DURING THE COURSE OF THE WORK.

ESTIMATE OF QUANTITIES	
1-1/2" ASPHALT SURFACE COURSE	2,543 SQ YDS
1-1/2" ASPHALT BINDER COURSE	2,543 SQ YDS
8" COMPACTED AGGREGATE BASE COURSE	2,543 SQ YDS
6" BARRIER CURB	1034 LIN FT
21" STORM SEWER (GRAVEL BKFL)	325 LIN FT
21" STORM SEWER (SPOIL BKFL)	17 LIN FT
8" P.V.C. STORM SEWER (SPOIL BKFL)	32 LIN FT
48" STORM SEWER MANHOLE	3 EACH
STANDARD STORM SEWER CATCH BASIN	2 EACH
21" R.C. END SECTION (W/GRATE)	1 EACH
3'X3' R.C. BOX STRUCTURE	1 EACH

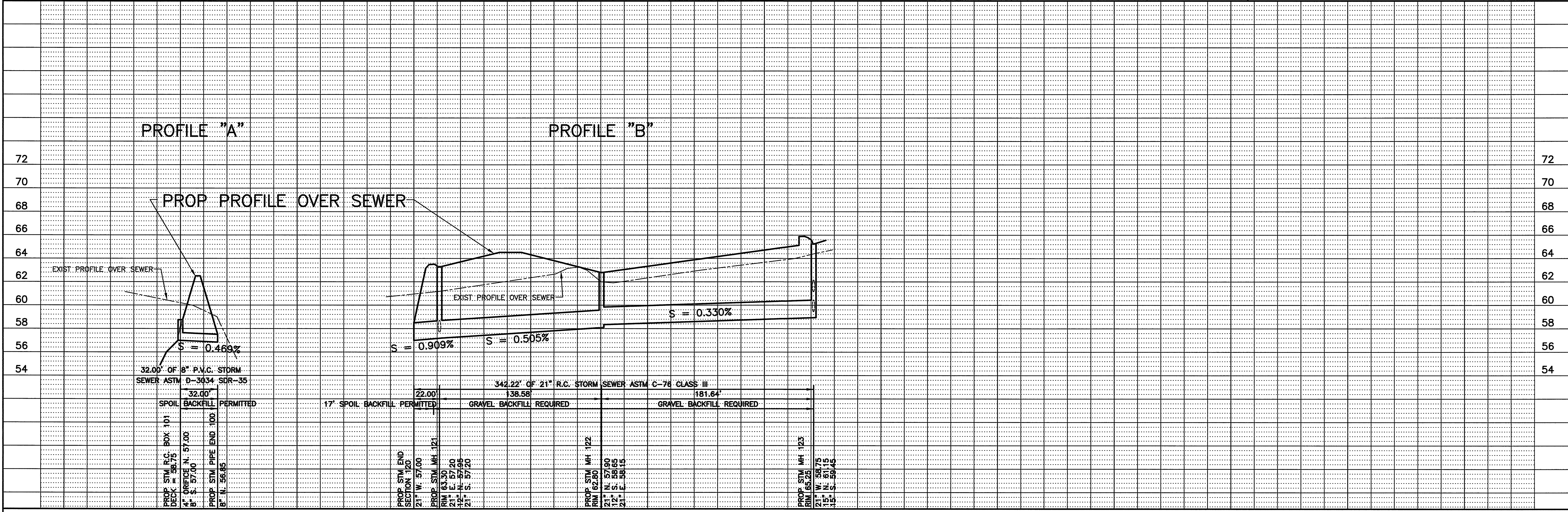

NO.	REVISIONS	BY	DATE
1	ADDED OWNERS REVISIONS	KKK	8-04-06
2	ADDED GENERAL REVISIONS	KKK	11-07-06
3	ADDED GENERAL REVISIONS	KKK	12-20-06

DESIGNED BY:
K. K. KLIMECK

DRAWN BY:
K. K. KLIMECK

CHECKED BY:
K. K. KLIMECK

SCALE:
1" = 40' HORIZ.
1" = 4' VERT.

DATE:
FEBRUARY 24, 2006



PIONEER ENGINEERING AND SURVEYING, L.L.C.
CONSULTANTS IN SUBDIVISIONS AND COMMERCIAL DEVELOPMENTS
3902 C.T.H. "B"
JOHNSON CREEK, WI. 53038
(920) 699 - 3330 FAX: 699 - 3332

THE RIDGE AT WOODLAND CREEK CONDOMINIUMS STORM SEWER & PAVING PLAN

IN: EASEMENTS FROM: END SECTION 120 TO: MH 123

IN: EASEMENTS FROM: END OF PIPE 100 TO: R.C. BOX 101

MUNIC. PROJ. NO.	PIONEER PROJ. NO.
CITY OF WAUKESHA	05-05
APPROVED BY	PIONEER SHT. NO.
CITY ENGINEER DATE	PAGE 3 OF 4
	PIONEER FILE NO.
	05-05

D:\0505\STW3