

WHILE THE SAME RESOURCES AS THE EXISTING ONES

Drives NOT PROPERTY

EXISTING STAIRS STRADDLES 7 1/2 H STRADDLES 11 1/2 D

CITY SIDE WALK

NOTE: REASON FOR MOVING STAIRS IS BECAUSE THERE IS NO ACCESS FROM FRONT OF BUILDING TO BACK.

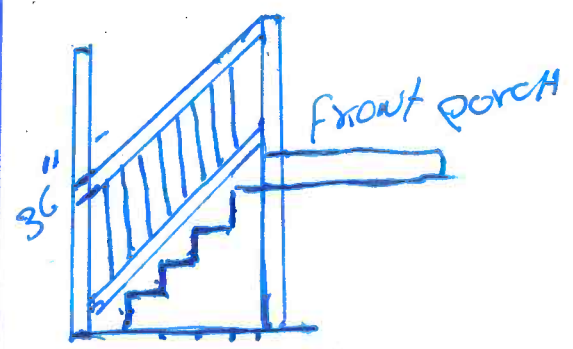
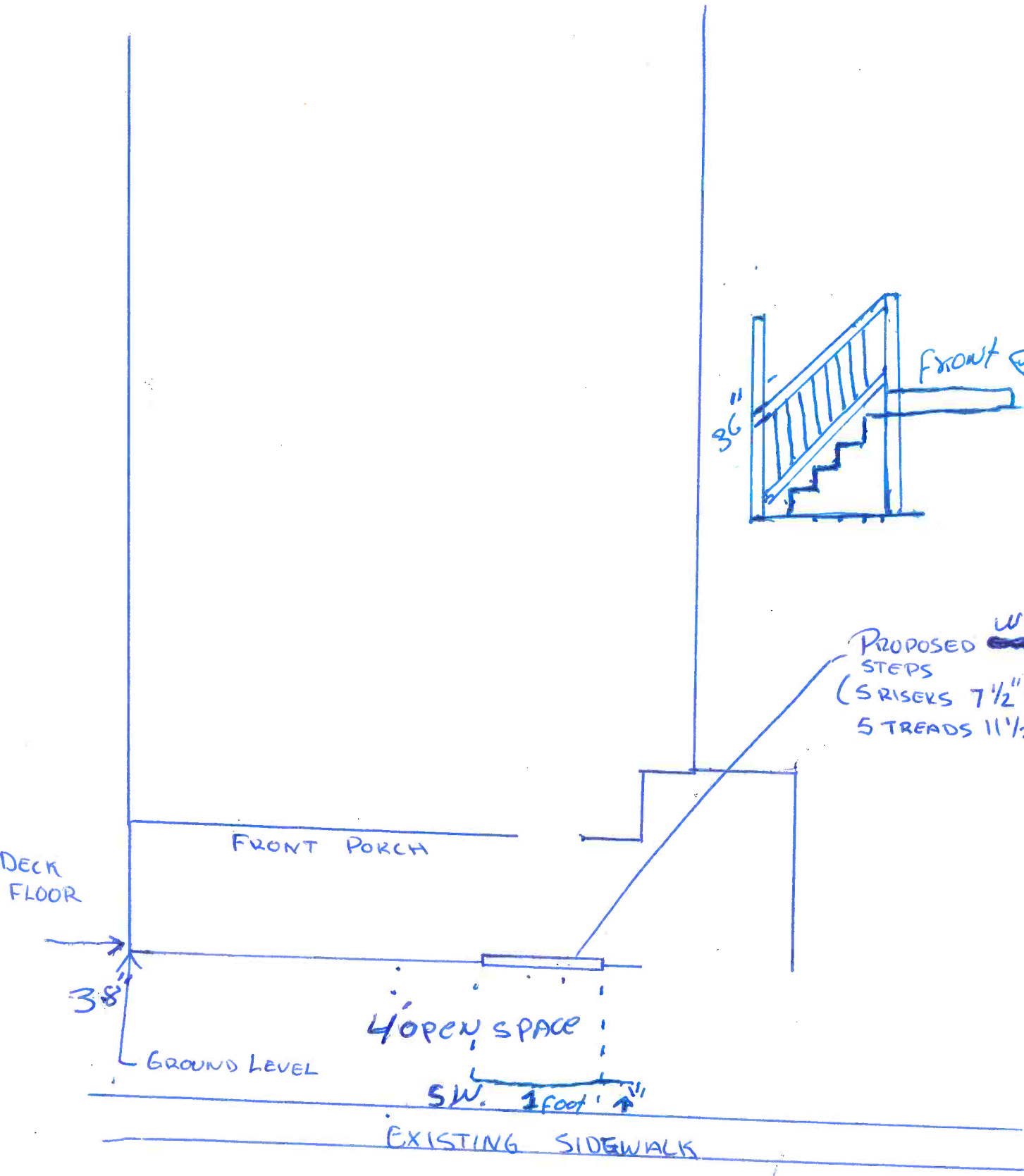

PROPOSED ~~WOOD~~ WOOD  
STEPS  
(5 RISES 7 1/2" H &  
5 TREADS 11 1/2")

OPEN SPACE

SW. 1 foot

EXISTING SIDEWALK