

PROPOSED CONCEPT PLAN - A

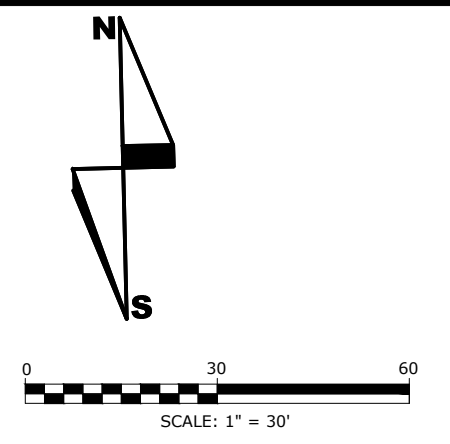

Property Owner:
Todd and Patricia Klotz
W274 S4640 Saylesville Rd.
Waukesha, WI 53189

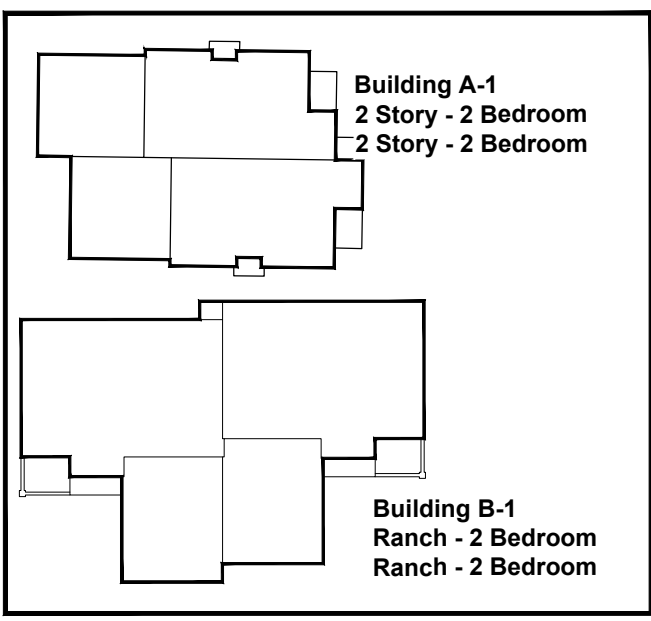

PROPOSED BUILDING STYLES

Site Calculations:
Proposed Condo Development
Proposed Units = 32
2.5 units per acre

Total acreage is 12.89 acres / 100%
Proposed Impervious Surface = 3.0 acres / 23%
Remaining Open Space = 9.89 acres / 77%

Proposed Parking:
2 per unit inside garage = 64
additional surface stalls = 21
Total proposed stalls = 85

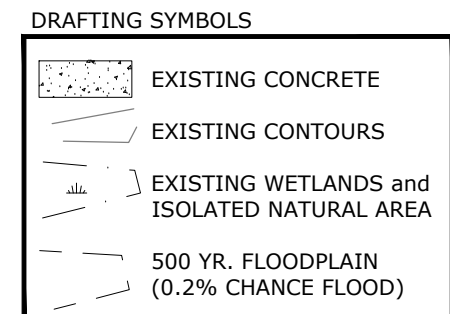

General Notes:

1. Wetlands and Floodplain taken from Waukesha County GIS data.
2. Boundary and contours taken from Ellena Engineering Concept Plan dated Jan. 18 2019.
3. Proposed development to be served by city water and sewer.

RIVER CROSSING
ADDN NO. 1
LOT 163

20' Drainage Easement

20' Drainage Easement

20' Drainage Easement

20' Drainage Easement

20' Drainage Easement

20' Drainage Easement

20' Drainage Easement

20' Drainage Easement

20' Drainage Easement

20' Drainage Easement

20' Drainage Easement

20' Drainage Easement

20' Drainage Easement

20' Drainage Easement

20' Drainage Easement

20' Drainage Easement

20' Drainage Easement

20' Drainage Easement

20' Drainage Easement

20' Drainage Easement

UNPLATTED LANDS

UNPLATTED LANDS