

**Amendment to Contract  
City of Waukesha – Everstream GLC Holding Company LLC**

This Amendment to Contract, referred to herein as the Amendment, is executed by and between the City of Waukesha, a Wisconsin municipal corporation, 201 Delafield Street, Waukesha, Wisconsin 53188, referred to as the City; and Everstream GLC Holding Company LLC, 1228 Euclid Avenue, Suite 250, Cleveland, Ohio 44115, referred to as Everstream. Together the City and Everstream are referred to as the Parties.

**Recitals**

The Parties executed a Contract titled “Fiber Optics Communications Facilities Joint Construction and Use” on January 23, 2020. The Contract provides, among other things, that Everstream will install fiber-optic cables around the City for its own use, and also install fiber-optic cables that will be conveyed to the City for the City’s use, in consideration of Everstream being able to install its cables in City-owned underground ducts.

A portion of that work involved installation of cable along St. Paul Avenue, which coincidentally was scheduled for reconstruction work that would interfere significantly with cable installation.

Therefore, the Parties executed another contract, also titled “Fiber Optics Communications Facilities Joint Construction and Use,” on September 27, 2021, which re-routed the cable-installation work along St. Paul Avenue to North Street, avoiding the reconstruction work. That cable has not yet been installed.

As part of the St. Paul Avenue reconstruction, the City installed underground ducts having the capacity to carry the cables that Everstream would have installed along North Street. The City is willing to allow Everstream to install cables in the City’s ducts along St. Paul Avenue instead of the re-routed location on North Street.

Now, therefore, the Parties agree and contract as follows:

1. **Amendment of Contract.** The Fiber Optics Communications Facilities Joint Construction and Use contract dated September 27, 2021, referred to herein as the Contract, is amended as follows:
  - a. Sheet OV1 of Exhibit A to the Contract is deleted.
  - b. Sheets 24, 25, and 26 of Exhibit A to the Contract are deleted and replaced with Sheets 24, 25, and 26 attached to this Amendment, which shall be incorporated into Exhibit A to the Contract.
  - c. All references to “48 SMFO” in Sheets 24, 25, and 26 attached to this Amendment are deemed to be “installed for Waukesha” for purposes of section 3 of the Contract.
  - d. All other terms and conditions of the Contract remain in effect and enforceable, except as specifically amended by this Amendment.
2. **Testing and Conveyance of Cables.** All cables that are to be conveyed to the City shall be tested and conveyed to the City no later than 30 days after their installation in City-owned duct.

**City of Waukesha**

\_\_\_\_\_  
By Shawn N. Reilly, Mayor  
Date:\_\_\_\_\_

\_\_\_\_\_  
Attested by Gina L. Kozlik, City Clerk  
Date:\_\_\_\_\_

**Everstream GLC Holding Company LLC**

By Shad Garcia, Director, Field Services

Date: \_\_\_\_\_

See Sheet 25

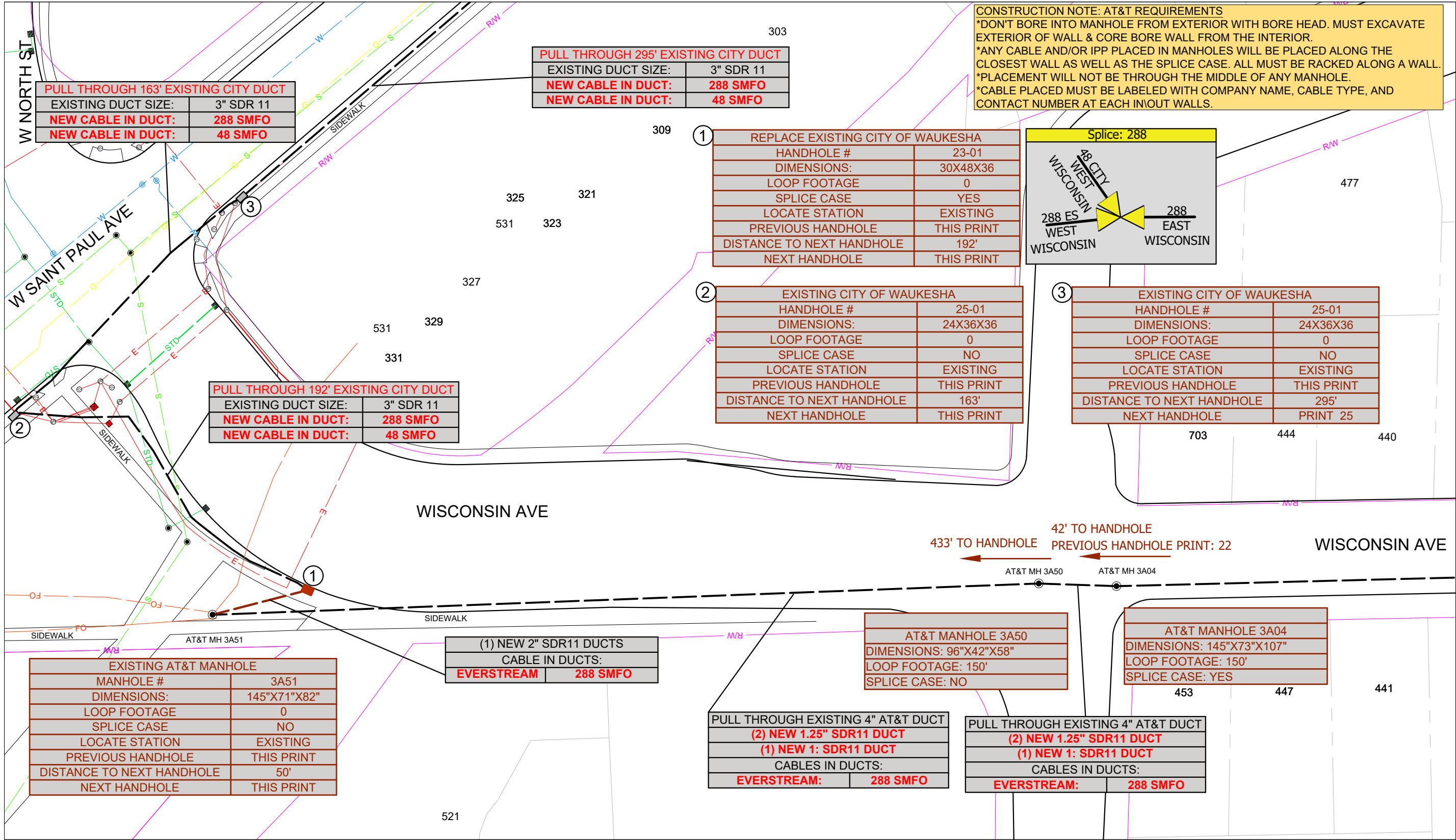

**CONSTRUCTION NOTE: AT&T REQUIREMENTS**  
 \*DON'T BORE INTO MANHOLE FROM EXTERIOR WITH BORE HEAD. MUST EXCAVATE EXTERIOR OF WALL & CORE BORE WALL FROM THE INTERIOR.  
 \*ANY CABLE AND/OR IPP PLACED IN MANHOLES WILL BE PLACED ALONG THE CLOSEST WALL AS WELL AS THE SPLICE CASE. ALL MUST BE RACKED ALONG A WALL.  
 \*PLACEMENT WILL NOT BE THROUGH THE MIDDLE OF ANY MANHOLE.  
 \*CABLE PLACED MUST BE LABELED WITH COMPANY NAME, CABLE TYPE, AND CONTACT NUMBER AT EACH IN/OUT WALLS.

**PULL THROUGH 163' EXISTING CITY DUCT**

EXISTING DUCT SIZE:	3" SDR 11
<b>NEW CABLE IN DUCT:</b>	<b>288 SMFO</b>
<b>NEW CABLE IN DUCT:</b>	<b>48 SMFO</b>

**PULL THROUGH 295' EXISTING CITY DUCT**

EXISTING DUCT SIZE:	3" SDR 11
<b>NEW CABLE IN DUCT:</b>	<b>288 SMFO</b>
<b>NEW CABLE IN DUCT:</b>	<b>48 SMFO</b>

**PULL THROUGH 192' EXISTING CITY DUCT**

EXISTING DUCT SIZE:	3" SDR 11
<b>NEW CABLE IN DUCT:</b>	<b>288 SMFO</b>
<b>NEW CABLE IN DUCT:</b>	<b>48 SMFO</b>

① **REPLACE EXISTING CITY OF WAUKESHA**

HANDHOLE #	23-01
DIMENSIONS:	30X48X36
LOOP FOOTAGE	0
SPLICE CASE	YES
LOCATE STATION	EXISTING
PREVIOUS HANDHOLE	THIS PRINT
DISTANCE TO NEXT HANDHOLE	192'
NEXT HANDHOLE	THIS PRINT

② **EXISTING CITY OF WAUKESHA**

HANDHOLE #	25-01
DIMENSIONS:	24X36X36
LOOP FOOTAGE	0
SPLICE CASE	NO
LOCATE STATION	EXISTING
PREVIOUS HANDHOLE	THIS PRINT
DISTANCE TO NEXT HANDHOLE	163'
NEXT HANDHOLE	THIS PRINT

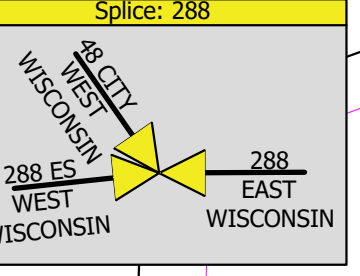

③ **EXISTING CITY OF WAUKESHA**

HANDHOLE #	25-01
DIMENSIONS:	24X36X36
LOOP FOOTAGE	0
SPLICE CASE	NO
LOCATE STATION	EXISTING
PREVIOUS HANDHOLE	THIS PRINT
DISTANCE TO NEXT HANDHOLE	295'
NEXT HANDHOLE	PRINT 25

**EXISTING AT&T MANHOLE**

MANHOLE #	3A51
DIMENSIONS:	145"X71"X82"
LOOP FOOTAGE	0
SPLICE CASE	NO
LOCATE STATION	EXISTING
PREVIOUS HANDHOLE	THIS PRINT
DISTANCE TO NEXT HANDHOLE	50'
NEXT HANDHOLE	THIS PRINT

**(1) NEW 2" SDR11 DUCTS**

CABLE IN DUCTS:	<b>EVERSTREAM</b>   <b>288 SMFO</b>
-----------------	-------------------------------------

**AT&T MANHOLE 3A50**

DIMENSIONS:	96"X42"X58"
LOOP FOOTAGE:	150'
SPLICE CASE:	NO

**AT&T MANHOLE 3A04**

DIMENSIONS:	145"X73"X107"
LOOP FOOTAGE:	150'
SPLICE CASE:	YES

**PULL THROUGH EXISTING 4" AT&T DUCT**

<b>(2) NEW 1.25" SDR11 DUCT</b>	
<b>(1) NEW 1" SDR11 DUCT</b>	
CABLES IN DUCTS:	<b>EVERSTREAM:</b>   <b>288 SMFO</b>

**PULL THROUGH EXISTING 4" AT&T DUCT**

<b>(2) NEW 1.25" SDR11 DUCT</b>	
<b>(1) NEW 1" SDR11 DUCT</b>	
CABLES IN DUCTS:	<b>EVERSTREAM:</b>   <b>288 SMFO</b>



Multimedia Communications & Engineering, Inc.  
 PO Box 11064 Green Bay, WI 54307  
 P: 920.301.7900 | 877.870.6968

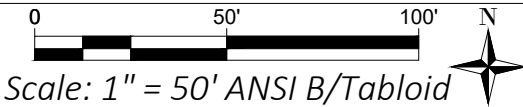

**EVERSTREAM  
 PHASE 2**

Sheet Group:  
**1:50 Scaled Plans**

Sheet ID:  
**24**

Permits required on this sheet: AT&T OCCUPANCY PERMIT/CITY OF WAUKESHA

Print Date: 2.28.2023

Page 25 of 72

See Sheet 26

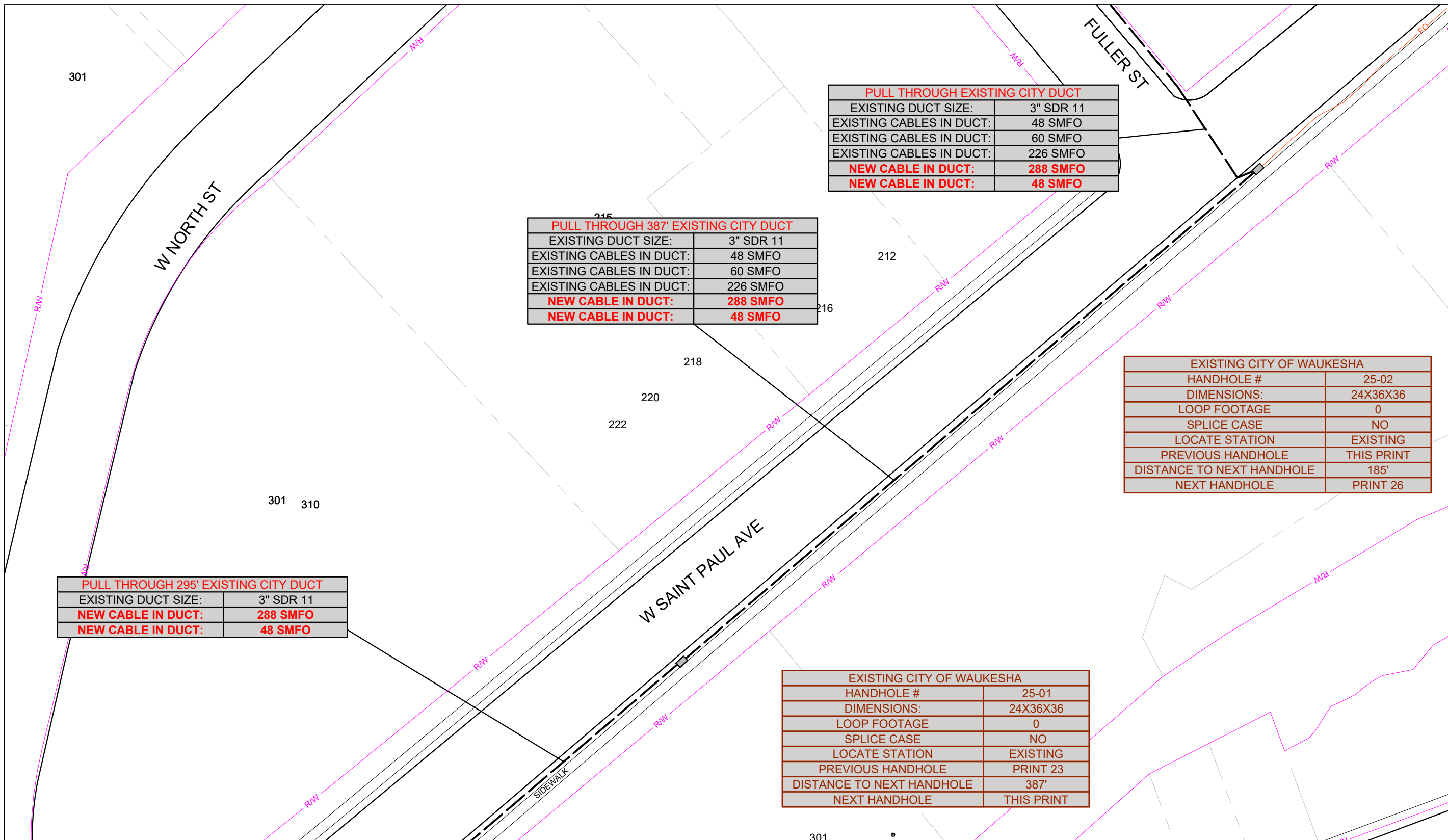

PULL THROUGH EXISTING CITY DUCT	
EXISTING DUCT SIZE:	3" SDR 11
EXISTING CABLES IN DUCT:	48 SMFO
EXISTING CABLES IN DUCT:	60 SMFO
EXISTING CABLES IN DUCT:	226 SMFO
<b>NEW CABLE IN DUCT:</b>	<b>288 SMFO</b>
<b>NEW CABLE IN DUCT:</b>	<b>48 SMFO</b>

PULL THROUGH 387' EXISTING CITY DUCT	
EXISTING DUCT SIZE:	3" SDR 11
EXISTING CABLES IN DUCT:	48 SMFO
EXISTING CABLES IN DUCT:	60 SMFO
EXISTING CABLES IN DUCT:	226 SMFO
<b>NEW CABLE IN DUCT:</b>	<b>288 SMFO</b>
<b>NEW CABLE IN DUCT:</b>	<b>48 SMFO</b>

EXISTING CITY OF WAUKESHA	
HANDHOLE #	25-02
DIMENSIONS:	24X36X36
LOOP FOOTAGE	0
SPLICE CASE	NO
LOCATE STATION	EXISTING
PREVIOUS HANDHOLE	THIS PRINT
DISTANCE TO NEXT HANDHOLE	185'
NEXT HANDHOLE	PRINT 26

PULL THROUGH 295' EXISTING CITY DUCT	
EXISTING DUCT SIZE:	3" SDR 11
<b>NEW CABLE IN DUCT:</b>	<b>288 SMFO</b>
<b>NEW CABLE IN DUCT:</b>	<b>48 SMFO</b>

EXISTING CITY OF WAUKESHA	
HANDHOLE #	25-01
DIMENSIONS:	24X36X36
LOOP FOOTAGE	0
SPLICE CASE	NO
LOCATE STATION	EXISTING
PREVIOUS HANDHOLE	PRINT 23
DISTANCE TO NEXT HANDHOLE	387'
NEXT HANDHOLE	THIS PRINT

See Sheet 24



Multimedia Communications & Engineering, Inc.  
 PO Box 11064 Green Bay, WI 54307  
 P: 920.301.7900 | 877.870.6968

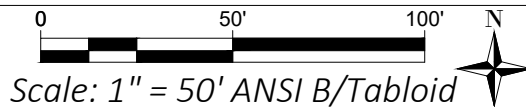

EVERSTREAM  
 PHASE 2

Sheet Group:  
 1:50 Scaled Plans

Sheet ID:  
 25

Print Date: 2.28.2023

Page 27 of 72

Permits required on this sheet: CITY OF WAUKESHA

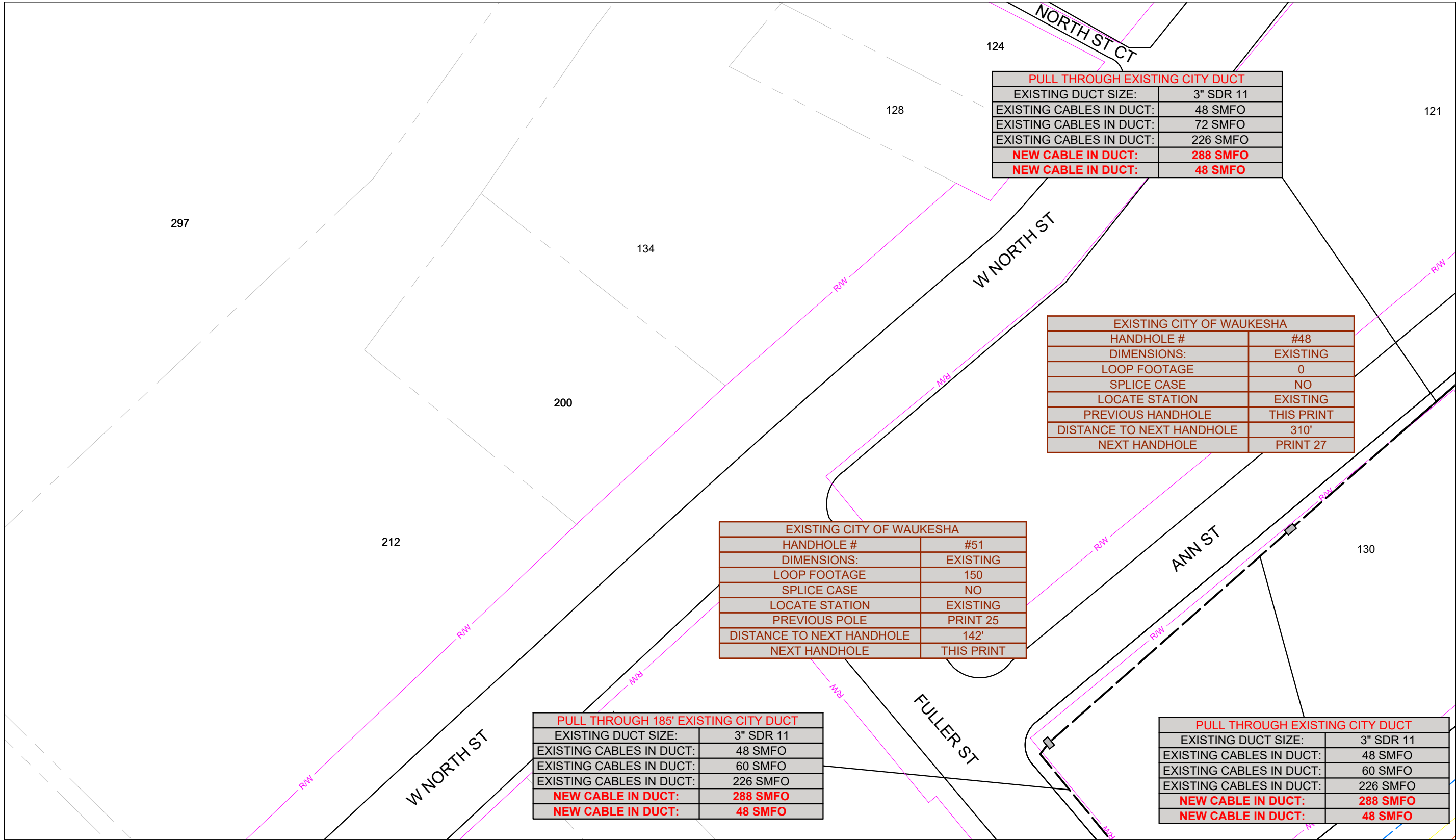

PULL THROUGH EXISTING CITY DUCT	
EXISTING DUCT SIZE:	3" SDR 11
EXISTING CABLES IN DUCT:	48 SMFO
EXISTING CABLES IN DUCT:	72 SMFO
EXISTING CABLES IN DUCT:	226 SMFO
<b>NEW CABLE IN DUCT:</b>	<b>288 SMFO</b>
<b>NEW CABLE IN DUCT:</b>	<b>48 SMFO</b>

EXISTING CITY OF WAUKESHA	
HANDHOLE #	#48
DIMENSIONS:	EXISTING
LOOP FOOTAGE	0
SPLICE CASE	NO
LOCATE STATION	EXISTING
PREVIOUS HANDHOLE	THIS PRINT
DISTANCE TO NEXT HANDHOLE	310'
NEXT HANDHOLE	PRINT 27

EXISTING CITY OF WAUKESHA	
HANDHOLE #	#51
DIMENSIONS:	EXISTING
LOOP FOOTAGE	150
SPLICE CASE	NO
LOCATE STATION	EXISTING
PREVIOUS POLE	PRINT 25
DISTANCE TO NEXT HANDHOLE	142'
NEXT HANDHOLE	THIS PRINT

PULL THROUGH 185' EXISTING CITY DUCT	
EXISTING DUCT SIZE:	3" SDR 11
EXISTING CABLES IN DUCT:	48 SMFO
EXISTING CABLES IN DUCT:	60 SMFO
EXISTING CABLES IN DUCT:	226 SMFO
<b>NEW CABLE IN DUCT:</b>	<b>288 SMFO</b>
<b>NEW CABLE IN DUCT:</b>	<b>48 SMFO</b>

PULL THROUGH EXISTING CITY DUCT	
EXISTING DUCT SIZE:	3" SDR 11
EXISTING CABLES IN DUCT:	48 SMFO
EXISTING CABLES IN DUCT:	60 SMFO
EXISTING CABLES IN DUCT:	226 SMFO
<b>NEW CABLE IN DUCT:</b>	<b>288 SMFO</b>
<b>NEW CABLE IN DUCT:</b>	<b>48 SMFO</b>

See Sheet 27

See Sheet 25



Multimedia Communications & Engineering, Inc.  
 PO Box 11064 Green Bay, WI 54307  
 P: 920.301.7900 | 877.870.6968

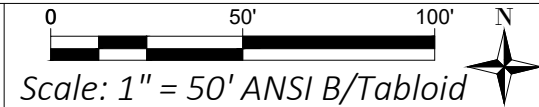

EVERSTREAM  
 PHASE 2

Sheet Group:  
 1:50 Scaled Plans

Sheet ID:  
 26

Permits required on this sheet: CITY OF WAUKESHA

Print Date: 2.28.2023

Page 28 of 72