

**BOLLARDS:**

- TYPE "A":**  
6"x9" CONCRETE FILLED PIPE 48" DOWN AND 60" UP FROM SLAB FINISH GRADE. SURROUND WITH 12" Ø CONC. PIER. SPACING AND LOCATIONS AS NOTED.
- TYPE "B":**  
4"x15'-6" TALL PIPE. CONCRETE FILLED TO 48" ABOVE CONCRETE SLAB FINISH GRADE. COUPLING SOCKET WELD AT JOINT. SET 48" BELOW GRADE AND 138" UP FROM SLAB FINISH.

**EQUIPMENT:**

- Jet A Tank:**  
15,000 gallon, 8'X40' UL 142 Flameshield Double Wall with Sloped saddles, external tank primed and coated with white epoxy paint. Internal tank blasted and lined with Phenicon HS epoxy lining, 3" floating suction system, (2) 24" manways, 4" water sump, water sump stinger with hand pump and 69" high staircase with 36"x36"x42"h step-off platform for tank sump testing.
- AvGas Tank:**  
15,000 gallon, 8'X40' UL 142 Flameshield Double Wall with Sloped saddles, external tank primed and coated with white epoxy paint. 24" manway, 4" water sump, water sump stinger with hand pump and 69" high staircase with 36"x36"x42"h step-off platform for tank sump testing.
- 24/7 P.O.S. FUEL MANAGEMENT SYSTEM:**  
FuelMaster 2560PLUSG retail and FBO operated system to authorize, track, and charge fuel to proprietary, fleet owned, or retail Major Credit Cards purchases. System to accept Spring City issued Smart Cards, MasterCard, and Visa Credit Cards. System to have a large remote digital "Gallons" and "Dollar Amount" display and signage to have "Price Per Gallon" flip numbers, Safety Instructions, and Refueling Procedures posted.
- Stainless Steel Jet A Filter Cabinet and Stainless Steel Meter Cabinet**  
Remote 3" fill through 20 gallon spill containers to a heated filter cabinet, suction drawn in through a Velcon #HV162 separator filter and water separator vessel using a stationary 10 HP, 230V 3-Phase Backmer GX3E and pushed up to the tank fill. Same pump would be used to draw fuel from tanks 3" floating suction system to a Spring City single point bulk truck loading in the same cabinet. Another meter cabinet would be used for retail self serve metered over wing refueling.
- Filtered tanker truck off-loading, target to be 120 - 140 GPM into the tank.
  - Filtered Spring City bulk truck single point refueling target to be 60 -70 GPM with 1.5"x100' Hannay hose reel with explosion proof electric rewind and certified 1.5"x100' hose
  - Filtered retail or proprietary jet over wing refueling target to be 30-40 GPM with 1.5"x100' Hannay hose reel with explosion proof electric rewind and 1.25" X100' certified hose with 1.5" OPW #295SAJ nozzle.
- Stainless Steel AvGas Filter and Meter Cabinet:**  
Remote 3" fill through 20 gallon spill containers to tank using off load tanker truck pump. Tank to have a 1.5 HP, 2" submersible aviation fuel designed pressure supply line to a meter cabinet system run through a 1.5" Velcon VF61 water separator and filters for retail self serve metered over wing refueling. Hannay hose reel with explosion proof electric rewind with certified 1"x75' hose and 1" OPW over wing nozzle with deadmen grounding system.
- Overfill airplane refueling target out of an OPW #275 1" nozzle to be 15-30 GPM
- 24/7 P.O.S. FUEL MANAGEMENT SYSTEM:**  
FuelMaster 2560PLUSG retail and FBO operated system to authorize, track, and charge fuel to proprietary, fleet owned, or retail Major Credit Cards purchases. System to accept Spring City issued Smart Cards, MasterCard, and Visa Credit Cards. System to have a large remote digital "Gallons" and "Dollar Amount" display and signage to have "Price Per Gallon" flip numbers, Safety Instructions, and Refueling Procedures posted.

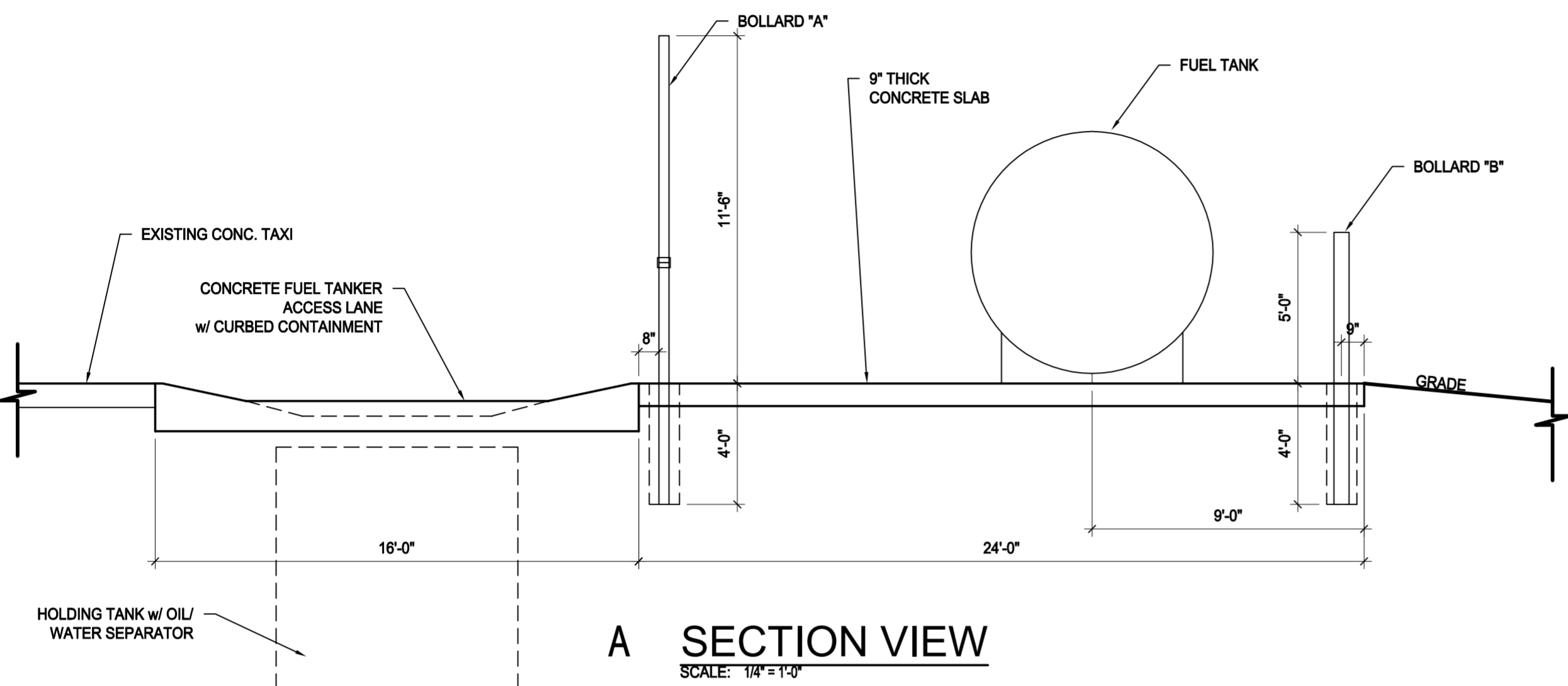

**A SECTION VIEW**  
SCALE: 1/4" = 1'-0"

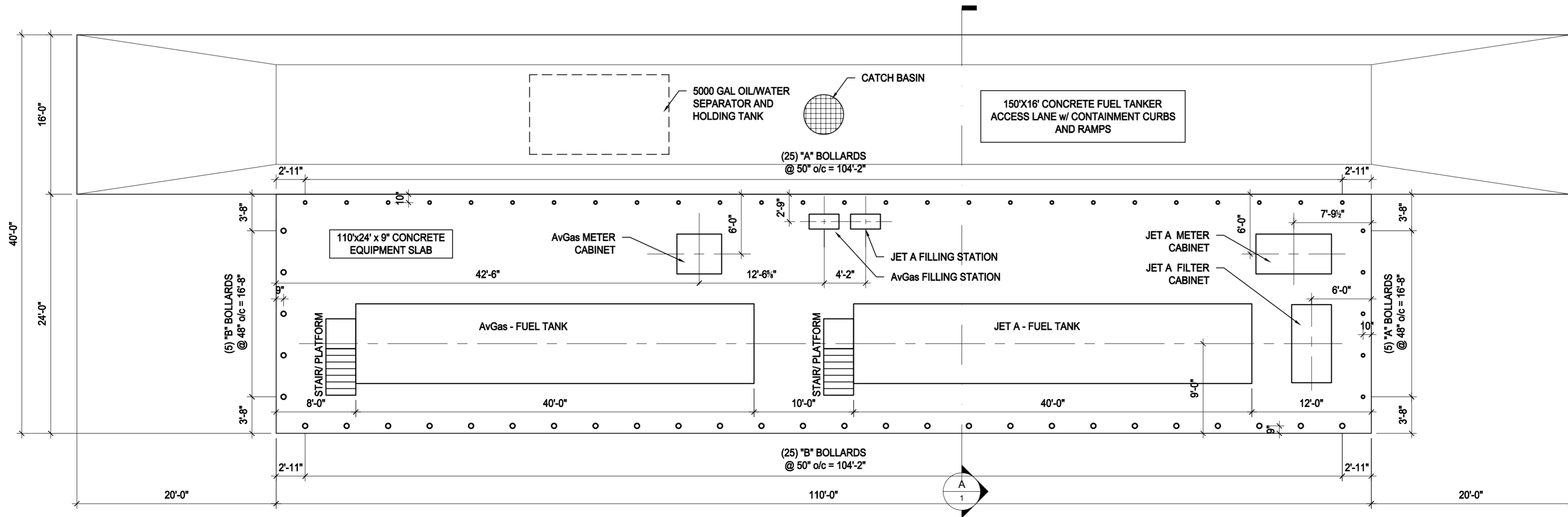

**PLAN VIEW**  
SCALE: 1/8" = 1'-0"

REVISIONS		DATE
NUMBER	DESCRIPTION	

Date: 9-24-2018  
Project: 2018-08.008  
Drawn by: MAP  
Checked by: MAP  
SHEET NUMBER