



eppstein uhen : architects

milwaukee 333 East Chicago Street
Milwaukee, Wisconsin 53202
telephone 414.271.5350
madison 309 West Johnson Street, Suite 202
Madison, Wisconsin 53703
telephone 608.442.5350

PROJECT INFORMATION

WMH HEART AND VASCULAR CENTER

725 American Avenue
Waukesha, WI 53188

ISSUANCE AND REVISIONS

DATE	DESCRIPTION
06/28/2017	PLAN COMMISSION - PRELIMINARY REVIEW

KEY PLAN

SHEET INFORMATION

**PROGRESS DOCUMENTS
NOT FOR CONSTRUCTION**
These documents reflect progress and intent and may be subject to change, including additional detail. These are not final construction documents and should not be used for final bidding or construction-related purposes.

PROJECT MANAGER TB
PROJECT NUMBER 16375

SCHEMATIC FLOOR PLAN

DO100

© Eppstein Uhen Architects, Inc.

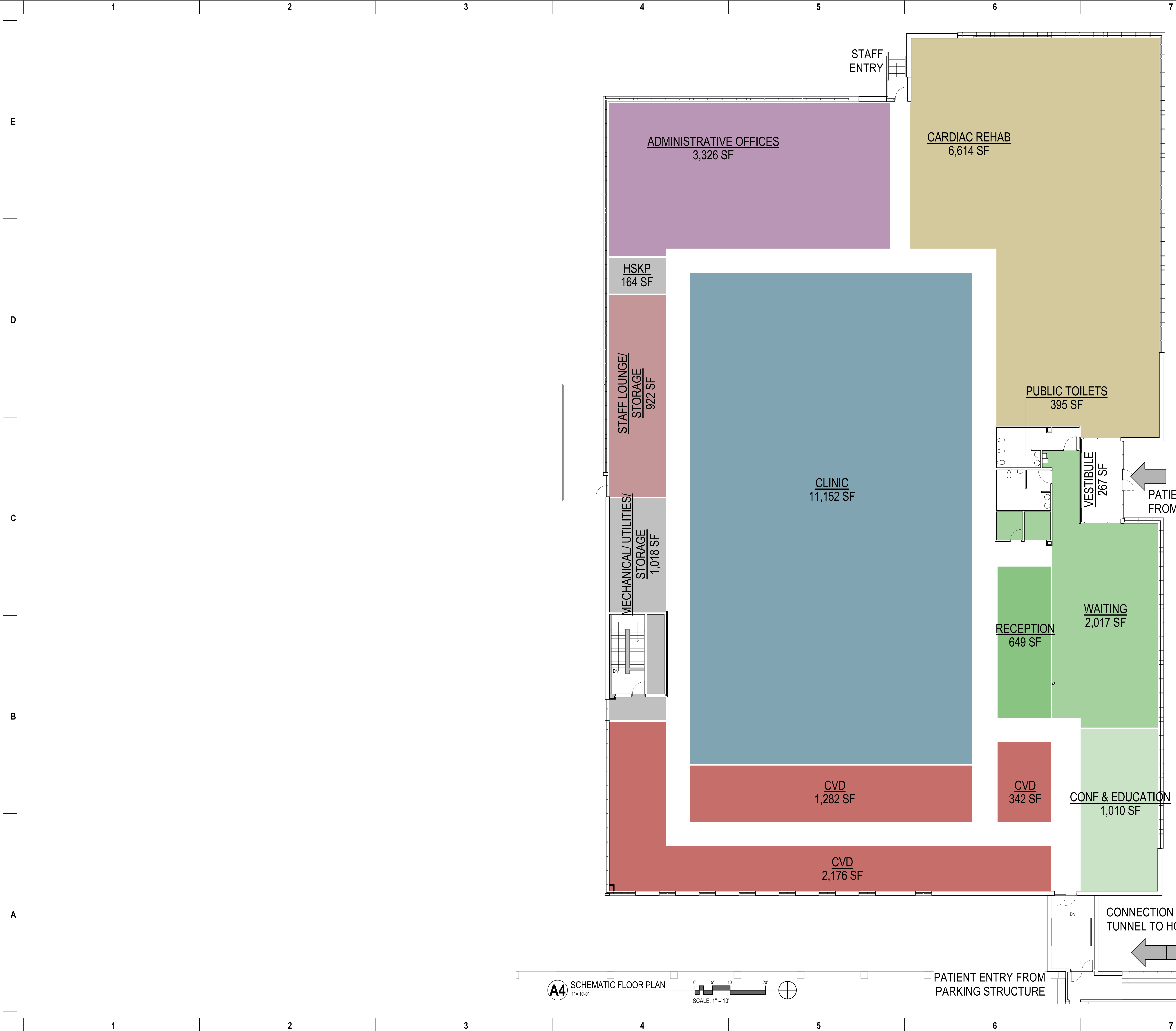

A4 SCHEMATIC FLOOR PLAN
1" = 10'-0"

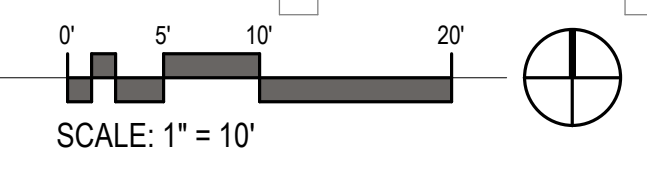

PATIENT ENTRY FROM PARKING STRUCTURE

CONNECTION TO EXISTING TUNNEL TO HOSPITAL

PATIENT ENTRY FROM SURFACE LOT

STAFF ENTRY

ADMINISTRATIVE OFFICES
3,326 SF

CARDIAC REHAB
6,614 SF

HSKP
164 SF

STAFF LOUNGE/
STORAGE
922 SF

MECHANICAL/UTILITIES/
STORAGE
1,018 SF

CLINIC
11,152 SF

PUBLIC TOILETS
395 SF

VESTIBULE
267 SF

RECEPTION
649 SF

WAITING
2,017 SF

CVD
1,282 SF

CVD
342 SF

CONF & EDUCATION
1,010 SF

CVD
2,176 SF

E

D

C

B

A

1

2

3

4

5

6

7

1

2

3

4

5

6

7