

P:\31\4015\1\dwg\Shops\31000000 - ALTERNATE NO 2.dwg SITE PLAN 1/17/2014 1:44:16 PM Job

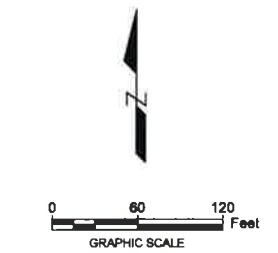
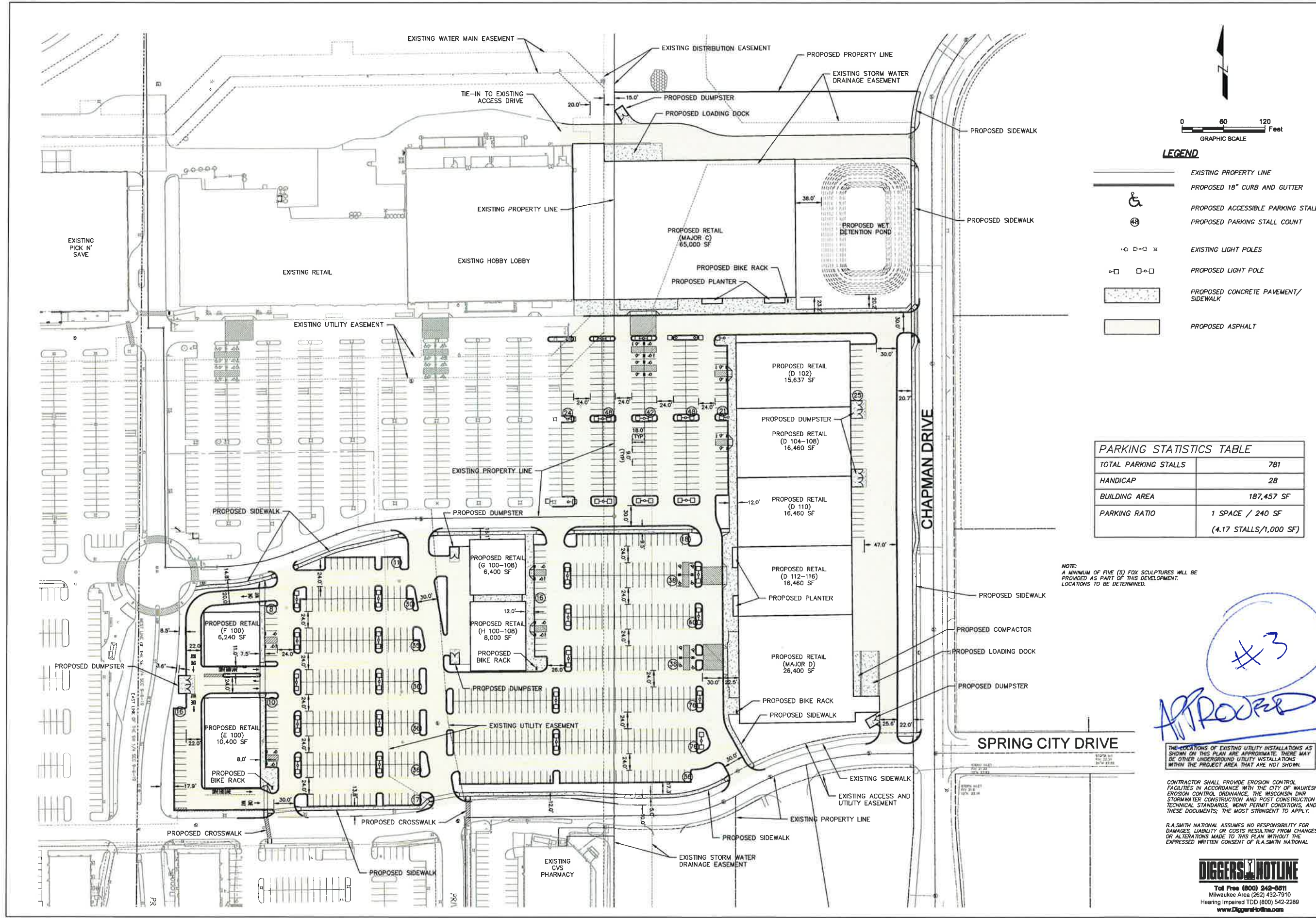

LEGEND

- EXISTING PROPERTY LINE
- PROPOSED 18" CURB AND GUTTER
- PROPOSED ACCESSIBLE PARKING STALL
- PROPOSED PARKING STALL COUNT
- EXISTING LIGHT POLES
- PROPOSED LIGHT POLE
- PROPOSED CONCRETE PAVEMENT/SIDEWALK
- PROPOSED ASPHALT

PARKING STATISTICS TABLE

TOTAL PARKING STALLS	781
HANDICAP	28
BUILDING AREA	187,457 SF
PARKING RATIO	1 SPACE / 240 SF (4.17 STALLS/1,000 SF)

NOTE:
A MINIMUM OF FIVE (5) FOX SCULPTURES WILL BE PROVIDED AS PART OF THIS DEVELOPMENT. LOCATIONS TO BE DETERMINED.

#3
APPROVED

THE LOCATIONS OF EXISTING UTILITY INSTALLATIONS AS SHOWN ON THIS PLAN ARE APPROXIMATE. THERE MAY BE OTHER UNDERGROUND UTILITY INSTALLATIONS WITHIN THE PROJECT AREA THAT ARE NOT SHOWN.

CONTRACTOR SHALL PROVIDE EROSION CONTROL FACILITIES IN ACCORDANCE WITH THE CITY OF WAUKESHA EROSION CONTROL ORDINANCE, THE WISCONSIN DNR STORMWATER CONSTRUCTION AND POST CONSTRUCTION TECHNICAL STANDARDS, WDR PERMIT CONDITIONS, AND THESE DOCUMENTS; THE MOST STRINGENT TO APPLY.

R.A. SMITH NATIONAL ASSUMES NO RESPONSIBILITY FOR DAMAGES, LIABILITY OR COSTS RESULTING FROM CHANGES OR ALTERATIONS MADE TO THIS PLAN WITHOUT THE EXPRESSED WRITTEN CONSENT OF R.A. SMITH NATIONAL

DIGGERS HOTLINE
Toll Free (800) 242-0811
Milwaukee Area (262) 432-7910
Hearing Impaired TDD (800) 542-2288
www.Diggerstohline.com

DESCRIPTION	
DATE	
R.A. Smith National <i>Beyond Surveying and Engineering</i>	
18745 W. Bluemound Road, Brookfield, WI 53005-9938 262-781-1000 Fax: 262-781-8688; www.ra-smith-national.com Appleton, WI Orange County, CA	
D LOT (SHOPS AT FOX RIVER) WAUKESHA, WI	SITE PLAN (OVERALL)
PRELIMINARY NOT FOR CONSTRUCTION	
© COPYRIGHT 2014 R.A. Smith National, Inc. DATE: 07/02/2014 SCALE: 1" = 60' JOB NO. 3140157 PROJECT MANAGER: ROBERT J. HARLEY, P.E. DESIGNED BY: JAH CHECKED BY: RJH	
SHEET NUMBER	C 1.0