



Color: Bronze

Weight: 10.8 lbs

Project:

Type:

Prepared By:

Date:

Driver Info

Type	Constant Current
120V	0.70A
208V	0.40A
240V	0.35A
277V	0.30A
Input Watts	70.8W

LED Info

Watts	70W
Color Temp	4000K (Neutral)
Color Accuracy	70 CRI
L70 Lifespan	100,000 Hours
Lumens	9,938 lm
Efficacy	140.3 lm/W

Technical Specifications**Compliance****UL Listed:**

Suitable for wet locations

IESNA LM-79 & LM-80 Testing:

RAB LED luminaires and LED components have been tested by an independent laboratory in accordance with IESNA LM-79 and LM-80.

IP Rating:

Ingress protection rating of IP65 for dust and water

DLC Listed:

This product is listed by Design Lights Consortium (DLC) as an ultra-efficient premium product that qualifies for the highest tier of rebates from DLC Member Utilities. Designed to meet DLC 5.1 requirements.
DLC Product Code: PLPPBUH2NS6D

Electrical**Driver:**

Constant Current, Class 2, 120-277V, 50/60Hz, 120V: 0.70A, 208V: 0.40A, 240V: 0.35A, 277V: 0.30A

Dimming Driver:

Driver includes dimming control wiring for 0-10V dimming systems. Requires separate 0-10V DC dimming circuit. Dims down to 10%.

THD:

3.19% at 120V, 13.21% at 277V

Power Factor:

99.5 % at 120V, 91.7 % at 277V

Surge Protection:

10kV

Performance**Lifespan:**

100,000-Hour LED lifespan based on IES LM-80 results and TM-21 calculations

Construction**IES Classification:**

The Type IV distribution (also known as a Forward Throw) is especially suited for mounting on the sides of buildings and walls, and for illuminating the perimeter of parking areas. It produces a semicircular distribution with essentially the same candlepower at lateral angles from 90° to 270°.

Cold Weather Starting:

The minimum starting temperature is -40°C (-40°F)

Maximum Ambient Temperature:

Suitable for use in up to 40°C (104°F)

Lens:

Polycarbonate lens

Technical Specifications (continued)

Construction

Housing:

Die-cast aluminum housing, lens frame and mounting arm

Vibration Rating:

3G vibration rating per ANSI C136.31

EPA:

- 1 Fixture: 0.46
- 2 Fixtures at 90°: 0.60
- 2 Fixtures at 180°: 0.93
- 3 Fixtures at 90°: 0.93
- 4 Fixtures at 90°: 0.93

EPA with Slipfitter & Adjustable Arm Mounting Accessories (Sold Separately)

- 1 Fixture: 0.66
- 2 Fixtures at 90°: 0.80
- 2 Fixtures at 180°: 1.32
- 3 Fixtures at 90°: 1.32
- 4 Fixtures at 90°: 1.32

Mounting:

Universal mounting arm compatible for hole spacing patterns from 1" to 5 1/2" center to center. Round Pole Adaptor plate included as a standard. Easy slide and lock to mount fixture with ease. Round pole diameter must be >4" to mount fixtures at 90° orientation.

Finish:

Formulated for high durability and long-lasting color

Green Technology:

Mercury and UV free. RoHS-compliant components.

LED Characteristics

LEDs:

Long-life, high-efficiency, surface-mount LEDs

Color Uniformity:

RAB's range of Correlated Color Temperature follows the guidelines of the American National Standard for Specifications for the Chromaticity of Solid State Lighting (SSL) Products, ANSI C78.377-2017.

Other

5 Yr Limited Warranty:

The RAB 5-year, limited warranty covers light output, driver performance and paint finish. RAB's warranty is subject to all terms and conditions found at rablighting.com/warranty.

Buy American Act Compliance:

RAB values USA manufacturing! Upon request, RAB may be able to manufacture this product to be compliant with the Buy American Act (BAA). Please contact customer service to request a quote for the product to be made BAA compliant.

Dimensions

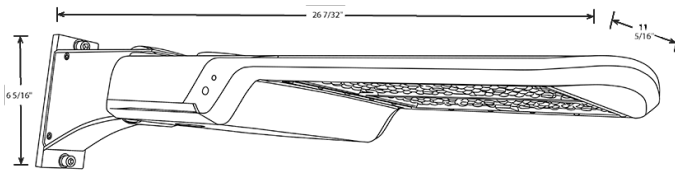

Features

- 0-10V Dimming, standard
- 100,000-hour LED lifespan
- 5-Year, limited warranty

Ordering Matrix

Family		Distribution	Wattage/Lumens	Mounting	Color Temp	Driver	Options
A17	-	4T	70		N		
		3T = Type III	70 = 70W/10,000LM	Blank = Universal Pole Mount	Blank = 5000K Cool	Blank = 120-277V, 0-10V	Blank = No Option
		4T = Type IV	100 = 100W/15,000LM	SF = Slipfitter (Factory installed	N = 4000K Neutral	Dimming	/3PRS = 3-pin Receptacle and
		5T = Type V	150 = 150W/22,500LM	SF available in 150W)		/480 = 480V, 0-10V	Shorting Cap
			200 = 200W/30,000LM			Dimming ¹	/7PRS = 7-pin Receptacle and
			240 = 240W/36,000LM				Shorting Cap
			300 = 300W/45,000LM				/MVS = Microwave Motion
			375 = 375W/51,800LM				Sensor
							/LC = Lightcloud® Controller

¹ 480V driver available standard on 150W and 300W and by special order on 100, 240 and 375W. Not available on 70W or 200W models.

Type II distribution available as special order

Wall mount and adjustable universal pole mount available as optional field-installed accessories



Color: Bronze

Weight: 13.2 lbs

Project:	Type:
Prepared By:	Date:

Driver Info		LED Info	
Type	Constant Current	Watts	150W
120V	1.50A	Color Temp	4000K (Neutral)
208V	0.80A	Color Accuracy	70 CRI
240V	0.70A	L70 Lifespan	100,000 Hours
277V	0.06A	Lumens	21,204 lm
Input Watts	149.2W	Efficacy	142.1 lm/W

Technical Specifications

Compliance

UL Listed:

Suitable for wet locations

IESNA LM-79 & LM-80 Testing:

RAB LED luminaires and LED components have been tested by an independent laboratory in accordance with IESNA LM-79 and LM-80.

IP Rating:

Ingress protection rating of IP65 for dust and water

DLC Listed:

This product is listed by Design Lights Consortium (DLC) as an ultra-efficient premium product that qualifies for the highest tier of rebates from DLC Member Utilities. Designed to meet DLC 5.1 requirements.
DLC Product Code: PL7C2E05FQ0M

Electrical

Driver:

Constant Current, Class 2, 120-277V, 50/60Hz, 120V: 1.50A, 208V: 0.70A, 240V: 0.70A, 277V: 0.60A

Dimming Driver:

Driver includes dimming control wiring for 0-10V dimming systems. Requires separate 0-10V DC dimming circuit. Dims down to 10%.

THD:

3.85% at 120V, 9.26% at 277V

Power Factor:

99.8% at 120V, 93.2% at 277V

Surge Protection:

10kV

Performance

Lifespan:

100,000-Hour LED lifespan based on IES LM-80 results and TM-21 calculations

Construction

IES Classification:

The Type IV distribution (also known as a Forward Throw) is especially suited for mounting on the sides of buildings and walls, and for illuminating the perimeter of parking areas. It produces a semicircular distribution with essentially the same candlepower at lateral angles from 90° to 270°.

Cold Weather Starting:

The minimum starting temperature is -40°C (-40°F)

Maximum Ambient Temperature:

Suitable for use in up to 40°C (104°F)

Lens:

Polycarbonate lens

Technical Specifications (continued)

Construction

Housing:

Die-cast aluminum housing, lens frame and mounting arm

Vibration Rating:

3G vibration rating per ANSI C136.31

EPA:

- 1 Fixture: 0.46
- 2 Fixtures at 90°: 0.60
- 2 Fixtures at 180°: 0.93
- 3 Fixtures at 90°: 0.93
- 4 Fixtures at 90°: 0.93

EPA with Slipfitter & Adjustable Arm Mounting Accessories (Sold Separately)

- 1 Fixture: 0.66
- 2 Fixtures at 90°: 0.80
- 2 Fixtures at 180°: 1.32
- 3 Fixtures at 90°: 1.32
- 4 Fixtures at 90°: 1.32

Mounting:

Universal mounting arm compatible for hole spacing patterns from 1" to 5 1/2" center to center. Round Pole Adaptor plate included as a standard. Easy slide and lock to mount fixture with ease. Round pole diameter must be >4" to mount fixtures at 90° orientation.

Finish:

Formulated for high durability and long-lasting color

Green Technology:

Mercury and UV free. RoHS-compliant components.

LED Characteristics

LEDs:

Long-life, high-efficiency, surface-mount LEDs

Color Uniformity:

RAB's range of Correlated Color Temperature follows the guidelines of the American National Standard for Specifications for the Chromaticity of Solid State Lighting (SSL) Products, ANSI C78.377-2017.

Other

5 Yr Limited Warranty:

The RAB 5-year, limited warranty covers light output, driver performance and paint finish. RAB's warranty is subject to all terms and conditions found at rablighting.com/warranty.

Buy American Act Compliance:

RAB values USA manufacturing! Upon request, RAB may be able to manufacture this product to be compliant with the Buy American Act (BAA). Please contact customer service to request a quote for the product to be made BAA compliant.

Dimensions

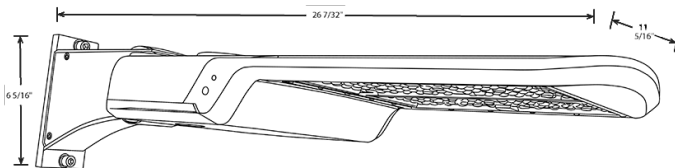

Features

- 0-10V Dimming, standard
- 100,000-hour LED lifespan
- 5-Year, limited warranty

Ordering Matrix

Family		Distribution	Wattage/Lumens	Mounting	Color Temp	Driver	Options
A17	-	4T	150		N		
		3T = Type III	70 = 70W/10,000LM	Blank = Universal Pole Mount	Blank = 5000K Cool	Blank = 120-277V, 0-10V	Blank = No Option
		4T = Type IV	100 = 100W/15,000LM	SF = Slipfitter (Factory installed	N = 4000K Neutral	Dimming	/3PRS = 3-pin Receptacle and
		5T = Type V	150 = 150W/22,500LM	SF available in 150W)		/480 = 480V, 0-10V	Shorting Cap
			200 = 200W/30,000LM			Dimming ¹	/7PRS = 7-pin Receptacle and
			240 = 240W/36,000LM				Shorting Cap
			300 = 300W/45,000LM				/MVS = Microwave Motion
			375 = 375W/51,800LM				Sensor
							/LC = Lightcloud® Controller

¹ 480V driver available standard on 150W and 300W and by special order on 100, 240 and 375W. Not available on 70W or 200W models.

Type II distribution available as special order

Wall mount and adjustable universal pole mount available as optional field-installed accessories



Accessories for A17 LED area lights

Color: Bronze

Weight: 3.6 lbs

Project:	Type:
Prepared By:	Date:

Technical Specifications

Performance

Description:

Arealight A17 wall mount kit

Construction

Finish:

Formulated for high durability and long-lasting color

Other

Buy American Act Compliance:

RAB values USA manufacturing! Upon request, RAB may be able to manufacture this product to be compliant with the Buy American Act (BAA). Please contact customer service to request a quote for the product to be made BAA compliant.

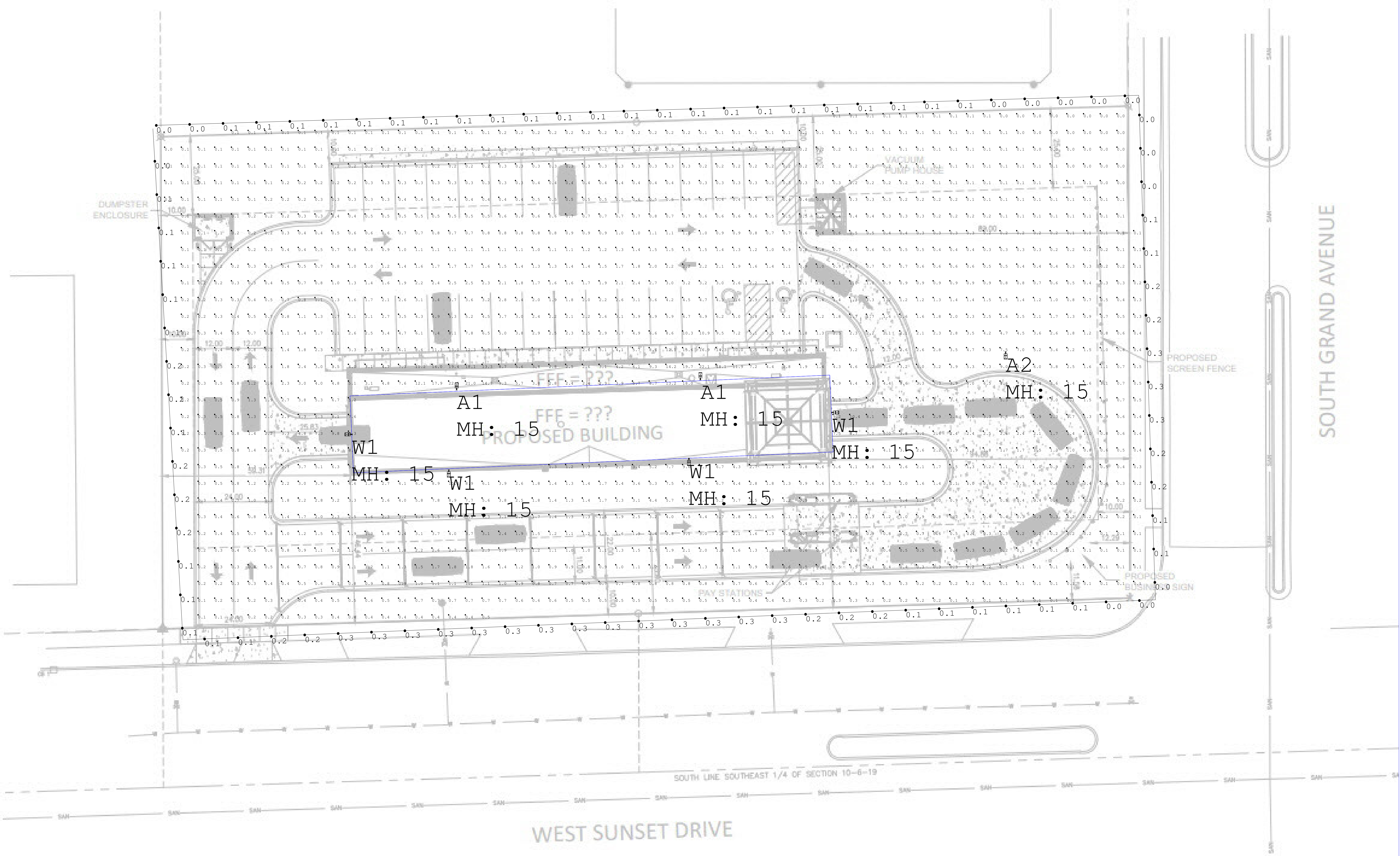

Not to Scale

Prepared For: Johnny Pannicola	Job Name: Peak Car Wash Lighting Layout Version A	PROJECT #	
		Scale: as noted	CASE #
Prepared By: Casey Electric Sales		Date:11/29/2022	Filename: Waukesha Car Wash.AGI
		Drawn By:Marie Smith	

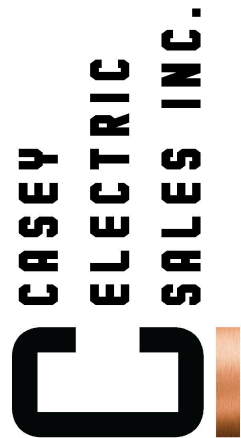

<div><div><div>CASEY ELECTRIC SALES INC.</div></div></div>	Prepared For: Johnny Pannicola		Job Name: Peak Car Wash			
	Prepared By: Casey Electric Sales		Scale: as noted	PROJECT #		
				Date: 11/29/2022	CASE #	
				Filename: Waukesha Car Wash.AGI		
				Drawn By: Marie Smith		

Calculation Summary											
Label	CalcType	Units	Avg	Max	Min	Avg/Min	Max/Min	Description	PtSpcLr	PtSpcTb	Meter Type
CalcPts_1	Illuminance	Fc	1.78	22.5	0.0	N.A.	N.A.		5	5	Horizontal
Property Line	Illuminance	Fc	0.14	0.3	0.0	N.A.	N.A.		10	N.A.	Horizontal

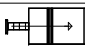
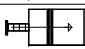
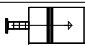
Luminaire Schedule													
Symbol	Qty	Tag	Label	Arrangement	Lum. Lumens	Arr. Lum. Lumens	LLF	Description	Lum. Watts	Arr. Watts	Total Watts	Filename	BUG Rating
	1	A2	A17-4T70N	Single	9798	9798	1.000	A17-4T70N	70.82	70.82	70.82	a17-4t70n.ies	B2-U0-G2
	4	W1	A17-4T70N + A17-WM	Single	9798	9798	1.000	A17-4T70N	70.82	70.82	283.28	a17-4t70n.ies	B2-U0-G2
	2	A1	a17-4t150N + A17-WM	Single	21117	21117	1.000	A17-4T150N	149.17	149.17	298.34	a17-4t150n.ies	B3-U0-G4

Expanded Luminaire Location Summary						
LumNo	Tag	X	Y	MTG HT	Orient	Tilt
13	W1	104	126.5	15	180	0
18	W1	134.558	114.249	15	270	0
19	W1	206.405	117.712	15	270	0
20	W1	250.754	133.062	15	0	0
29	A2	301.184	149.579	15	270	0
34	A1	136.899	141.424	15	90	0
35	A1	209.828	144.454	15	90	0
Total Quantity: 7						

NOTES:

* The light loss factor (LLF) is a product of many variables, only lamp lumen depreciation (LLD) has been applied to the calculated results unless otherwise noted. The LLD is the result (quotient) of mean lumens / initial lumens per lamp manufacturers' specifications.

* Illumination values shown (in footcandles) are the predicted results for planes of calculation either horizontal, vertical or inclined as designated in the calculation summary. Meter orientation is normal to the plane of calculation.

* The calculated results of this lighting simulation represent an anticipated prediction of system performance. Actual measured results may vary from the anticipated performance and are subject to means and methods which are beyond the control of RAB Lighting Inc.

* Mounting height determination is job site specific, our lighting simulations assume a mounting height (insertion point of the luminaire symbol) to be taken at the top of the symbol for ceiling mounted luminaires and at the bottom of the symbol for all other luminaire mounting configurations.

* It is the Owner's responsibility to confirm the suitability of the existing or proposed poles and bases to support the proposed fixtures, based on the weight and EPA of the proposed fixtures and the owner's site soil conditions and wind zone. It is recommended that a professional engineer licensed to practice in the state the site is located be engaged to assist in this determination.

* The landscape material shown hereon is conceptual, and is not intended to be an accurate representation of any particular plant, shrub, bush, or tree, as these materials are living objects, and subject to constant change. The conceptual objects shown are for illustrative purposes only. The actual illumination values measured in the field will vary.

* Photometric model elements such as buildings, rooms, plants, furnishings or any architectural details which impact the dispersion of light must be detailed by the customer documents for inclusion in the RAB lighting design model. RAB is not responsible for any inaccuracies caused by incomplete information on the part of the customer, and reserves the right to use best judgement when translating customer requests into photometric studies.

* RAB Lighting Inc. luminaire and product designs are protected under U.S. and International intellectual property laws. Patents issued or pending apply.

PROJECT #

Scale: as noted

Date:11/29/2022

Job Name:
Peak Car Wash
Lighting Layout
Version A

Prepared For:
Johnny Pannicola
Prepared By:
Casey Electric Sales

Casey Electric Sales Inc.

Filename: C:\Users\Marie Smith\Desktop\PC (8)\Desktop\Waukesha Car Wash.AGI

Drawn By:Marie Smith