

AL SERIES AREA LIGHT



CALCULATED
LIFETIME
**100,000
HOURS**

Finish Color



AL Series LED Area Light luminaires provide substantial energy savings through efficient delivery of light into all large areas. Capable of producing up to 51,100 lumen's, delivered into IES types 3, 4 or 5-Square.

Applications: parking lots, walkways, roadways and building areas, etc.

Replacement: ALS:175W- 250W MH, ALM: 400W MH, ALL: 750W-1000W MH+

PERFORMANCE INFORMATION

SERIES NUMBER	POWER	LUMENS	DISTRIBUTION	CCT
ALS 90 T3 G1 5K	70 Watts	9,000 Lm	Type 3	5000K
ALS 130 T3 G1 5K	105 Watts	13,400 Lm	Type 3	5000K
ALM 195 T3 G2 5K	150 Watts	19,700 Lm	Type 3	5000K
ALM 195 T3 G2 HVU 5K	150 Watts	19,700 Lm	Type 3	5000K
ALM 260 T3 G2 5K	200 Watts	26,200 Lm	Type 3	5000K
ALM 260 T3 G2 HVU 5K	200 Watts	26,380 Lm	Type 3	5000K
ALL 330 T3 G2 5K	250 Watts	33,250 Lm	Type 3	5000K
ALL 330 T3 G2 HVU 5K	250 Watts	33,250 Lm	Type 3	5000K
ALL 390 T3 G2 5K	300 Watts	39,300 Lm	Type 3	5000K
ALL 390 T3 G2 HVU 5K	300 Watts	39,300 Lm	Type 3	5000K

Project:	
Catalog No.:	
Fixture Type:	
Notes:	

SPECIFICATIONS

HOUSING

Precision die-cast aluminum housings with integral heat-sink fins. Parting lines dressed for high quality finish

AMBIENT TEMPERATURE

Suitable for use in -40°C to +45°C (-40°F to 113°F)

MOUNTING

Rigid direct-pole mounting arm. Arm mount, Slipfitter, or Wall mount.

EFFICACY

Up to 146 lumen's per watt (see individual wattage data)

CCT AND CRI

4000K and 5000K CCT available; 70CRI

OPTICS

Precision molded secondary optics produce superior uniformity, minimal light trespass and maximum pole spacing. Optics sealed to LED package for IP66 protection.

WARRANTY

10 year limited warranty. Complete warranty terms located at:

www.slgus.com

ELECTRICAL

Voltage: 120/277V standard. 347V-480V optional.

Class 2 Constant Current Drivers with 90% power factor, <20% THD.

Driver efficiency (>90% standard); 50/60Hz; Open/short circuit protection; 10K Surge protector per ANSI/IEEE C62.41.2; NEMA twist lock photocell control optional. Dimming 0-10V driver optional. Motion sensor (PIR) optional

FINISH

Polyester Powder Dark Bronze or White finish. Multi-stage process produces 3 mil thickness for superior corrosion resistance and maximum durability.

CERTIFICATIONS

UL Listed for wet locations. Equivalent to IP66 rating. FCC compliant. RoHs compliant. IDA dark-sky compliance.

DesignLights Consortium® (DLC) Premium qualified product and DLC qualified product. Not all versions of this product may be DLC Premium qualified or DLC qualified. Please check the DLC Qualified Products List at www.slgus.com/DLC to confirm which versions are qualified.

ORDERING GUIDE

EXAMPLE: ALS 90 T3 G1 5K SPAR

Luminaire Type	Lumen Output*	Distribution Type	Generation	Voltage	CCT	Mounting	Finish*	Options
ALS Small LED Area Light	ALS 90 9,000 Lumens 130 13,400 Lumens	T3 Type 3	G1	Standard 120-277V	4K 4000K 5K 5000K	SPAR Arm Mount SFD Adjustable Slipfitter Mount	Standard: Blank Dark Bronze	Standard No Option N NEMA Twist-lock Photocell N7 NEMA Seven-Pin Photocell
ALM Medium LED Area Light	ALM 195 19,700 Lumens 260 26,200 Lumens	T3 Type 3 T4 Type 4 T5 Type 5	G2	Standard 120-277V HVU** 347-480V		WM Wall Mount SFD-P1 Slipfitter with Photocell AL-T Trunnion*** AL-Y Yoke Mount***	Custom: W White*	M (FSP-212) Motion Sensor AL-BC-S ALS House side shield AL-BC-ML ALM-ALL House side shield
ALL Large LED Area Light	ALL 330 33,250 Lumens 390 39,300 Lumens							

NOTE: Data as report to DLC, actual test results may vary.
Lumen's for Type 3, other patterns may have different lumen outputs.

Please contact SLG agent for informations on Mounting, Finish options, and Options inventory.

*For any Finish color other than Dark Bronze, please call for custom order.

*** Photocell not available for this type of mounting



SLG Lighting

10643 W. Airport Blvd. Suite 400, Stafford, Texas 77477
Email: support@slgus.com | Phone: (832) 939-8412 | www.slgus.com

AL.V18.18

PERFORMANCE INFORMATION







		5000 K CCT					4000K CCT				
SERIES NUMBER	POWER	LUMENS	DISTRIBUTION TYPE	B	U	G	LUMENS	B	U	G	
ALS 90 T3 G1 5K	70 Watts	9,000 Lm	Type 3	N/A	N/A	N/A	N/A	N/A	N/A	N/A	
ALS 130 T3 G1 5K	105 Watts	13,400 Lm	Type 3	N/A	N/A	N/A	N/A	N/A	N/A	N/A	
ALM 195 T3 G2 5K	150 Watts	19,700 Lm	Type 3	3	0	2	19,500 Lm	3	0	2	
		18,800 Lm	Type 4	3	0	3	18,800 Lm	3	0	3	
		21,150 Lm	Type 5	4	0	2	21,000 Lm	4	0	2	
ALM 260 T3 G2 5K	200 Watts	26,200 Lm	Type 3	3	0	2	26,000 Lm	3	0	2	
		25,000 Lm	Type 4	3	0	3	25,000 Lm	3	0	3	
		27,200 Lm	Type 5	4	0	2	27,000 Lm	4	0	2	
ALL 330 T3 G2 5K	250 Watts	33,250 Lm	Type 3	4	0	3	33,000 Lm	4	0	3	
		30,500 Lm	Type 4	4	0	3	30,000 Lm	4	0	3	
		35,250 Lm	Type 5	5	0	2	35,000 Lm	5	0	2	
ALL 390 T3 G2 5K	300 Watts	39,300 Lm	Type 3	4	0	3	39,000 Lm	4	0	3	
		37,000 Lm	Type 4	4	0	4	36,000 Lm	4	0	4	
		42,300 Lm	Type 5	5	0	2	42,000 Lm	5	0	2	

ELECTRICAL LOAD

			Current (A)					
ALS	Series Number	Wattage	120V	208V	240V	277V	347V	480V
		ALS 90 T3 G1 5K	70 Watts	0.58	0.34	0.30	0.25	N/A
	ALS 130 T3 G1 5K	105 Watts	0.87	0.50	0.44	0.38	N/A	N/A
ALM	ALM 195 T3 G2 5K	150 Watts	1.25	0.72	0.63	0.54	0.43	0.31
	ALM 195 T3 G2 HVU 5K	150 Watts	1.25	0.72	0.63	0.54	0.43	0.31
	ALM 260 T3 G2 5K	200 Watts	1.66	0.96	0.83	0.72	0.58	0.42
	ALM 260 T3 G2 HVU 5K	200 Watts	1.66	0.96	0.83	0.72	0.58	0.42
ALL	ALL 330 T3 G2 5K	250 Watts	2.08	1.20	1.04	0.90	0.72	0.52
	ALL 330 T3 G2 HVU 5K	250 Watts	2.08	1.20	1.04	0.90	0.72	0.52
	ALL 390 T3 G2 5K	300 Watts	2.5	1.44	1.25	1.08	0.87	0.62
	ALL 390 T3 G2 HVU 5K	300 Watts	2.5	1.44	1.25	1.08	0.87	0.62

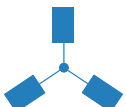

EPA OF AREA LIGHT

	Item	Watt							
	AL		1	2 @90°	2 @120°	2@180°	3 @90°	3 @120°	4 @90°
S	ALS90/ALS130	70W/105W	0.626	0.705	0.971	0.981	0.982	0.975	0.982
M	ALM195/ALM260	150W/200W	0.4418	0.7145	0.8813	0.8836	1.0548	1.0135	1.0548
L	ALL330/ALL390	250W/300W	0.5614	0.8471	1.105	1.1228	1.294	1.2503	1.294

DIMENSIONS

70W&105W (SLIPFITTER MOUNT)

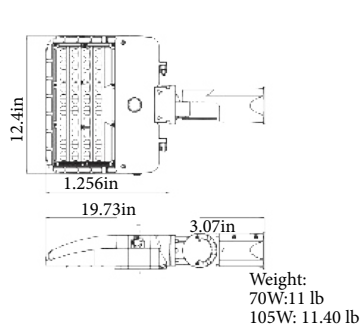

70W&105W (POLE MOUNT)

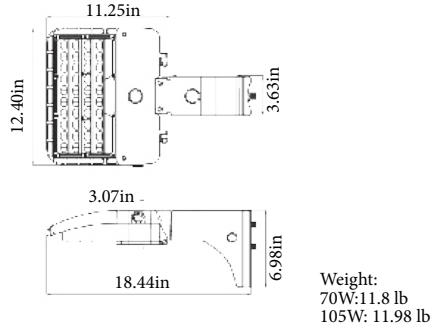

70W&105W (WALL MOUNT)

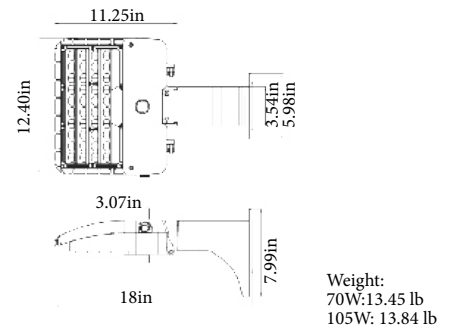

150W&200W (SLIPFITTER)

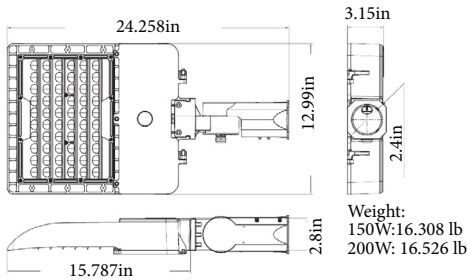

150W&200W (POLE MOUNT)

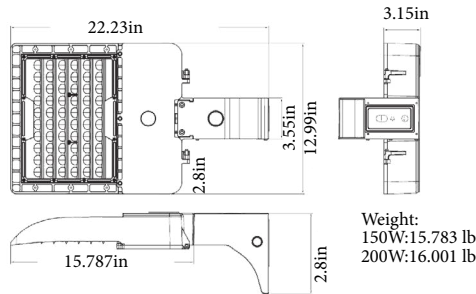

150W&200W (WALL MOUNT)

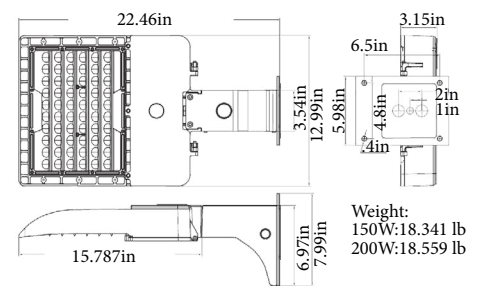

250W&300W&350W (SLIPFITTER)

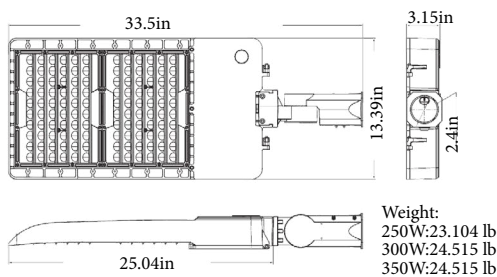

250W&300W&350W (POLE MOUNT)

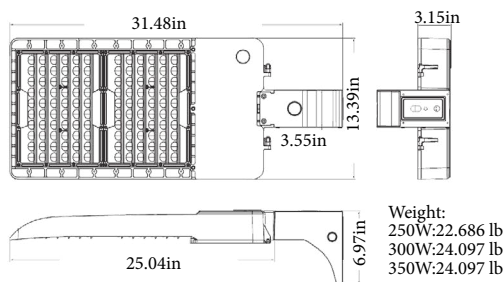

250W&300W&350W (WALLMOUNT)

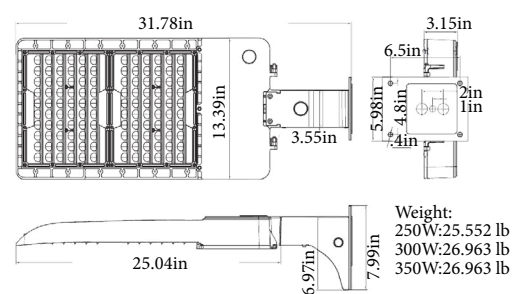

PROJECTED LUMINAIRE MAINTENANCE

OPERATING HOURS					
Ambient Temperature	0	25,000	50,000	100,000	Calculated L70 (Hours)
25°C/ 77°F	1	0.95	0.91	0.81	>214,973









Data references the extrapolated performance projections for the area light base model noted in a 25°C ambient, based on 10,000 hours of LED testing (tested per IESNA LM-80-08 and projected per IESNA TM-21-11)

LUMEN AMBIENT TEMPERATURE (LAT) MULTIPLIERS:

Use these factors to determine relative lumen output for average ambient temperatures from 0°C-40°C (32°F-104°F)

Ambient Temperature		Lumen Multiplier
0°C	32°F	1.02
10°C	50°F	1.01
20°C	68°F	1.00
25°C	77°F	1.00
30°C	86°F	0.98
40°C	104°F	0.98

PERFORMANCE COMPARISON

	Product Series	LED Watts	Lumen Output	Lumens Per/Watt	REPLACES	Voltage	Max. Mounting Height	DLC
	ALS 90	70W	9,000 Lm	129 Lm/W	175W	120-277V	15-20Ft	
	ALS 130	105W	13,400 Lm	128 Lm/W	250W	120-277V	15-20Ft	
	ALM 195	150W	19,700 Lm	131 Lm/W	400W	120-277V	20-30Ft	
	ALM 260	200W	26,200 Lm	131 Lm/W	400W	120-277V	20-30Ft	
	ALL 330	250W	33,250 Lm	133 Lm/W	750W	120-277V	30-50Ft	
	ALL 390	300W	39,300 Lm	131 Lm/W	1000W	120-277V	30-50Ft	

Area Light Motion Sensor Wattstopper



The Wattstopper offer an extensive line of both indoor and outdoor occupancy sensors utilizing a variety of sensing technologies to ensure optimal performance in any environment.

Benefits:

- Comply with energy codes such as Title 24, ASHRAE 90.1, IECC, and other energy codes.
- Enhance green building practices, such as LEED.
- Operating Humidity: 20-90%.
- Operating temperature: -40-167°F (-40-75°C)
- IP66 rated
- Polycarbonate, flame retardant, UV resistant, impact resistant.
- Meets the materials restrictions of RoHS.

Motion Sensor Setting

Motion Sensor	Day Lighting Control	High / Low Dim	Time Delay	Auto On	Auto Off	Load Rating	Current Consumption	Operating Temperature
FSP-212	Yes	Low Dim	30 Sec-30 min	5 fc	10 fc	1/6hp	10mA	-40°F - 158°F



SLG Lighting

10643 W. Airport Blvd. Suite 400, Stafford, Texas 77477
Email: support@slgus.com | Phone: (832) 939-8412 | www.slgus.com

AL.V18.18

SMART WIRELESS CONTROL NODE

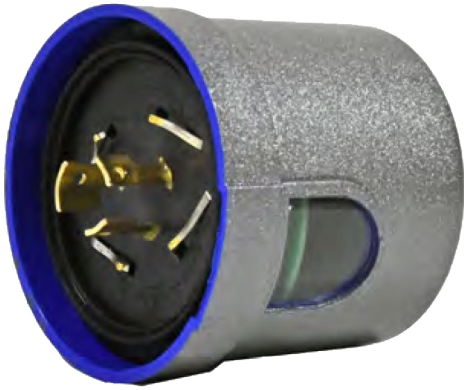

APPLICATIONS:

- Smart City
- Parking Lots
- Private Roadways
- Public Streets & Highways
- College & Corporate Campus Walkways
- Shopping Malls & Centers

WIRELESS NETWORK:

- IEEE 802.15.4 2.4GHz ISM
- Range: 600 + meters LOS transmit/ receive

ELECTRICAL:

- Operating Voltage: 120-277VAC, 347VAC, 480VAC
- Operating Current: 75mA max .
- Switching Capacity: 2.5A max @480VAC

FEATURES:

- Real time measure and transfer of input Voltage, Amperage, Wattage, Power Factor, KWH and Hours of operation
- Dim LED fixtures via standard 0-10V dimming interface
- Self-forming and self-healing mesh network with secure encrypted communication
- Smart Wireless Control Node and G5 Smart Gateway can be spaced up to 600m apart (Clear Line of Sight) or up to 2000m with relay
- Designed to UL 916 standards
- Inrush Current Limiting at Turn On
- IP65 rated
- Automatically download programmed schedules
- Controlled by an G5 Smart Gateway and fully integrated into G5 Smart Software Platform
- AES Encryption and Certificate Based Authentication
- 5 year warranty standard, 10 year extended warranty available

ACCURACY

- Real Power and Energy: 2%
- Reactive Power and Energy: IEC 62053-23 Class 2, 2%Current
- Current: 0.8%
- Voltage: 0.4% (+0.015% per °C deviation from 25°C
- 108VL -N to 528VAC -L

ENVIRONMENTAL:

- Operating Temperature: -30 °C to 60 °C -22 °F to 158 °F)
- Storage Temperature: -40 °C to 85 °C -40 °F to 185 °F)
- Humidity Range: <95% Relative Humidity, non-condensing
- Altitude of Operation: 3KM max

G5 SMART GATEWAY



APPLICATIONS:

- Smart City
- Parking Lots
- Private Roadways
- Public Streets & Highways
- College & Corporate Campus Walkways
- Jogging & Bike Pathways

FEATURES:

- Self-forming and self healing mesh network with secure encrypted communication
- Support Wi-Fi or 3/4G Mobile network
- Smart photocell and gateway can be spaced up to 600m apart (Clear Line of Sight) or up to 2000m apart with relay
- Can control up to 80 G5 smart photocells
- Storage of up to 30 days data in local memory
- Automatically synchronize data in local memory with server once network is recovered
- Designed to comply with UL773 standards
- IP65 rated
- Standard 5-year Warranty
- Built-in surge protection
- Designed in the USA

WIRELESS NETWORK:

- Network: IEEE 802.15.4-2003 2.4GHz ISM
- Range: 600 + meters LOS transmit/ receive
- Back haul Communication: Wifi, 3/4G CDMA, LTE
- Comply with FCC Part 15

ELECTRICAL:

- Operating Voltage: 120-277VAC, 347VAC, 480VAC
- Operating Current: 75mA max.
- Switching Capacity: 2.5A max. @ 480VAC
- Surge: Meets ANSI, 10KV, 3KA Combination Wave

ENVIRONMENTAL:

- Operating Temperature: -30 ° to 60 ° C (-22 ° to 158°F)
- Storage Temperature: -40 ° to 85° C (-40 ° to 185° F)
- Humidity Range: <95% Relative Humidity, noncondensing
- Altitude of Operation: 3 km max



SLG Lighting

10643 W. Airport Blvd. Suite 400, Stafford, Texas 77477
Email: support@slgus.com | Phone: (832) 939-8412 | www.slgus.com

AL.V18.18

PHOTOMETRIC

SLG offers a complete set of optical system to meet every site lighting requirement. These systems provide remarkable flexibility in precisely matching light distribution patterns to specific site requirements. (See ordering guide.)

TYPE 3:

Type 3 optics produce an asymmetrical pattern that directs the majority of the light forward and equally on both sides of the luminaire. In a back-to-back configuration, it creates a rectangular pattern which can extend pole spacings.

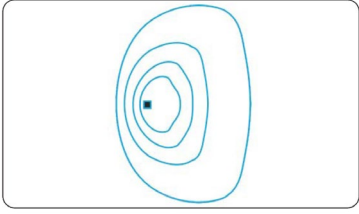

TYPE 4:

Type 4 is suitable for applications where light is primarily required forward with minimal back light. Typical installations include perimeter poles.

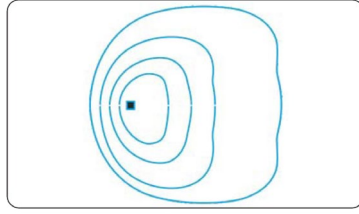

TYPE 5:

Type 5 optics produce a symmetrical square distribution pattern that distributes light equally on all sides of the luminaire. Type 5 luminaires is universal for most area lighting applications

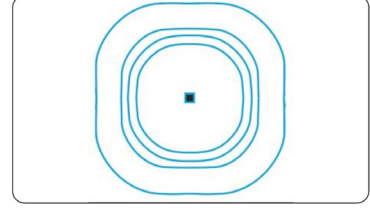

MOUNTING OPTIONS

ARM MOUNT (SPAR) (SQUARE OR ROUND POLES)

Standard versatile mounting arm is simple to install and can be used with existing poles for retrofit installations.



SLIP-FITTER MOUNT (SFD)

An optional cast aluminum mast arm adapter secures fixture head to nominal 2"(2-3/8" O.D. pipe size) horizontal steel tenon arm.



WALL MOUNT (WM)

Wall Mount is easy to install for direct wall mounting with 1/2" conduit wiring or standard J-box mounting



MOUNTING DIMENSIONS

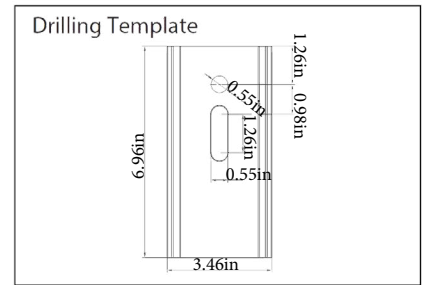
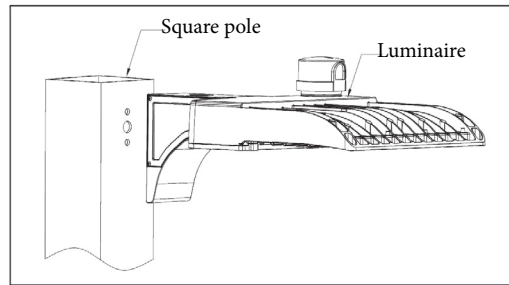
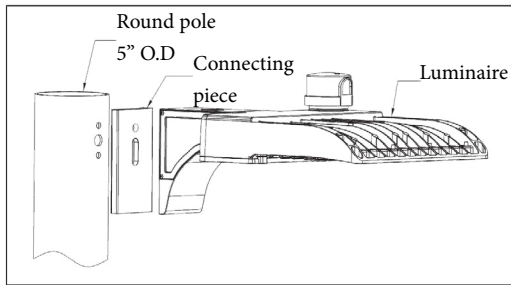

BACKLIGHT CONTROL ACCESSORIES

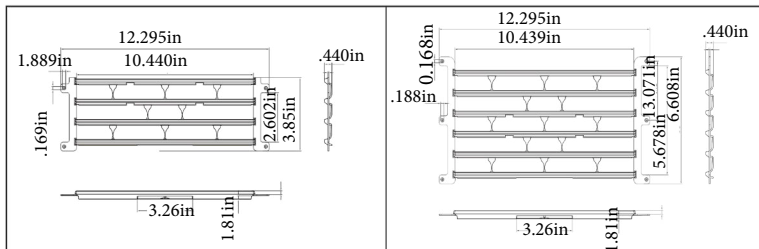

Scan for more information



SLG Lighting

10643 W. Airport Blvd. Suite 400, Stafford, Texas 77477
Email: support@slgus.com | Phone: (832) 939-8412 | www.slgus.com

AL.V18.18