

PLANTING NOTES

GENERAL

Digging
Contact local Digger's Hotline prior to any digging.

Topsail
Topsail shall be classified as a sandy loam soil to silty loam. No organic topsail from peaty sources will be accepted. Topsail imported from a local supplier shall be stripped and stockpiled for more than 12 months to be relatively free of viable weed seeds. Topsail shall be sifted and/or screened to be free of stones and clay lumps, plants or other extraneous materials.

Fine Grading
Inspect site and verify that adequate topsail has been provided for all seed and planting beds. Remove all trash and stone exceeding 2 inches in diameter from area to a depth of 2 inches prior to bed preparation and planting. Fine grade to within 1/2" of finished grade. All lawn areas to be sloped evenly to sheet drain and approximate contours on grading plan.

PLANTING

Substitutions
Substitutions or changes of plant species, cultivar, or size at planting must be approved by the owner prior to ordering of materials.

Plant Staking and Quantities
Contractor shall stake tree, shrub, and perennial locations in the field and obtain approval from owner prior to planting. Plantings shown are diagrammatic. Provide additional plant quantities as needed, based on actual field dimensions to satisfy the design intent of the drawings.

Plant starter mix
A 2:1 ratio mix of two parts peat moss and one part manure.

Trees
Pocket plant and back fill pits with a mix of 10% plant starter mix, and 90% existing soil. Tree holes to be at least 2 times the spread diameter of the root ball. Use shovel to rough up sides of exposed walls. Set depth of root ball to be same as grown in nursery or slightly higher if planting in clay soil.

Shrubs
Pocket plant and back fill pits with a mix of 10% plant starter mix, and 90% existing soil. Set depth of root ball to be same as grown in nursery or slightly higher if planting in clay soil.

Perennials
Condition topsail in perennial planting beds by adding 3" plant starter mix. Add bone meal and milorganite, each at the rate of 1-2 lbs. per 100 S.F. Add granular sulfur at the rate of 3-4 lbs. per 100 S.F. Rototill to blend and re-grade as necessary. Set plant depth to be same as grown in nursery. Water-in well.

MULCHING
Install a 3" layer of shredded bark throughout tree, shrub, and perennial planting beds. For trees in lawn, install a 4-5' diameter circle of mulch around each tree. Do not allow mulch to touch plant stems. Contractor shall provide shredded bark mulch from disease-free hardwood trees. Provide generally flat bark, maximum of 1" wide and 4' long, graded down to sawdust, and relatively free of deleterious matter.

BED EDGING
All turf and perennial planting beds adjacent to turf areas shall be edged with 4" shovel-cut edging.

TURF SEDING

Proportions by common name	by weight
A. Barron kentucky bluegrass	20 %
B. Liberty kentucky bluegrass	20 %
C. Pennlawn fescue	20 %
D. Prelude ii perennial ryegrass	20 %
E. Palmer ii perennial ryegrass	20 %

Apply at the rate of 5 Lbs. per 1000 Sf.

Method of grass seeding may be varied at discretion of Contractor on their responsibility to establish smooth, uniform turf composed of the grasses specified.

- Spread lawn fertilizer per manufacturer's specifications.
- Do not seed following rain or if surface has been compacted by rain.
- Do not seed when wind velocity exceeds 6 m.p.h.
- Method of mulching may be varied at discretion of contractor. Fiber mulch to be mixed with seed and fertilizer if hydroseeding. Or, protect seeded areas by spreading straw mulch to form a continuous blanket over seeded areas.
- Keep seedbed moist for 4 weeks.

MEADOW SEEDING
Contractor shall prepare area for installation of new seeded prairie, and is responsible to follow supplier's instructions for all planting operations necessary to guarantee a healthy stand of plants within a one-year establishment period. Seed mix shall be "Detention Basin - Bioswale Seed Mix", from Prairie Nursery in Westfield, WI, Ph.1-800-476-9453. Contractor shall install per supplier's instructions.

MAINTENANCE
Maintenance Period - Contractor shall provide regular maintenance until a date of 60 days after completion of planting. Maintenance shall begin when planting is started for ongoing planting areas. Maintenance operations shall include watering, weeding, and mowing. Contractor shall provide temporary irrigation equipment if needed to provide a minimum of 1" of water per week throughout the maintenance period for all planting areas.

PLANT GUARANTEE
The landscape contractor shall guarantee to replace once, without charge, any woody plant material (deciduous or evergreen trees & shrubs) that dies within one year of installation, providing the owner gives normal plant care (regular watering). The owner must report plant losses within the guarantee period.

PLANTING SCHEDULE

SYM	BOTANICAL NAME	COMMON NAME	QTY	SIZE	COND.	SPACING
Shade Trees						
Qr	Quercus rubra	Red Oak	4	2.5' Cal.	B/B	As shown
Ornamental Trees						
CC	Crataegus crusgalli var. inermis	Thornless Cockspur Hawthorn	7	2" Cal.	B/B	As shown
Deciduous Shrubs						
AB	Aronia arbutifolia 'Brilliantissima'	Brilliant Red Chokeberry	25	18" HT.	B/B	48" o.c.
PO	Physocarpus opulifolius 'Diablo'	Diablo Ninebark	5	36" HT.	B/B	60" o.c.
WM	Weigela 'Minuet'	Minuet Weigela	22	2 Gal.	Container	42" o.c.
Evergreen Shrubs						
JC	Juniperus chinensis pfitz. comp.	Compact Pfitzer Juniper	8	5 Gal.	B/B	60" o.c.
Perennials						
BC	Bouteloua curtipendula	Sideoats Gramma	5	1 Gal.	Container	30" o.c.
MS	Miscanthus sinensis 'Red Flame'	Red Flame Miscanthus	82	1 Gal.	Container	30" o.c.
SM	Salvia x 'May Night'	May Night Salvia	17	1 Gal.	Container	24" o.c.
SS	Schizachyrium scoparium	Lille Bluestem	49	1 Gal.	Container	30" o.c.

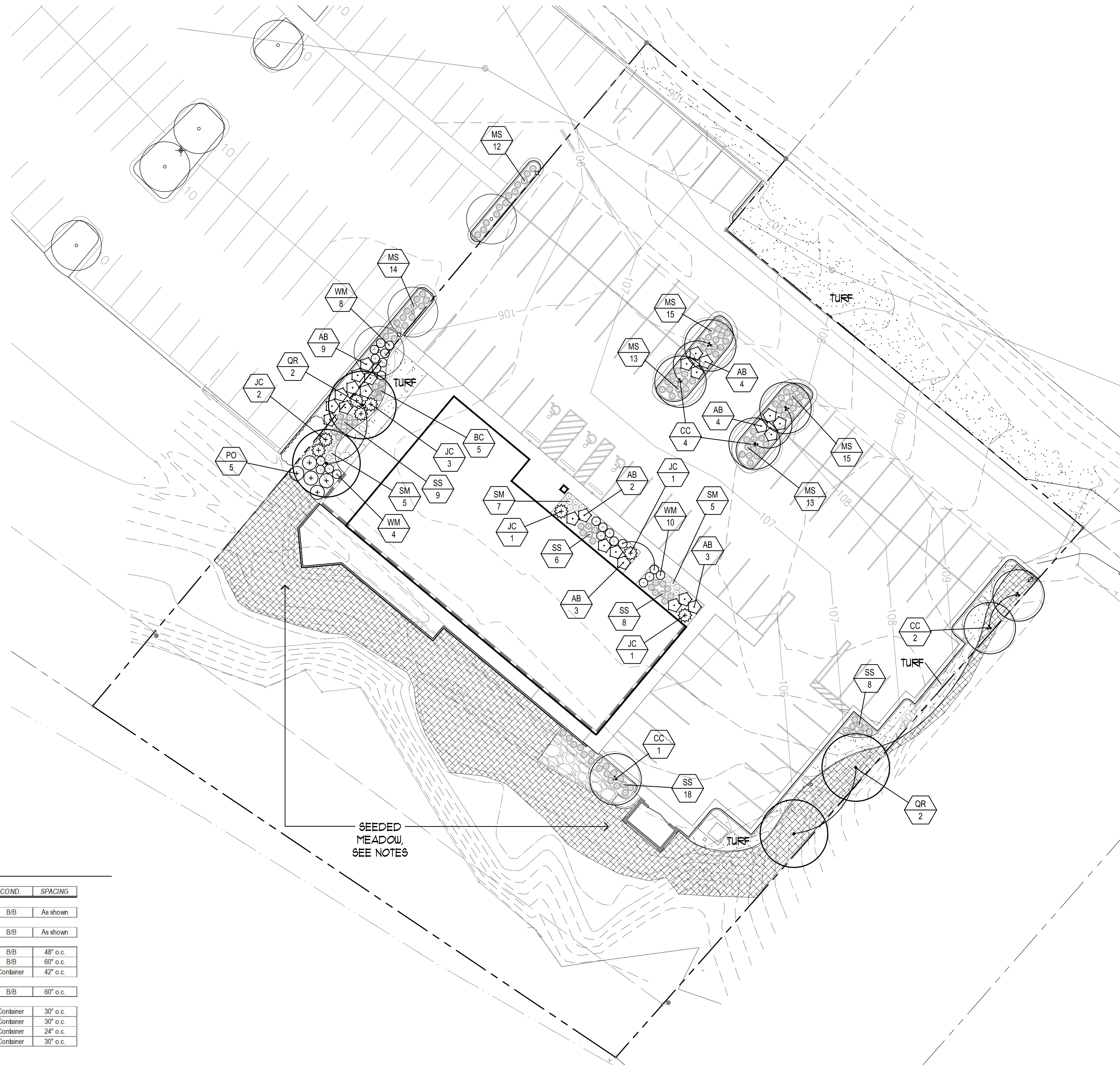

LANDSCAPE PLAN
1" = 20'-0"

REVISIONS

NO.	DATE	DESCRIPTION

SCALE: AS NOTED
DATE: 8/11/19
DRAWN BY: JDS
WAUKESHA COMM