

TYPICAL ALUMINUM RAILING ELEVATION

ARS ALUMINUM RAILING SYSTEM FOR GLASS

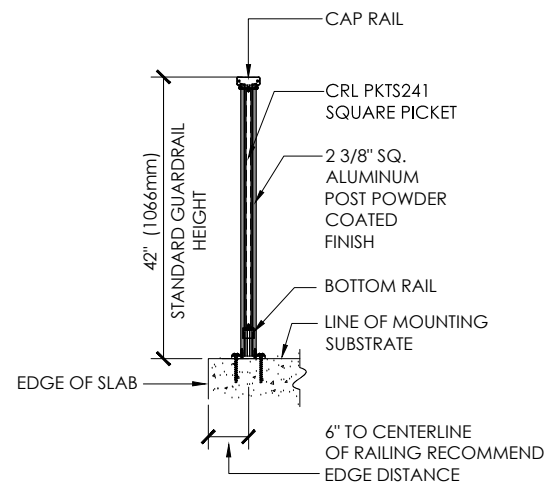

TYPICAL SECTION

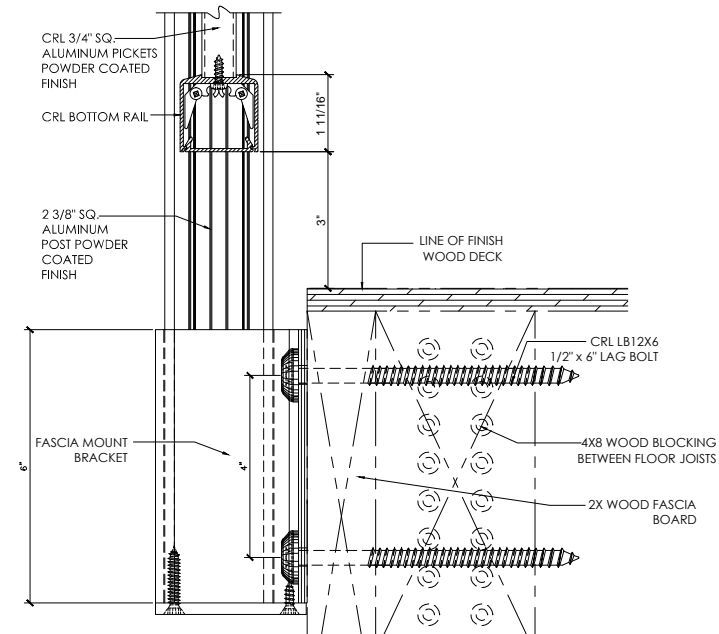

WOOD SUBSTRATE TYPICAL FASCIA MOUNT DETAIL

SPACING WILL DEPEND ON MOUNTING SUBSTRATE AND REGION OF PROJECT

TYPICAL ARS ATTACHMENTS

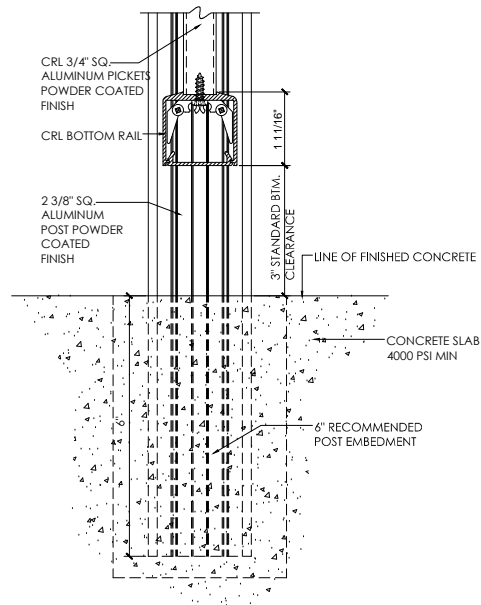

CONCRETE SUBSTRATE TYPICAL CORE MOUNT DETAIL

SPACING WILL DEPEND ON MOUNTING SUBSTRATE AND REGION OF PROJECT

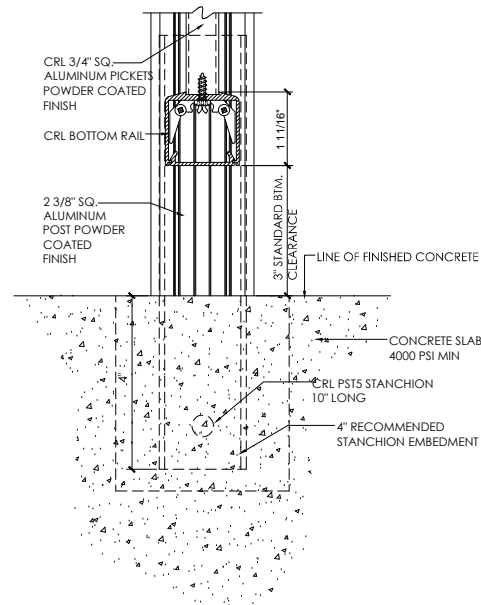

CONCRETE SUBSTRATE TYPICAL CORE MOUNT WITH STANCHION DETAIL

SPACING WILL DEPEND ON MOUNTING SUBSTRATE AND REGION OF PROJECT

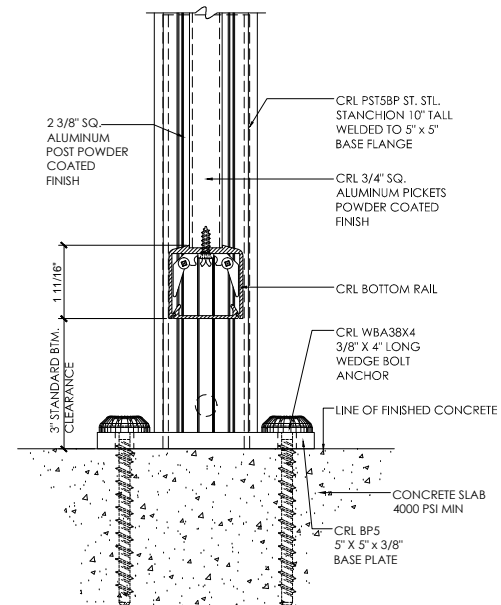

CONCRETE SUBSTRATE TYPICAL SURFACE MOUNT WITH STANCHION DETAIL

SPACING WILL DEPEND ON MOUNTING SUBSTRATE AND REGION OF PROJECT

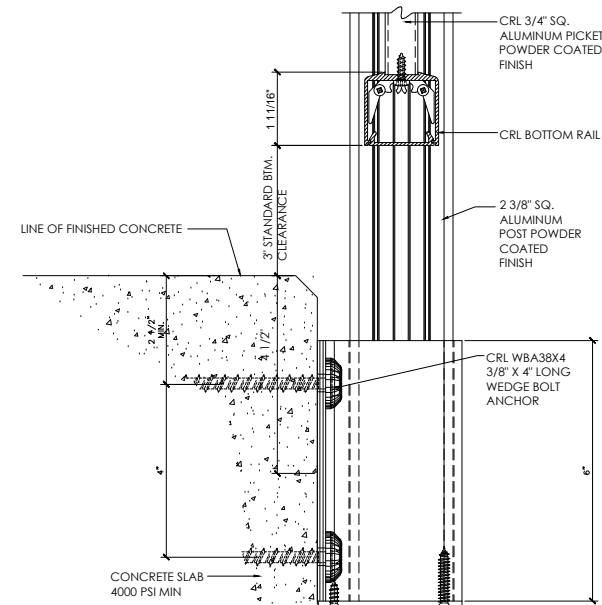

CONCRETE SUBSTRATE TYPICAL FASCIA MOUNT DETAIL

ANCHOR SPACING WILL DEPEND ON MOUNTING SUBSTRATE AND REGION OF PROJECT

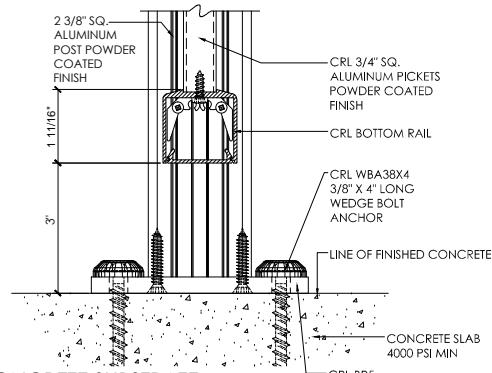

CONCRETE SUBSTRATE TYPICAL SURFACE MOUNT DETAIL

SPACING WILL DEPEND ON MOUNTING SUBSTRATE AND REGION OF PROJECT

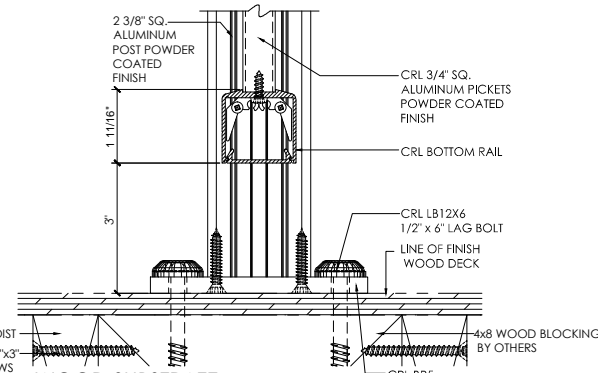

WOOD SUBSTRATE TYPICAL SURFACE MOUNT DETAIL

SPACING WILL DEPEND ON MOUNTING SUBSTRATE AND REGION OF PROJECT

Revisions By:



C.R.LAURENCE CO. ARCHITECTURAL PRODUCTS 2503 E. Varnum Avenue, Los Angeles, CA 90056-1897 PH (800)-421-8444 www.crlaluminum.com

Description:

ARS ALUMINUM RAILING SYSTEM FOR PICKET DRAWING FILES

Drawn By: A.S.V.
Date: 11-18-11
Scale: as shown
File Name: ARS
Sheet

SHT-1

CRL's ARS PICKET RAILING SYSTEM TOP CAP PROFILES

ALUMINUM SHAPES FOR PICKET RAILING

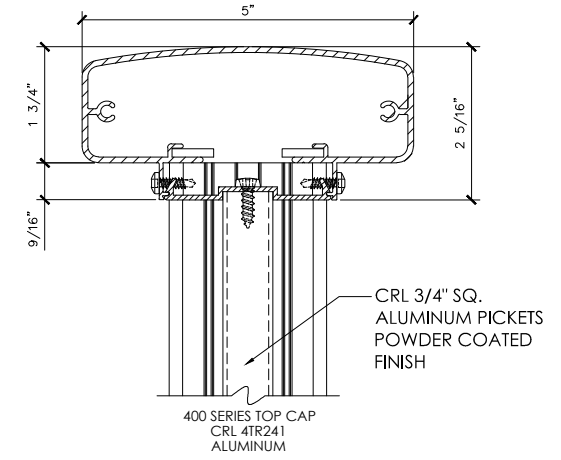
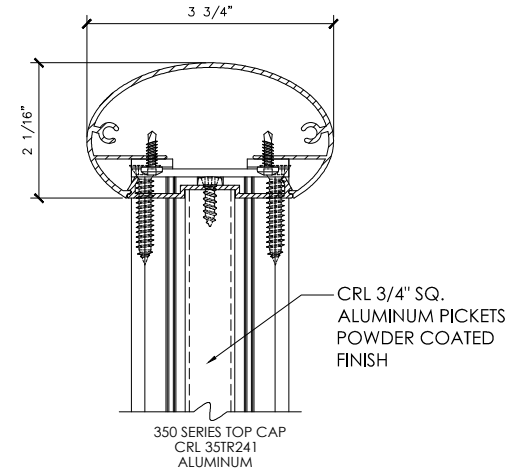
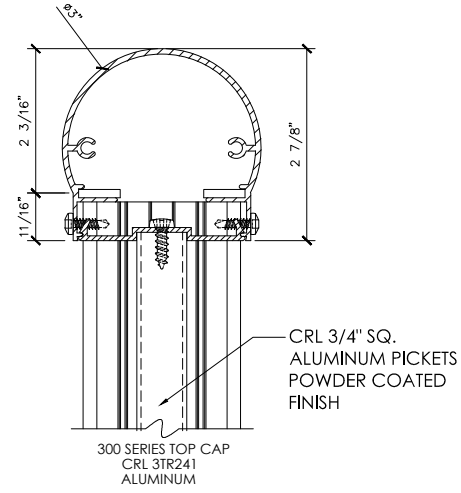
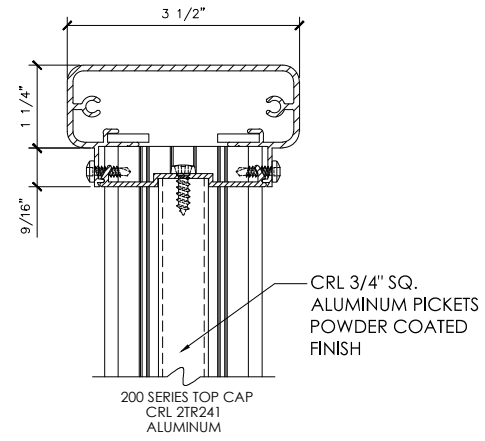
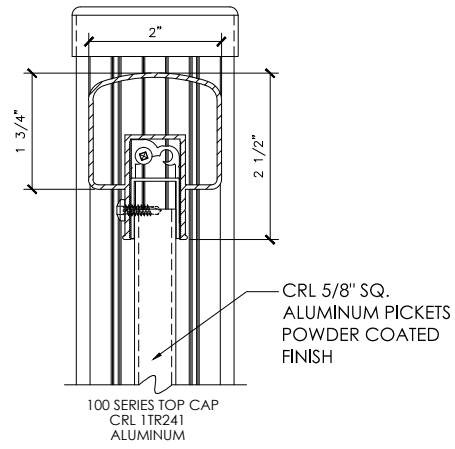

Revisions By:



Description:

ARS ALUMINUM RAILING
SYSTEM FOR PICKET
DRAWING FILES

Drawn By: A.S.V.
Date: 11-18-11
Scale: as shown
File Name: ARS

Sheet

SHT-2