

1801Summit Ave.
Waukesha WI 53188
USA



C4 LIFE SAFETY LEGEND

C4 CODE SUMMARY



PROJECT LOCATION MAP

A501 DETAILS, INTERIOR ELEVATIONS, SCHEDULES AND PARTITION TYPES

C5 DRAWING INDEX

CONTACT:
Allen Link
LinkBuilds, Inc.
al.linkbuilds@gmail.com
(414) 379-0299

OWNER/TENANT INFORMATION

1801Summit Ave.,
Waukesha, WI 53188

[illegible]

ARCHITECT

CONNOLLY ARCHITECTS, INC.
229 E. Wisconsin Ave. Suite 1000
Milwaukee, WI 53202
Phone: (414) 289-0900
FAX: (414) 289-7762
Contact: Heather Wogsland
E-mail: hwogsland@triglyph.net

DESIGNER LIST & STAMP

G001

SHEET OF

[illegible]

A1 ABBREVIATION LIST

DETAIL/PLAN NO. (IN REFERENCE TO SHEET GRID AT TOP & RIGHT SIDE)

A5

DRAWING TITLE

DETAIL OR PLAN TITLE

NOT TO SCALE

0 4' 8' 16'

SECTION NO.
A3
A-507

SECTION DETAIL

SHEET NO.

DETAIL (IN REFERENCE TO SHEET GRID AT TOP & RIGHT SIDE)

C5
A-507

DETAIL REFERENCE

SHEET NO. (DETAILS REFERENCE TO SHEET ON WHICH THEY OCCUR)

ELEV. NO.
A3
A-202

SHEET NO.

ELEVATION MARKER

1

STRUCTURAL/COLUMN GRID

OFFICE
102

ROOM NAME & NUMBER

101

DOOR NUMBER

2

KEYNOTE

1

WALL TAG

A

66'-0"

LIGHT TAG

1

100.00

NEW SPOT ELEVATION

1

REVISION IDENTIFIER

CONTRACT LIMIT LINE

100

INDICATES NEW DOOR AND/OR WALL

100

INDICATES EXISTING DOOR AND/OR WALL

100

INDICATES DOOR AND/OR WALL TO BE REMOVED
SALVAGE DOORS FOR REUSE

100

INDICATES PATCH EXISTING WALLS AS REQUIRED FOR SMOOTH FINISH

PLAN NORTH

NORTH ARROW

SYMBOL KEY

A4 SYMBOL KEY

FOR: LINK & ASSOCIATES RE: FIRST FEDERAL SAVING
LEGAL DESCRIPTION: The East 175 feet of Garvens property as described by the description, to-wit: That part of the South West 1/4 of Section 33, Town 7 North, Range 19 East, in the City of Waukesha, County of Waukesha, State of Wisconsin, bounded and described as follows: Commencing at the South 1/4 corner of Section 33; running thence due North along the South 1/4 line of said Section 125.00 feet; thence due East 30 feet to a point; thence due North 1446.90 feet to the centerline of U.S.H. "18" and Summit Avenue; thence North 86°05' West along said centerline 60.14 feet to the place of beginning of land herein described; thence due South 200.00 feet; thence North 86°05' West, 475.00 feet; thence due North 200.00 feet to the tangent centerline of U.S.H. "18" and Summit Avenue; thence South 86°05' East 475.00 feet to the place of beginning. Except those lands described in Quit Claim Deed recorded May 3, 1973 on Reel 38, Image 164, as Document No. 848842. Benchmark 127.27 (City Datum) Top of concrete found marking the center of Sec 33-7-19.
REFERENCE BEARING: East line of Southwest 1/4 of Section 33-7-19 has a bearing of N01°32'14"W per Wisconsin State Plane Coordinate System Grid, South Zone.
NOTE NO TITLE POLICY WAS FURNISHED THEREFORE COMPLETENESS OF LEGAL DESCRIPTION AND EASEMENTS ARE NOT WARRANTED.

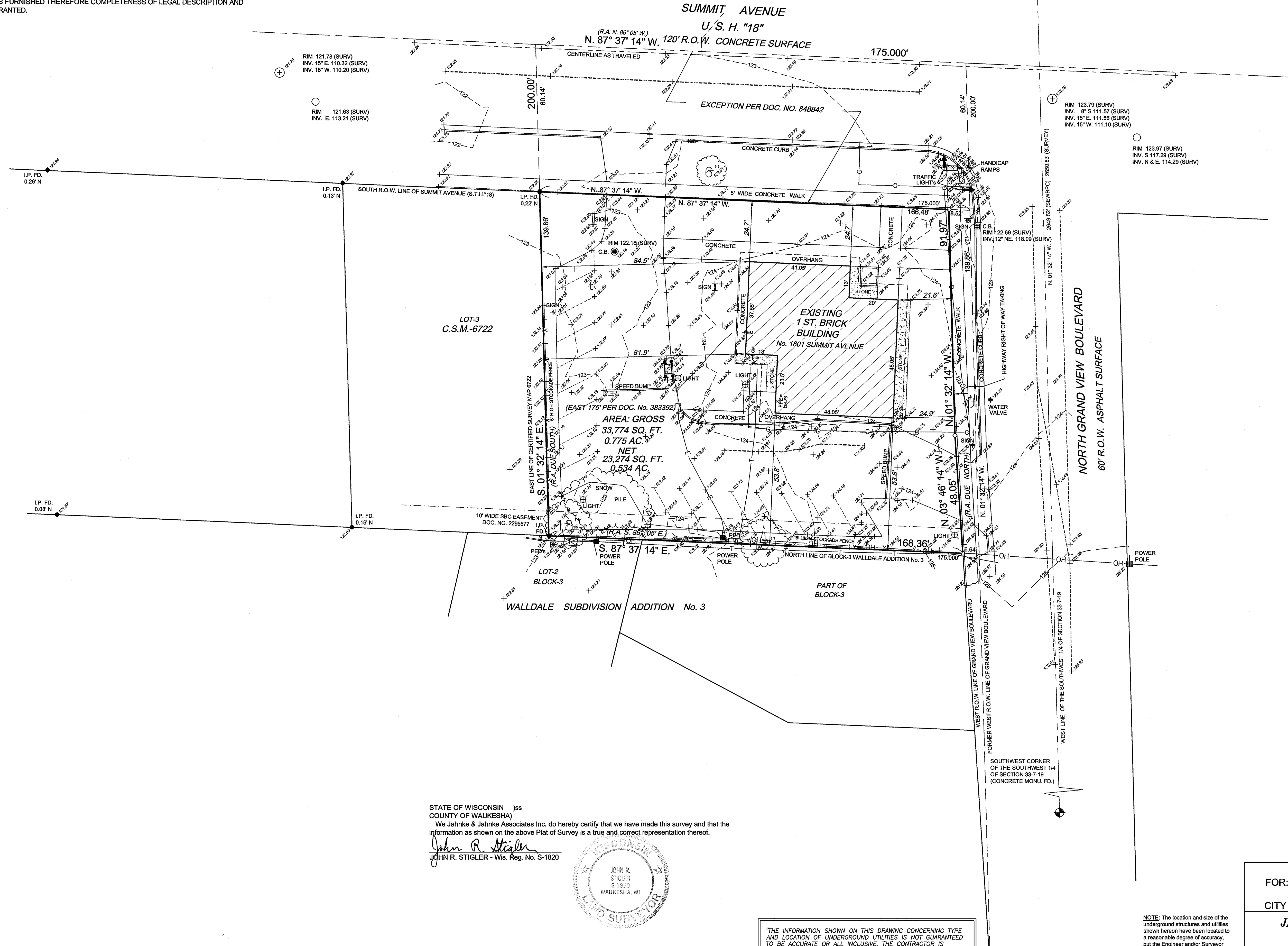
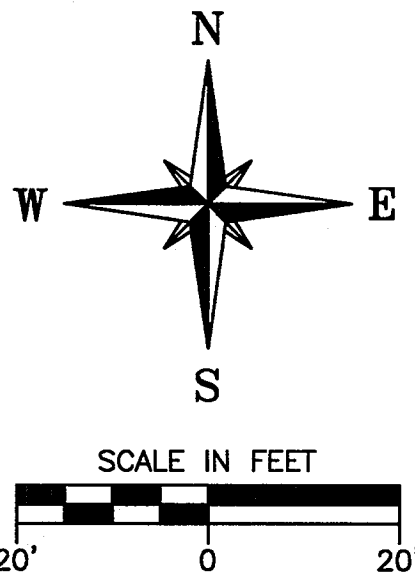

STATE OF WISCONSIN) ss
COUNTY OF WAUKESHA)
We Jahnke & Jahnke Associates Inc. do hereby certify that we have made this survey and that the information as shown on the above Plat of Survey is a true and correct representation thereof.
John R. Stigler
JOHN R. STIGLER - Wis. Reg. No. S-1820

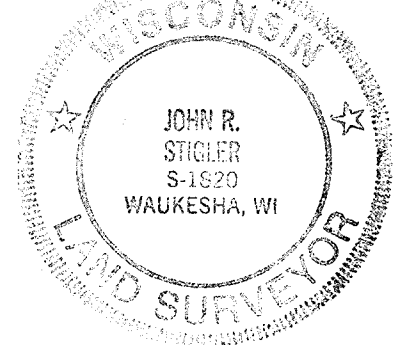

"THE INFORMATION SHOWN ON THIS DRAWING CONCERNING TYPE AND LOCATION OF UNDERGROUND UTILITIES IS NOT GUARANTEED TO BE ACCURATE OR ALL INCLUSIVE. THE CONTRACTOR IS RESPONSIBLE FOR MAKING HIS OWN DETERMINATIONS AS TO THE TYPE AND LOCATION OF UNDERGROUND UTILITIES AS MAY BE NECESSARY TO AVOID DAMAGE THERETO."

NOTE: The location and size of the underground structures and utilities shown hereon have been located to a reasonable degree of accuracy, but the Engineer and/or Surveyor does not guarantee their exact location or the location of others not shown.
Contact Diggers Hotline, Inc., Etc.

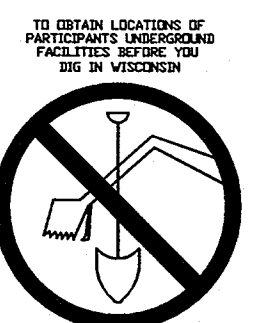

CALL DIGGERS HOTLINE
1-800-242-6511
TOLL FREE
VIA SERVICE REQUESTS
REQUIRE NO. 3 WORK DATE
NOTICE BEFORE YOU DIG
MILV. AREA 259-1181







SITE PLAN
FOR: LINK & ASSOCIATES RE: FIRST FEDERAL SAVING
PART OF THE SOUTHWEST 1/4 OF SECTION 33-7-19
CITY OF WAUKESHA, WAUKESHA COUNTY, WISCONSIN

JAHNKE & JAHNKE ASSOCIATES INC.
PLANNERS & PROFESSIONAL ENGINEERS
711 W. MORELAND BLVD.-WAUKESHA, WI 53188
TEL No. (262) 542-5797 FAX (262) 542-7898 (E-MAIL: jstigler@jahnkeandjahnke.com)

SCALE: 1"=20'	DATE: FEBRUARY 25, 2015
DRAWN BY: P.M.	CHECKED BY: J.R.S.
BOOK NO.: PEWAUKEE-179 pg-3	JOB: S-7552
FILE NO.: PEWAUKEE-1110	SHEET 1 OF 1

FILE NAME: S:\PROJECTS\7552.dwg



-  LIGHT POLE -
NUMBER OF HEADS AS SHOWN
-  FH FIRE HYDRANT
-  BOLLARD
-  SIGN
-  WHEEL STOP
-  SPOT ELEVATION



SHEET OF

B

[illegible]

A001

SHEET OF



A5

B

[illegible]

A101

SHEET OF

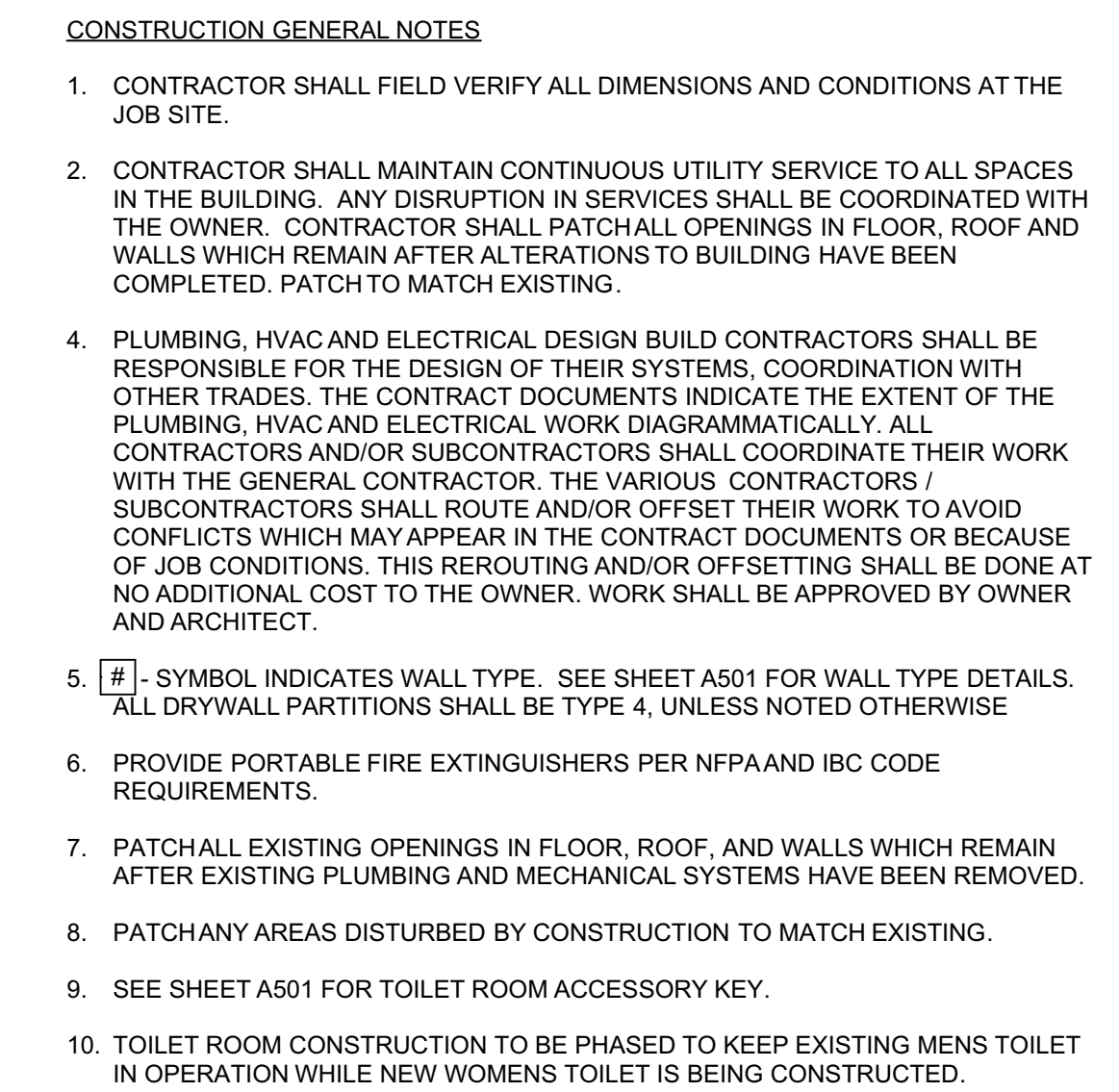

(A5)

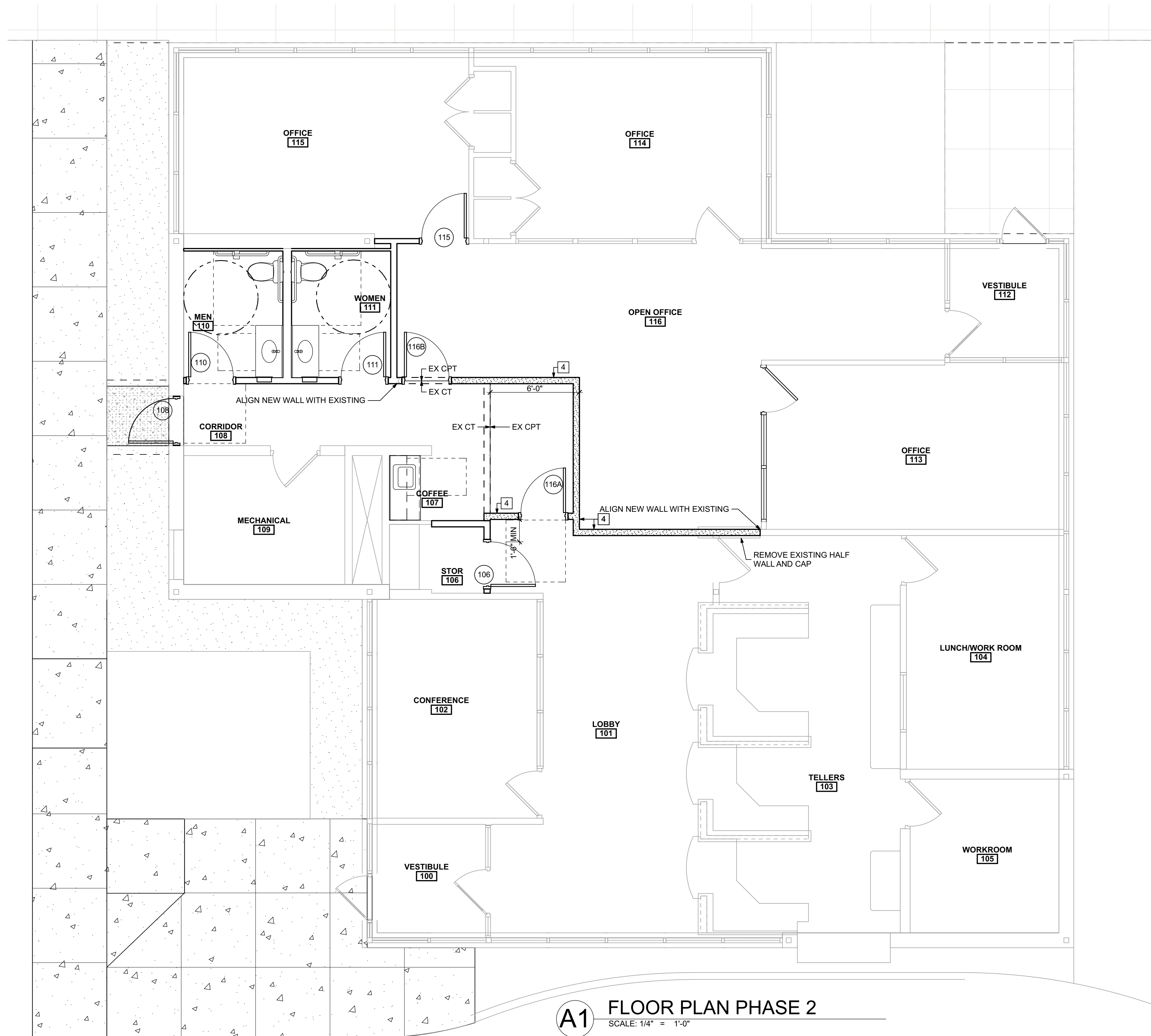

FIRST
FEDERAL
BANK

1801 Summit Ave.,
Waukesha, WI 53188

CONSTRUCTION GENERAL NOTES

1. CONTRACTOR SHALL FIELD VERIFY ALL DIMENSIONS AND CONDITIONS AT THE JOB SITE.
2. CONTRACTOR SHALL MAINTAIN CONTINUOUS UTILITY SERVICE TO ALL SPACES IN THE BUILDING. ANY DISRUPTION IN SERVICES SHALL BE COORDINATED WITH THE OWNER. CONTRACTOR SHALL PATCHALL OPENINGS IN FLOOR, ROOF AND WALLS WHICH REMAIN AFTER ALTERATIONS TO BUILDING HAVE BEEN COMPLETED. PATCH TO MATCH EXISTING.
3. PLUMBING, HVAC AND ELECTRICAL DESIGN BUILD CONTRACTORS SHALL BE RESPONSIBLE FOR THE DESIGN OF THEIR SYSTEMS. COORDINATION WITH OTHER TRADES. THE CONTRACT DOCUMENTS INDICATE THE EXTENT OF THE PLUMBING, HVAC AND ELECTRICAL WORK DIAGRAMMATICALLY. ALL CONTRACTORS AND/OR SUBCONTRACTORS SHALL COORDINATE THEIR WORK WITH THE GENERAL CONTRACTOR. THE VARIOUS CONTRACTORS / SUBCONTRACTORS SHALL ROUTE AND/OR OFFSET THEIR WORK TO AVOID CONFLICTS WHICH MAY APPEAR IN THE CONTRACT DOCUMENTS OR BECAUSE OF JOB CONDITIONS. THIS REROUTING AND/OR OFFSETTING SHALL BE DONE AT NO ADDITIONAL COST TO THE OWNER. WORK SHALL BE APPROVED BY OWNER AND ARCHITECT.
5. **#** - SYMBOL INDICATES WALL TYPE. SEE SHEET A501 FOR WALL TYPE DETAILS. ALL DRYWALL PARTITIONS SHALL BE TYPE 4, UNLESS NOTED OTHERWISE
6. PROVIDE PORTABLE FIRE EXTINGUISHERS PER NFPAAND IBC CODE REQUIREMENTS.
7. PATCHALL EXISTING OPENINGS IN FLOOR, ROOF, AND WALLS WHICH REMAIN AFTER EXISTING PLUMBING AND MECHANICAL SYSTEMS HAVE BEEN REMOVED.
8. PATCHANY AREAS DISTURBED BY CONSTRUCTION TO MATCH EXISTING.
9. SEE SHEET A501 FOR TOILET ROOM ACCESSORY KEY.
10. TOILET ROOM CONSTRUCTION TO BE PHASED TO KEEP EXISTING MENS TOILET IN OPERATION WHILE NEW WOMENS TOILET IS BEING CONSTRUCTED.

[illegible]

FIRST FLOOR PLAN PHASE 2

A102

SHEET OF

B

[illegible]

A103

SHEE

C



- REFLECTED CEILING LEGEND

- REFLECTED CEILING GENERAL NOTES

1. WHERE NEW WALLS PENETRATE EXISTING CEILING SYSTEMS TO REMAIN, REMOVE EXISTING CEILING SYSTEM AS REQUIRED AND PATCH TO MATCH EXISTING CEILING SYSTEM TO NEW WALL.
2. HVAC SUPPLY AND RETURN GRILLES, IF SHOWN, ARE FOR CONCEPT ONLY. HVAC DESIGN/BUILD CONTRACTOR SHALL BE RESPONSIBLE FOR FINAL DESIGN.
3. E.C. IS RESPONSIBLE FOR ALL LIGHTING DESIGN INCLUDING EGRESS LIGHTING DESIGN AND FOR SUBMITTAL (IF REQUIRED) TO AUTHORITY HAVING JURISDICTION.
10. NEW TOILET ROOM EXHAUST TO BE CONNECTED TO A NEW IN-LINE EXHAUST FAN TO THE EXTERIOR. FAN TO BE SWITCHED WITH LOBBY LIGHTING.
11. NEW LIGHT FIXTURES TO MATCH BUILDING STANDARD TYPE FOR LAMP REPLACEMENT AND APPEARANCE.

B

[illegible]

A

SHEET TITLE

SHEET OF



B

[illegible]

A201

