

ARCHITECT:

kolbrook design

828 DAVIS STREET
SUITE 300
EVANSTON, IL 60201
Ph 847.492.1992

PROJECT:

Tropical Smoothie Cafe
WAUKESHA, WI

Job No.

1674.025

Issue Date

2024 05 23

Project Area

Bldg: 3,718 SF

Lot: 48,871 SF

Sheet Title:

Existing Conditions

Scale:

1" - 40'-0"

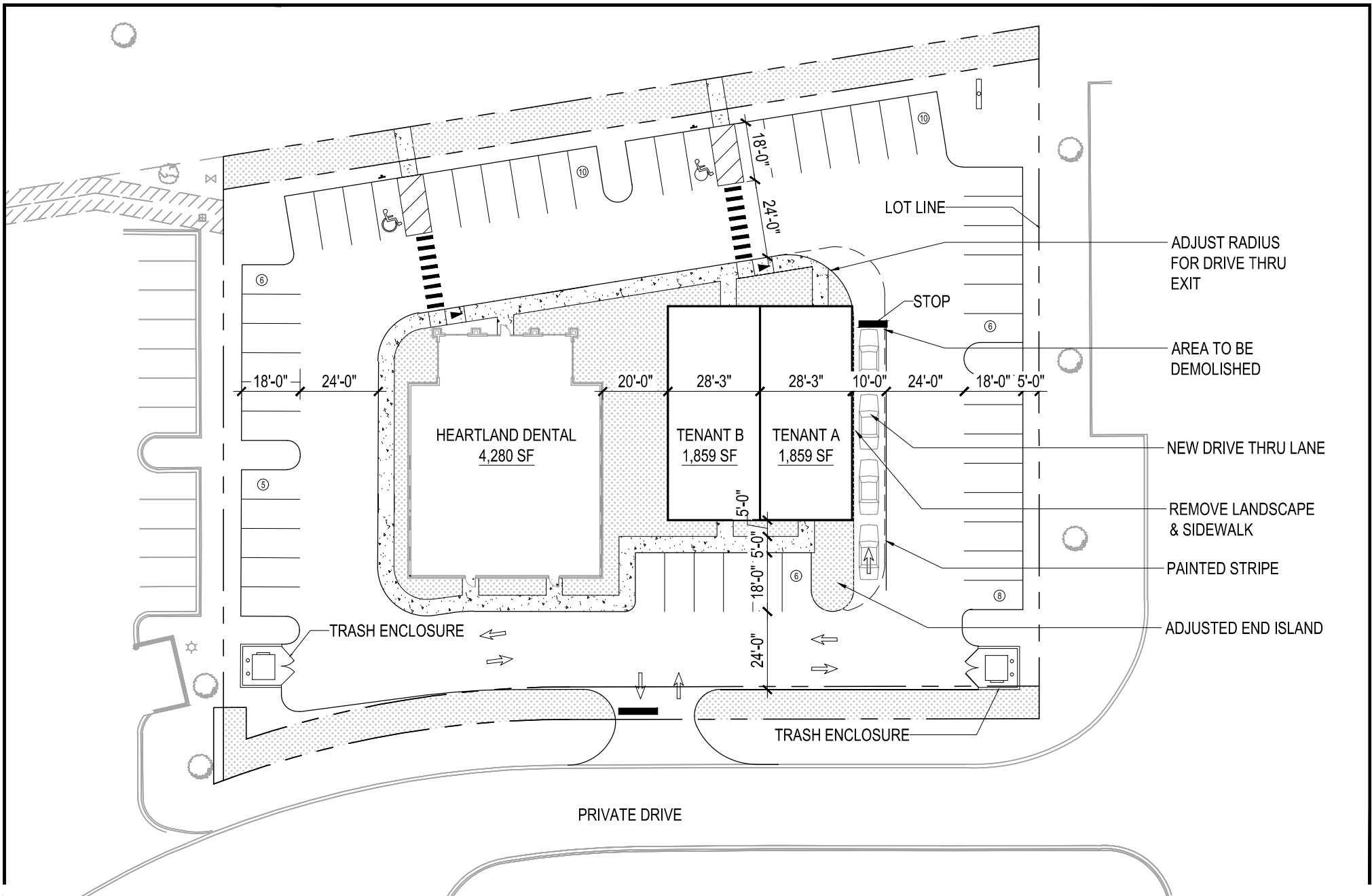

ARCHITECT:

kolbrook design

828 DAVIS STREET
SUITE 300
EVANSTON, IL 60201
Ph 847.492.1992

PROJECT:

Tropical Smoothie Cafe
WAUKESHA, WI

Sheet Title:
Site Plan

Job No.

1674.025

Issue Date

2024 05 23

Scale:

1" - 40'-0"

Project Area

Bldg: 3,718 SF

Lot: 48,871 SF

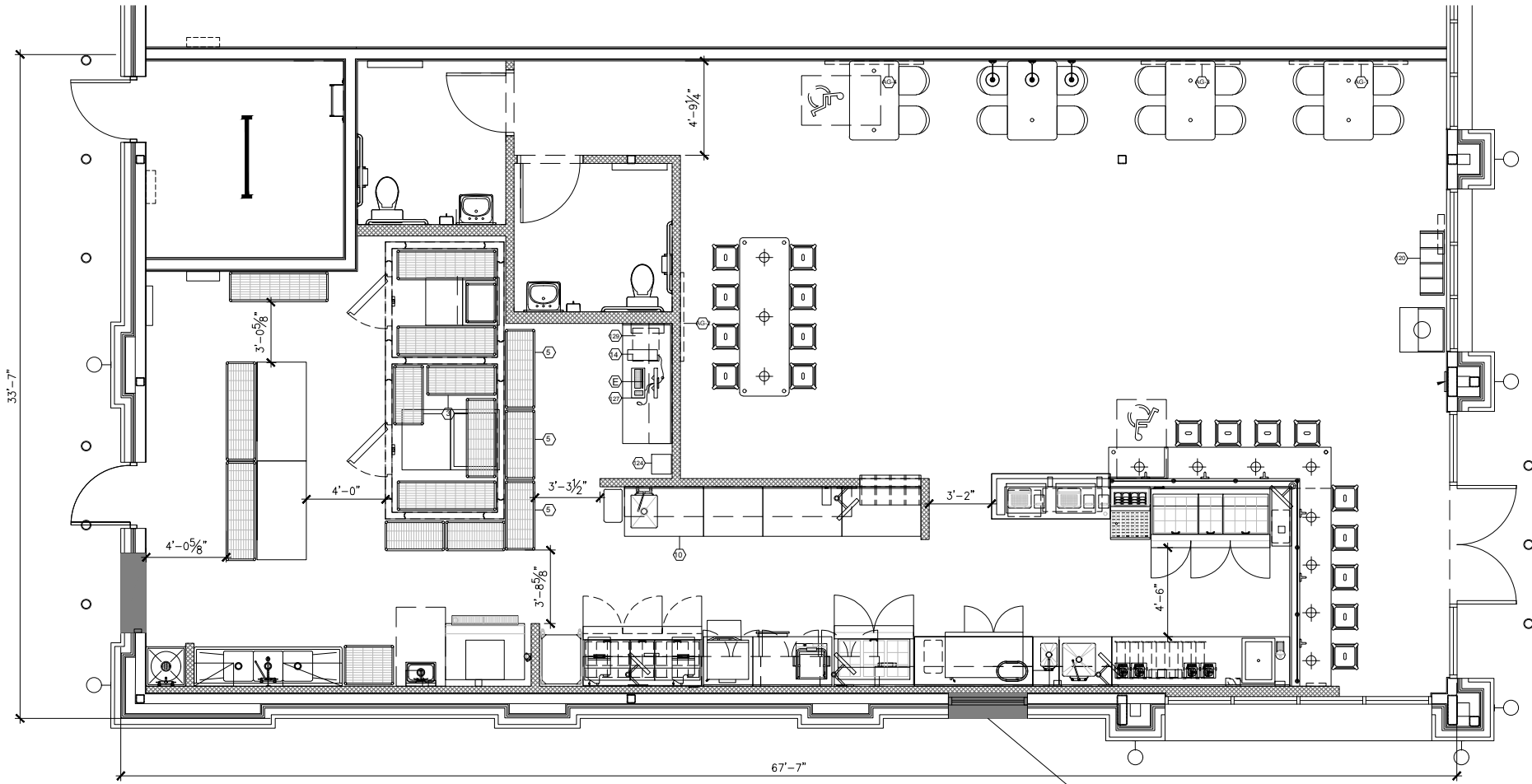

PROPOSED DT WINDOW

ARCHITECT:



828 DAVIS STREET
SUITE 300
EVANSTON, IL 60201
Ph 847.492.1992

PROJECT:

Tropical Smoothie Cafe
WAUKESHA, WI

Job No.

1674.025

Issue Date

2024 05 23

Project Area

Bldg: 3,718 SF

Lot: 48,871 SF

Sheet Title:

Floor Plan

Scale:

1/8" - 1'-0"



PROPOSED DT WINDOW

ARCHITECT:



828 DAVIS STREET
 SUITE 300
 EVANSTON, IL. 60201
 Ph 847.492.1992

PROJECT:
 Tropical Smoothie Cafe
 WAUKESHA, WI

Sheet Title:
 Elevation

Job No.
 1674.025
 Issue Date
 2024 05 23
 Scale:
 1/8" - 1'-0"

Project Area
 Bldg: 3,718 SF
 Lot: 48,871 SF