

TREE PROTECTION NOTES

- ALL EXISTING TREE LOCATIONS AND SIZES ARE TO BE VERIFIED IN THE FIELD BY THE CONTRACTOR. THE CONTRACTOR SHALL NOTIFY THE LANDSCAPE ARCHITECT OF ANY DISCREPANCIES BETWEEN THE DRAWINGS AND ACTUAL FIELD CONDITIONS, PRIOR TO THE START OF CONSTRUCTION.
- ALL TREES TO REMAIN AS NOTED ON THE DRAWINGS ARE TO BE ENCLOSED WITH A TREE PROTECTION FENCE, PRIOR TO THE START OF CONSTRUCTION. THE FENCE SHALL CONSIST OF 4' TALL ORANGE PLASTIC FENCE WITH METAL POSTS SPACED NO FURTHER THAN 6' APART. THE FENCE IS TO BE LOCATED UNDER THE OUTER EDGES OF THE TREE'S CANOPY, BUT NO CLOSER THAN 5' AWAY FROM THE TREE'S TRUNK. LANDSCAPE ARCHITECT TO APPROVE FENCE LOCATION.
- NO MATERIALS OR VEHICLES SHALL BE STORED, DRIVEN OR PARKED WITHIN TREE PROTECTION FENCING.
- ALL GRADING, CONSTRUCTION EQUIPMENT AND MATERIALS SHALL BE FORBIDDEN FROM ENCRDACHING WITHIN THE TREE PROTECTION FENCING.
- CRUSHED LIMESTONE OR ANY MATERIALS THAT MAY BE DETRIMENTAL TO TREES SHALL NOT BE DUMPED WITHIN THE TREE PROTECTION FENCING NOR SHALL THEY BE LOCATED AT ANY HIGHER ELEVATION WHERE DRAINAGE TOWARD THE TREE(S) COULD CONCEIVABLY AFFECT THE HEALTH OF SAID TREE(S).
- IF IT IS THE CONTRACTOR'S OPINION THAT ANY OF THE TREES TO BE PRESERVED WILL BE NEGATIVELY AFFECTED DURING THE CONSTRUCTION PROCESS, THE LANDSCAPE ARCHITECT SHALL BE NOTIFIED IMMEDIATELY.
- THE CONTRACTOR IS TO MAINTAIN THE PROTECTION FENCING THROUGHOUT THE ENTIRE CONSTRUCTION PROCESS UNTIL NEW LANDSCAPING BEGINS AND THE LANDSCAPE ARCHITECT APPROVES REMOVAL OF THE FENCING.
- IF ROOTS OF A TREE TO REMAIN ARE EXPOSED, THE LANDSCAPE ARCHITECT IS TO BE CONTACTED AT ONCE.
- ALL TREES TO BE PRESERVED SHALL BE PRUNED TO REMOVE EXISTING DEAD WOOD TO COMPENSATE FOR ROOT LOSS DURING CONSTRUCTION BY A QUALIFIED ARBORIST WITH A MINIMUM 5 YEARS EXPERIENCE AT THE DIRECTION OF THE LANDSCAPE ARCHITECT.
- IF IT IS THE CONTRACTOR'S, OR ARBORIST'S OPINION THAT ANY TREE TO BE PRESERVED SHALL REQUIRE ROOT PRUNING, FERTILIZATION OR ANY OTHER HORTICULTURAL ACTIVITIES NOT SPECIFIED IN THE CONTRACT DRAWINGS, THE LANDSCAPE ARCHITECT SHOULD BE NOTIFIED PRIOR TO THE WORK. SAID HORTICULTURAL ACTIVITIES SHALL BE PERFORMED ONLY BY A QUALIFIED ARBORIST UNLESS APPROVED BY THE LANDSCAPE ARCHITECT AND SHALL BE AT THE CONTRACTOR'S EXPENSE IF DUE TO HIS NEGLIGENCE.
- IF THE CONTRACTOR DAMAGES A TREE TO BE PROTECTED SO THAT IT DOES NOT SURVIVE HE SHALL BE RESPONSIBLE FOR REPLACING THE TREE IN KIND OR REPLACING IT WITH TREES ABOUT THE SAME NUMBER OF CALIPER INCHES (MEASURED 6" ABOVE THE GROUND). THE LANDSCAPE ARCHITECT IS TO APPROVE THE REPLACEMENT TREES.

FENCING SHALL BE LOCATED AS SHOWN ON THE TREE PRESERVATION PLAN (LTI-0). FENCE SHALL BE PLACED SO THAT THE POSTS FACE THE TREE. AFTER INSTALLING ALL POSTS, TIGHTLY WRAP THE FABRIC ACROSS THE POSTS TO PREVENT SAGGING. POSTS SHALL BE PLACED A MAXIMUM OF 6' ON CENTER. SAFETY FENCE FABRIC SHALL BE ORANGE CONTRACTOR'S GRADE SMOOTH TOP DIAMOND PLASTIC FENCE. POSTS SHALL BE 6" LONG HEAVY DUTY GALVANIZED STEEL T-POSTS, SET TO A DEPTH OF 2' BELOW GRADE. POST SHALL NOT BE DRIVEN INTO EXISTING ROOTS. LOCKING TIES SHALL BE 3" PLASTIC LOCKING ZIP TIES, 4 PER POST. ANY ALTERATIONS TO THE FENCING LAYOUT MUST BE APPROVED BY LANDSCAPE ARCHITECT.

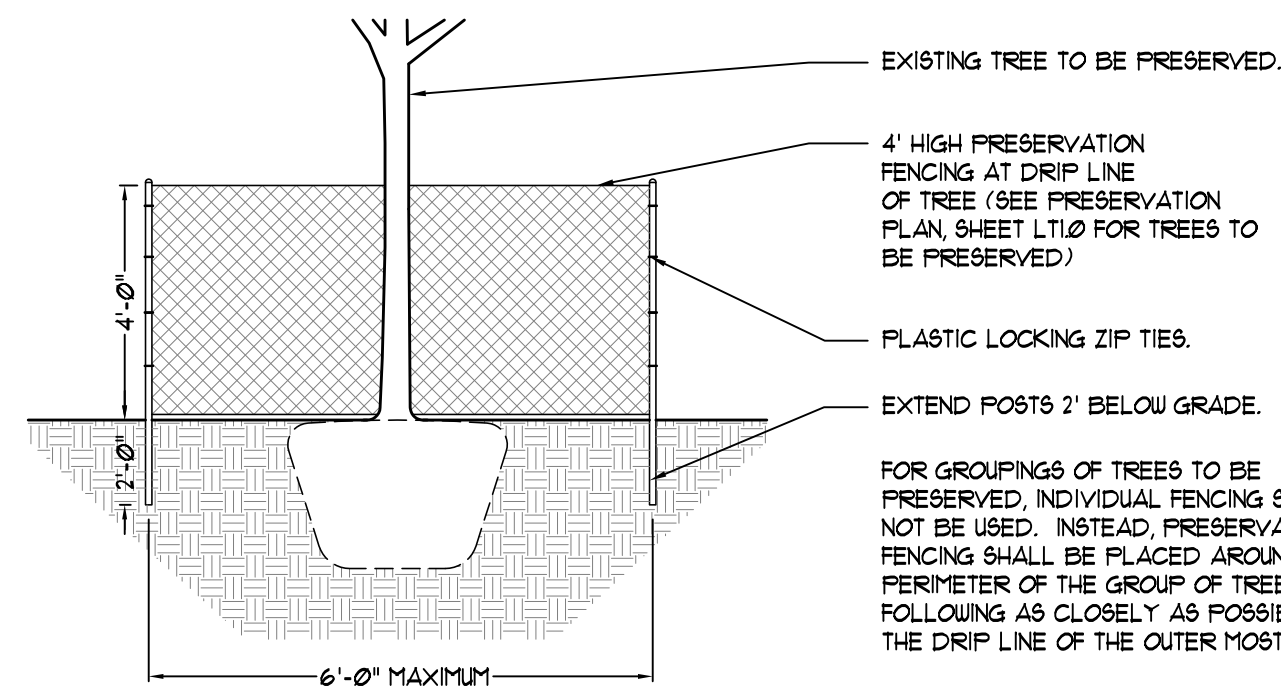

1 TREE PRESERVATION DETAIL - SNOW MESH FENCING
NOT TO SCALE

LOCATE ALL UNDERGROUND UTILITIES PRIOR TO DIGGING. TREE PIT WIDTH TO BE EXTENDED 12" AROUND THE ENTIRE ROOT BALL AS SHOWN IN THE DETAIL BELOW. TEST TREE PIT FOR DRAINAGE PRIOR TO INSTALLING TREE. PRUNE OFF ALL DEAD, BROKEN OR SCARRED BRANCHES, AND SHAPE PRUNE AS DIRECTED BY THE LANDSCAPE ARCHITECT. FOR TREES UP TO 4" CALIPER OR 12' HEIGHT, REMOVE APPROXIMATELY 5%-10% OF THE OVERALL BRANCHING. LOCATE ROOT FLARE IN ROOT BALL AND SET TREE HEIGHT SO THAT ROOT FLARE IS FLUSH WITH FINISH GRADE. WATER IN THE PLANTING MIX THOROUGHLY, WHILE KEEPING THE TREE PLUMB. STRAIGHTEN TREE IF SETTLING OCCURS. CONTRACTOR TO UN-TIE AND REMOVE TWINE FROM AROUND ROOT FLARE OF TREE AT THE END OF THE WARRANTY PERIOD.

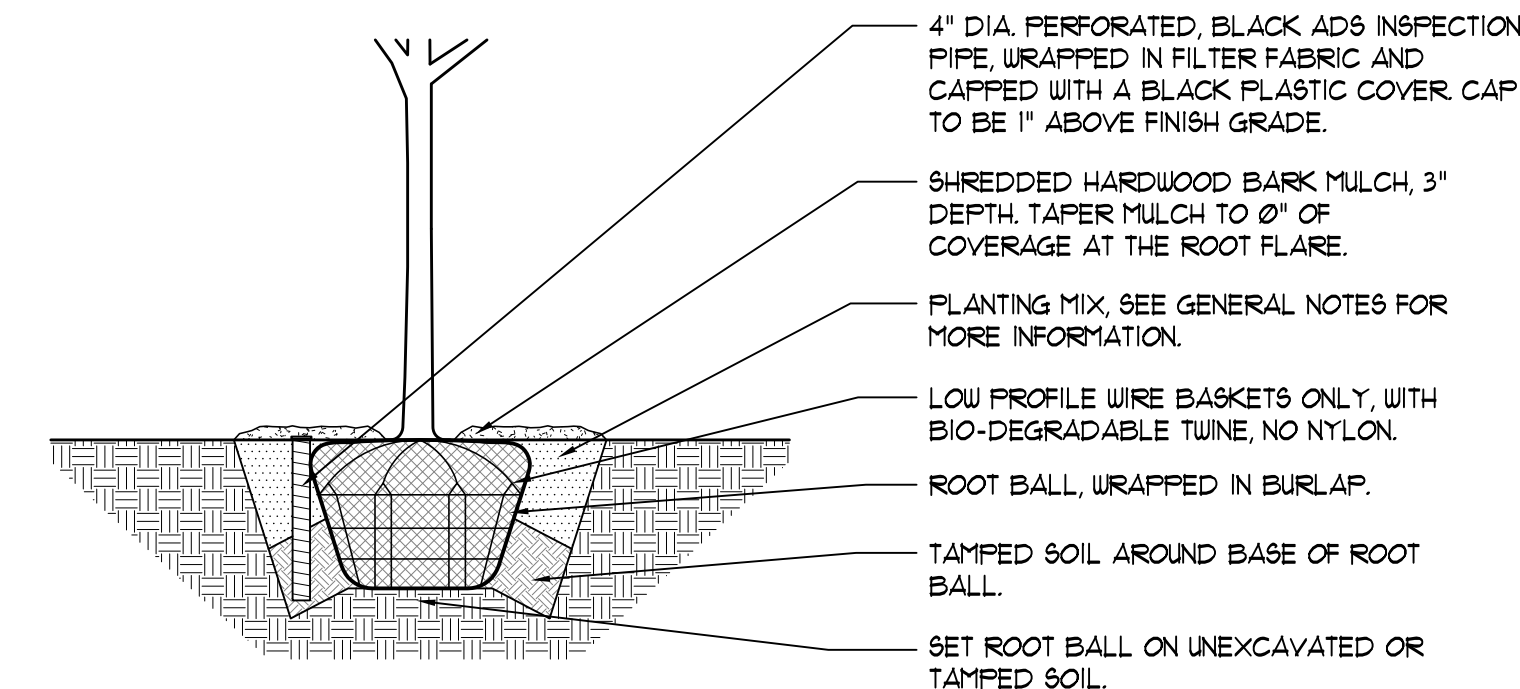

2 DECIDUOUS TREE PLANTING DETAIL
NOT TO SCALE

LOCATE ALL UNDERGROUND UTILITIES PRIOR TO PLANTING. SHRUBS BEDS ARE TO BE EXCAVATED AS A SINGLE SHRUB PIT. EXTEND SHRUB PIT WIDTH TO EDGES OF PLANT BED AS SHOWN ON THE LANDSCAPE PLAN. LOCATE ROOT FLARE IN ROOT BALL AND SET SHRUB HEIGHT SO THAT ROOT FLARE IS FLUSH WITH FINISH GRADE. REMOVE TWINE FROM ROOT FLARE. BACKFILL AND WATER IN THE PLANTING MIX THOROUGHLY, WHILE KEEPING THE SHRUB PLUMB. STRAIGHTEN SHRUB IF SETTLING OCCURS. PRUNE OFF ALL DEAD, BROKEN OR SCARRED BRANCHES, AND SHAPE PRUNE AS DIRECTED BY THE LANDSCAPE ARCHITECT. MULCH LIMITS FOR SHRUBS SHALL EXTEND TO ALL OUTER EDGES OF PLANTING BEDS, SEE LANDSCAPE PLAN FOR BED LAYOUTS.

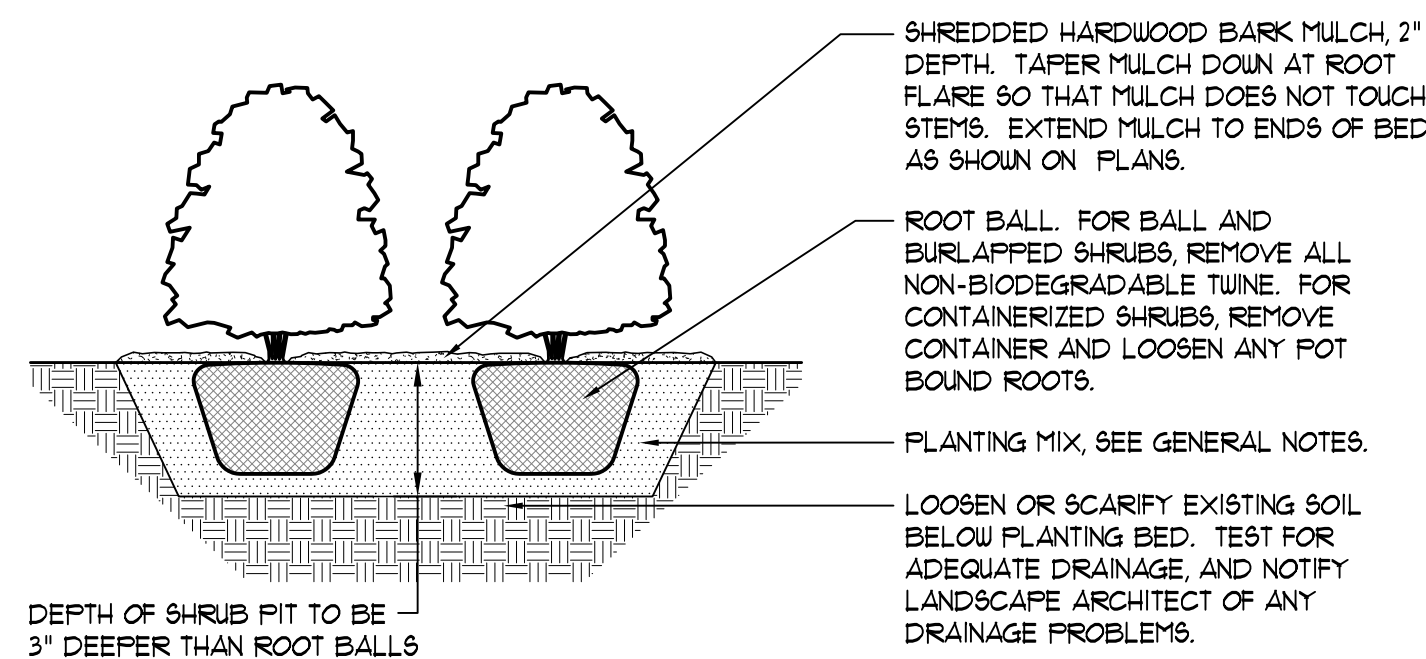

3 SHRUB PLANTING DETAIL
NOT TO SCALE

LOCATE ALL UNDERGROUND UTILITIES PRIOR TO DIGGING. EXCAVATE ENTIRE PERENNIAL / GROUNDCOVER BED, AND BACKFILL WITH PLANTING MIX AS SPECIFIED. BED HEIGHT IS TO BE 2" ABOVE FINISH GRADE AND WELL DRAINED. MULCH LIMITS FOR PERENNIAL BEDS TO EXTEND TO ALL EDGES OF THE BEDS, SEE PLANS FOR BED LAYOUTS. SEE PLANT LIST FOR PLANT SPACING. GAPS BETWEEN PLANTS SHALL BE NO GREATER THAN THE SPECIFIED SPACING FOR THAT PARTICULAR PLANT.

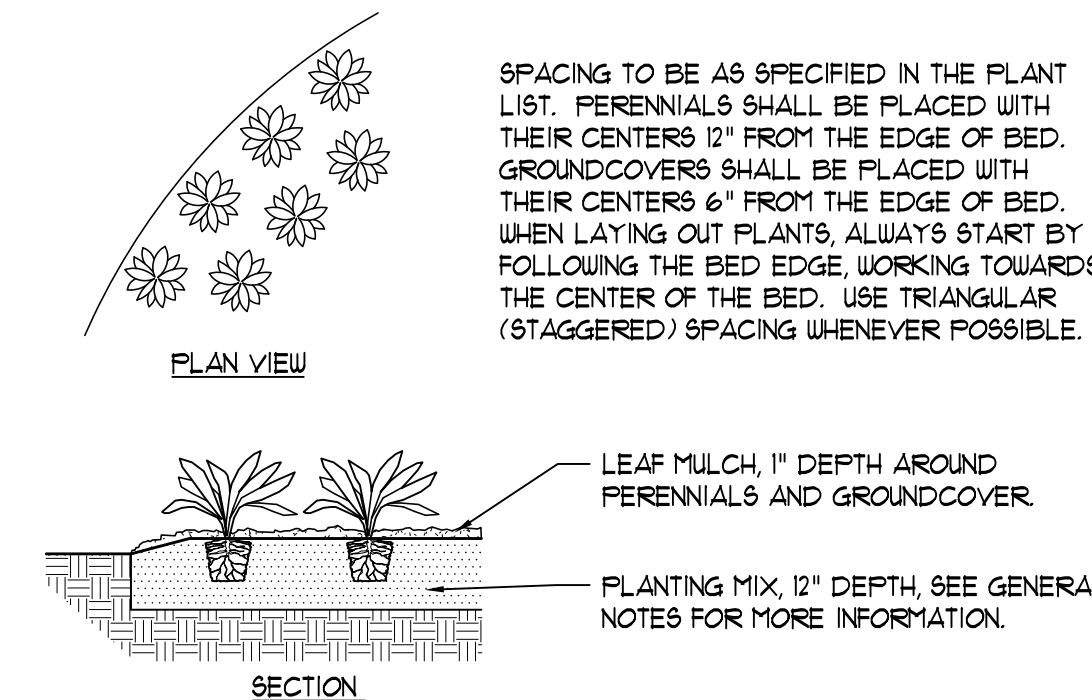

4 PERENNIAL AND GROUNDCOVER PLANTING DETAIL
NOT TO SCALE

SHEET NO.	TITLE	DRAWN BY	DATE	REV	DATE	DESCRIPTION	BY
L-2.0	LANDSCAPE DETAILS	M/M	1/19/17	W/S	1/19/17	MCDONALD'S - WAUKESHA, WI	W

PREPARED BY: **McDonald's USA, LLC**
 These drawings and specifications are the confidential and proprietary property of McDonald's USA, LLC. They are not to be copied or reproduced without the written consent of McDonald's USA, LLC. Use of these drawings for use on a different site or at a later time. Use of the services of properly licensed architects and engineers. Reproduction of the contract documents for reuse on another project is not authorized.

PREPARED BY: **V3 Companies**
 7325 Janes Avenue
 Woodridge, IL 60517
 630.724.9200 phone
 630.724.9202 fax
 www.v3co.com