

N. GREENFIELD AVE

E. BROADWAY

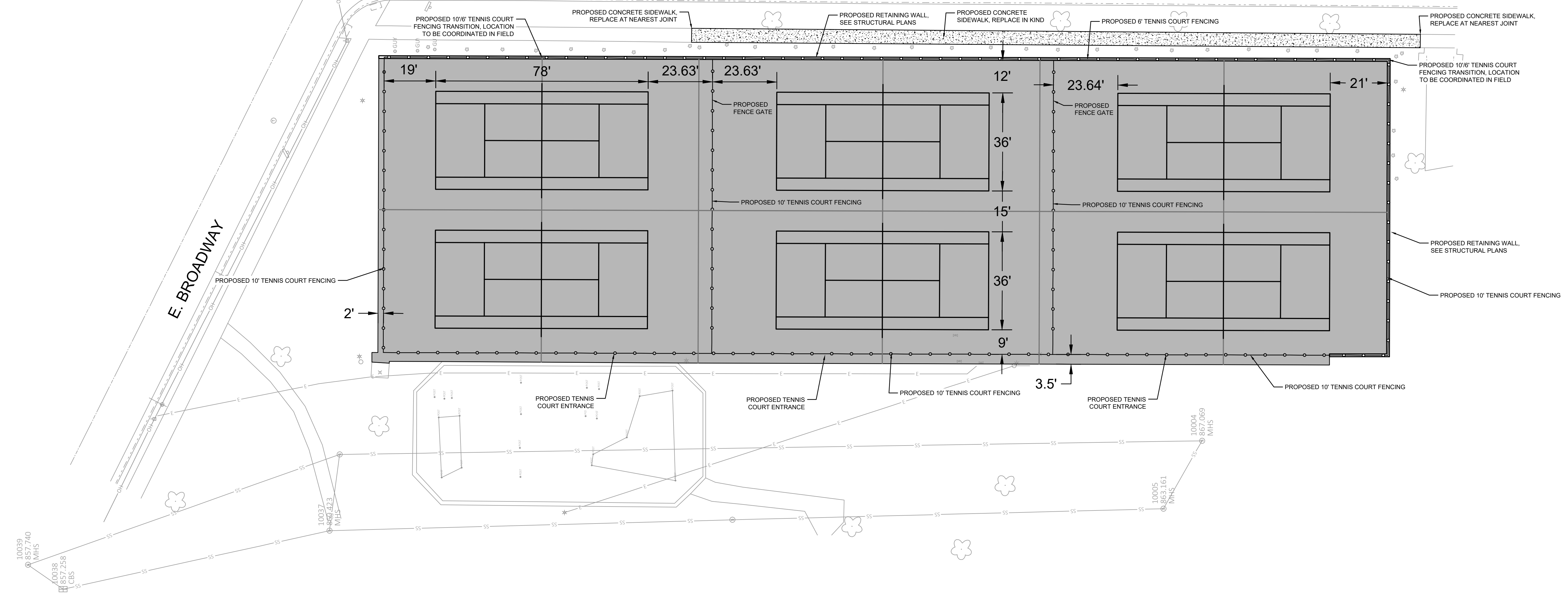

PROPOSED FEATURES

- STRUCTURAL RETAINING WALL
- PROPOSED COURT FENCE
- EDGE OF ASPHALT
- STANDARD-DUTY ASPHALT PAVEMENT
- CONCRETE SIDEWALK
- PROPOSED COURT LAYOUT
- PROPOSED CONTROL JOINT

THE LOCATIONS OF EXISTING UTILITY INSTALLATIONS AS SHOWN ON THIS PLAN ARE APPROXIMATE. THERE MAY BE OTHER UNDERGROUND UTILITY INSTALLATIONS WITHIN THE PROJECT AREA THAT ARE NOT SHOWN. THE CONTRACTOR SHALL BE RESPONSIBLE FOR VERIFYING THE EXISTENCE AND LOCATION OF ALL UNDERGROUND UTILITIES.

R.A. SMITH, INC. ASSUMES NO RESPONSIBILITY FOR DAMAGES, LIABILITY OR COSTS RESULTING FROM CHANGES OR ALTERATIONS MADE TO THIS PLAN WITHOUT THE EXPRESSED WRITTEN CONSENT OF R.A. SMITH, INC.



**Know what's below.
Call before you dig.**

R.A. SMITH, INC. ASSUMES NO RESPONSIBILITY FOR DAMAGES, LIABILITY OR COSTS RESULTING FROM CHANGES OR ALTERATIONS MADE TO THIS PLAN WITHOUT THE EXPRESSED WRITTEN CONSENT OF R.A. SMITH, INC.

DATE	DESCRIPTION

16745 W. Bluemound Road
Brookfield, WI 53005-5938
(262) 781-1000
rasmith.com

raSmith
CREATIVITY BEYOND ENGINEERING

Brookfield, WI | Milwaukee, WI | Appleton, WI | Madison, WI
Cedarburg, WI | Naperville, IL | Irvine, CA

**BUCHNER PARK TENNIS COURTS
CITY OF WAUKESHA**

SITE PLAN

© COPYRIGHT 2021 R.A. Smith, Inc.
DATE: 04/16/2021
SCALE: 1" = 20'
JOB NO. 3200313
PROJECT MANAGER: LUKE HAAS, P.L.A.
DESIGNED BY: CDC
CHECKED BY: LJH
SHEET NUMBER
C100

P:\200313\Drawings\Sheets\3200313_SFP01.dwg - SITE PLAN - 4/16/2021 8:00:54 AM - cdc