

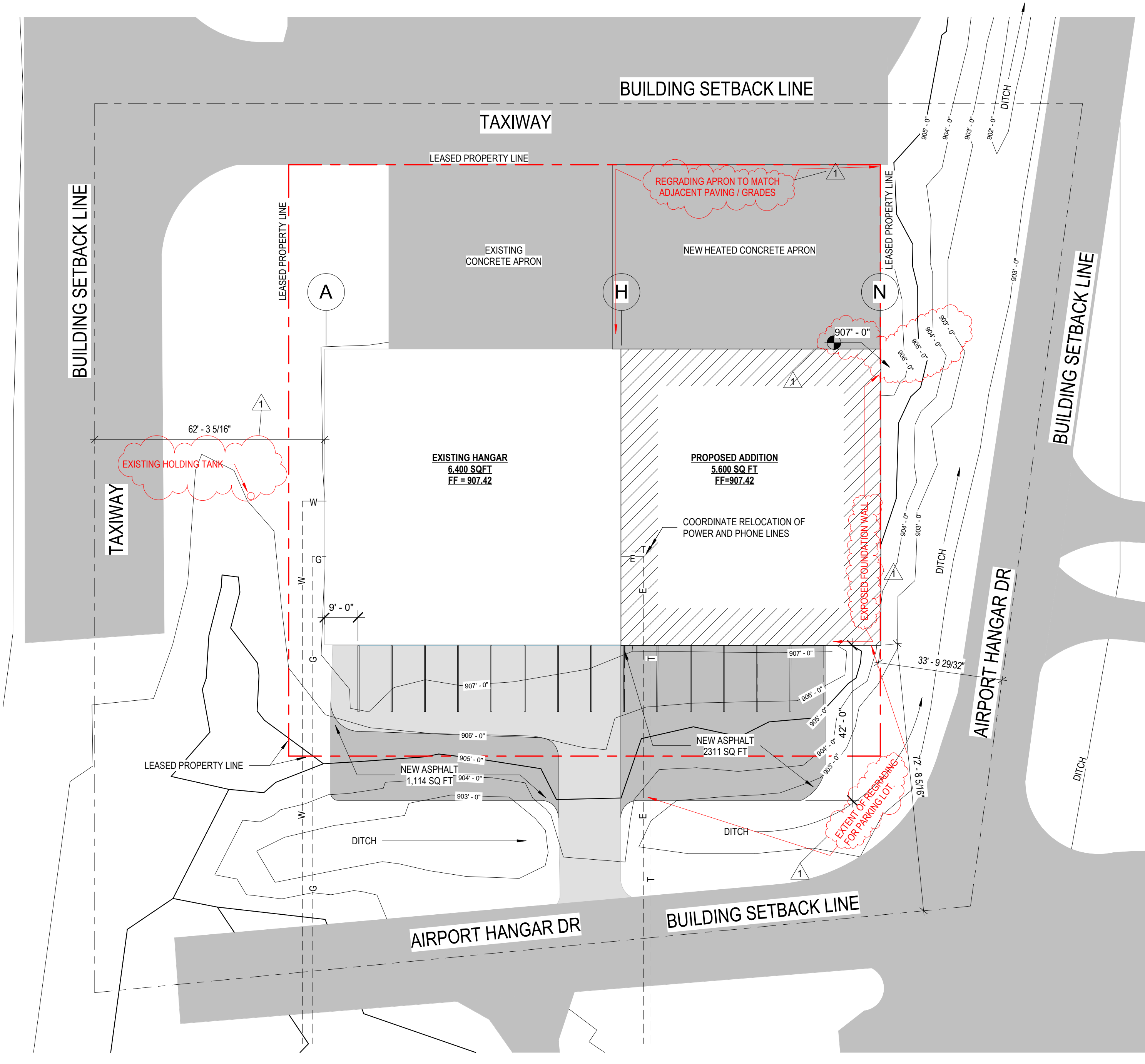

# HANGAR ADDITION

556 & 558 NORTHVIEW RD  
WAUKESHA, WI

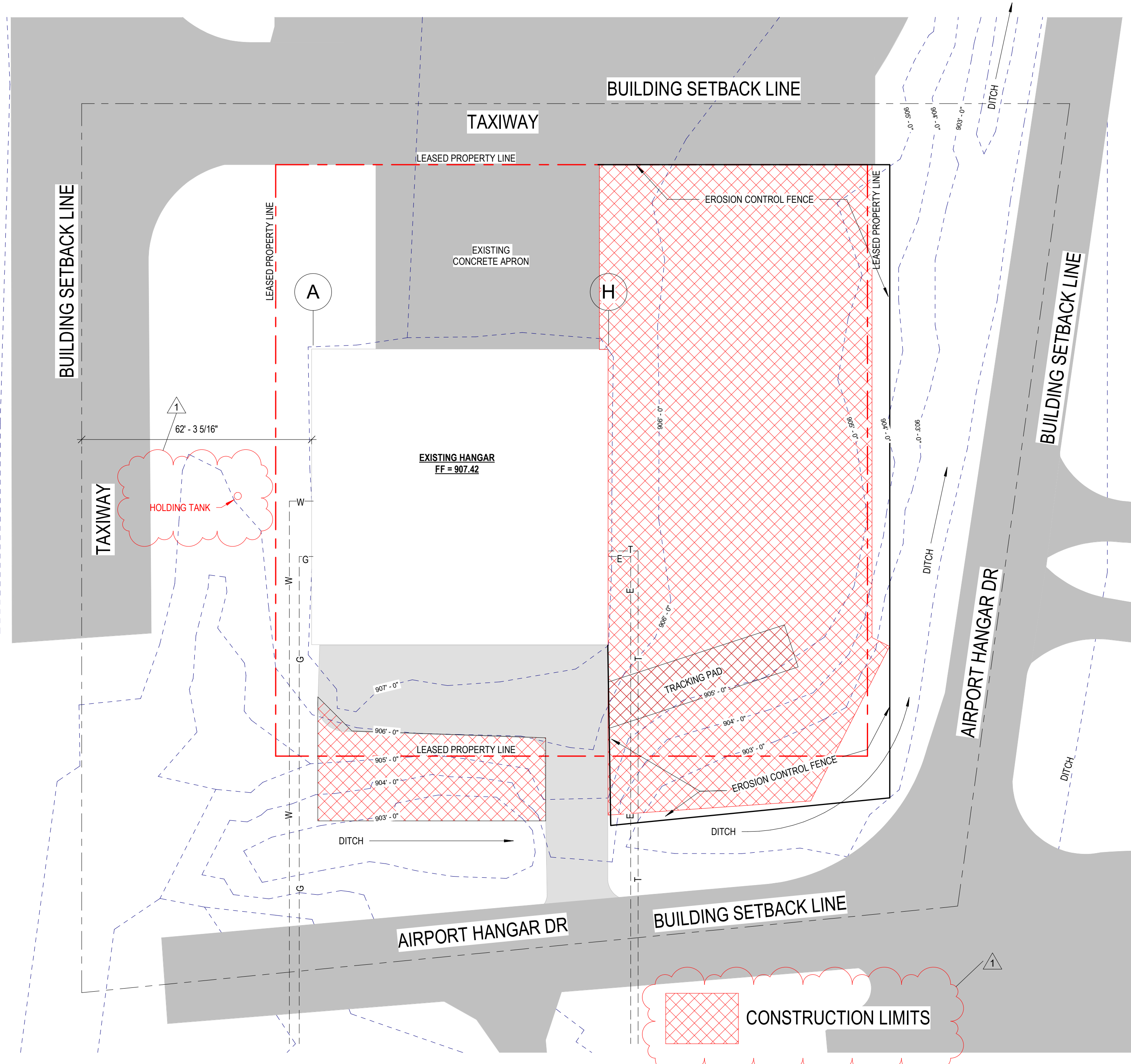

2 Existing Site  
1" = 20'-0"

3 Proposed Site  
1" = 20'-0"

\*All site improvements and construction shown on the plans shall conform to the City of Waukesha Development Handbook & Infrastructure Specifications. Where the plans do not comply, it shall be the sole responsibility and expense of the Developer to make revisions to the plans and/or constructed infrastructure to comply.\*

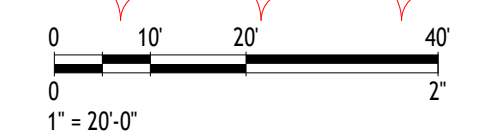

- DOOR NOTE:**
- LANDINGS TO BE PROVIDED AT ALL EGRESS DOORS.
  - LANDING CLEARANCES TO MATCH "ADA DOOR CLEARANCES" UNLESS EGRESS DOOR IS "EXIT ONLY", THEN A CLEAR FLOOR SPACE OF 36"x60" IS REQUIRED AT THE LANDING.
  - THRESHOLDS AT DOORWAYS SHALL BE 1/2" MAX. IN HEIGHT
  - LANDINGS SHALL HAVE A SLOPE & CROSS SLOPE NOT STEEPER THAN 1:48.

**REVISIONS**

No.	DATE	DESCRIPTION
1	09.13.2024	Revision 1

**WAUKESHA PLAN APPROVAL**

SHEET TITLE:	SITE PLAN
JOB NUMBER:	22056
ISSUED DATE:	08 26 2024
DRAWN BY:	BEC
SHEET NUMBER:	C1.0

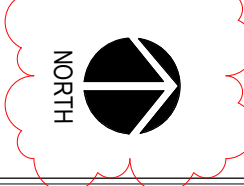



NOTE: THE LOCATION AND SIZE OF THE UNDERGROUND STRUCTURES AND UTILITIES SHOWN HEREON HAVE BEEN LOCATED TO A REASONABLE DEGREE OF ACCURACY, BUT THE ENGINEER AND/OR SURVEYOR DOES NOT GUARANTEE THEIR EXACT LOCATION OR THE LOCATION OF OTHERS NOT SHOWN. CONTACT DIGGERS HOTLINE, INC., ETC.

TO OBTAIN LOCATIONS OF PARTICIPANTS UNDERGROUND FACILITIES BEFORE YOU DIG IN WISCONSIN  
CALL DIGGERS HOTLINE TOLL FREE 1-800-255-8151  
WI STATUTE 182.0175(1)(F)4, REQUIRES MIN. 3 WORK DAYS NOTICE BEFORE YOU EXCAVATE  
MILWAUKEE AREA 259-1181

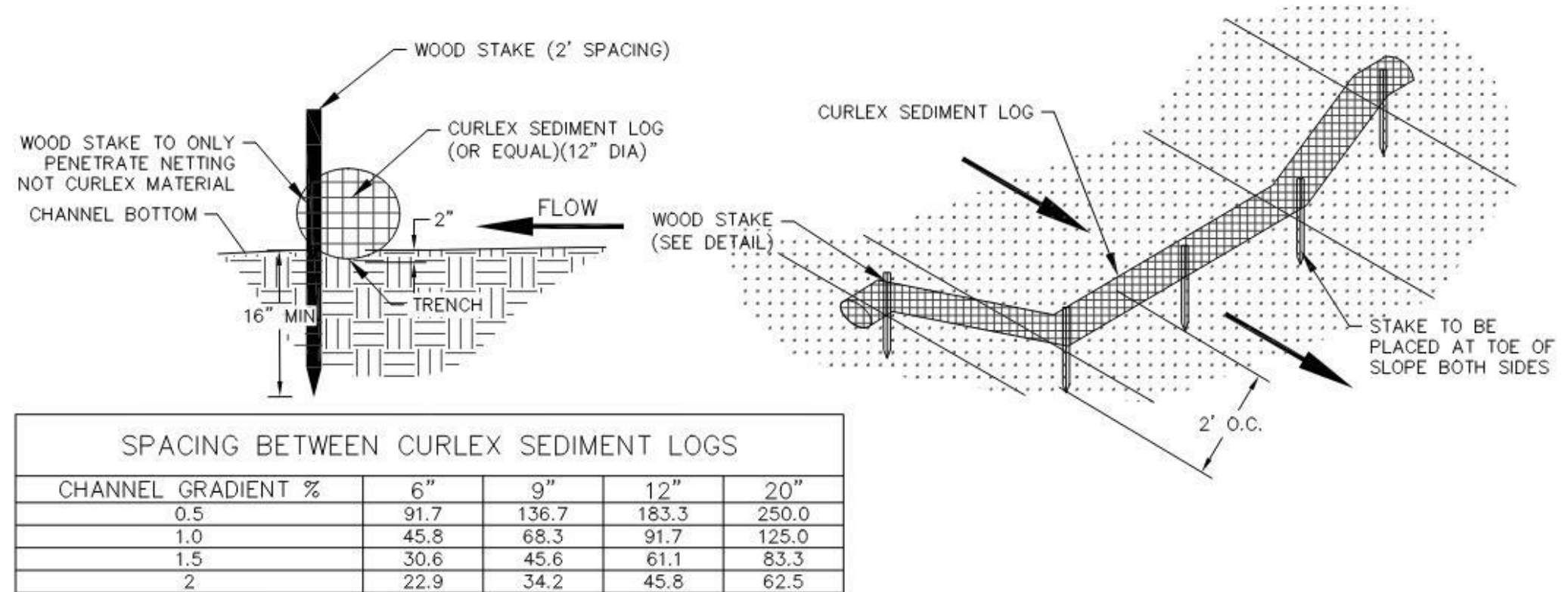

SPACING BETWEEN CURLEX SEDIMENT LOGS				
CHANNEL GRADIENT %	6"	9"	12"	20"
0.5	91.7	136.7	183.3	250.0
1.0	45.8	68.3	91.7	125.0
1.5	30.6	45.6	61.1	83.3
2	22.9	34.2	45.8	62.5

SEDIMENT LOG DETAIL

1 Erosion Control Sediment Log DTL  
1/4" = 1'-0"

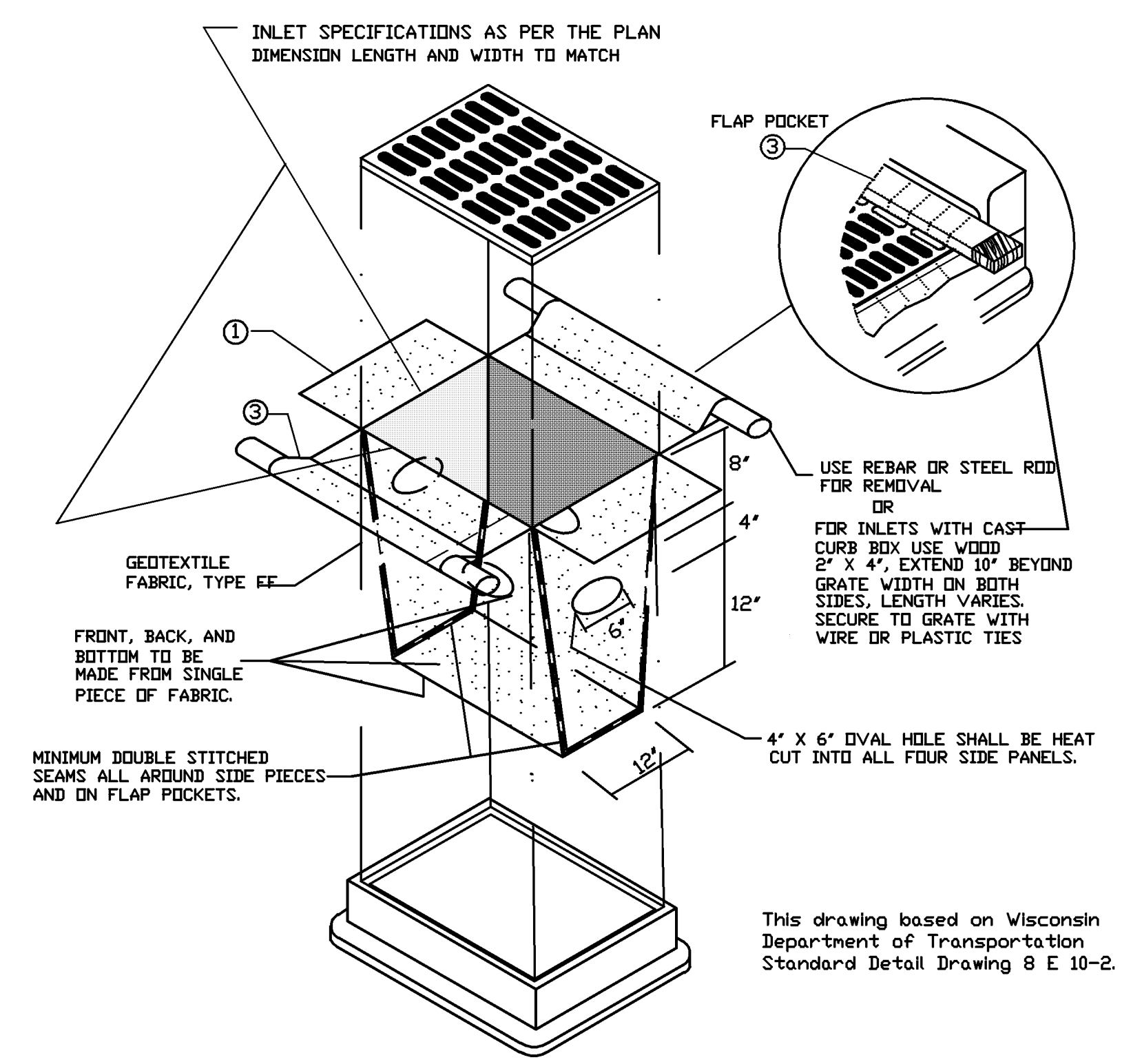

INLET PROTECTION, TYPE D  
(CAN BE INSTALLED IN ANY INLET TYPE WITH OR WITHOUT A CURB BOX AS PER NOTE 2)

**GENERAL NOTES**  
MANUFACTURED ALTERNATIVES APPROVED AND LISTED ON THE DEPARTMENT'S EROSION CONTROL PRODUCT ACCEPTABILITY LIST MAY BE SUBSTITUTED.  
WHEN REMOVING OR MAINTAINING INLET PROTECTION, CARE SHALL BE TAKEN SO THAT THE SEDIMENT TRAPPED ON THE GEOTEXTILE FABRIC DOES NOT FALL INTO THE INLET. ANY MATERIAL FALLING INTO THE INLET SHALL BE REMOVED IMMEDIATELY.  
1 FINISHED SIZE, INCLUDING FLAP POCKETS WHERE REQUIRED, SHALL EXTEND A MINIMUM OF 10' AROUND THE PERIMETER TO FACILITATE MAINTENANCE OR REMOVAL.  
2 FOR INLET PROTECTION, TYPE C (WITH CURB BOX), AN ADDITIONAL 18" OF FABRIC IS WRAPPED AROUND THE WOOD AND SECURED WITH STAPLES. THE WOOD SHALL NOT BLOCK THE ENTIRE HEIGHT OF THE CURB BOX OPENING.  
3 FLAP POCKETS SHALL BE LARGE ENOUGH TO ACCEPT WOOD 2X4.

**INSTALLATION NOTES**  
TYPE D  
DO NOT INSTALL INLET PROTECTION TYPE D IN INLETS SHALLOWER THAN 30", MEASURED FROM THE BOTTOM OF THE INLET TO THE TOP OF THE GRATE.  
TRIM EXCESS FABRIC IN THE FLOW LINE TO WITHIN 3" OF THE GRATE.  
THE INSTALLED BAG SHALL HAVE A MINIMUM SIDE CLEARANCE, BETWEEN THE INLET WALLS AND THE BAG, MEASURED AT THE BOTTOM OF THE OVERFLOW HOLES, OF 3". WHERE NECESSARY THE CONTRACTOR SHALL CINCH THE BAG, USING PLASTIC ZIP TIES, TO ACHIEVE THE 3" CLEARANCE. THE TIES SHALL BE PLACED AT A MAXIMUM OF 4' FROM THE BOTTOM OF THE BAG.

3 Inlet Protection DTL  
1/4" = 1'-0"

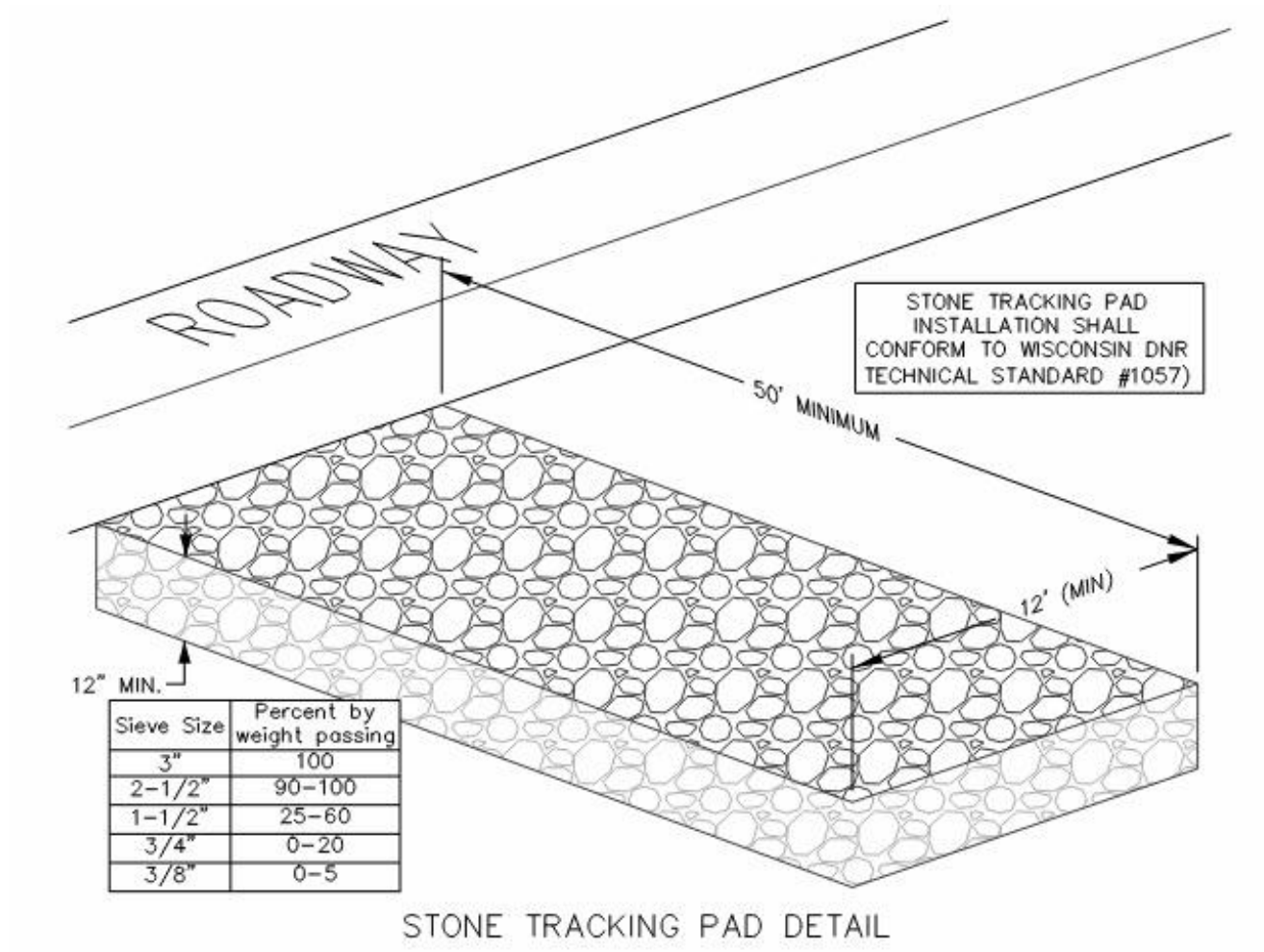

4 Tracking Pad  
1/4" = 1'-0"

**GENERAL NOTES**  
1. TRENCH SHALL BE A MINIMUM OF 4" WIDE & 6" DEEP TO BURY AND ANCHOR THE GEOTEXTILE FABRIC. FOLD MATERIAL TO FIT TRENCH AND BACKFILL & COMPACT TRENCH WITH EXCAVATED SOIL.  
2. WOOD POST SHALL BE A MINIMUM SIZE OF 1 1/8" X 1 1/8" OF OAK OR HICKORY.  
3. CONSTRUCT SILT FENCE FROM A CONTINUOUS ROLL IF POSSIBLE BY CUTTING LENGTHS TO AVOID JOINTS. IF A JOINT IS NECESSARY, USE ONE OF THE FOLLOWING TWO METHODS:  
A) TWIST METHOD -- OVERLAP THE END POST AND TWIST, OR ROTATE, AT LEAST 180 DEGREES, OR  
B) HOOK METHOD -- HOOK THE END OF EACH SILT FENCE LENGTH.

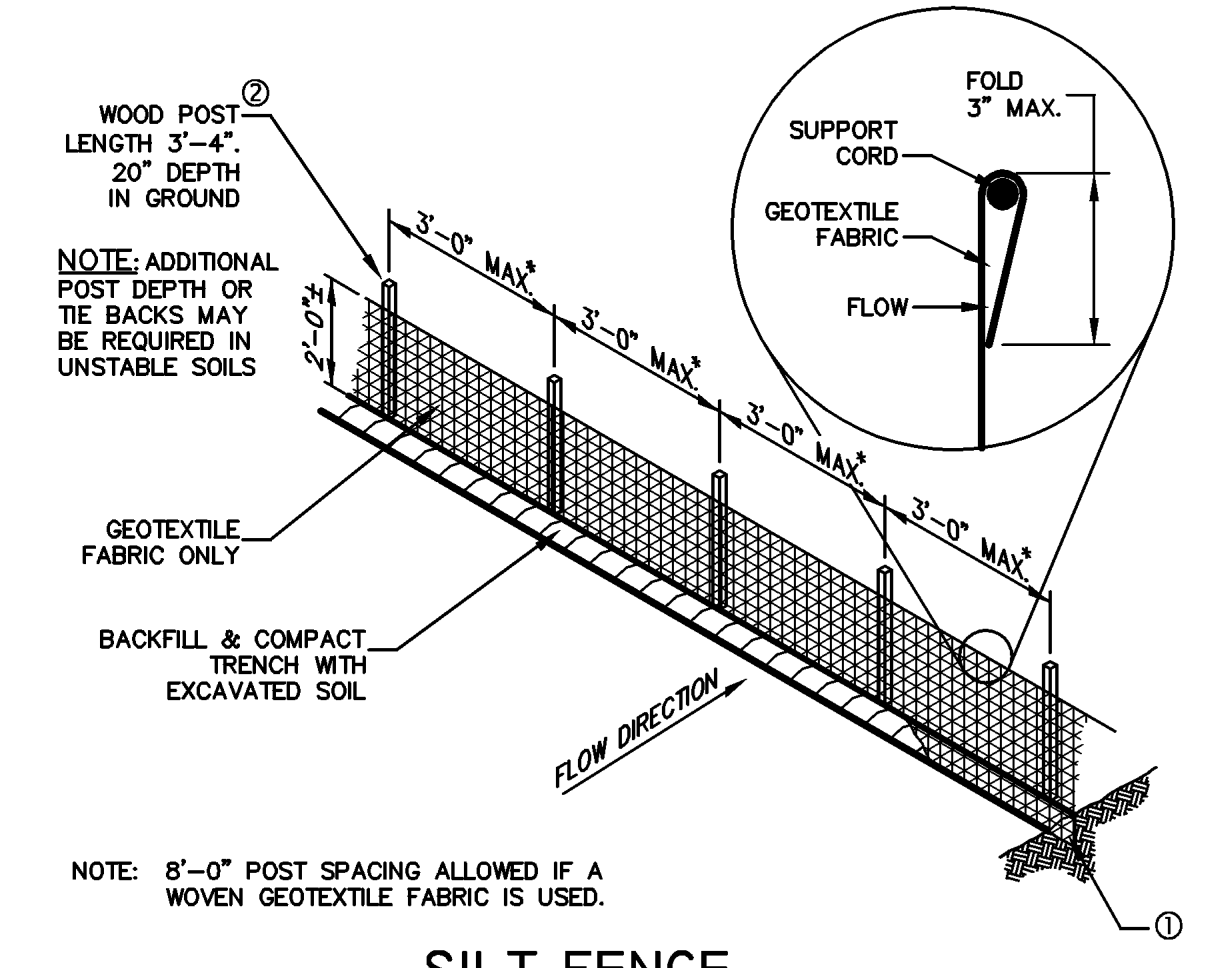

SILT FENCE

SILT FENCE TO BE INSTALLED IN ACCORDANCE WITH WISCONSIN DEPARTMENT OF NATURAL RESOURCES CONSERVATION PRACTICE STANDARD 1056 (THIS DRAWING BASED ON WISCONSIN DEPARTMENT OF TRANSPORTATION DETAIL DRAWING 8 E 9-6)

2 Erosion Control Fence DTL  
1/4" = 1'-0"

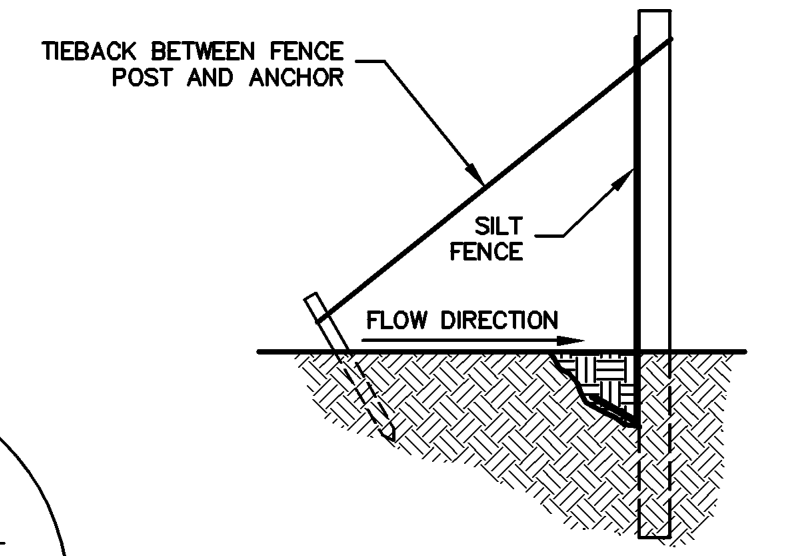

SILT FENCE TIE BACK  
(WHEN ADDITIONAL SUPPORT REQUIRED)

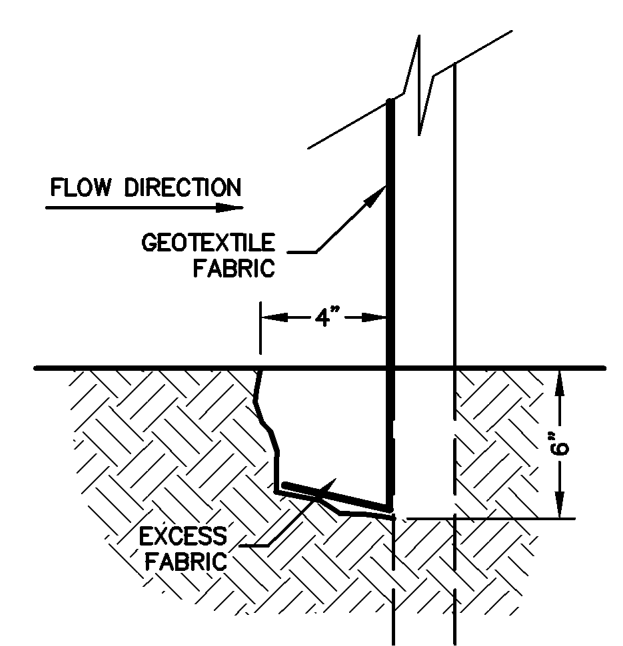

TRENCH DETAIL

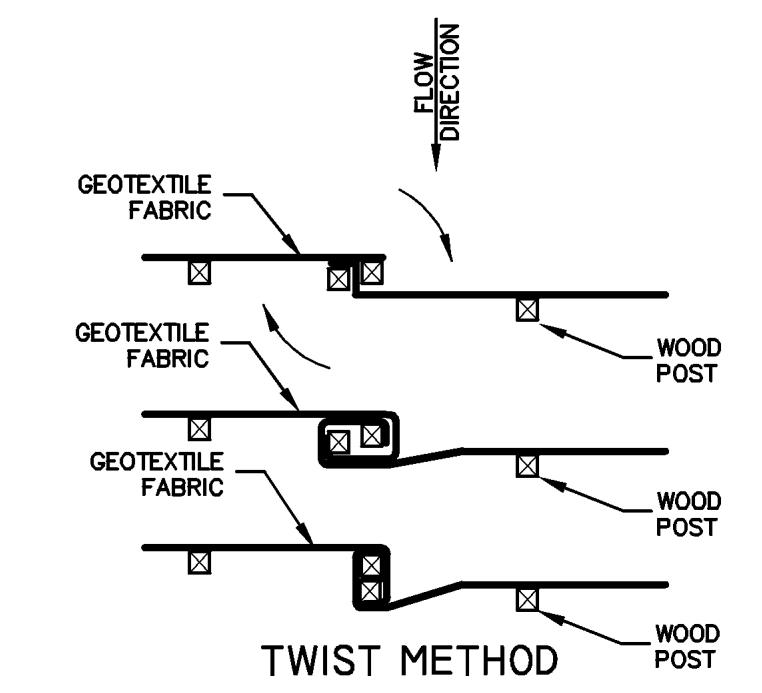

TWIST METHOD

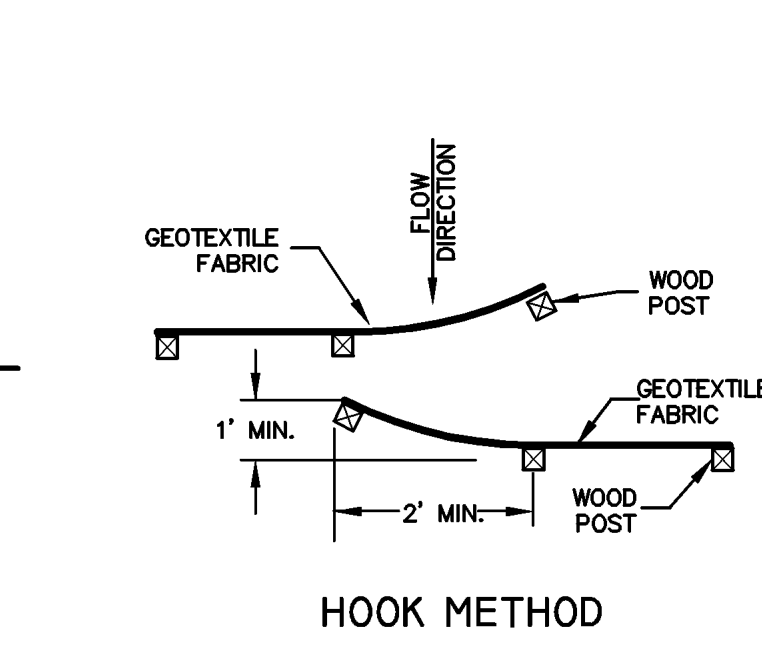

HOOK METHOD

JOINING TWO LENGTHS OF SILT FENCE

**HANGAR ADDITION**  
556 & 558 NORTHVIEW RD  
WAUKESHA, WI

**REVISIONS**

No.	DATE	DESCRIPTION

**WAUKESHA PLAN APPROVAL**

SHEET TITLE: CIVIL DETAILS  
JOB NUMBER: 22056  
ISSUED DATE: 08 26 2024  
DRAWN BY: BEC  
SHEET NUMBER:

**C1.1**