



PROPOSAL

ALL PURCHASE ORDERS, CONTRACTS, AND CHECKS TO BE MADE OUT TO:
LANDSCAPE STRUCTURES, INC.
 601 7TH STREET SOUTH
 DELANO, MN 55328 U.S.A.
763-972-3391 800-328-0035
Fax: 763-972-3185



Sourcewell Contract No. 010521-LSI

Customer Information

CONTACT: Melissa Lipska
PHONE 262-524-3721
FAX: 262-524-3713
email: mlipska@waukesha-wi.gov
SHIP TO: Horeb Springs Park
Maintenance City of Waukesha
Kit/Info ? Parks, Recreation & Forestry Department
1900 Aviation Drive Waukesha, WI 53188
BILL TO: _____

Destination _____
 F.O.B. _____

FREIGHT

Net 30 days upon credit approv., deposit may be required
 TERMS (Subject To Credit Approval By LSI)

To be determined upon order

SHIPPING TIME

Pricing Good for 60 days from Date of Proposal

We are pleased to submit this proposal to supply the following items:

QTY	ITEM NO.	DESCRIPTION	UNIT WT	UNIT PRICE	WEIGHT	EXTENDED AMT
Project Name:						
1		New Landscape Structures play equipment, per attached 2D, 3Ds & Component List for Horeb Springs Design on 5.16.22	9,531	139,354.00	9,531	\$ 139,354.00
1		8% Discount on equipment through contract		(11,148.00)	-	\$ (11,148.00)
					-	\$ -
					-	\$ -
					-	\$ -
					-	\$ -
					-	\$ -
					-	\$ -
					-	\$ -
					-	\$ -
					-	\$ -
					-	\$ -
					-	\$ -
					-	\$ -
					-	\$ -
					-	\$ -
					-	\$ -
Total Weight					9,531	
SUBTOTAL MATERIAL						\$ 128,206.00
Standard Terms and Conditions for Installation Apply						
						INSTALLATION
						Not Included
						FREIGHT
						Billed separately
						SALES TAX
						TOTAL
						\$ 128,206.00

SIGNATURE BELOW ACCEPTING THIS PROPOSAL WILL CONSTITUTE A PURCHASE ORDER ONLY UPON APPROVAL BY LANDSCAPE STRUCTURES, INC. CUSTOMER RECEIPT OF AN ORDER ACKNOWLEDGEMENT CONSTITUTES SUCH APPROVAL.

ACCEPTED BY CUSTOMER _____ DATE _____
 PRINT NAME
 Gerber Leisure Products, Inc. _____ 5/16/2022
 PROPOSED BY LSI REPRESENTATIVE _____ DATE _____
 Meghan Barrett
 PRINT NAME

Taxable: Freight _____ Installation _____

Horeb Springs Park

Date:05/16/2022
By:KLP

Rep Organization: Gerber Leisure Products
Contact Person: Meghan Barrett

Quote No: 5.16.22

Project Title: Horeb Springs Park

Location: Waukesha, WI

PlayBooster® (5-12 years)						
PHASE-1 Direct Bury Mixed Material			UNIT		TOTAL	
QTY	NO.	DESCRIPTION	WEIGHT (lb)	PRICE (US \$)	WEIGHT (lb)	PRICE (2022)
PlayBooster®						
Climbers Other						
1	302740A	Tidal Wave Climber 56"Dk DB			498.0	10,705.00
Climbers W/Permalene Handholds						
1	229832A	Dot-to-Dot Climber			204.0	2,666.00
1	200609A	Traveler Climber w/2 Hanger Brackets			351.0	10,475.00
1	272084A	Wood Plank Ladder w/Permalene Handholds 72" Deck DB			137.0	1,836.00
Decks						
6	122197A	90* Triangular Tenderdeck	66.0	1,020.00	396.0	6,120.00
1	152911B	Curved Transfer Module Left 40"Dk DB			240.0	3,269.00
2	121948A	Kick Plate 8"Rise	13.0	138.00	26.0	276.00
2	111228A	Square Tenderdeck	118.0	1,214.00	236.0	2,380.00
3	121949A	Tri-Deck Kick Plate 8"Rise	13.0	199.00	39.0	597.00
Enclosures						
1	164092A	Bongo Panel Above Deck			53.0	1,173.00
1	117957A	Periscope Panel Above Deck			63.0	1,923.00
1	119514A	Pilot Panel Above Deck			54.0	1,326.00
1	116244A	Pipe Barrier Above Deck			51.0	740.00
2	116244B	Pipe Barrier w/Wheel Above Deck	57.0	969.00	114.0	1,938.00
1	115254A	Storefront Panel			24.0	740.00
Motion & More Fun						
1	111357A	Chinning Bar Alum DB			41.0	632.00
1	153165A	Stationary Cyclor Accessible			22.0	576.00
Posts						
1	111404E	116"Alum Post DB			29.0	362.00
1	111404D	124"Alum Post DB			30.0	423.00
1	111404C	132"Alum Post DB			31.0	439.00
3	111404A	148"Alum Post DB	36.0	464.00	108.0	1,392.00
5	111404L	164"Alum Post DB	38.0	546.00	190.0	2,730.00
3	111404Z	182"Steel Post DB 44" Bury	105.0	551.00	315.0	1,653.00
2	154883A	265"Steel Post (60" Bury) For CoolTopper Single Post Pyramid Roof	222.0	1,685.00	444.0	2,336.00
Roofs						

Horeb Springs Park

Date:05/16/2022
By:KLP

Rep Organization: Gerber Leisure Products
Contact Person: Meghan Barrett

Quote No: 5.16.22

Project Title: Horeb Springs Park

Location: Waukesha, WI

PlayBooster® (5-12 years)						
PHASE-1 Direct Bury Mixed Material			UNIT		TOTAL	
QTY	NO.	DESCRIPTION	WEIGHT (lb)	PRICE (US \$)	WEIGHT (lb)	PRICE (2022)
2	154884A	CoolToppers Single Post Pyramid Roof DB Only1	145.0	3,912.00	290.0	7,824.00
Slides						
1	130390A	Double Swoosh Slide 72"Dk DB1			174.0	2,795.00
1	124863C	SlideWinder2 48"Dk DB 1 Right 1 Left			178.0	3,086.00
1	222708A	WhooshWinder Slide 72"Dk DB1			346.0	5,982.00
Freestanding Play Climbers						
2	171569A	Mushroom Stepper 10"Height DB Only	127.0	1,112.00	254.0	2,224.00
1	171570A	Mushroom Stepper 16"Height DB Only			127.0	1,112.00
1	171571A	Mushroom Stepper 20"Height DB Only			151.0	1,464.00
Custom						
1	CP000251A	DTR IND Hillscape Wide Bottom Wave Climber Cedar			834.0	10,578.00
1	CP001964A	DTR IND Lily Pad Wobble Pod			317.0	3,325.00
Motion & More Fun						
1	205800A	TopsyTurny Spinner 42"Bury DB Only1			397.0	5,850.00
Signs						
1	182503C	Welcome Sign (LSI Provided) Ages 5-12 years Direct Bury			24.0	0.00
Sports & Fitness						
1	173596A	Log Balance Beam DB1			455.0	4,192.00
Swings						
2	174018A	Belt Seat ProGuard Chains for 8' Beam Height	8.0	148.00	16.0	296.00
1	237296A	Friendship Swing w/Single Post Frame 52" Bury ProGuard Chains			351.0	3,750.00
1	176038G	Full Bucket Seat ProGuard Chains for Toddler Swing			11.0	408.00
1	177345A	Single Post Swing Frame 52" Bury Additional Bay 8' Beam Height Only			148.0	1,193.00
1	177337A	Toddler Swing Add-On Beam			31.0	592.00

Horeb Springs Park

Date:05/16/2022
By:KLP

Rep Organization: Gerber Leisure Products
Contact Person: Meghan Barrett

Quote No: 5.16.22

Project Title: Horeb Springs Park

Location: Waukesha, WI

PlayBooster® (5-12 years)						
PHASE-1 Direct Bury Mixed Material			UNIT		TOTAL	
QTY	NO.	DESCRIPTION	WEIGHT (lb)	PRICE (US \$)	WEIGHT (lb)	PRICE (2022)

PlayBooster® (2-5 years)						
PHASE-1 Direct Bury Aluminum			UNIT		TOTAL	
QTY	NO.	DESCRIPTION	WEIGHT (lb)	PRICE (US \$)	WEIGHT (lb)	PRICE (2022)

PlayBooster®

Climbers Nature-Inspired

1	172666A	Corkscrew Climber w/Recycled Wood-Grain Handholds 32"Dk DB			97.0	2,162.00
1	169318C	Wood Plank Wiggle Ladder 48"Deck w/Recycled Wood-Grain Handholds DB			79.0	1,770.00

Custom

1	CP000247A	DTR PB Hillscape Wood-Grain handhold Set All Cedar			55.0	1,040.00
---	-----------	--	--	--	------	----------

Decks

2	122197A	90* Triangular Tenderdeck	66.0	1,020.00	132.0	2,040.00
1	184354A	Curved Transfer Module Left 2-5yrs 32"Dk DB			210.0	3,228.00
1	121948A	Kick Plate 8"Rise			13.0	138.00
1	111228A	Square Tenderdeck			118.0	1,214.00
1	121949A	Tri-Deck Kick Plate 8"Rise			13.0	199.00

Enclosures

1	116244B	Pipe Barrier w/Wheel Above Deck			57.0	969.00
1	115254A	Storefront Panel			24.0	740.00

Posts

2	111404F	108"Alum Post DB	28.0	352.00	56.0	704.00
1	111404E	116"Alum Post DB			29.0	362.00
3	111404D	124"Alum Post DB	30.0	423.00	90.0	1,269.00
1	154883B	249"Steel Post (60" Bury) For CoolTopper Single Post Pyramid Roof			211.0	1,112.00

Roofs

1	154884A	CoolToppers Single Post Pyramid Roof DB Only1			145.0	3,912.00
---	---------	---	--	--	-------	----------

Slides

Horeb Springs Park

Date:05/16/2022
By:KLP

Rep Organization: Gerber Leisure Products
Contact Person: Meghan Barrett

Quote No: 5.16.22

Project Title: Horeb Springs Park

Location: Waukesha, WI

PlayBooster® (2-5 years)						
PHASE-1 Direct Bury Aluminum			UNIT		TOTAL	
QTY	NO.	DESCRIPTION	WEIGHT (lb)	PRICE (US \$)	WEIGHT (lb)	PRICE (2022)
1	123331B	Double Slide 48"Dk DB			137.0	2,443.00
1	124863A	SlideWinder2 32"Dk DB 1 Left			139.0	2,443.00
Freestanding Play Motion & More Fun						
1	164075B	Double Bobble Rider DB			131.0	2,448.00
Signs						
1	182503A	Welcome Sign (LSI Provided) Ages 2-5 years Direct Bury			24.0	0.00

SUMMARY				WEIGHT (lb)	PRICE (2022)
PlayBooster® (5-12 years) PHASE-1				7,800.0	111,523.00
PlayBooster® (2-5 years) PHASE-1				1,731.0	27,831.00

ALL PHASES					
Total				9,531.0	139,354.00



Gerber Leisure Products, INC.

PO Box 42
Mount Horeb, WI 53572
Phone: 800-236-7758

QUOTE

Table with quote details: DATE: 5/16/2022, QUOTE Name: Horeb CB Quote, Valid Until: 5/20/2022

Prepared by: Meghan Barrett / meghan@gerberleisure.com

Customer

City of Waukesha- Horeb Springs Park
Attn: Keith Johnson, Melissa Lipska, Mona Bauer
429 S Washington Ave
Waukesha, WI 53188
mlipska@waukesha-wi.gov; kjohnson@waukesha-wi.gov,
MBauer@waukesha-wi.gov

Main table with columns: DESCRIPTION, QTY, PRICE, AMOUNT. Includes items like Freight to installer, Hybrid Community Build and Supervision fee, and Work to be completed by City of Waukesha Representatives.

Summary table: Subtotal \$15,915.00, Taxable \$0.00, Tax rate 0.000%, Tax due \$0.00, Other \$0.00, TOTAL Due \$15,915.00

TERMS AND CONDITIONS

- 1. A 50% deposit is required to place the order
2. Customer will be billed for equipment upon receipt of signed quote
3. Additional services will be billed upon completion of the project
4. Payment will be due within 30 days of invoice date
5. Please mail or email signed price quote to the address above

Customer Acceptance (sign below):

x _____

Print Name:

If you have any questions about this price quote, please contact: Meghan Barrett at 608-514-6323 / meghan@gerberleisure.com

Thank You For Your Business!



Horeb Springs Park

Horeb Park • 05.16.2022







The play components identified on this plan are IPEMA certified. (Unless model number is preceded with *) The use and layout of these components conform to the requirements of ASTM F1487. To verify product certification, visit www.ipema.org

THIS PLAY AREA & PLAY EQUIPMENT IS DESIGNED FOR AGES 2-12 YEARS UNLESS OTHERWISE NOTED ON PLAN.

IT IS THE MANUFACTURER'S OPINION THAT THIS PLAY AREA DOES CONFORM TO THE A.D.A. ACCESSIBILITY STANDARDS, ASSUMING AN ACCESSIBLE PROTECTIVE SURFACING IS PROVIDED, AS INDICATED, OR WITHIN THE ENTIRE USE ZONE.

THIS CONCEPTUAL PLAN WAS BASED ON INFORMATION AVAILABLE TO US. PRIOR TO CONSTRUCTION, DETAILED SITE INFORMATION INCLUDING SITE DIMENSIONS, TOPOGRAPHY, EXISTING UTILITIES, SOIL CONDITIONS, AND DRAINAGE SOLUTIONS SHOULD BE OBTAINED, EVALUATED, & UTILIZED IN THE FINAL DESIGN. PLEASE VERIFY ALL DIMENSIONS OF PLAY AREA, SIZE, ORIENTATION, AND LOCATION OF ALL EXISTING UTILITIES, EQUIPMENT, AND SITE FURNISHINGS PRIOR TO ORDERING. SLIDES SHOULD NOT FACE THE HOT AFTERNOON SUN.

CHOOSE A PROTECTIVE SURFACING MATERIAL THAT HAS A CRITICAL HEIGHT VALUE TO MEET THE MAXIMUM FALL HEIGHT FOR THE EQUIPMENT (REF. ASTM F1487 STANDARD CONSUMER SAFETY PERFORMANCE SPECIFICATION FOR PLAYGROUND EQUIPMENT FOR PUBLIC USE, SECTION 8 CURRENT REVISION). THE SUBSURFACE MUST BE WELL DRAINED. IF THE SOIL DOES NOT DRAIN NATURALLY IT MUST BE TILED OR SLOPED 1/8" TO 1/4" PER FOOT TO A STORM SEWER OR A "FRENCH DRAIN".

IT IS THE MANUFACTURER'S OPINION AND INTENT THAT THE LAYOUT OF THESE COMPONENTS CONFORM WITH THE U.S. CONSUMER PRODUCT SAFETY COMMISSION'S (CPSC) "HANDBOOK FOR PUBLIC PLAYGROUND SAFETY".

DESIGNED BY:
KLP

COPYRIGHT: 5/12/22
LANDSCAPE STRUCTURES, INC.
601 7th STREET SOUTH - P.O. BOX 198
DELANO, MINNESOTA 55328
PH: 1-800-328-0035 FAX: 1-763-972-6091

4/20/22	22030704-03	KLP
4/4/22	22030704-02	KLP
3/7/22	22030704-01	KLP
Date	Previous Drawing #	Initials

EXISTING ACCESS PATH TO REMAIN

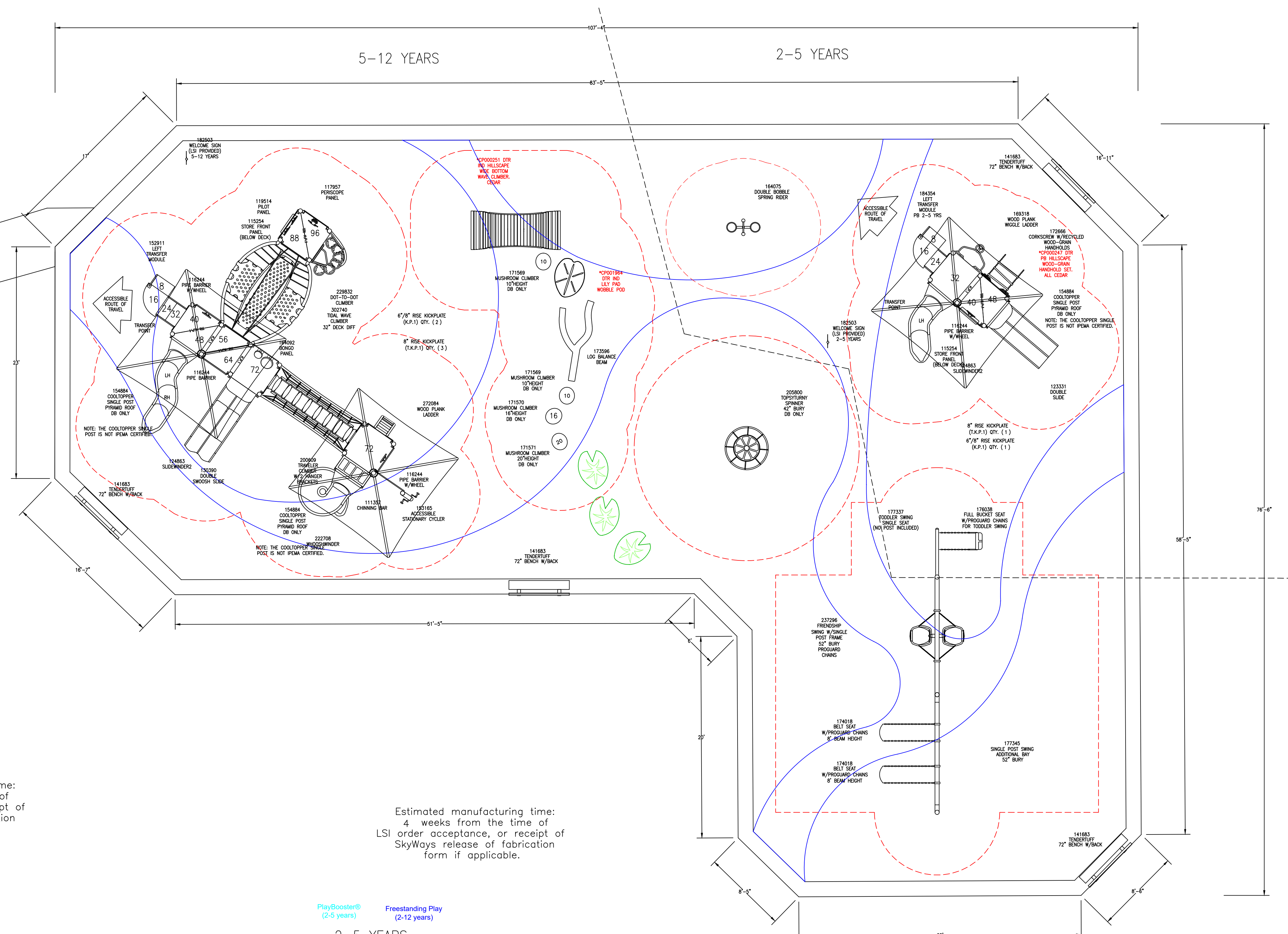

Estimated manufacturing time:
4 weeks from the time of LSI order acceptance, or receipt of SkyWays release of fabrication form if applicable.

Estimated manufacturing time:
4 weeks from the time of LSI order acceptance, or receipt of SkyWays release of fabrication form if applicable.

PlayBooster® (5-12 years)
5-12 YEARS

TOTAL ELEVATED PLAY COMPONENTS	12		
TOTAL ELEVATED COMPONENTS ACCESSIBLE BY RAMP	0	REQUIRED	0
TOTAL ELEVATED COMPONENTS ACCESSIBLE BY TRANSFER	8	REQUIRED	6
TOTAL ACCESSIBLE GROUND LEVEL COMPONENTS SHOWN	15	REQUIRED	4
TOTAL DIFFERENT TYPES OF GROUND LEVEL COMPONENTS	11	REQUIRED	11

PlayBooster® (2-5 years) Freestanding Play (2-12 years)
2-5 YEARS

TOTAL ELEVATED PLAY COMPONENTS	5		
TOTAL ELEVATED COMPONENTS ACCESSIBLE BY RAMP	0	REQUIRED	0
TOTAL ELEVATED COMPONENTS ACCESSIBLE BY TRANSFER	5	REQUIRED	3
TOTAL ACCESSIBLE GROUND LEVEL COMPONENTS SHOWN	3	REQUIRED	2
TOTAL DIFFERENT TYPES OF GROUND LEVEL COMPONENTS	3	REQUIRED	3

SURFACING:
TOTAL PIP = 5,460 SQ FT
8' = 2,745 SQ FT
4' = 2,715 SQ FT
CONCRETE BORDER = 332 LN FT

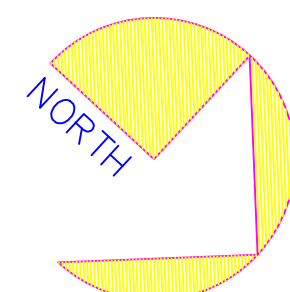
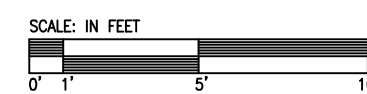

Horeb Spring Park
Waukesha, WI

Gerber Leisure Products, Inc.
Meghan Barrett

SYSTEM TYPE:
Multi-system
DRAWING #:
22030704-04





The play components identified on this plan are IPEMA certified. (Unless model number is preceded with *) The use and layout of these components conform to the requirements of ASTM F1487. To verify product certification, visit www.ipema.org

THIS PLAY AREA & PLAY EQUIPMENT IS DESIGNED FOR AGES 2-12 YEARS UNLESS OTHERWISE NOTED ON PLAN.

IT IS THE MANUFACTURER'S OPINION THAT THIS PLAY AREA DOES CONFORM TO THE A.D.A. ACCESSIBILITY STANDARDS, ASSUMING AN ACCESSIBLE PROTECTIVE SURFACING IS PROVIDED, AS INDICATED, OR WITHIN THE ENTIRE USE ZONE.

THIS CONCEPTUAL PLAN WAS BASED ON INFORMATION AVAILABLE TO US. PRIOR TO CONSTRUCTION, DETAILED SITE INFORMATION INCLUDING SITE DIMENSIONS, TOPOGRAPHY, EXISTING UTILITIES, SOIL CONDITIONS, AND DRAINAGE SOLUTIONS SHOULD BE OBTAINED, EVALUATED, & UTILIZED IN THE FINAL DESIGN. PLEASE VERIFY ALL DIMENSIONS OF PLAY AREA, SIZE, ORIENTATION, AND LOCATION OF ALL EXISTING UTILITIES, EQUIPMENT, AND SITE FURNISHINGS PRIOR TO ORDERING. SLIDES SHOULD NOT FACE THE HOT AFTERNOON SUN.

CHOOSE A PROTECTIVE SURFACING MATERIAL THAT HAS A CRITICAL HEIGHT VALUE TO MEET THE MAXIMUM FALL HEIGHT FOR THE EQUIPMENT (REF. ASTM F1487 STANDARD CONSUMER SAFETY PERFORMANCE SPECIFICATION FOR PLAYGROUND EQUIPMENT FOR PUBLIC USE, SECTION 8 CURRENT REVISION). THE SUBSURFACE MUST BE WELL DRAINED. IF THE SOIL DOES NOT DRAIN NATURALLY IT MUST BE TILED OR SLOPED 1/8" TO 1/4" PER FOOT TO A STORM SEWER OR A "FRENCH DRAIN".

IT IS THE MANUFACTURER'S OPINION AND INTENT THAT THE LAYOUT OF THESE COMPONENTS CONFORM WITH THE U.S. CONSUMER PRODUCT SAFETY COMMISSION'S (CPSC) "HANDBOOK FOR PUBLIC PLAYGROUND SAFETY".

DESIGNED BY:
KLP

COPYRIGHT: 5/12/22
LANDSCAPE STRUCTURES, INC.
601 7th STREET SOUTH - P.O. BOX 198
DELANO, MINNESOTA 55328
PH: 1-800-328-0035 FAX: 1-763-972-6091

4/20/22	22030704-03	KLP
4/4/22	22030704-02	KLP
3/7/22	22030704-01	KLP
Date	Previous Drawing #	Initials

EXISTING ACCESS PATH TO REMAIN

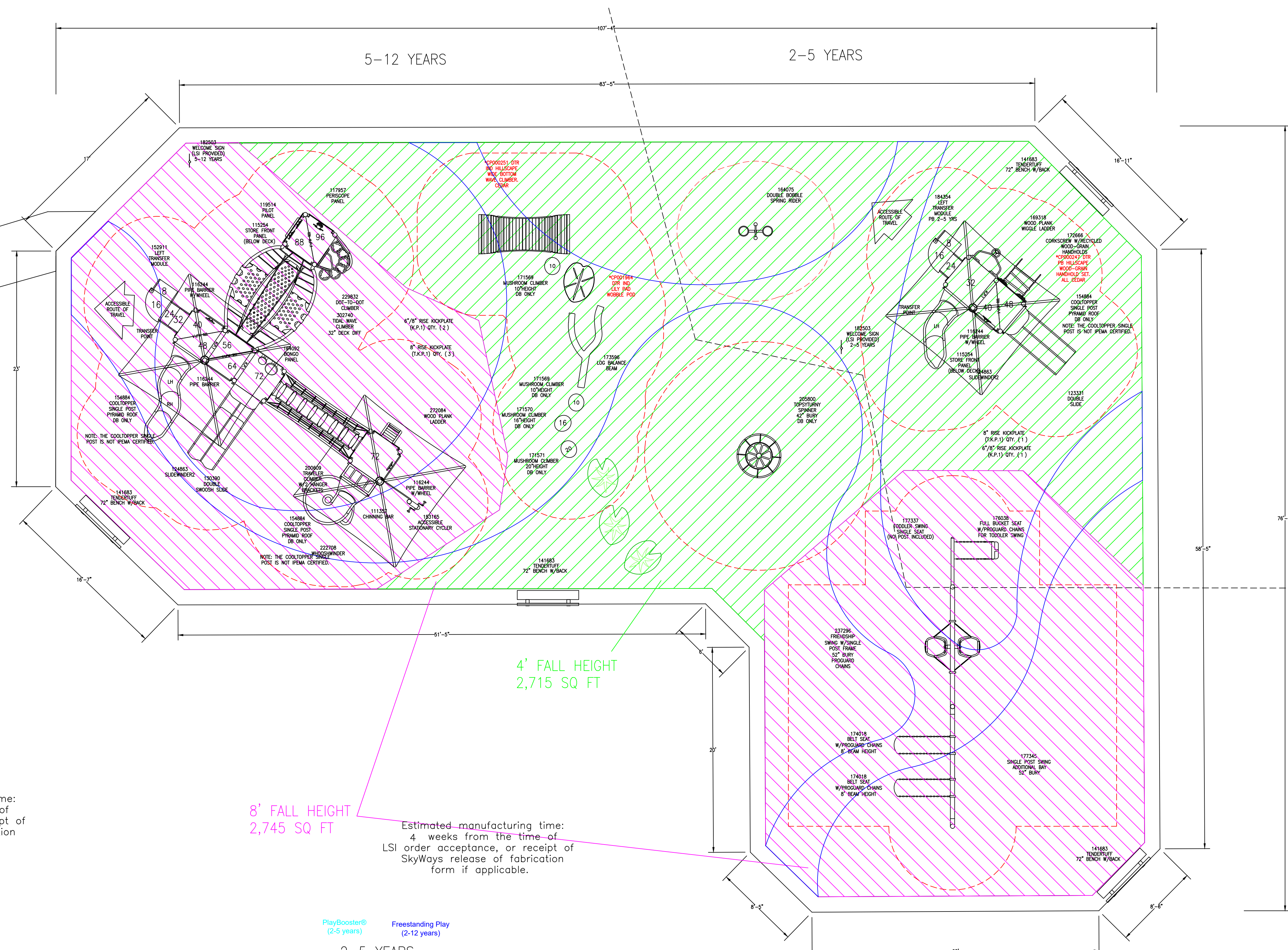

4' FALL HEIGHT
2,715 SQ FT

8' FALL HEIGHT
2,745 SQ FT

Estimated manufacturing time:
4 weeks from the time of LSI order acceptance, or receipt of SkyWays release of fabrication form if applicable.

Estimated manufacturing time:
4 weeks from the time of LSI order acceptance, or receipt of SkyWays release of fabrication form if applicable.

PlayBooster®
(5-12 years)
5-12 YEARS

PlayBooster®
(2-5 years) Freestanding Play
(2-12 years)
2-5 YEARS

TOTAL ELEVATED PLAY COMPONENTS	12		
TOTAL ELEVATED COMPONENTS ACCESSIBLE BY RAMP	0	REQUIRED	0
TOTAL ELEVATED COMPONENTS ACCESSIBLE BY TRANSFER	8	REQUIRED	6
TOTAL ACCESSIBLE GROUND LEVEL COMPONENTS SHOWN	15	REQUIRED	4
TOTAL DIFFERENT TYPES OF GROUND LEVEL COMPONENTS	11	REQUIRED	11

TOTAL ELEVATED PLAY COMPONENTS	5		
TOTAL ELEVATED COMPONENTS ACCESSIBLE BY RAMP	0	REQUIRED	0
TOTAL ELEVATED COMPONENTS ACCESSIBLE BY TRANSFER	5	REQUIRED	3
TOTAL ACCESSIBLE GROUND LEVEL COMPONENTS SHOWN	3	REQUIRED	2
TOTAL DIFFERENT TYPES OF GROUND LEVEL COMPONENTS	3	REQUIRED	3

SURFACING:
TOTAL PIP = 5,460 SQ FT
8' = 2,745 SQ FT
4' = 2,715 SQ FT
CONCRETE BORDER = 332 LN FT

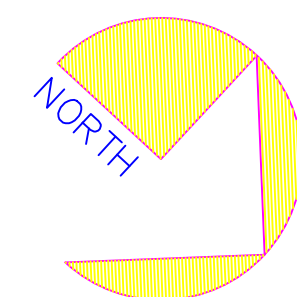
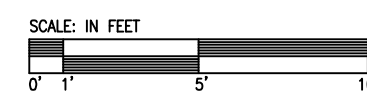

Horeb Spring Park
Waukesha, WI

Gerber Leisure Products, Inc.
Meghan Barrett

SYSTEM TYPE:
Multi-system
DRAWING #:
22030704-04





Horeb Springs Park

Horeb Park • 05.16.2022





Horeb Springs Park

Horeb Park • 05.16.2022









Horeb Springs Park



Horeb Park • 05.16.2022



Welcome

WELCOME







Horeb Springs Park

Horeb Park • 05.16.2022





Horeb Springs Park



Horeb Park • 05.16.2022