

MC&E ENGINEERING	\$1,399.29
MC&E PROJECT MANAGEMENT	\$3,386.82
MATERIAL	\$1,282.00
UNDERGROUND CONSTRUCTION	\$9,918.05
SPLICING AND TERMINATION	\$3,657.60
GRAND TOTAL	\$19,643.77

UW
Waukesha

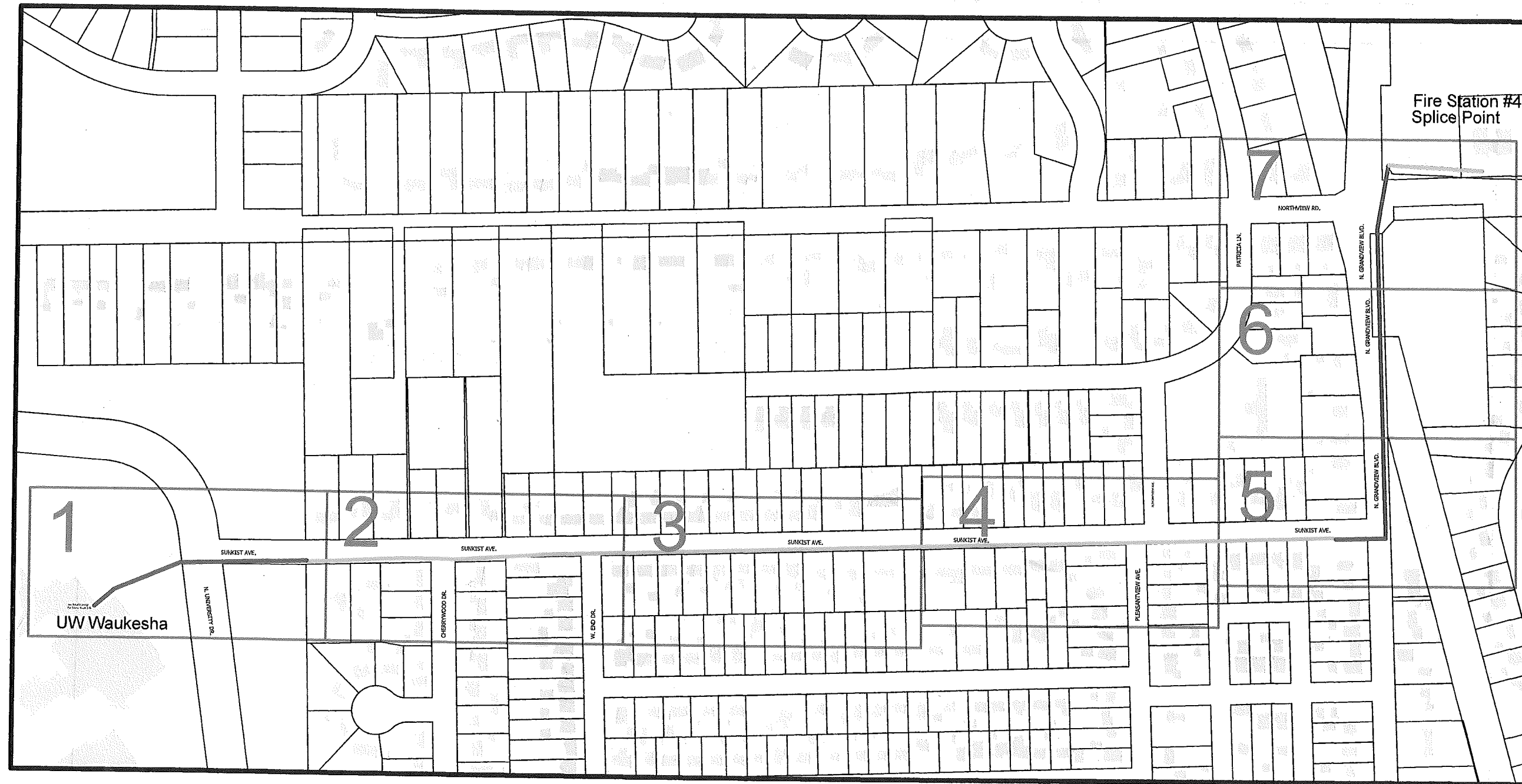



Fire Station #4
Splice Point

1

2

3

4

5

6

7

UW Waukesha

UNIVERSITY DR.

CHERRYWOOD DR.

W. END DR.

RESERVOIR AVE.

PATRICHIA LN.

NORTHVIEW RD.

N. GRANDVIEW BLVD.

SUNQUIST AVE.

SUNQUIST AVE.

SUNQUIST AVE.

SUNQUIST AVE.

SUNQUIST AVE.

CITY OF WAUKESHA
FIRE STATION #4 TO
UW WAUKESHA CAMPUS CONNECITON
 6/25/2014
 No Scale

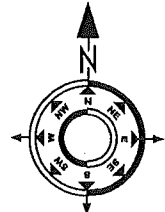
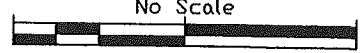

Legend

- = New Duct Route
- = Aerial Route
- = Existing Duct Route

Map Key

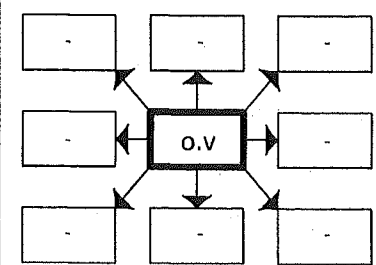

Drawn By: Dan Becker
 Title: CAD Operator
 Company: MC&E
 Phone: (920) 676-3496
 Email: dbecker@mcae.biz

Page Number:
overview

MC&E Multimedia Communications & Engineering, Inc.
 PO Box 11064 Green Bay, WI
 Ph. (920) 676-0494 Fax (920) 467-9770

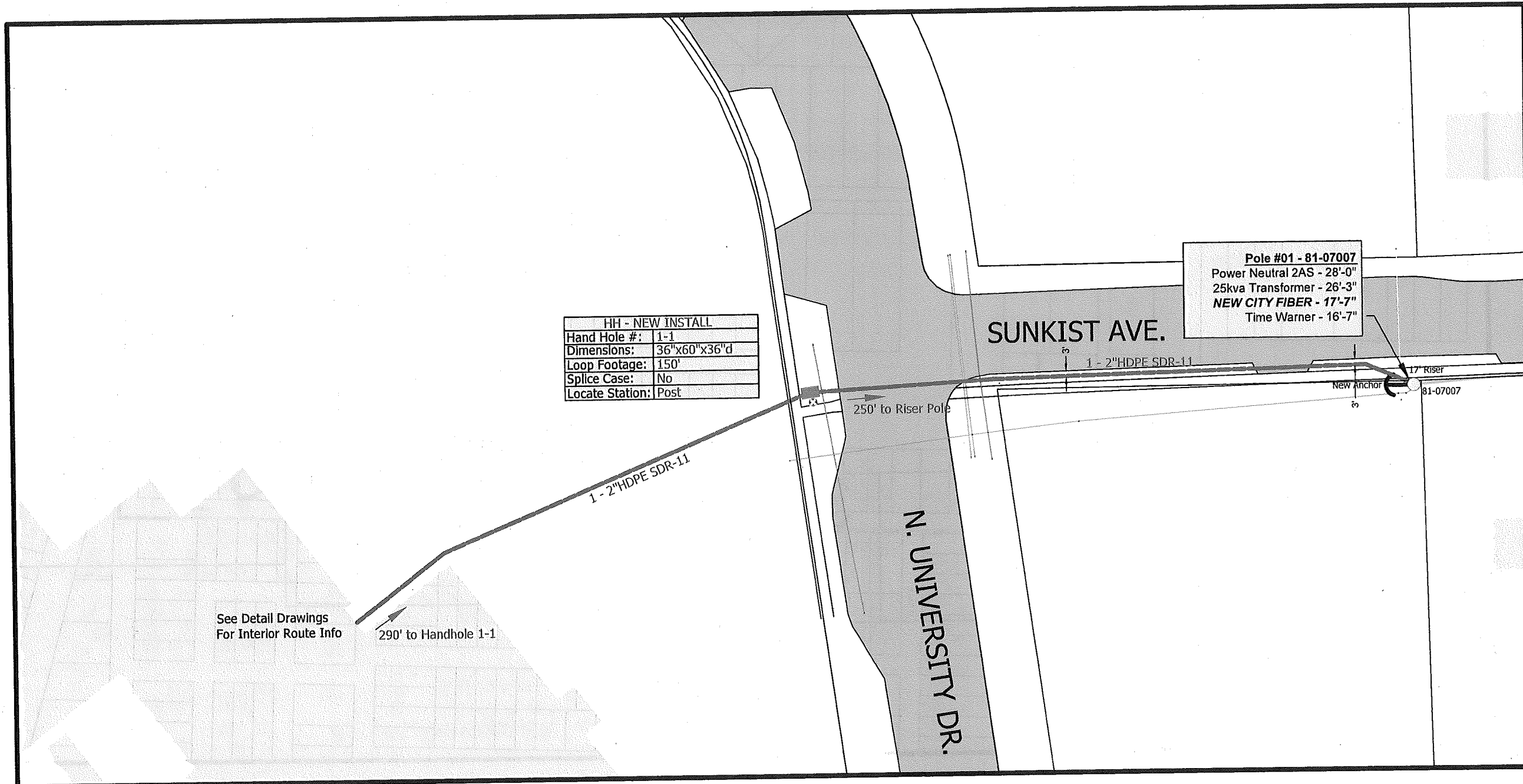

HH - NEW INSTALL	
Hand Hole #:	1-1
Dimensions:	36"x60"x36"d
Loop Footage:	150'
Splice Case:	No
Locate Station:	Post

Pole #01 - 81-07007
 Power Neutral 2AS - 28'-0"
 25kva Transformer - 26'-3"
 NEW CITY FIBER - 17'-7"
 Time Warner - 16'-7"

See Print 2

CITY OF WAUKESHA
FIRE STATION #4 TO
UW WAUKESHA CAMPUS CONNECITON
 6/25/2014
 Scale: 1"=50'

M&E Multimedia Communications & Engineering, Inc.
 PO Box 11064 Green Bay, WI
 Ph. (920) 676-0494 Fax (920) 467-9770

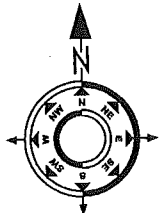

Legend			
	= New 2" Duct Install		= Utility Pole
	= New Handhole		= Fire Hydrant
	= New Locate Station		= Traffic Control Box
	= Telco		= Telco Ped
	= Cable TV		= Cable TV Ped
	= Electric		= Electric Ped
	= Gas		= Electric Transformer
	= Water		= Catch Basin / Inlet
	= Sanitary Sewer		= Round Catch Basin / Inlet
	= Storm Sewer		= Manhole
			= Handhole
			= Utility Pole
			= Anchor
			= Strand
			= Overhead Guy
			= Public Right of Way
			= Street Light

Typical Install Depth is 36"

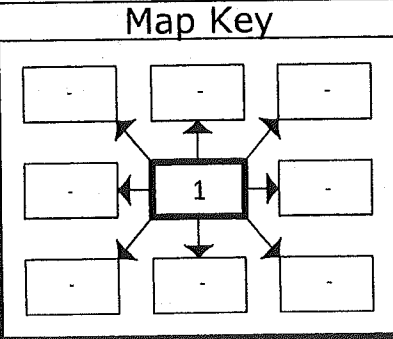

Drawn By: Dan Becker
 Title: CAD Operator
 Company: MC&E
 Phone: (920) 676-3496
 Email: dbecker@mcae.biz
 Page Number:
 1

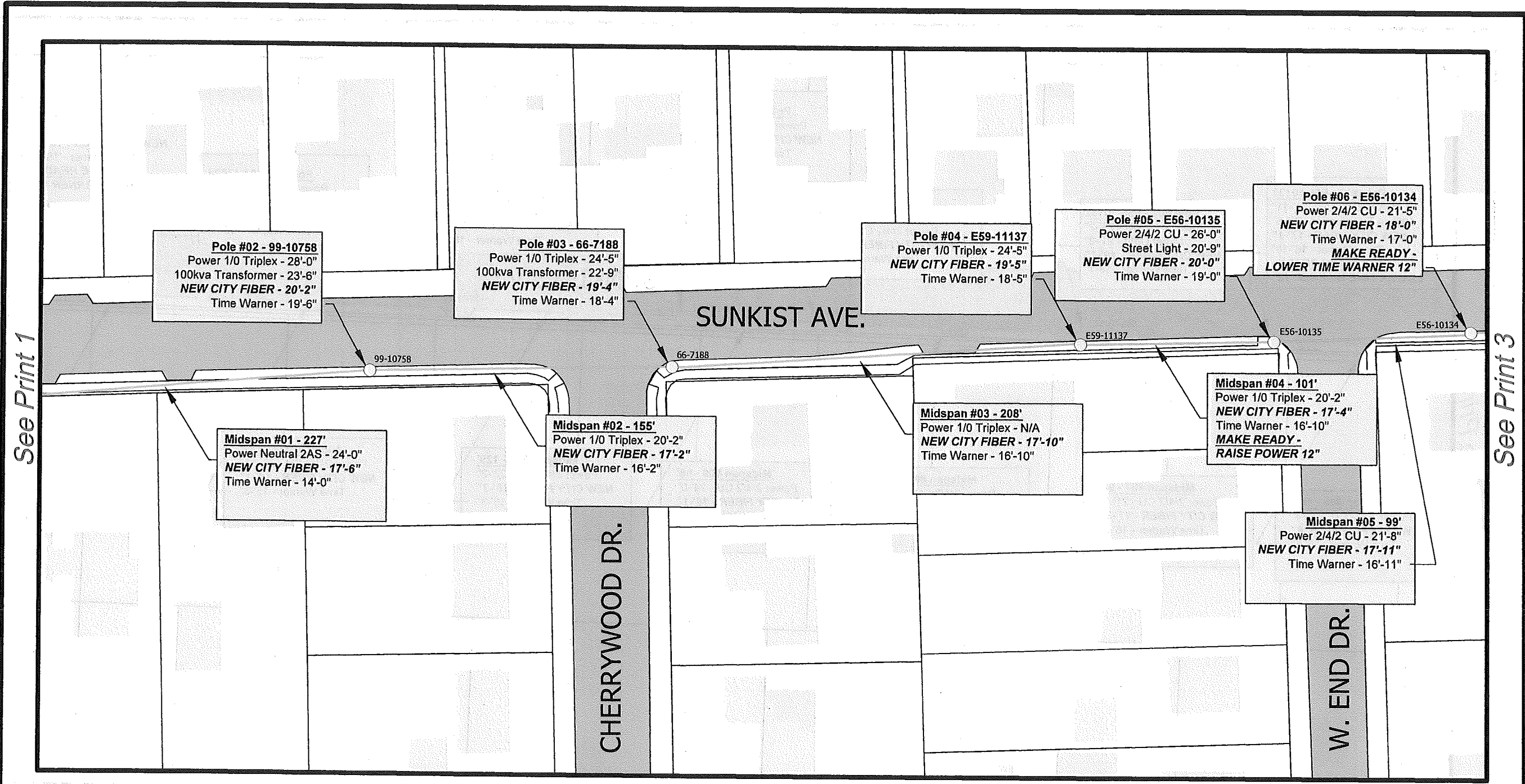

See Print 1

See Print 3

CITY OF WAUKESHA
FIRE STATION #4 TO
UW WAUKESHA CAMPUS CONNECITON
6/25/2014
 Scale: 1"=50'

MC&E Multimedia Communications & Engineering, Inc.
 PO Box 11064 Green Bay, WI
 Ph. (920) 676-0494 Fax (920) 467-9770

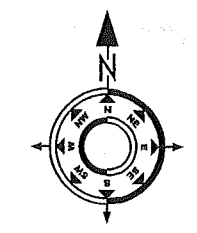

Legend

- - - = New 2" Duct Install	○ = Utility Pole	○ = Utility Pole
■ = New Handhole	♥ = Fire Hydrant	→ = Anchor
⊗ = New Locate Station	■ = Traffic Control Box	— = Strand
— = Telco	■ = Telco Ped	— = Overhead Guy
— = Cable TV	● = Cable TV Ped	— = Public Right of Way
— = Electric	■ = Electric Ped	— = Street Light
— = Gas	■ = Electric Transformer	
— = Water	■ = Catch Basin / Inlet	
— = Sanitary Sewer	● = Round Catch Basin / Inlet	
— = Storm Sewer	● = Manhole	
	□ = Handhole	

Typical Install Depth is 36"

Map Key

Drawn By: Dan Becker
 Title: CAD Operator
 Company: MC&E
 Phone: (920) 676-3496
 Email: dbecker@mcae.biz
 Page Number:
2

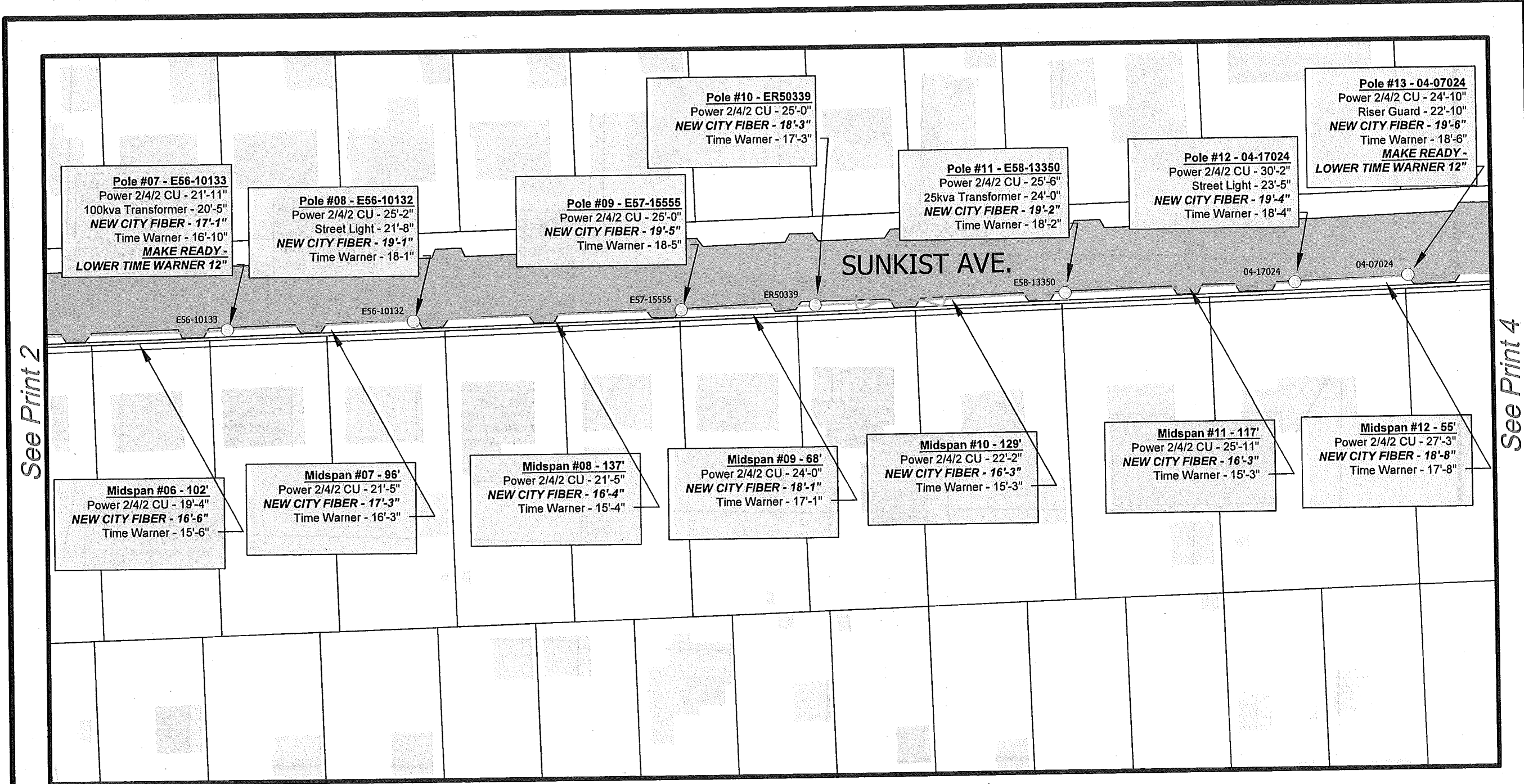

See Print 2

See Print 4

CITY OF WAUKESHA
FIRE STATION #4 TO
UW WAUKESHA CAMPUS CONNECITON
6/25/2014
 Scale: 1"=50'

MCE Multimedia Communications & Engineering, Inc.
 PO Box 11064 Green Bay, WI
 Ph. (920) 676-0494 Fax (920) 467-9770

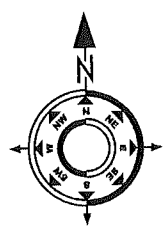

Legend			
	= New 2" Duct Install		= Utility Pole
	= New Handhole		= Fire Hydrant
	= New Locate Station		= Traffic Control Box
	= Telco		= Telco Ped
	= Cable TV		= Cable TV Ped
	= Electric		= Electric Ped
	= Gas		= Electric Transformer
	= Water		= Catch Basin / Inlet
	= Sanitary Sewer		= Round Catch Basin / Inlet
	= Storm Sewer		= Manhole
			= Handhole
			= Utility Pole
			= Anchor
			= Strand
			= Overhead Guy
			= Public Right of Way
			= Street Light

Typical Install Depth is 36"

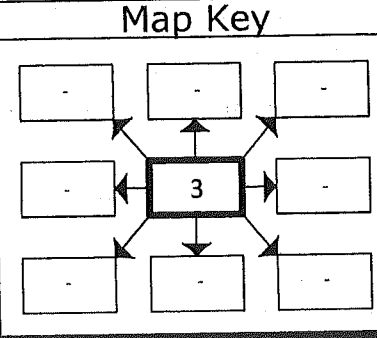

Drawn By: Dan Becker
 Title: CAD Operator
 Company: MC&E
 Phone: (920) 676-3496
 Email: dbecker@mcae.biz
 Page Number:
3

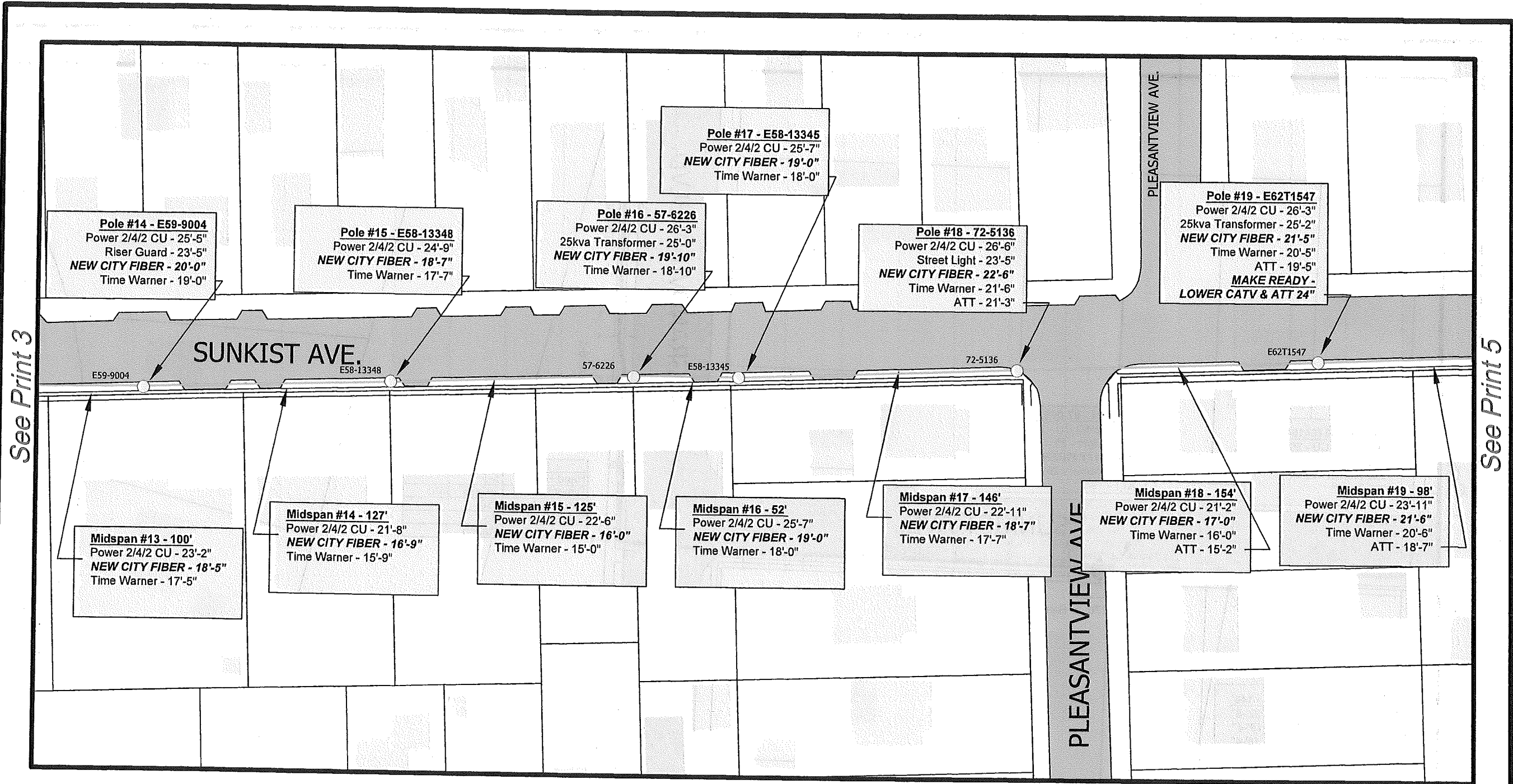

See Print 3

See Print 5

CITY OF WAUKESHA
FIRE STATION #4 TO
UW WAUKESHA CAMPUS CONNECITON
6/25/2014
Scale: 1"=50'

MC&E Multimedia Communications & Engineering, Inc.
PO Box 11064 Green Bay, WI
Ph. (920) 676-0494 Fax (920) 467-9770

Legend

--- = New 2" Duct Install	○ = Utility Pole	○ = Utility Pole
■ = New Handhole	■ = Fire Hydrant	○ = Anchor
⊗ = New Locate Station	□ = Traffic Control Box	— = Strand
— = Telco	■ = Telco Ped	— = Overhead Guy
— = Cable TV	● = Cable TV Ped	— = Public Right of Way
— = Electric	■ = Electric Ped	— = Street Light
— = Gas	■ = Electric Transformer	
— = Water	■ = Catch Basin / Inlet	
— = Sanitary Sewer	● = Round Catch Basin / Inlet	
— = Storm Sewer	● = Manhole	
	□ = Handhole	

Typical Install Depth is 36"

Map Key

Drawn By: Dan Becker
Title: CAD Operator
Company: MC&E
Phone: (920) 676-3496
Email: dbecker@mcae.biz
Page Number:
4

See Print 6

See Print 4

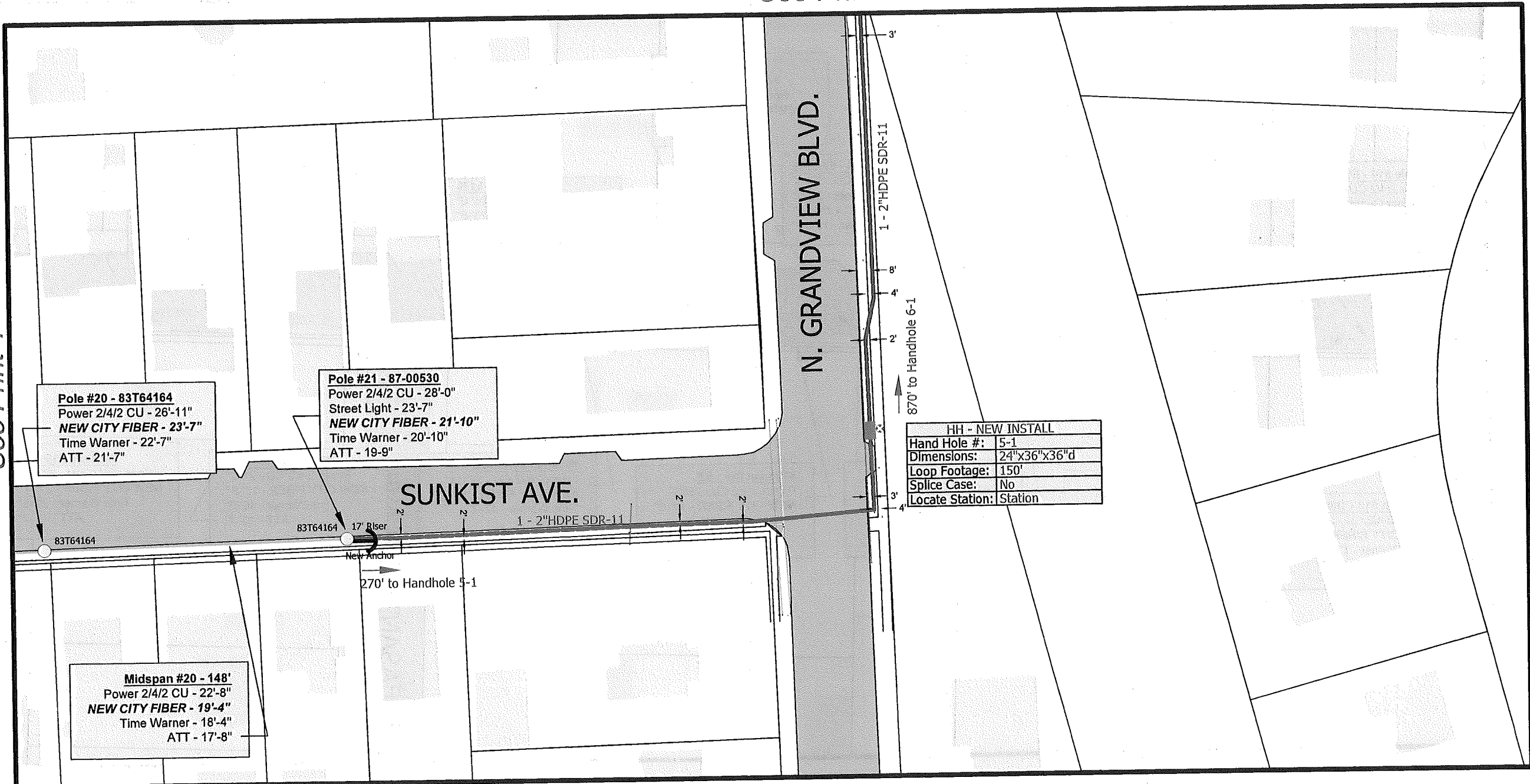

HH - NEW INSTALL	
Hand Hole #:	5-1
Dimensions:	24"x36"x36"d
Loop Footage:	150'
Splice Case:	No
Locate Station:	Station

CITY OF WAUKESHA
FIRE STATION #4 TO
UW WAUKESHA CAMPUS CONNECITON
6/25/2014

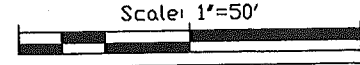

M&E Multimedia Communications & Engineering, Inc.
 PO Box 11064 Green Bay, WI
 Ph. (920) 676-0494 Fax (920) 467-9770

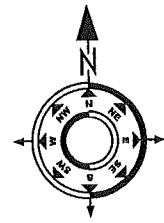

Legend

- - - = New 2" Duct Install
- = New Handhole
- ⊗ = New Locate Station
- = Telco
- = Cable TV
- = Electric
- = Gas
- = Water
- = Sanitary Sewer
- = Storm Sewer
- = Utility Pole
- ⊕ = Fire Hydrant
- = Traffic Control Box
- = Telco Ped
- = Cable TV Ped
- = Electric Ped
- = Electric Transformer
- = Catch Basin / Inlet
- ⊙ = Round Catch Basin / Inlet
- ⊙ = Manhole
- = Handhole
- = Utility Pole
- = Anchor
- = Strand
- = Overhead Guy
- = Public Right of Way
- = Street Light

Typical Install Depth is 36"

Map Key

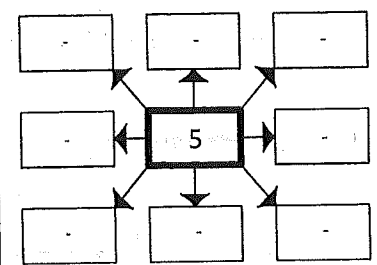

Drawn By: Dan Becker
 Title: CAD Operator
 Company: MC&E
 Phone: (920) 676-3496
 Email: dbecker@mcae.biz
 Page Number:
5

See Print 7



See Print 5

CITY OF WAUKESHA
FIRE STATION #4 TO
UW WAUKESHA CAMPUS CONNECITON
6/25/2014

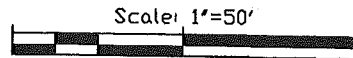

MC&E Multimedia Communications & Engineering, Inc.
 PO Box 11064 Green Bay, WI
 Ph. (920) 676-0494 Fax (920) 467-9770

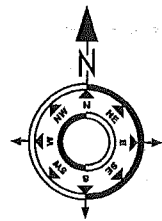

Legend

- | | | |
|---------------------------------|-------------------------------|-------------------------|
| - - - - - = New 2" Duct Install | ○ = Utility Pole | ○ = Utility Pole |
| ■ = New Handhole | ● = Fire Hydrant | — = Anchor |
| ⊗ = New Locate Station | ■ = Traffic Control Box | — = Strand |
| — = Telco | ■ = Telco Ped | — = Overhead Guy |
| — = Cable TV | ● = Cable TV Ped | — = Public Right of Way |
| — = Electric | ■ = Electric Ped | — = Street Light |
| — = Gas | ■ = Electric Transformer | |
| — = Water | ■ = Catch Basin / Inlet | |
| — = Sanitary Sewer | ● = Round Catch Basin / Inlet | |
| — = Storm Sewer | ● = Manhole | |
| | □ = Handhole | |

Typical Install Depth is 36"

Map Key

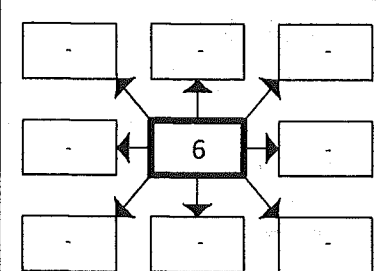

Drawn By: Dan Becker
 Title: CAD Operator
 Company: MC&E
 Phone: (920) 676-3496
 Email: dbecker@mcae.biz

Page Number:
6

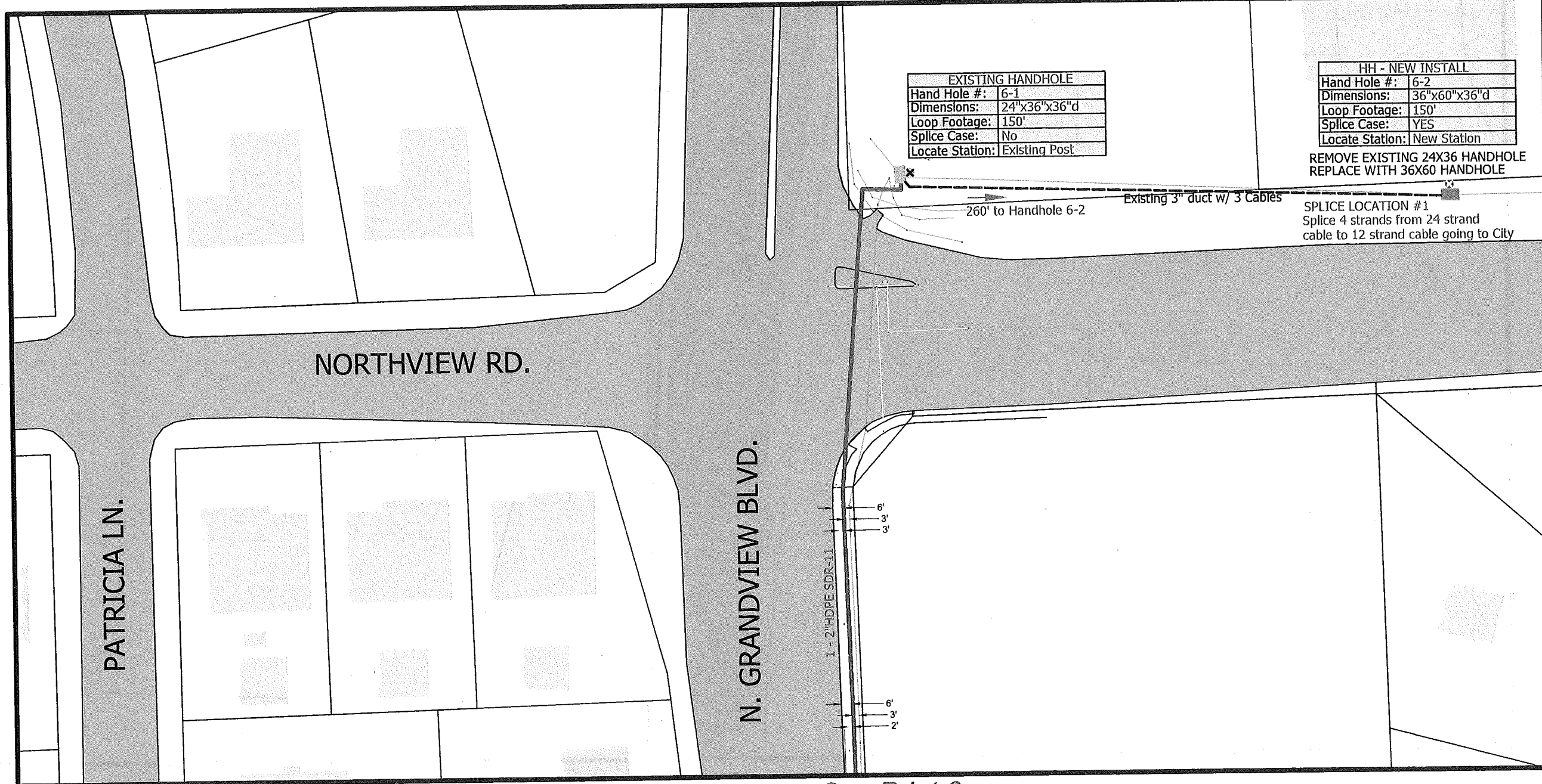

See Print 6

CITY OF WAUKESHA
FIRE STATION #4 TO
UW WAUKESHA CAMPUS CONNECITON
6/25/2014

Scale: 1"=50'



Multimedia Communications & Engineering, Inc.
 PO Box 11064 Green Bay, WI
 Ph. (920) 676-0494 Fax (920) 467-9770

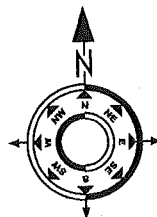

Legend			
	= New 2" Duct Install		= Utility Pole
	= New Handhole		= Fire Hydrant
	= New Locate Station		= Traffic Control Box
	= Telco		= Telco Ped
	= Cable TV		= Cable TV Ped
	= Electric		= Electric Ped
	= Gas		= Electric Transformer
	= Water		= Catch Basin / Inlet
	= Sanitary Sewer		= Round Catch Basin / Inlet
	= Storm Sewer		= Manhole
	= Handhole		= Utility Pole
	= Anchor		= Strand
	= Strand		= Overhead Guy
	= Overhead Guy		= Public Right of Way
	= Public Right of Way		= Street Light
	= Street Light		

Typical Install Depth is 36"

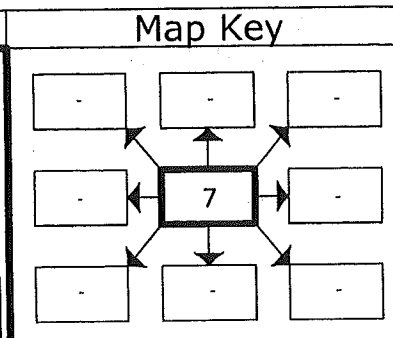

Drawn By: Dan Becker
 Title: CAD Operator
 Company: MC&E
 Phone: (920) 676-3496
 Email: dbecker@mcae.biz
 Page Number:
7