

MORELAND BLVD.

VARIABLE WIDTH PUBLIC R.O.W.

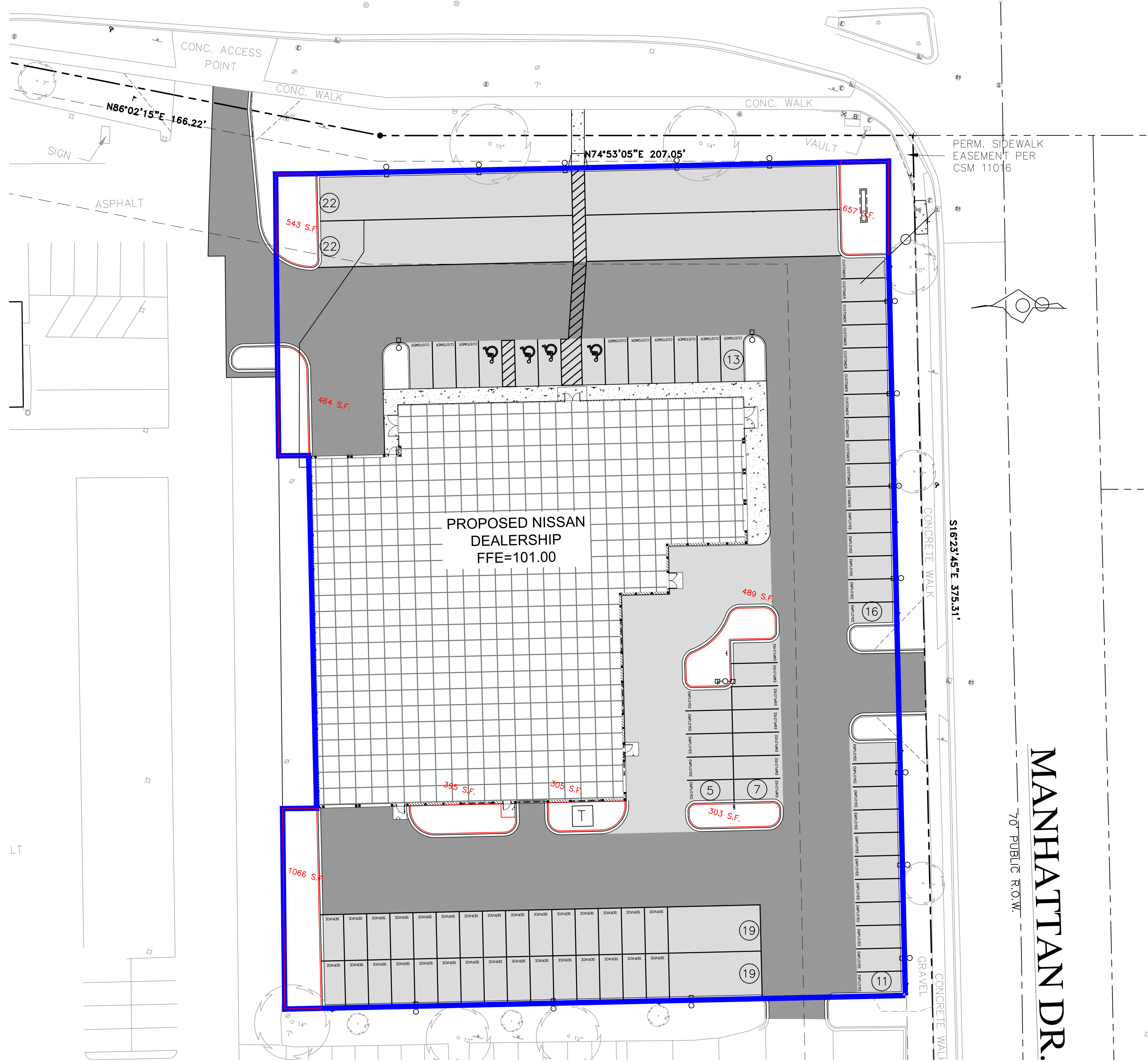
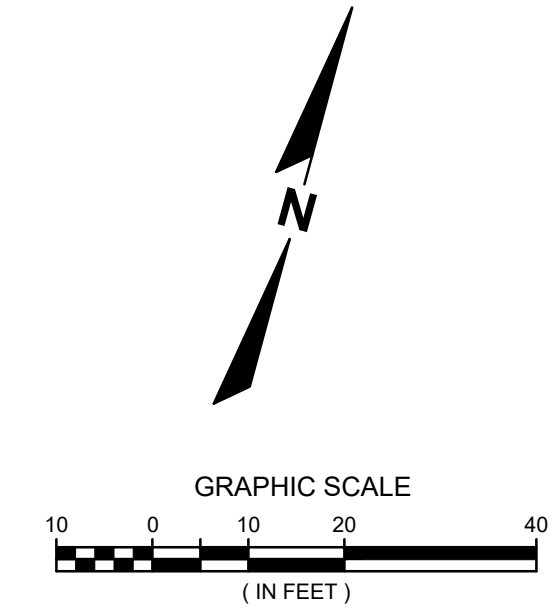

SITE DATA	
TOTAL LANDSCAPE AREA	77,701 SF (1.78 AC)
BUILDING AREA	21,336 SF (0.49 AC)
INTERIOR LANDSCAPE AREA	4,222 SF (0.09 AC)
TOTAL INTERIOR GREEN SPACE	7.72%

MANHATTAN DR.
70' PUBLIC R.O.W.

DATE	DESCRIPTION

16745 W. Bluemound Road
Brookfield, WI 53005-5938
(262) 781-1000
rasmith.com



Brookfield, WI | Milwaukee, WI | Appleton, WI | Madison, WI
Cedarburg, WI | Naperville, IL | Irvine, CA

NISSAN WAUKESHA
CITY OF WAUKESHA, WISCONSIN
INTERIOR LA AREA



Know what's below.
Call before you dig.

R.A.SMITH, INC. ASSUMES NO RESPONSIBILITY FOR DAMAGES, LIABILITY OR COSTS RESULTING FROM CHANGES OR ALTERATIONS MADE TO THIS PLAN WITHOUT THE EXPRESSED WRITTEN CONSENT OF R.A.SMITH, INC. ALL COPYRIGHTS TO THESE DRAWINGS ARE RESERVED. THEY MAY NOT BE COPIED, CHANGED, OR ASSIGNED TO ANY THIRD PARTY IN ANY MANNER WITHOUT OBTAINING THE EXPRESSED WRITTEN PERMISSION OF R.A.SMITH, INC.

© COPYRIGHT 2023 R.A. Smith, Inc.
DATE: 5/22/2023
SCALE: 1" = 20'
JOB NO. 3220213
PROJECT MANAGER: RYAN J. LANCOUR, P.E.
DESIGNED BY: CRR
CHECKED BY: RJL
SHEET NUMBER
1 OF 1

P:\3220213\Draw\Exhibits\3220213-Interior Landscaping.dwg - INTERIOR LA AREA, 5/30/2023 11:31:55 AM, crr