



Handwritten text at the bottom left of the page.



Handwritten text at the bottom center of the page.



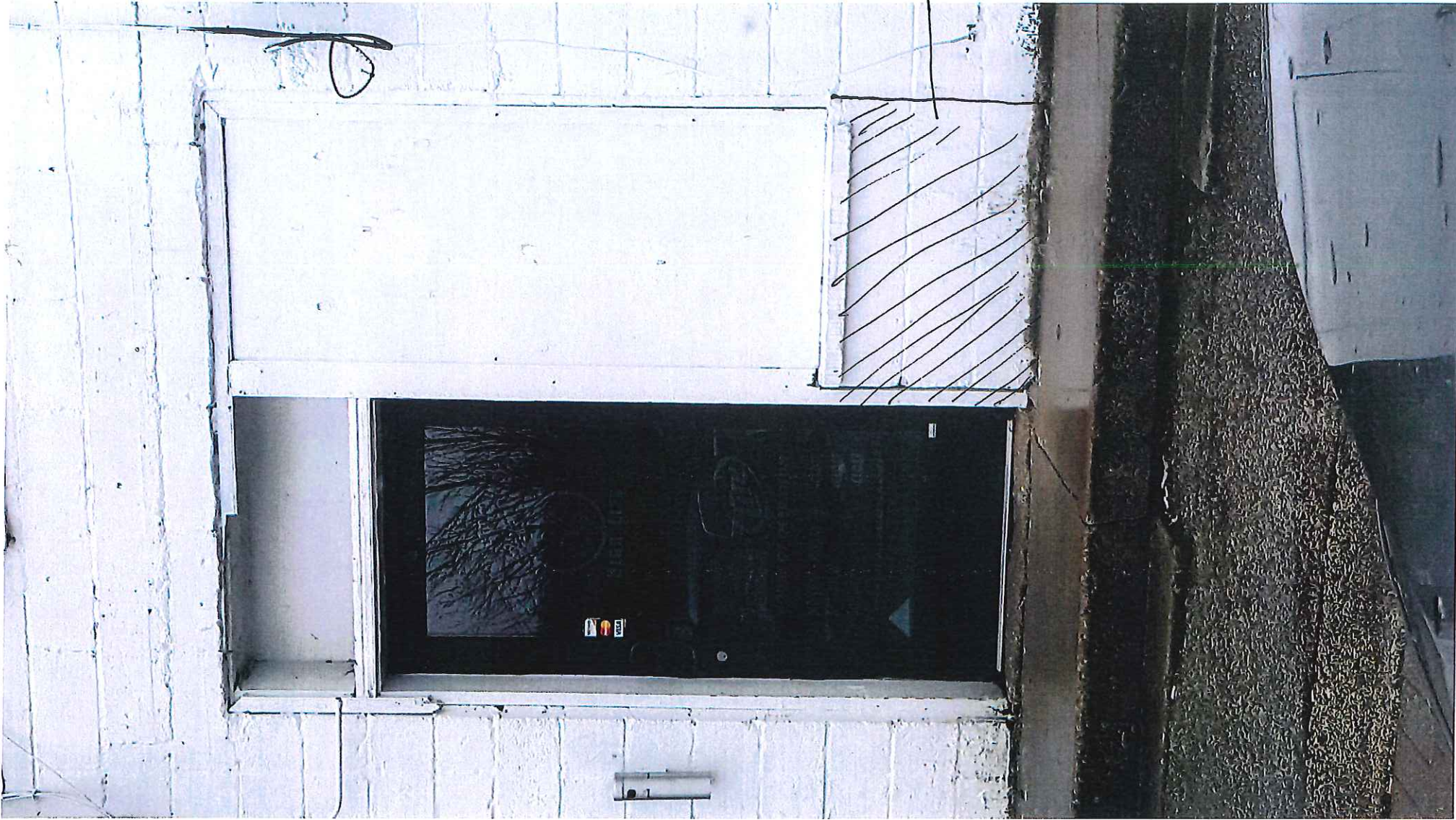

To Be
Removed

BRISTOL

BRISTOL

2

Details of the Plan

Comment. 1 Door, 1 boarded up window

Rot, Decay, Chipping Underlayment, Not energy efficient
Pieces of Trim missing from previous owner.

Proposed.

1. Dark Bronze Metal Finish ⁱⁿ (Keeps with current metal finishes found
on Bldg)

2. Re trimmed surround in dark bronze ~~in~~ Top View
Brake metal

3. 1 Door, 1 Window/Door

4. Old door to be discarded
Donated to Restore

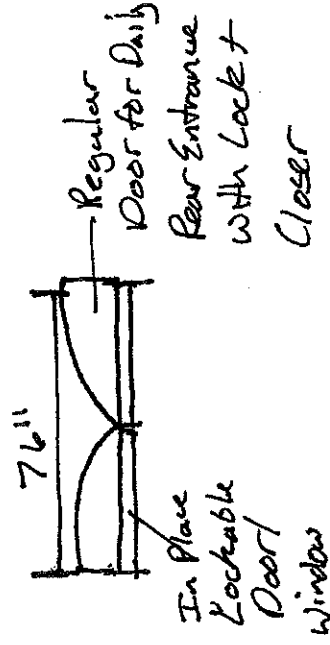

Future Plans - Small Deck in Rear of Bldg -

1. Brewery Back of Bldg with Small Area for Patrons
To Smoke in; keeps Cigarette Butts in Back of Bldg (used
of front.)

2. Small Seating Area w/ Trellace or Crankout awning possibly
Lattice w/ Ivy and/or Planters

Rough Sketch of Future Proposals (Not included in this permit)



View from outside looking in

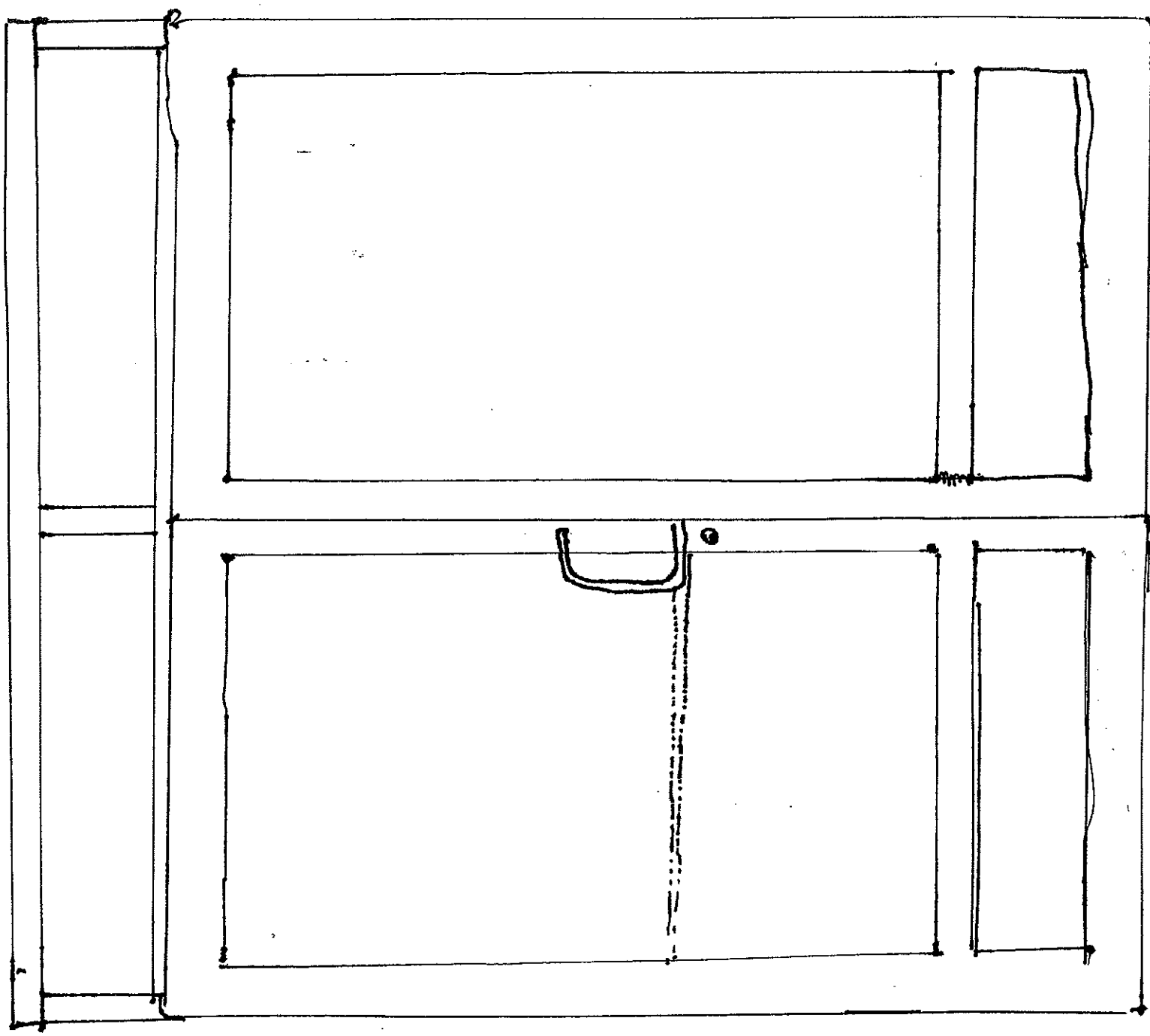

Standard Dark Bronze ~~aluminum~~ aluminum