

Office of the Clerk Treasurer

201 Delafield Street
Waukesha, Wisconsin 53188-3633

Gina Kozlik, Clerk Treasurer

clerktreas@waukesha-wi.gov

1-262-524-3550

December 08, 2022

To: Natalie Driebel, Accounting Clerk, Finance Department

Re: Claim for Property Damage on September 18, 2022

Submitted by: Seifert & Associates, LLC
757 N. Broadway Street
Suite 300
Milwaukee, WI 53202

Claimant: Tatjana and Thomas Ward
2700 Chatsworth Circle
Waukesha, WI 53188

Date Claim Received: December 07, 2022

The enclosed is being sent to you to provide to our insurance or as needed for your review.

Sincerely,

Katie Panella

City of Waukesha Deputy Clerk-Treasurer

Cc: Clerk (original) / Finance / Attorney / Public Works

Seifert & Associates

December 7, 2022

(p) 414 . 273 . 9900

Gina Kozlik, City Clerk
City of Waukesha
201 Delafield St.
Waukesha, WI 53188



NOTICE OF CIRCUMSTANCES GIVING RISE TO CLAIM AND CLAIM PURSUANT TO WIS. STAT. § 893.80

PLEASE TAKE NOTICE that TATJANA WARD and THOMAS WARD (hereinafter Mr. and Mrs. Ward), by and through their Attorneys, Seifert & Associates, by Adam J. Best, states that the following circumstances give rise to a claim:

The undersigned appears on behalf of Mr. and Mrs. Ward with regard to a negligence action.

GENERAL ALLEGATIONS

1. Mr. and Mrs. Ward are adult residents of the City of Waukesha, residing at 2700 Chatsworth Circle.
2. On or around September 18, 2022, Mr. and Mrs. Ward discovered that their house's basement was flooded with sewer water.
3. The water rose to a level of around 4 to 6 inches.
4. Mr. and Mrs. Ward were in the process of remodeling their basement. The damage from the sewer water damaged a significant amount of the features installed in the remodeling project, such as cabinets, floors, etc.
5. Additionally, several items of personal property were damaged as a result of the flood. This included power tools, guitars, a foosball table, etc.

6. Following the discovery of the flooding, Mr. Ward contacted his father, who is a civil engineer, to assist and advise how to proceed. Further, Mr. Ward contacted Marathon Restoration to assist with lowering the water levels in the basement.
7. Additionally, Mr. Ward contacted the non-emergency police line to inform them of the situation.
8. Approximately 2 ½ hours following the discovery of the flooded basement, Marathon Restoration, a company whose responsibilities include reporting to emergency situations such as basement flooding, responded to Mr. and Mrs. Ward's residence. Marathon Restoration worked on lowering the water level and salvaging whatever items of personal property were salvageable at that point.
9. Following the discovery of the flooded basement, Mr. Ward spoke with Joe Baginski, a Street Supervisor for the City of Waukesha Department of Public Works. Mr. Baginski informed Mr. Ward that the flooding in the basement was a result of an incident that occurred during a nearby water/sewer project. The incident caused damage to the sewer main, which resulted in a backup, leading to the flooding of Mr. and Mrs. Ward's basement.
10. The repairs were being conducted approximately 50-100 yards away from Mr. and Mrs. Ward's house.
11. Mr. Baginski told Mr. and Mrs. Ward that the incident that caused the flooding occurred on or around September 16, 2022.
12. As a result of the flooding, Mr. and Mrs. Ward suffered significant pecuniary damages (see RELIEF SOUGHT).

Thank you for your attention to this matter, should you have any questions or concerns, please do not hesitate to reach out and contact me at any time.

Very truly yours,

 12/7/22

Adam J. Best

Attorney at Law

Seifert & Associates

December 7, 2022 --

(p) 414 . 273 . 9900

Gina Kozlik, City Clerk
City of Waukesha
201 Delafield St.
Waukesha, WI 53188

Re: Claim by Tatjana and Thomas Ward

PLEASE TAKE NOTICE that TATJANA WARD and THOMAS WARD (hereinafter Mr. and Mrs. Ward), by and through their Attorneys, Seifert & Associates, by Adam J. Best, provides, pursuant to Wis. Stat. § 893.80, the following itemized list of damages supporting their claim:

RELIEF SOUGHT

- A. As a result of the flooding, Mr. and Mrs. Ward suffered damage to a significant amount of personal property that was stored in the basement. These items were submerged, either fully or partially, in sewer water. A full breakdown of the damaged property is listed in the attached excel spreadsheet, an electronic copy of which will be available upon request.
- B. The total value of the lost items of personal property is approximately \$30,686.61.
- C. Further, as a result of the flooding, Mr. and Mrs. Ward were required to pay for the following services, in order to mitigate their losses:
 - a. Basement cleanup services through Marathon Restoration: \$13,026.64
- D. Mr. and Mrs. Ward were in the process of finishing their basement. In order to repair the work that had been conducted to this point, Mr. and Mrs. Ward have received an estimate of \$124,119.60 from Servpro. The estimate by Servpro is attached. Mr. and Mrs. Ward are asking for \$124,119.60 in damages related to restoring the basement renovation to where it was prior to the basement flood.

- E. As a result of the work that was conducted in order to mitigate Mr. and Mrs. Ward's losses, extensive amounts of energy was used by Marathon Restoration. Mr. and Mrs. Ward's energy bill for the month of September was \$203.68, \$75.43 more than the month of August. Mr. and Mrs. Ward are requesting the difference in energy bill cost as damages. Attached is a summary of energy usage and cost provided by We Energies.
- F. Mr. and Mrs. Ward filed a claim with their insurance company, Safeco, but were informed that their insurance plan did not cover water damage, and, therefore, Safeco would not cover the cost of the damages.
- G. Mr. and Mrs. Ward reserve the right to request additional damages that are currently unknown to them. The damages presented in this document are only those damages known to Mr. and Mrs. Ward at this time.

Dated this 7th Day of December, 2022

SEIFERT & ASSOCIATES
Attorneys for Plaintiff

Signed by:

757 N. Broadway St., Suite 300
Milwaukee, WI 53202
(t) 414-273-9900
(f) 414-299-3710

 12/7/22
Adam J. Best, Bar No. 1115553



SERVPRO of SW Waukesha County and SERVPRO Jefferson County/Oconomowoc

SERVPRO of SW Waukesha County - Franchise #9841
SERVPRO of Jefferson County/Oconomowoc - Franchise #10786
1416 Poplar Drive Units A & B
Waukesha, WI 53188
262-542-0900 Email: todd@servpro9841.com
Tax ID: 80-0561165

Client: Tatjana Ward
Property: 2700 Chatsworth Cir
Waukesha, WI 53188

Home: (920) 284-7470

Operator: TODD

Estimator: Keeyana Brinkman
Position: Recon Coordinator
Company: SERVPRO of Southwest Waukesha County
Business: 1416 Poplar Drive Units A & B
Waukesha, WI 53188

Business: (262) 542-0900
E-mail: recon@servpro9841.com

Type of Estimate: Reconstruction/Repairs

Date Entered: 11/7/2022

Date Assigned:

Price List: WIMW8X_NOV22

Labor Efficiency: Restoration/Service/Remodel

Estimate: WARD_RECON

File Number: 050925987

This estimate is the property of SERVPRO of Southwest Waukesha County and SERVPRO Jefferson County/Oconomowoc and has been prepared for the exclusive use of our customer, the insurance agent, the insurance adjuster and the insurance company. This estimate may not be distributed or copied without the expressed written permission of SERVPRO of Southwest Waukesha County.



SERVPRO of SW Waukesha County and SERVPRO Jefferson County/Oconomowoc

SERVPRO of SW Waukesha County - Franchise #9841
SERVPRO of Jefferson County/Oconomowoc - Franchise #10786
1416 Poplar Drive Units A & B
Waukesha, WI 53188
262-542-0900 Email: todd@servpro9841.com
Tax ID: 80-0561165

CONTINUED - Main Level

DESCRIPTION	QTY	REMOVE	REPLACE	TAX	O&P	TOTAL
20. Temporary Toilet	1.00 EA	0.00	320.00	0.00	64.00	384.00
Temporary Toilet - (2) months @ \$160/mo. - Allowance for temporary toilets						
22. Cleaning (Bid Item)	1.00 EA	0.00	828.00	0.00	165.60	993.60
Cleaning (during construction and final) to be performed by Leffler Janitorial - Job site construction cleaning and final clean up prior to occupancy - Final cleanup will include removing marks and/or stains from all finished surfaces, cleaning and dusting of cabinets and countertops, doors, frames, shelving and other exposed surfaces. - Floor surfaces will be vacuumed and/or swept and cleaned (wet/damp mop). - Bathrooms will be sanitized, including walls, fixtures, mirrors and all surfaces. - All interior windows to be cleaned and all stickers removed.						
23. Debris disposal - (Bid Item)	1.00 EA	525.00	0.00	0.00	105.00	630.00
Dumpster (1) @ \$525 each						
Total: Main Level				0.00	20,686.60	124,119.60
Line Item Totals: WARD_RECON				0.00	20,686.60	124,119.60

Grand Total Areas:

384.00 SF Walls	144.00 SF Ceiling	528.00 SF Walls and Ceiling
144.00 SF Floor	16.00 SY Flooring	48.00 LF Floor Perimeter
0.00 SF Long Wall	0.00 SF Short Wall	48.00 LF Ceil. Perimeter
144.00 Floor Area	160.44 Total Area	384.00 Interior Wall Area
456.00 Exterior Wall Area	50.67 Exterior Perimeter of Walls	
0.00 Surface Area	0.00 Number of Squares	0.00 Total Perimeter Length
0.00 Total Ridge Length	0.00 Total Hip Length	



SERVPRO of SW Waukesha County and SERVPRO Jefferson County/Oconomowoc

SERVPRO of SW Waukesha County - Franchise #9841
SERVPRO of Jefferson County/Oconomowoc - Franchise #10786
1416 Poplar Drive Units A & B
Waukesha, WI 53188
262-542-0900 Email: todd@servpro9841.com
Tax ID: 80-0561165

Summary for Dwelling

Line Item Total	103,433.00
Overhead	10,343.30
Profit	10,343.30
	<hr/>
Replacement Cost Value	\$124,119.60
Net Claim	\$124,119.60
	<hr/> <hr/>

Keeyana Brinkman
Recon Coordinator

SERVPRO of SW Waukesha County and SERVPRO Jefferson County/Oconomowoc are pleased to provide our customers the finest professional mitigation and restoration services. The estimate and the scope of services provided are according to professional guidelines as stated in the IICRC Standard and Reference Guide for Professional Water Damage Restoration published by the Institute of Inspection Cleaning and Restoration Certification (IICRC), 2715 East Mill Plain Blvd. Vancouver, Washington 98661 USA.

3
4
5
6
7
8
9
10
11
12
13
14
15
16
17
18
19
20
21
22
23
24
25
26
27
28
29

Energy Bill (August vs September 2022) Difference

\$75.43

August 2022 (\$128.25)

September (\$203.68)

2700 Chatsworth Circle

Amount due by 11/17/2022: \$357.30

Account: 0700453234-00001 Select different account

May not include recent payments or adjustments.

Summary View bill history View payment history Compare your bills

Print Help and info

From: 10/2021 To: 11/2022 ☒ Display graph Update

Summary Cost Usage

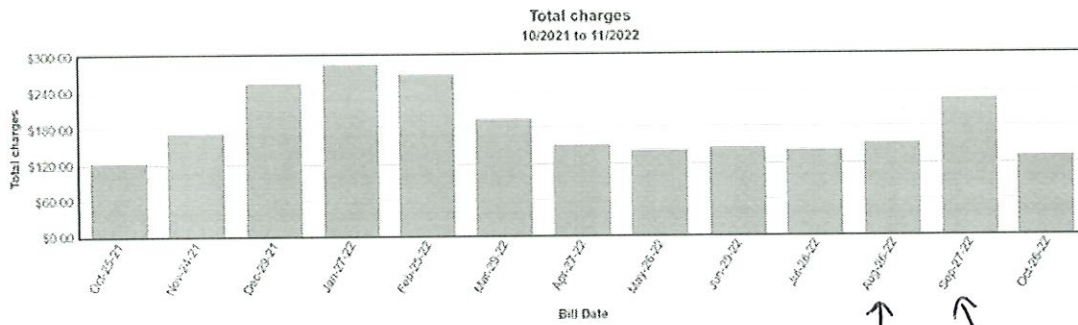

↑
\$128.25

↑
\$203.68

Version of spreadsheet with links for price amounts available upon request

Item	Quantity	Single Price
Novaform Memory Foam Mattress Queen	1	\$529.99
Queen Box Spring Set	1	239.99
Queen Headboard	1	\$379.99
Twin Mattress	2	\$399.99
GE Dishwasher	1	\$548.00
GE Top Freezer Refrigerator (Stainless Steel)	1	\$968.00
3M Packing Tape	1	\$7.68
Diablo Saw Blade 7.25"	1	\$21.47
Roberts Carpet Trimmer 10-616	1	\$57.97
Construction Screws - T-25 * 72 count	1	\$7.98
Foam Luprificant Klein Tools	1	\$25.30
Great Stuff - Foam Cleaner	1	\$9.97
Sponge Tape - 10' x 3/4" 3/8"	1	\$8.99
6" Milwaukee Tool Metal Torch Blade	5	\$3.39
Diablo Wood 6" Hackzawl	1	\$3.47
9" Metal MT Blade	1	\$21.47
Swingline - 1/2" Heavy Duty Staples	1	\$24.97
Sharpie	1	\$4.24
3/8 in. Cobalt Red Helix Twist Drill Bit	1	\$16.27
6" Wood Sawzawl Blade	1	\$19.47
Clamp/vice	1	\$14.47
3-1/4 in. x 0.131 in. Round Drive 30-Degree Steel Galvanized Smooth Shank Paper Tape Framing Nails (75	1	\$48.48
Clamp/vice	1	\$14.47
Steel Wool Brush Attachment	1	\$19.36
Small Craftsman Phillips Screwdriver	1	\$4.98
Clamp/clip	1	\$0.99
20 Razor Blades	1	\$9.97
Magnetic bit holder	4	\$5.99
Flat Head Impact	1	\$5.99
Phillips impact attachment	15	\$1.88
Star Drive impact attachment	8	\$3.29
Loctite Sealant 565	1	\$70.70
Driver	4	

3/8" Hex Driver	1	\$6.67
Permasal AWG16-14 Electrical Connectors	15	\$0.22
Philips Screws - Stainless 1 1/4"	16	\$0.63
Brass Door knob	1	\$9.47
1/2" Arrow T50 Staples	1	\$12.47
Craftsman 19190 Finish Nails 1-1/2"	1	\$15.98
Roll Electrical Tape - White	1	\$6.98
Dewalt Star Drive Set - Qty 15	1	\$10.47
Rock River Bi Metal 8" - qty 4	1	\$28.95
6" Bi Metal Rock River	1	\$22.95
Razor Blades - Qty 25	4	\$9.97
Oscillating Saw attachment	1	\$17.97
large red lighter	1	\$1.77
Heavy Metal Rock River 6"	1	\$11.97
Steel Wool Bag - #0000	1	\$4.97
Remington Square Washers - 3" - 1 Full box spw s300	1	\$28.48
Promar 400 Primer - Sherwin Williams	1	\$70.69
Craftsman 12 Gallon shopvac 4.25 peak horsepower wet dry vac	1	\$99.98
Shop vac muffler attachment	1	\$19.43
Kilz PVA Primer Sealer	1	\$14.98
Builders Legacy Primer - 5 Gallon Hallman Lindsey	1	\$138.45
Interior Oil Based Primer Sherwin Williams - 1 Gallon	1	\$46.99
Golden harvest border adhesive tub	1	\$7.98
Exterior Latex Sherwin Williams - 1 Gallon	1	\$84.99
3 1/8" Construction Screws #9	1	\$35.12
3 1/8" 25 lb. box Construction Screws	1	\$69.98
Tubing for electrical tape 1/2" Flexible tubing	1	\$71.62
48" Clamp by Rockler	1	\$44.99
Pex Tubing - 1" - 20'	1	\$25.40
Pex Tubing - 3/4" 6'	1	\$4.36
7' 2x4	2	\$3.32
30"x45" door for electrical box	1	\$507.47
Select Pine - 6'	2	\$13.87
1" Thick pre cut - 7' length	2	\$2.98

Mohawk Vinyl Flooring from Costco (7 boards per box)

1" Filter

1/2" Drywall Ultralite sheetrock

5/8" Drywall - Fire rated firecode core type x

Insulation R15 - 3.5"x15x24

16x25x5 Filter by Filterbuy Merv13

Kenmore Freezer

Rigid Orbital Sander - Plug in -

Tarp - Plastic Sheeting

Pre-cut 5/8" drywall

P80 - Random Orbit Sander - 40 QTY

Flat LED Light

Kuhl Dehumidifier

Green Bungee Cord

6' Ethernet Cable

Black 4" Tube - Outdoor 10"

Wooster Pro 3" Paint Brush

Quadmax Color Match - Sealant -

Ultima Windor & Door Roofing sealant

Table Clamp/Vice

Small Paint brush

Cable Pass through - Black

Great Stuff Window & Door Sealant

1/4" 3 3/4" Concrete Screws

Grey Electrical Box

Rustoleum High Performance enamel spray paint

Great Stuff Pest Blox

GE Sealant Silicone

2 Gallon Paint Bucket - Bathroom

Table Clamp/Vice

3" C-Clamp

10 mm Husky wrench

Electrical Tape

P150 8" Sanding Pads - QTY 40

19	\$8.57
1	\$1.75
4	\$9.28
11	\$12.48
6	\$24.53
2	\$58.29
1	\$539.99
1	\$79.00
1	\$19.98
2	\$12.48
1	\$16.99
2	\$17.98
1	\$329.00
1	\$2.58
1	\$8.61
1	\$7.49
1	\$18.47
11	\$6.99
1	\$5.85
1	\$19.20
1	\$6.47
1	\$8.97
7	\$9.97
1	\$19.97
1	\$3.51
1	\$10.48
1	\$9.97
1	\$13.28
2	\$21.98
5	\$19.28
1	\$5.78
1	\$4.98
1	\$8.23
1	\$15.99

Pine Shelves - 8' Length 10" wide	3	\$39.97
Remington 29282a Shells	2	\$10.48
50' Steel Fish Tape by Southwire	1	\$16.55
Pro Bond Wood Filler - Elmers	1	\$5.46
22 Caliber Shells - 22SGNDL5 - power loads, 100 ct.	1	\$12.99
Grade 3 Steel Wool	1	\$4.97
1 1/2" Senco Galvanized Staples 1/4" - qty 5000	1	\$30.21
Select Maple	1	\$87.99
Select Oak 4' Pieces	3	\$31.98
Husky Pick Axe	1	\$34.98
3/8" Staples	1	\$4.97
N95 Mask	1	\$2.00
Metal 4 Norton	1	\$3.97
Tiger Ceramic - 5"	1	\$25.43
Diamond Blade - Cut-off wheel 4.5" Blade	1	\$21.27
Diamond Cup Grinder	1	\$43.08
Sanding	1	\$30.80
Tiger Ceramic - 5"	1	\$6.29
4.5" Cutoff Wheel - qty 3	1	\$9.97
Locking mechanisms for cut-off wheel	3	\$17.97
8239 - 42:12 No idea what these are	1	
9/16" Impact Driver - Milwaukee Tool	1	\$13.26
9/16" long impact	1	\$16.01
Bendable attachment for impact driver	1	\$95.51
Brass Hex bolts - 3 1/4 inch	12	\$2.75
Countersink Drill bit - 7/8"	1	\$80.17
Milwaukee tool Insulation knife	1	\$16.97
Blue bunge cord	1	\$1.93
Curved Claw Hammer	1	\$25.29
Wall plate for cord/cable pass through - White	1	\$19.99
Coaxial wall plate - white	1	\$1.10
lighter	1	\$1.32
Pex pipe cutter - orange	1	\$24.47
279457 whirlpool heating element	1	\$7.88

Outlet wall-plate - Beige	1	\$0.45
Cable Pass through wall plate - Black	1	\$6.97
Kit 2344 cord tensioner	1	\$9.17
Kit 2345 cord tensioner	1	\$9.17
Duck brand professional painter's tape - .94" x 60 yd	1	\$1.77
1lb Worthington Premium Silver Solder .118inch 3mm Dia. Lead Free 331756 NSF	1	\$121.87
extension cord end -- repair/replacement	1	\$3.60
HDMI 2.0 Outlet passthrough - White	1	\$9.99
Set of drywall screws - 15-20+	1	\$4.98
Buyer's point brush wall plate - black - 1019	1	\$12.77
Cable Pass through - white	3	\$10.87
LED Electrical box for light fixture	1	\$3.62
Blue electrical box covers	4	\$1.86
Power outlet - white	1	\$3.13
Electrical covers - red/orange	1	\$14.48
Electrical wire holders	25	\$4.99
Home Depot 5 gallon buckets	2	\$4.98
commercial grade quickcrete - crack resistant cement - 50 lb bag	1	\$5.42
3' Johnson level	1	\$29.97
foam tape - 3M - VHB tapes (red)	1	\$17.09
3M masking tape	1	\$2.98
clear tape large roll	2	\$13.32
metal outlet face/cover	1	\$4.86
Bag of shims	1	\$1.58
Smart outlet - 4.8 AMP USB - 2 PK (WHITE)	2	\$39.34
Pair of work gloves	1	\$3.50
PS-250 NM Cable wood staples - 1/2" qty 250	2	\$52.78
Sharkbite 3/4" x 3/4" x 24" tubing	1	\$19.45
Ryobi tool bag	1	\$43.51
Paint scraper steel brush	1	\$7.42
Computer repair kit (kaiisi?)	1	\$24.99
small clamps (4-pack)	1	\$36.97
Husky felx-head ratchet	1	\$37.97
razor blades - qty 25	5	\$1.97

Personna carpet blades - 10 pack	1	\$3.47
6" metal ruler	1	\$5.48
Wall outlet plate	9	\$0.72
Dual light switch plate	1	\$8.95
single light switch plate	11	\$0.77
single light switch plate (full size opening for dimmer/flat switch)	12	\$0.77
dual light switch plate (full size opening for dimmer/flat switch)	1	\$8.95
Coaxial wall plate	1	\$4.98
Cable passthrough wall plate	1	\$9.97
Plate cover - Dual	2	\$0.72
Plate cover - Single	2	\$0.85
Thicker wall plate light switch for flat light dimmer switch	1	\$108.89
Light switch/Outlet combo plate cover	3	\$2.26
Thicker wall plate cover - 1/2"x3"x3"	1	\$4.47
Beige outlet cover	1	\$0.72
Wall outlet plate	1	\$0.72
Dual light switch plate	4	\$8.95
single light switch plate	1	\$0.77
single light switch plate (full size opening for dimmer/flat switch)	5	\$0.77
dual light switch plate (full size opening for dimmer/flat switch)	6	\$0.77
Coaxial wall plate	4	\$8.95
Cable pass through - Single	1	\$4.98
Black outlet cover	1	\$9.97
dual light switch plate (full size opening for dimmer/flat switch) - Leviton 3/8"	1	\$0.72
metal wall plate	2	\$6.85
CE Tech - Cat 6 Jack connector (white)	1	\$4.86
Plug - 3 to 2	1	\$8.98
1 beige light switch (older style)	1	\$2.33
Shop Broom	1	\$1.60
AT&T Broadband connector/hook-up	1	\$29.97
Kidde Smoke detector	1	\$19.97
Leviton GFCI Outlet (15A - 125V) - c - Black	1	\$22.31
Milwaukee tool bag - large	1	\$59.97
Wide head diagonal cutting pliers	1	\$19.99

Dewalt battery/charger 18V	1	\$69.00
Handle for Milwaukee Tool hammer drill	1	\$12.99
Husky Razor blades	3	\$0.35
Small phillips screw driver	1	\$5.97
Small flathead screw driver	1	\$5.47
connector for impact driver hex attachment	1	\$6.98
Bendable attachment for impact driver/ratchet tool	1	\$15.97
Impact driver attachment - phillips	1	\$34.97
Impact driver attachment - star drive	1	\$19.95
Milwaukee tool impact driver attachment	1	\$17.00
1/4" driver	1	\$4.49
5/16" driver	1	\$5.47
Hitch ball wrench 1/2"	1	\$15.47
Rigid oscillating tool - plug-in	1	\$99.00
Nails variety pack PrimeSource brand	1	\$10.98
2lb sledge hammer	1	\$17.97
hammer - red	1	\$15.00
hammer - yellow	1	\$8.97
N95 Mask - Milwaukee Tool	1	\$2.00
Orbitalum - 790 042 048 Performance blade	1	\$23.05
Orbitalum blade attachment - 4 inch	1	\$49.97
Gorilla tape - black	1	\$16.98
white athletic tape	1	\$9.87
wrench - rubberized hammer	1	\$10.48
Orbitalum blade attachment - 12 inch	1	\$49.95
Electrical Tape - black	1	\$8.23
kobalt 8" wrench - 7/16" - black	1	\$17.74
milwaukee tool blade remover	1	\$36.99
bosch titanium blade drill bits	1	\$18.47
husky 3/4" wrench	1	\$20.97
concrete chisel - 10"	1	\$2.36
pro fitter thread seal tape	1	\$8.23
electrical tape	1	\$24.90
air compressor attachment - male-female	2	

air compressor attachment - male-female (non-locking)	1	\$24.00
philips dewalt drill bit	1	\$4.47
cresecent 5/8 driver - chrome vandrium	1	\$9.82
11/16"	1	\$8.70
9 mm	1	\$8.46
7/16"	1	\$10.11
13 mm	1	\$7.97
11/32"	1	\$11.00
5/8"	1	\$9.82
9/16"	1	\$10.47
14 mm	1	\$9.44
1/2"	1	\$8.07
1/2"	1	\$8.07
3/8"	1	\$6.46
milwaukee tool packout rolling tool box	1	\$139.00
milwaukee tool n95 mask 10 pack	1	\$26.47
Owen's Corning r20 faced insulation 5.5" x 15" x 32'	1	\$49.88
Miller Lite Dart Board	1	\$131.16
OVE Decors 36" Bathroom Vanity from Costco	1	\$999.99
Reflectix R-3.7 Reflective Insulation 24" x 25' 50 SF	1	\$28.00
Foosball table cover	1	\$129.99
Outdoor throw pillows	2	\$22.32
Doctor's Choice Monarch Supreme Plush mattress set - full xl size	1	\$1,089.99
Adjustable bed frame with remote (Full XL)	1	\$344.99
Michael Kors jacket - Black - small	1	\$195.00
Jennifer Lopez jacket - black - medium (leather w/ fur inside)	1	\$179.99
Steve Madden - Medium jacket - leather? - peacoat	1	\$79.72
Via Spiga jacket - size 6 - leather/peacoat - leopard print inside -	1	\$94.99
Black Rivet jacket/peacoat - large - white	1	\$24.99
Ann Klein jacket/peacoat - small - gray w/ hood	1	\$99.99
ZeroXposur jacket - women's small - white	1	\$49.99
Ikea black fabric storage container	1	\$9.99
zeroXposur jacket - men's large - black/grey	1	\$68.21
pink yoga mat	1	\$19.23

HP Laptop --	1	\$330.99
Large Advent Wreath Centerpiece (Sitting on log with 4 pillar candles)	1	\$139.59
Advent candles (4 count)	4	\$4.27
Coffin case - electric guitar bag	1	\$175.95
67 Fender Telecaster w/ Bigsby conversion tremolo	1	\$9,047.00
Lasko Super Fan Max	1	\$69.99
Foosball table	1	\$1,995.00
1/2" power pex coil 100'	1	\$29.95
10' aluminum straight edge	1	\$131.38
wall texture - 600 sq ft coverage	1	\$16.78
1 towel	1	\$10.33
8 budweiser bottles	1	\$11.29
5 guiness	5	\$2.50
3 Pillows	3	\$18.50
Custom Oak Floating Shelf (66"W x 11 1/2"D x 3")	1	\$770.00
Custom Oak Floating Shelves (17 3/4"W x 11 1/2"D x 3")	2	\$210.00
Felt Electric Shop Light	1	\$49.99
Ibanez Acoustic Guitar	1	\$499.99
Washburn Cumberland Acoustic Electric Guitar	1	\$799.99
Floor Trim Base Boards - 12'	17	\$22.98
1 Box Mohawk Vinyl Flooring from Costco	1	\$59.99
1 Box of Drywall Screws - 25 lbs.	1	\$52.98
Emerald Exterior Deep base paint	1	\$98.99
Home Depot Orange Bucket		\$4.98
Emerald Exterior Deep base paint	1	\$98.99
Duration Home Interior Acrylic Latex Paint 1 Gallon	1	\$82.49
Duration Home Interior Acrylic Latex Paint 5 Gallon	1	\$407.45
6" Sawzall Milwaukee Tool Blade	1	\$5.49
Sanding Pads 80 Grit	9	\$9.97
Drywall Trowell	1	\$29.98
Ryobi Tool Bag	1	\$17.94
Carpenter Pencils - 10 Pack	1	\$4.97
Steel Wool Sanding pad	1	\$14.48
Clamp	1	\$9.24

Water Wiz Applicator Refill Pad	1	\$4.20
Shop Vac Extension	1	\$17.26
Sandin Pad 120	1	\$6.98
Sanding Pad 100 Grit	2	\$6.98
Sheet 100 Grit	2	\$6.98
Sheet 220 Grit	1	\$6.98
Pack of 60 Grit Sandpaper	1	\$6.98
Pro Classic Interior Acrylic Latex Paint	1	\$89.99
Premium Wall & Wood Primer - Sherwin Williams	1	\$60.49
100' Electrical Extension Cord	1	\$25.97
Minwax Stainable wood filler 16 Oz	1	\$12.48
Basement Itemized List Total		

MARATHON RESTORATION

Mail Payment to 2332 N. Sylvania Ave, Sturtevant, WI 53177

Insured: Tatjana Ward
Home: 2700 Chutsworth Cir
Waukesha, WI 53188

Cellular: (920) 284-7470
E-mail: tajapiljic@gmail.com

Claim Rep.: N/A

Estimator: Dakota Pettit

Business: (414) 514-0407

Claim Number: 050925987

Policy Number: 0

Type of Loss: Sewage

Date Contacted: 9/18/2022 12:00 AM

Date of Loss: 9/18/2022 12:00 AM

Date Received: 9/18/2022 12:00 AM

Date Inspected: 9/18/2022 12:00 AM

Date Entered: 10/9/2022 7:03 PM

Price List: WIMW8X_SEP22
Restoration/Service/Remodel

Estimate: TATJANAWARD

Marathon Commercial Services appreciates the opportunity to provide you with this scope of work and loss estimate for your project. This report is based on our representative's inspection of the loss site and is provided for either informational purposes as an estimate or as an invoice for services already provided.

This report is not a contract to commence the services contained in it. By definition an estimate is a statement of the approximate cost of work to be done. Every effort is made to make the costs and scope of work as accurate as possible. This report does not guarantee that further latent damages may be discovered during the course of services performed.

For services already provided by Marathon Commercial Services this report serves as an invoice. As such, the costs contained within it are owed Marathon Commercial Services, by the client which has contracted for the services provided at the property address, within 30 days of receipt.

MARATHON RESTORATION

Mail Payment to 2332 N. Sylvania Ave, Sturtevant, WI 53177

CONTINUED - Recreation Room

DESCRIPTION	QTY	REMOVE	REPLACE	TAX	TOTAL
14. Cabinet - full height unit - Detach	3.00 LF	0.00	20.52	3.39	64.95
15. Cabinet - upper (wall) unit - Detach	6.00 LF	0.00	17.61	5.81	111.47
16. Remove Cabinet door	13.00 SF	3.76	0.00	0.00	48.88
17. Remove Cabinet drawer front	3.00 SF	3.76	0.00	0.00	11.28
18. Remove Shelving - 12" - in place	12.00 LF	0.47	0.00	0.00	5.64
19. Remove Outlet or switch cover	5.00 EA	0.79	0.00	0.00	3.95
20. Tear out wet drywall, cleanup, bag, per LF - to 2' - Cat 3	131.35 LF	5.54	0.00	3.11	730.79
21. Tear out and bag wet insulation - Category 3 water	184.00 SF	1.24	0.00	0.81	228.97
22. Clean with pressure/chemical spray	927.72 SF	0.00	0.39	20.44	382.25
23. Water extraction from hard surface floor - Cat 2 water	665.02 SF	0.00	0.42	15.36	294.67
24. Apply anti-microbial agent to more than the floor	927.72 SF	0.00	0.27	15.93	266.41
EQUIPMENT					
25. Dehumidifier (per 24 hour period) - Large - No monitoring 2 technicians for 5 days of rental between stabilization and drying.	10.00 EA	0.00	76.75	42.21	809.71
26. Air mover (per 24 hour period) - No monitoring 12 air movers for 3 days of drying.	36.00 EA	0.00	26.50	52.47	1,006.47
27. Negative air fan/Air scrubber (24 hr period) - No monit. 1 air scrubber for 3 days of air washing and odor control.	3.00 DA	0.00	72.25	11.92	228.67
Totals: Recreation Room				266.94	8,185.17

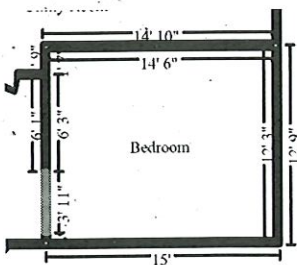

Bedroom

Height: 8'

401.95 SF Walls	177.68 SF Ceiling
579.63 SF Walls & Ceiling	177.68 SF Floor
19.74 SY Flooring	49.59 LF Floor Perimeter
53.51 LF Ceil. Perimeter	

Missing Wall - Goes to Floor

3' 11" X 6' 8"

Opens into RECREATION_R

DESCRIPTION	QTY	REMOVE	REPLACE	TAX	TOTAL
28. Water extract from hard surf flr - Cat 3 wtr - after hours	177.68 SF	0.00	1.26	12.31	236.19

MARATHON RESTORATION

Mail Payment to 2332 N. Sylvania Ave, Sturtevant, WI 53177

CONTINUED - Utility Room

DESCRIPTION	QTY	REMOVE	REPLACE	TAX	TOTAL
EQUIPMENT					
43. Air mover (per 24 hour period) - No monitoring 6 air movers for 3 days of drying.	18.00 EA	0.00	26.50	26.24	503.24
44. Negative air fan/Air scrubber (24 hr period) - No monit. 1 air scrubber for 3 days of air washing and odor control.	3.00 DA	0.00	72.25	11.92	228.67
Totals: Utility Room				73.67	1,785.78
Total: Main Level				386.77	11,208.06

General

DESCRIPTION	QTY	REMOVE	REPLACE	TAX	TOTAL
45. Emergency service call - after business hours	1.00 EA	0.00	247.80	13.63	261.43
46. Equipment setup, take down, and monitoring (hourly charge)	7.50 HR	0.00	56.96	23.50	450.70
47. Equipment decontamination charge - per piece of equipment	6.00 EA	0.00	33.85	13.04	216.14
48. Personal protective gloves - Disposable (per pair) 15 mil	16.00 EA	0.00	2.96	5.35	52.71
49. Respirator cartridge - organic vapor & acid gas (per pair)	4.00 EA	0.00	23.92	10.81	106.49
50. Respirator - Half face - multi-purpose resp. (per day)	4.00 DA	0.00	1.67	0.37	7.05
51. Floor protection - cloth - skid resistant, breathable	180.00 SF	1.20	0.00	5.74	221.74
52. Floor protection - plastic and tape - 10 mil Used in garage for the affected contents from the basement to be brought up and set on.	200.00 SF	0.00	0.38	1.32	77.32
53. Dumpster load - Approx. 12 yards, 1-3 tons of debris	1.00 EA	425.00	0.00	0.00	425.00
Totals: General				73.76	1,818.58
Line Item Totals: TATJANAWARD				460.53	13,026.64