

THIS DRAWING has been prepared by the Architect, or prepared under his direct supervision or on instrument of service and is intended for use only on this project. All Drawings, Specifications, ideas and designs, including the overall layout, form, arrangement, and composition of space and elements portrayed, constitute the original, unpublished Work of the Architect. Any reproduction, use, or disclosure of the information contained herein without the written consent of the Architect is strictly prohibited.

© 2015 H.C. KLOVER ARCHITECT
 THE ARCHITECT ASSUMES responsibility for the existing building structure, site conditions, existing construction elements, or any documents, drawings or other instruments used for any part of this Project which do not bear the Architect's seal. The Architect's services are undertaken only in the interest of the Project Owner. No obligation is assumed by the Architect for the benefit of any other entity.
 RELATED DOCUMENTS: This Drawing is a single component of an integrated set of Construction Documents. General and Supplementary Conditions of the Contract, General Requirements, Specifications and other Drawings may affect the Work described. Failure to review and integrate the scope stated in the whole of its Construction Documents does not relieve the Contractor from providing a complete Project.
 COMPLIANCE: All laws, codes, ordinances and regulations with authorities having jurisdiction and with requirements of the Landlord, if applicable. Do not start Work until all permits and required approvals are obtained.
 VERIFY ACTUAL CONDITIONS and dimensions prior to construction. Compensation of work conditions verification and acceptance of all existing conditions. Application of a material or equipment item to Work intended to obtain conditions acceptance of that Work, and acceptance of responsibility for satisfactory installation.
 DIMENSIONS SHOWN are to finish face of a material unless otherwise indicated.
 DIMENSIONS & HEIGHTS shown - DO NOT SCALE drawings unless otherwise directed.

project title

CFT & PANDA
WAWUKESHA
 2720 N GRANDVIEW BLVD
 WAWUKESHA, WI 53188

project number
 14045.004
 drawing issuance
 PLANNING REVIEW 05.17.17
 drawing revisions
 No. Description Date:

professional seal

drawing title
 PRELIMINARY
 SITE PLAN
 drawing number
AS100

NORTH GRANDVIEW

SILVERNAIL RD

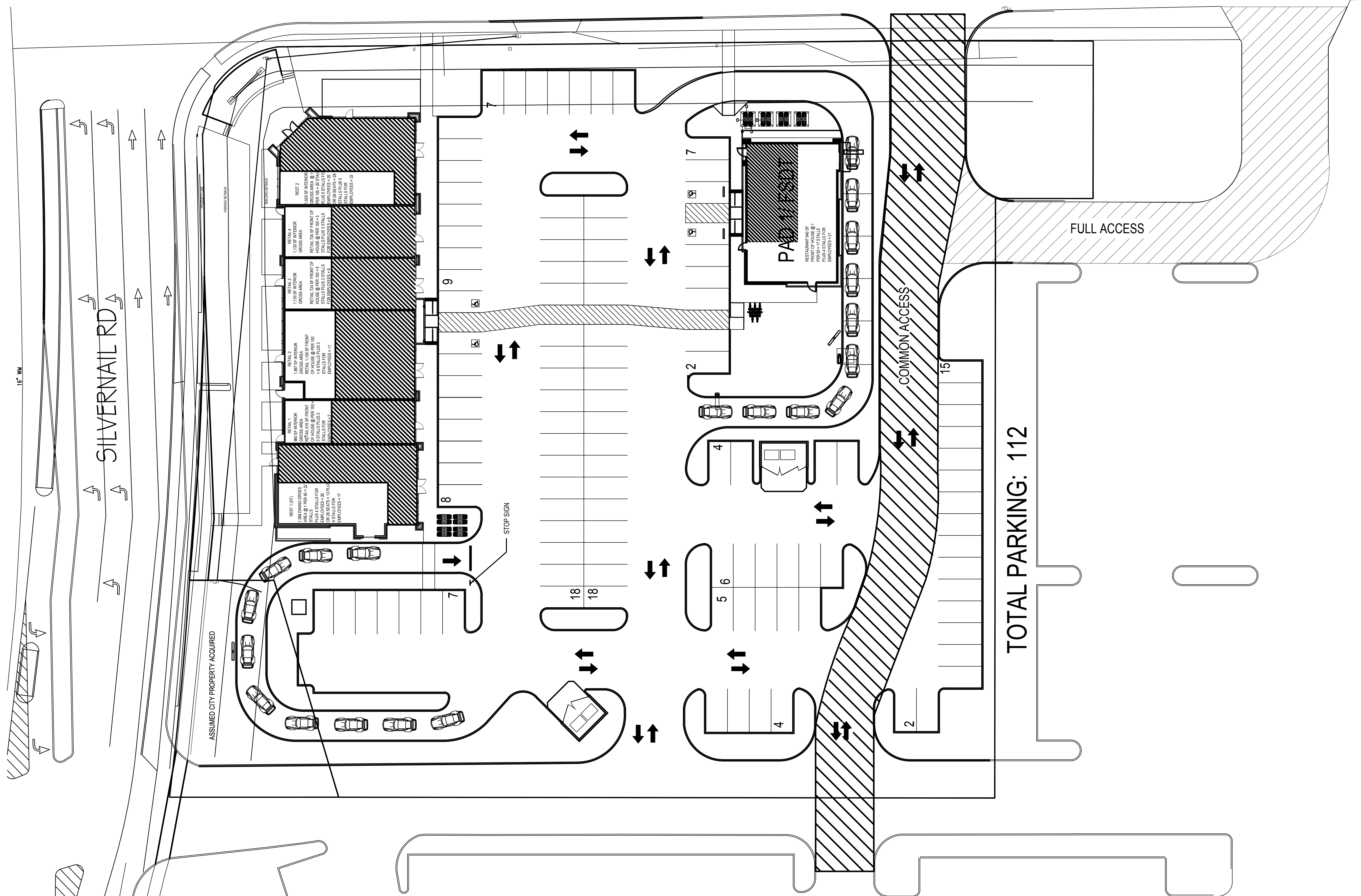

SITE INFORMATION

COMBINED LOT SIZE - 100,379 SF
 (PER ALTA) (2.304 ACRES)

BUILDING SQUARE FOOTAGES:

PANDA EXPRESS - 2,600 SF
 CFT RETAIL CENTER - 9,660 SF
 TOTAL - 12,260 SF

PARKING CALCULATIONS:

112 SPACES TOTAL PROVIDED

RESTAURANT
 1 SPACE PER 100 SF DINING AREA # 1
 SPACE PER EMPLOYEE

RETAIL
 1 SPACE PER 150 SF FRONT OF
 HOUSE # 1 SPACE PER EMPLOYEE

DRIVE THRU
 1 SPACE PER 50 SF DINING AREA # 1
 SPACE PER EMPLOYEE

PANDA EXPRESS - 840 / 50 =
 17 SPACES

+ 4 EMPLOYEES MAX =
 21 TOTAL SPACES REQ.

RETAIL BUILDING:

REST 1 (DT) - 21,098 / 50 = 22
 SPACES
 +4 EMPLOYEE MAX =
 26 TOTAL SPACES REQ.

REST 2 - 1,920 / 100 = 20 SPACES
 +5 EMPLOYEE MAX =
 25 TOTAL SPACES REQ.

RETAIL 1 - 615 / 150 SF = 5 SPACES
 + 2 EMPLOYEE MAX =
 7 SPACES REQ.

RETAIL 2 - 1,195 / 150 SF = 8
 SPACES
 + 3 EMPLOYEE MAX =
 11 SPACES REQ.

RETAIL 3 - 724 / 150 SF = 5 SPACES
 + 3 EMPLOYEE MAX =
 8 SPACES REQ.

RETAIL 4 - 724 / 150 SF = 5 SPACES
 + 3 EMPLOYEE MAX =
 8 SPACES REQ.

TOTAL RETAIL BUILDING REQ. PARKING
 = 85 STALLS

TOTAL SHOPPING CENTER REQ
 PARKING = 106 STALLS

6 SPACES REMAINING,
 NUMBERS SUBJECT TO CHANGE PER
 USE CLASSIFICATION.

CALCS PER MUNICOD SECTION 22.53

SITE PLAN
 SCALE: 1" = 20'-0"