

OBERLIN FILTER
 831 SILVER NAIL RD. WAUKESHA, WI

EROSION CONTROL PLAN
C3.0

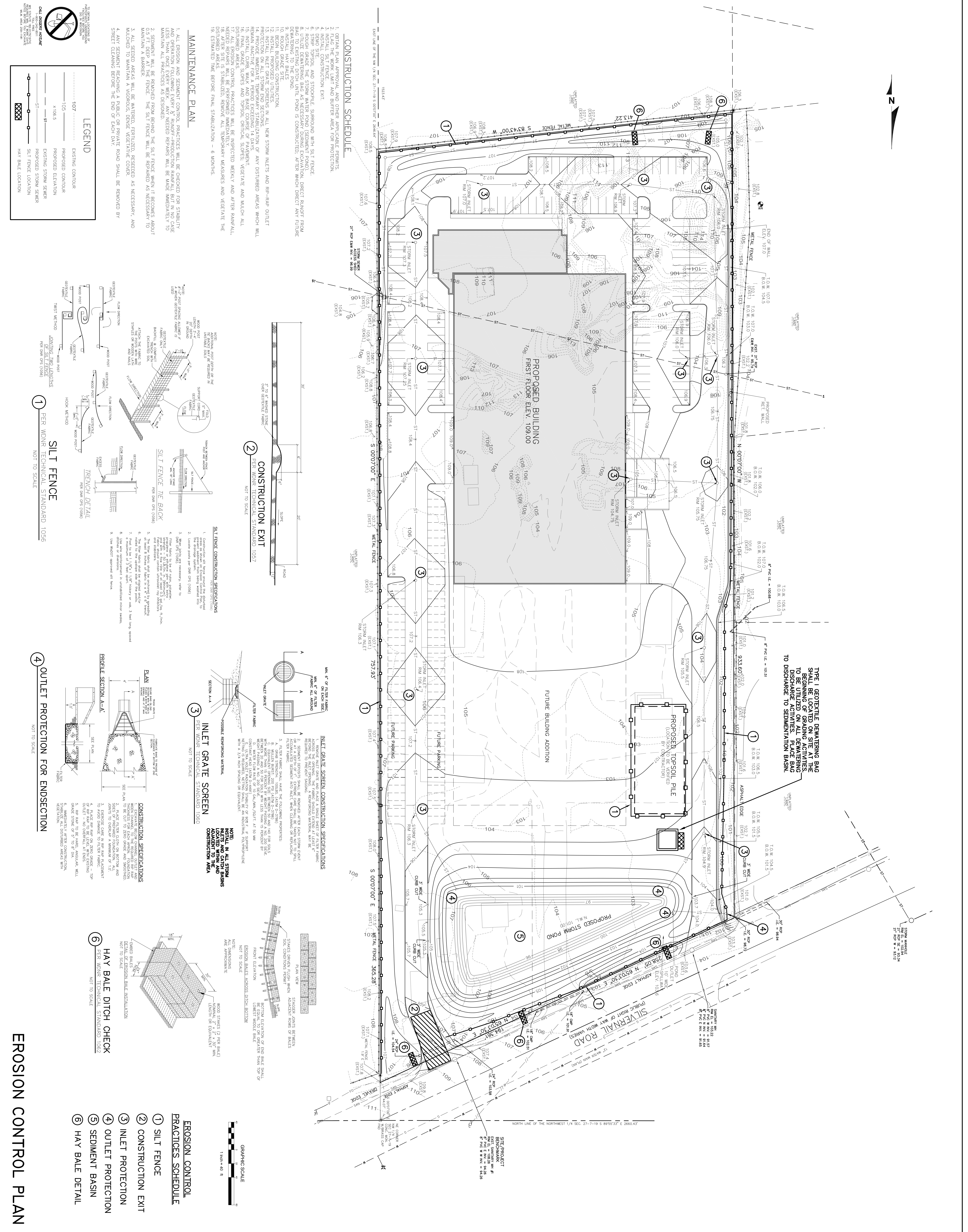

CONSTRUCTION SCHEDULE

1. OBTAIN PLAN APPROVAL AND OTHER APPLICABLE PERMITS.
2. INSTALL SILT FENCE.
3. INSTALL CONSTRUCTION EXIT.
4. STRIP TOPSOIL AND STOCKPILE, SURROUND WITH SILT FENCE.
5. ROUGH GRADE THE STORM WATER POND (SEDIMENT POND) DIRECT DRIVWAY FROM BAG TO EXISTING DITCH UNTIL POND IS CONSTRUCTED. AFTER WHICH DIRECT ANY FUTURE DRAINAGE TO THE POND.
6. ROUGH GRADE SITE.
7. INSTALL PROPOSED UTILITIES.
8. INSTALL INLET GRATE SCREENS IN ALL NEW STORM INLETS AND REP-RAP OUTLET REMAIN INACTIVE FOR A PERIOD EXCEEDING 14 DAYS.
9. PROVIDE IMMEDIATE TEMPORARY STABILIZATION OF ANY DISTURBED AREAS WHICH WILL REMAIN INACTIVE FOR A PERIOD EXCEEDING 14 DAYS.
10. FINAL GRADE SLOPES AND TOPSOIL CRITICAL SLOPES; VEGETATE AND MULCH ALL NEEDED REPAIRS WILL BE PERFORMED IMMEDIATELY.
11. ALL EROSION CONTROL PRACTICES WILL BE INSPECTED WEEKLY AND AFTER RAINFALL. DISTURBED AREAS SHALL BE REPAIRED IMMEDIATELY.
12. ESTIMATED TIME BEFORE FINAL STABILIZATION - 6 MONTHS.

MAINTENANCE PLAN

1. ALL EROSION AND SEDIMENT CONTROL PRACTICES WILL BE CHECKED FOR STABILITY AND OPERATION FOLLOWING EVERY 1/2" RAINFALL-PRODUCTION RAINFALL BUT IN NO CASE MAINTAIN ALL PRACTICES AS DESIGNED.
2. SEDIMENT WILL BE REMOVED FROM BEHIND THE SILT FENCE WHEN IT BECOMES ABOUT 0.5 FT DEEP AT THE FENCE. THE SILT FENCE WILL BE REPAIRED AS NECESSARY TO MAINTAIN A BARRIER.
3. ALL SEEDS AREAS WILL BE WATERED, FERTILIZED, RESEED AS NECESSARY, AND MULCHED TO MAINTAIN A WOODS, DENSE VEGETATIVE COVER.
4. ANY SEEDING REPAIRING A PUBLIC OR PRIVATE ROAD SHALL BE REMOVED BY STREET CLOSING BEFORE THE END OF EACH DAY.

LEGEND

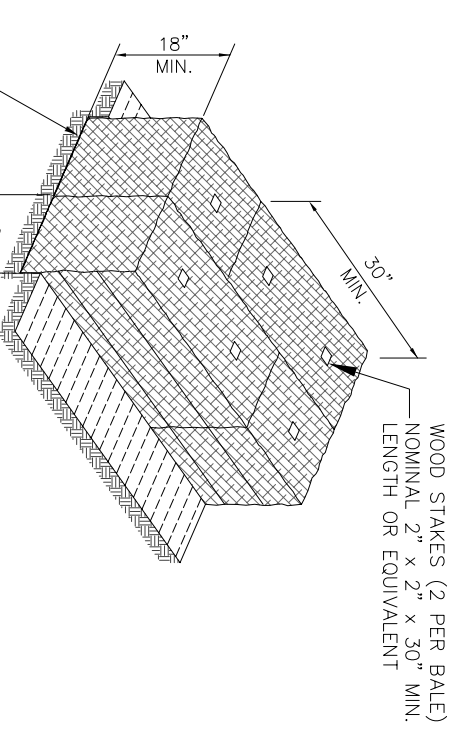
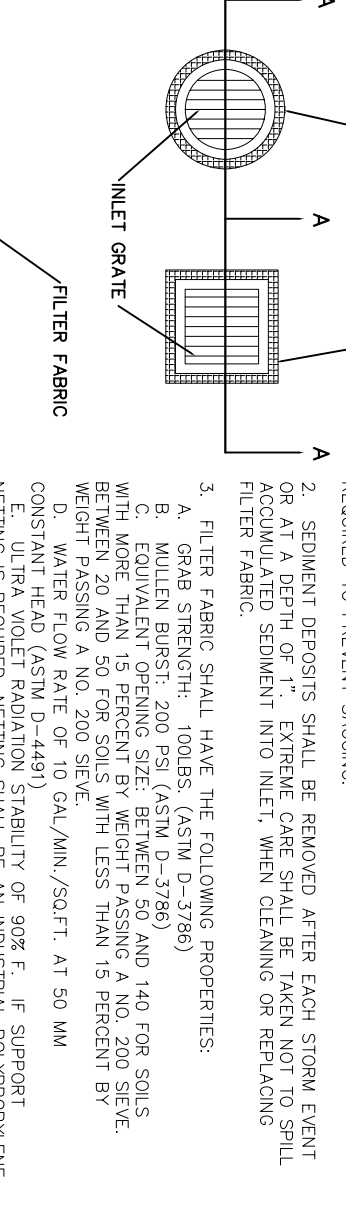
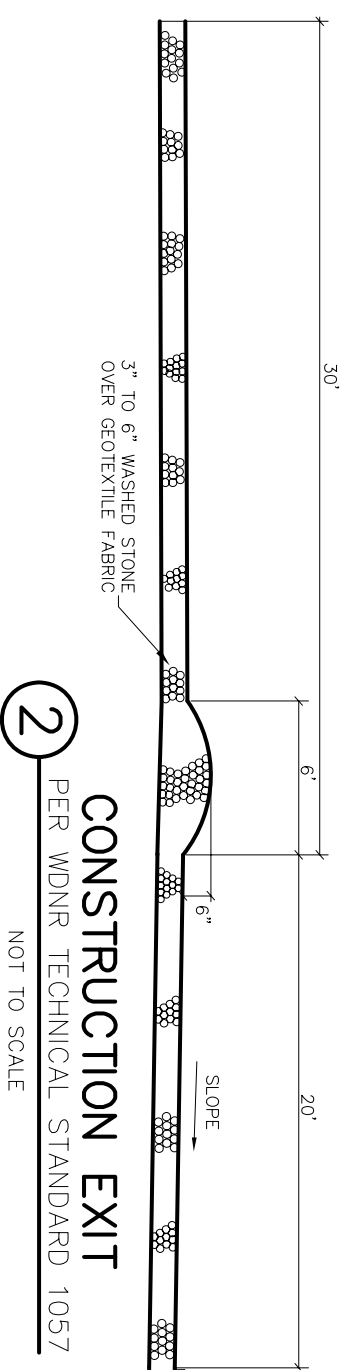
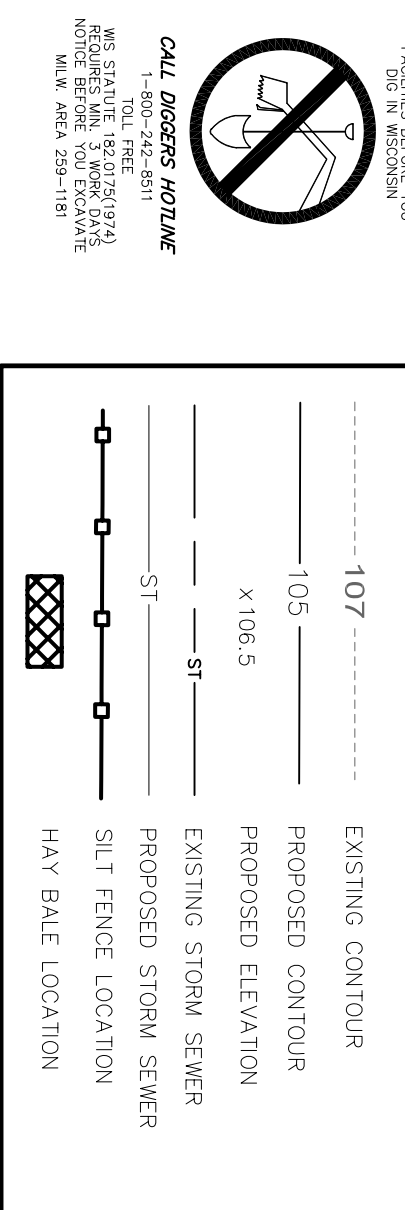

- EROSION CONTROL PRACTICES SCHEDULE**
- 1 SILT FENCE
 - 2 CONSTRUCTION EXIT
 - 3 INLET PROTECTION
 - 4 OUTLET PROTECTION
 - 5 SEDIMENT BASIN
 - 6 HAY BALE DETAIL

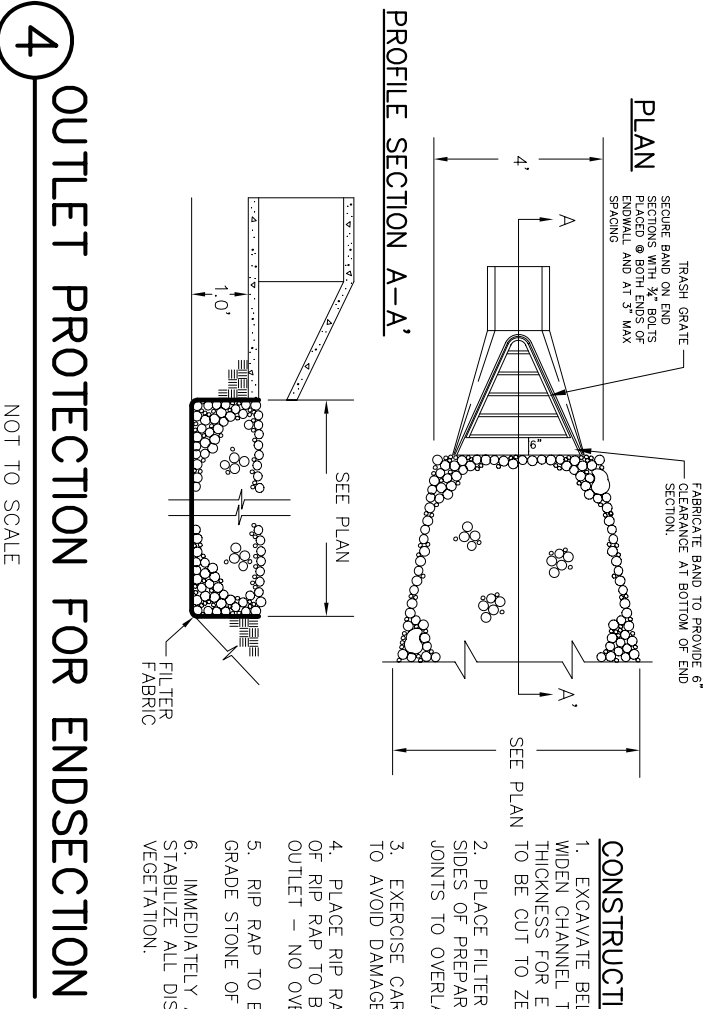
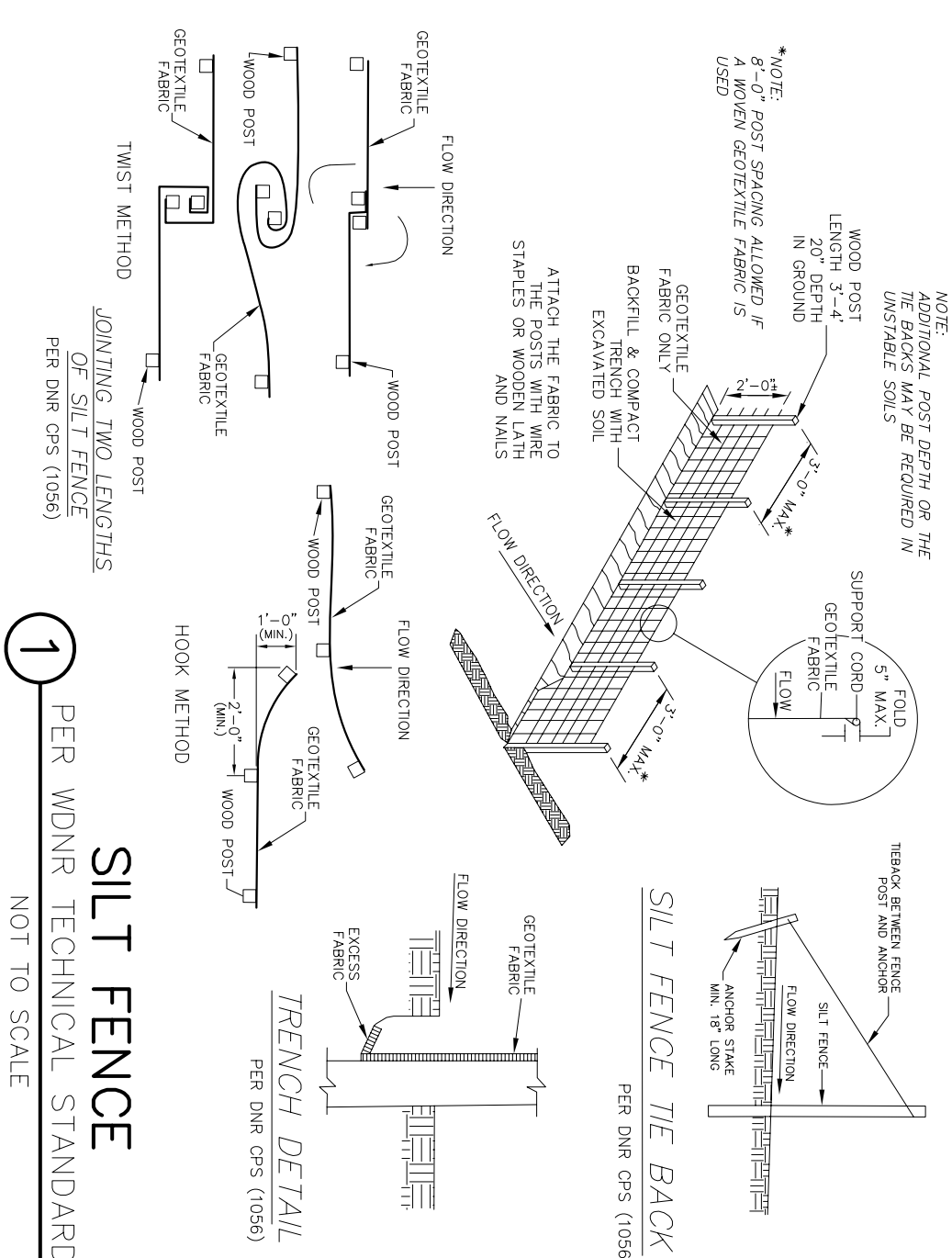
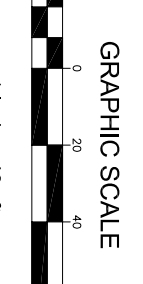

- SILT FENCE CONSTRUCTION SPECIFICATIONS**
1. Construct silt fence in firm ground. Do not construct silt fence in soft ground.
 2. Locate posts per SDP C3.0 (1056)
 3. After 100% inspection, verify to:
 4. Fabric mesh to be of equal weight.
 5. Fabric mesh to be of equal weight.
 6. The fabric mesh and its supporting soil/structure shall be inspected by a professional engineer.
 7. Post to be 1 1/2" x 1 1/2" heavy wall, 3' x 100' spaced
 8. Fabric mesh to be 1/2" x 1/2" heavy wall, 3' x 100' spaced
 9. Use wood stakes at intervals.

- INLET GRATE SCREEN CONSTRUCTION SPECIFICATIONS**
1. Inlet grate screen shall be installed in all new storm inlets and rep-rap outlets.
 2. Screenings shall be removed from the inlet grate screen.
 3. Screenings shall be removed from the inlet grate screen.
 4. Screenings shall be removed from the inlet grate screen.
 5. Screenings shall be removed from the inlet grate screen.
 6. Screenings shall be removed from the inlet grate screen.
 7. Screenings shall be removed from the inlet grate screen.
 8. Screenings shall be removed from the inlet grate screen.
 9. Screenings shall be removed from the inlet grate screen.

- CONSTRUCTION SPECIFICATIONS**
1. Hay bales shall be installed in all storm inlets and rep-rap outlets.
 2. Hay bales shall be installed in all storm inlets and rep-rap outlets.
 3. Hay bales shall be installed in all storm inlets and rep-rap outlets.
 4. Hay bales shall be installed in all storm inlets and rep-rap outlets.
 5. Hay bales shall be installed in all storm inlets and rep-rap outlets.
 6. Hay bales shall be installed in all storm inlets and rep-rap outlets.
 7. Hay bales shall be installed in all storm inlets and rep-rap outlets.
 8. Hay bales shall be installed in all storm inlets and rep-rap outlets.
 9. Hay bales shall be installed in all storm inlets and rep-rap outlets.