

SURVEYOR'S CERTIFICATE

STATE OF WISCONSIN } ss.
 COUNTY OF WAUKESHA }

WE, JAHNKE & JAHNKE ASSOCIATES INC., DO HEREBY CERTIFY THAT WE HAVE MADE THIS SURVEY AND THAT THE INFORMATION AS SHOWN ON THE ABOVE PLAT OF SURVEY IS TRUE AND CORRECT REPRESENTATION THEREOF.

John R. Stigler
 JOHN R. STIGLER - Wis. Reg. No. S-1820
 Dated this 28th day of September, 2016

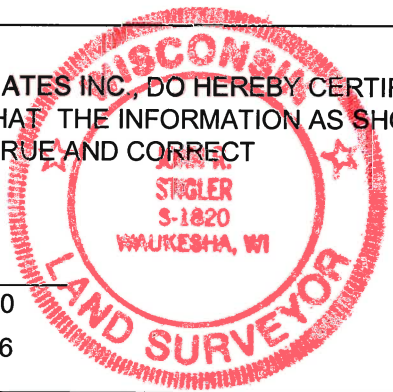

EXHIBIT A FOR: WAUKESHA IRON AND METAL PART OF THE SE 1/4 OF SEC. 35, T.7N., R.19E. CITY OF WAUKESHA, WAUKESHA COUNTY, WISCONSIN		
JAHNKE & JAHNKE ASSOCIATES INC. PLANNERS & PROFESSIONAL ENGINEERS 711 W. MORELAND BLVD.-WAUKESHA, WI. 53188 TEL.No.(262) 542-5797 FAX (262) 542-7698 (E-MAIL nszibel@jahnkeandjahnke.com)		
SCALE: 1"= 40'	DATE: SEPTEMBER 28, 2016	
DRAWN BY: N.S.	CHECKED BY: J.R.S.	FILE NO.: PEWAUKEE-1054
BOOK NO.: PEWAUKEE -171 pg 33	JOB: S-7781	SHEET 1 OF 1

FILE NAME: S:\PROJECTS\IS7781\DWG\IS7781-2016.dwg