

Waukesha  
City Hall  
Waukesha, WI

**B | W | B | R**

1241 John Q Hammons Dr., Ste. 503  
Madison, WI 53717  
608.829.3701  
bwbr.com

Consultants

**RING & DUCHATEAU**  
17400 West Capitol Drive - Brookfield, WI 53045  
Phone: 414.778.1700 / Fax: 414.778.2360 / r-d@ringdu.com  
RD Project Number: 218221.02

This document may be an electronic file or may be printed from an electronic file provided to the user. It is the sole responsibility of the user to ensure that the content and quality is consistent with the content and quality of the original documents on file at BWBR.

I hereby certify that this plan, specification or report was prepared by me or under my direct supervision and that I am a duly Licensed Registered Architect under the laws of the State of Wisconsin.

Name

Date Issue Date Lic./Reg. No.

Issued For

Item Date

**NOT FOR CONSTRUCTION**  
**FOR REFERENCE ONLY**

This Sheet may be a Reduced Copy  
The bar above is 1" long on a Full Size Sheet.  
Drawing Scales apply to Full Size Sheets.

Comm. No. Drawn

3.2017123.00 PCW

Sheet Title

**CITY SUBMITTAL - ZONE 3**

Sheet No.

**102**

Copyright BWBR

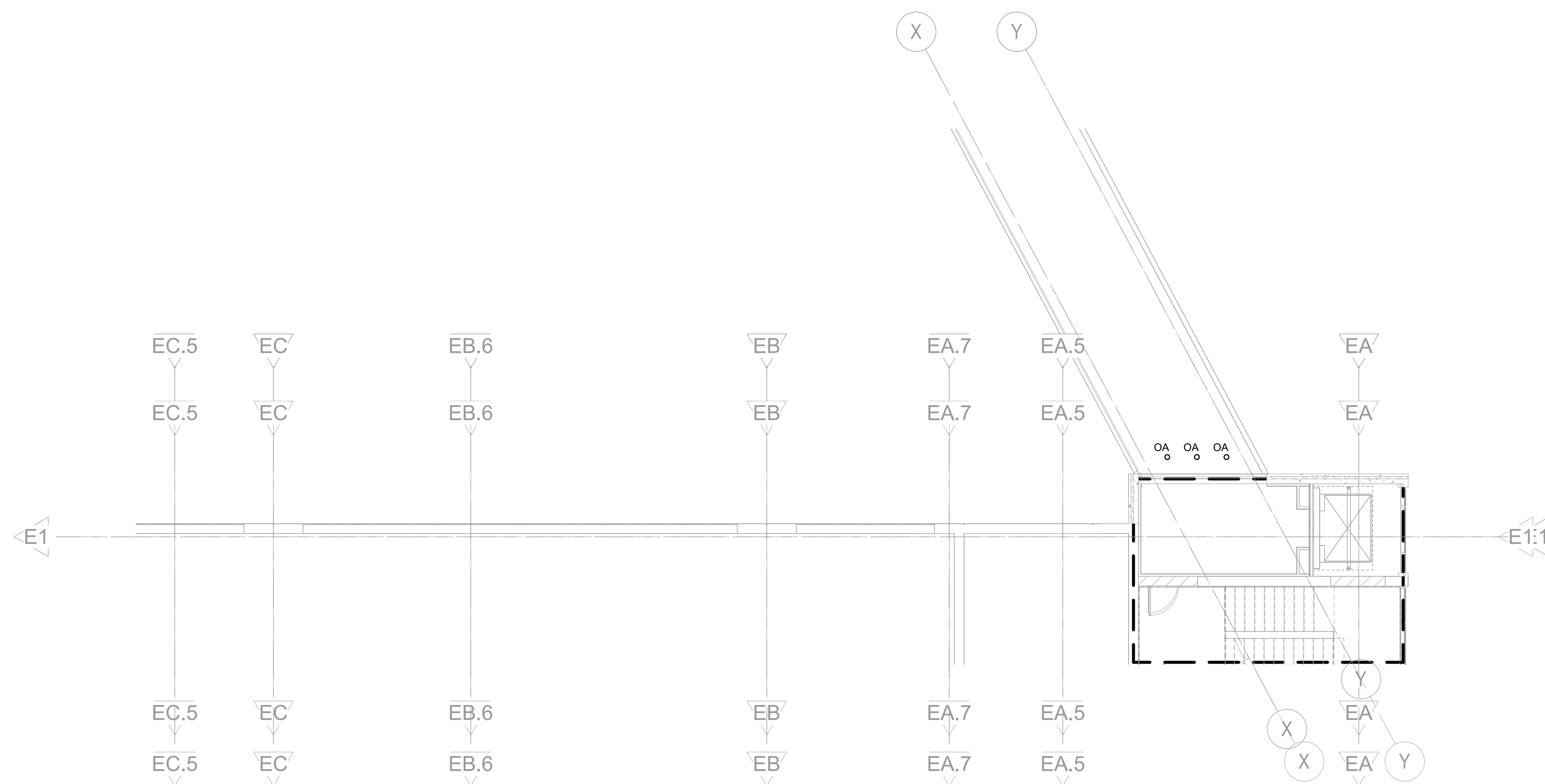

**1** LIGHTING PLAN - FIRST LEVEL - ZONE 3 CITY SUBMITTAL  
1/8" = 1'-0"

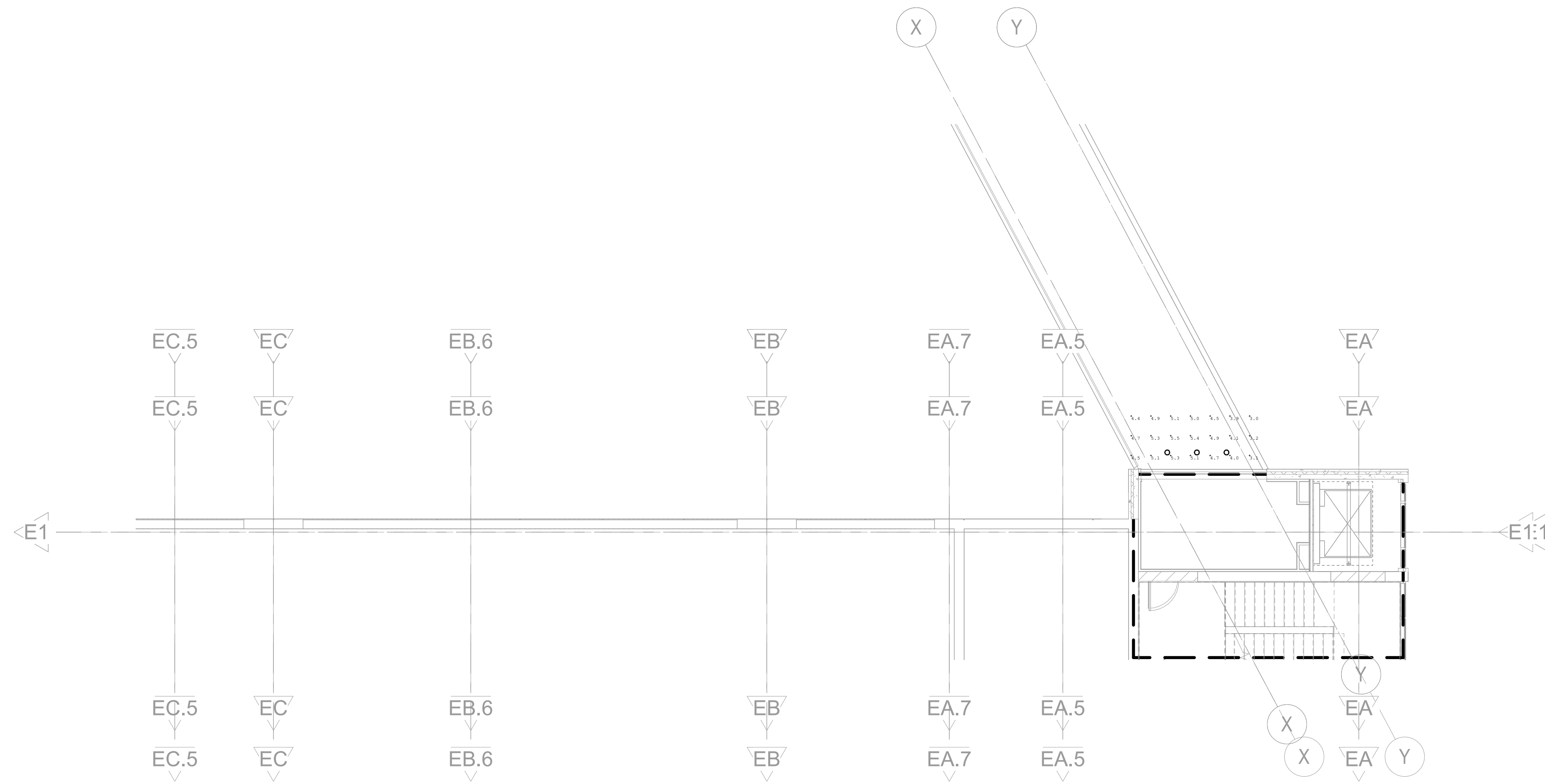

**2** LIGHTING PLAN - FIRST LEVEL - ZONE 3 PHOTOMETRIC  
1/8" = 1'-0"

Calculation Summary							
Label	CalcType	Unit	Avg	Max	Min	Avg/Min	Max/Min
PARR GARAGE_EXIT DOOR	Illuminance	FC	4.56	5.5	3.0	1.52	1.83