

E. MAIN STREET

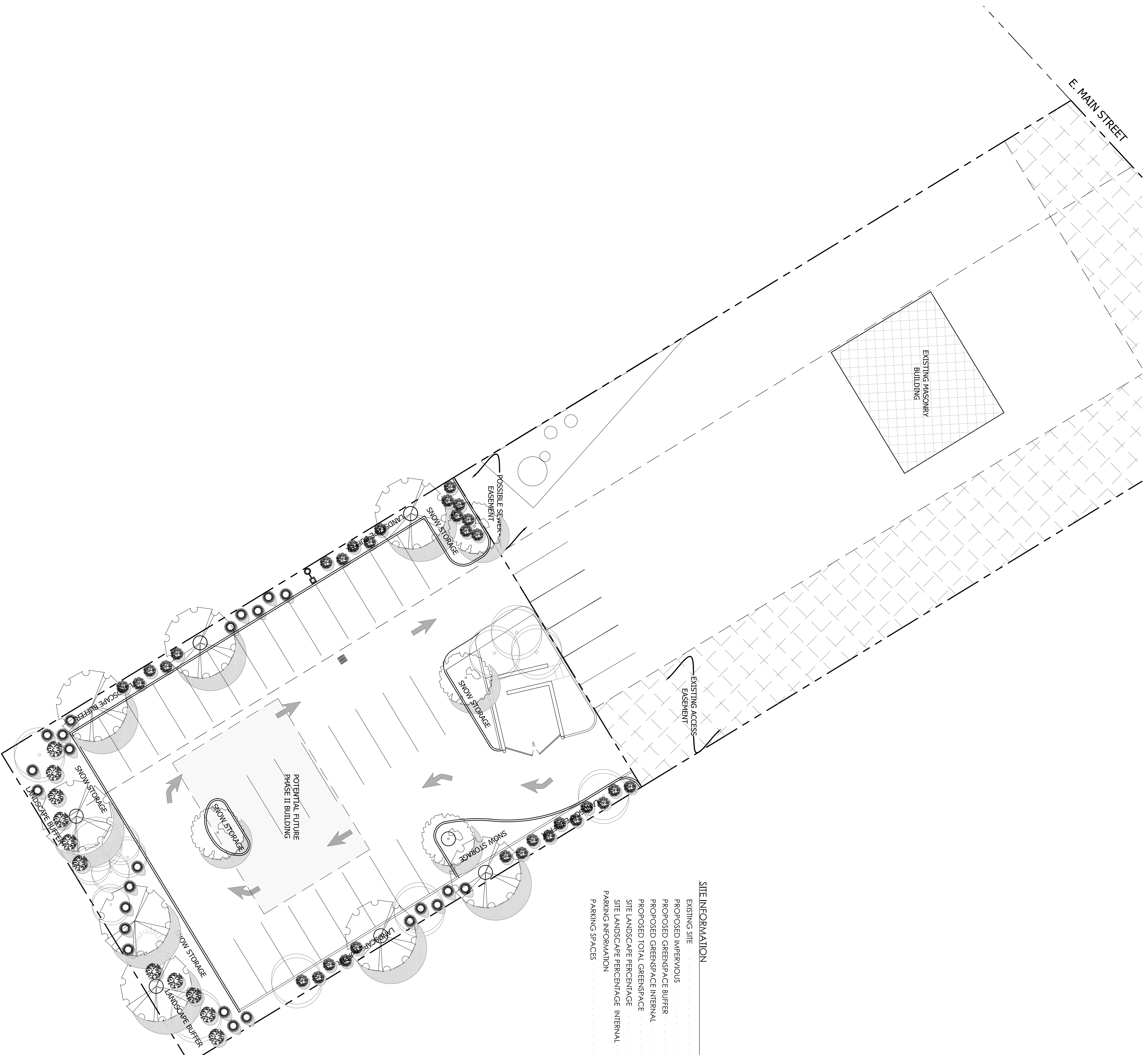

SITE INFORMATION

EXISTING SITE	15,387 SQ. FT.
PROPOSED IMPERVIOUS	10,942 SQ. FT.
PROPOSED GREENSPACE BUFFER	3,295 SQ. FT.
PROPOSED GREENSPACE INTERNAL	1,150 SQ. FT.
PROPOSED TOTAL GREENSPACE	4,445 SQ. FT.
SITE LANDSCAPE PERCENTAGE	APPROX. 28.8%
PARKING INFORMATION	APPROX. 7.5%
PARKING SPACES	29 STALLS

1. OBTAIN PLANNING DEPARTMENT AND OTHER APPLICABLE PERMITS.
2. FLAG THE WORK LIMIT AND BUFFER AREA FOR PROTECTION.
3. INSTALL SILT FENCE.
4. STAKE AND STAKE OUT THE PROPOSED CONSTRUCTION LIMIT.
5. STRIP TOPSOIL AND STOCKPILE AT LOCATION SHOWN, SURROUND WITH SILT FENCE.
6. ROUGH GRADE SITE.
7. BEGIN BUILDING CONSTRUCTION.
8. UTILIZE DEWATERING BAG AS NECESSARY. DIRECT RUNOFF FROM BAG TO EXISTING STORM DRAINAGE SYSTEMS AS EQUIPPED.
9. PROVIDE IMMEDIATE TEMPORARY STABILIZATION OF ANY DISTURBED AREAS WHICH WILL REMAIN UNCOVERED FOR A PERIOD EXCEEDING 14 DAYS.
10. UTILIZE DEWATERING BAG AS NECESSARY DURING EXCAVATION FOR BUILDING CONSTRUCTION. DIRECT RUNOFF FROM BAG TO EXISTING STORM WATER FACILITIES.
11. PROVIDE IMMEDIATE TEMPORARY STABILIZATION OF ANY DISTURBED AREAS WHICH WILL REMAIN UNCOVERED FOR A PERIOD EXCEEDING 14 DAYS.
12. FINAL GRADE SLOPES AND TOPSOIL CRITICAL SLOPES. VEGETATE AND MULCH ALL DISTURBED AREAS.
13. FINAL GRADE SLOPES AND TOPSOIL CRITICAL SLOPES. VEGETATE AND MULCH ALL DISTURBED AREAS.
14. ALL EROSION CONTROL PRACTICES WILL BE INSPECTED WEEKLY AND AFTER RAINFALL. NEEDED REPAIRS WILL BE PERFORMED IMMEDIATELY.
15. ALL EROSION CONTROL PRACTICES WILL BE MAINTAINED THROUGHOUT CONSTRUCTION. ALL EROSION CONTROL PRACTICES WILL BE MAINTAINED THROUGHOUT CONSTRUCTION. REMOVE ALL TEMPORARY MEASURES AND VEGETATE THE DISTURBED AREAS.
16. ESTIMATED TIME BEFORE FINAL STABILIZATION - 3 MONTHS.

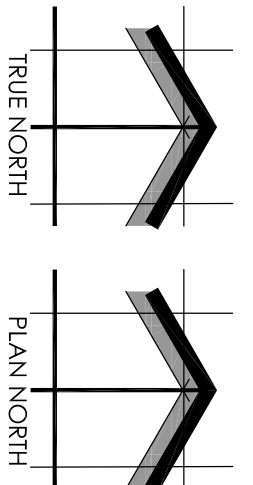

SHEET NUMBER: LSP1.1
08/21/2015
L15-027

WAIKESHIA'S BEST CARS- WAIKESHIA, WI
Proposed Preliminary Landscape Plan - Scheme "C"