

CERTIFIED SURVEY MAP NO.

A DIVISION OF THAT PART OF THE NORTHWEST 1/4 OF THE SOUTHEAST 1/4, THE SOUTHWEST 1/4 OF THE SOUTHEAST 1/4, AND THE SOUTHEAST 1/4 OF THE SOUTHWEST 1/4 OF SECTION 1, THE NORTHWEST 1/4 OF THE NORTHEAST 1/4 AND THE NORTHEAST 1/4 OF THE NORTHEAST 1/4 OF SECTION 12 TOWNSHIP 6 NORTH, RANGE 19 EAST, IN THE CITY OF WAUKESHA, WAUKESHA COUNTY, WISCONSIN.

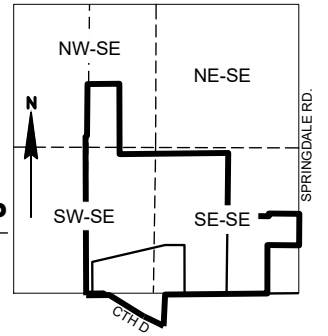

VICINITY MAP

SE 1/4, SEC. 1-6-19
NE 1/4, SEC. 12-6-19
Scale: 1" = 2000'

OVERLAP BETWEEN LEGAL DESCRIPTION AND CSM 7626

UNPLATTED LANDS

GAP BETWEEN LEGAL DESCRIPTIONS

LOT 4
CSM.7626

LOT 5
CSM.7626

LOT 1
CSM.11123

POB

NW-SE

NE-SE

SW-SE

SE-SE

NW-NE

NE-NE

LOT 2
45.56 ACRES
EXCLUDING 0.27 ACRES OR 11,734 SQ FT FOR R/W

LOT 1
9.84 ACRES
EXCLUDING 0.10 ACRES OR 4,394 SQ FT FOR R/W

PARCEL 1
CSM.1214

PARCEL 1
CSM.1214

LOT 1
CSM.11105

150' WIDE WEPC EASEMENT
V.1064 P.9 DOC.672186

PARCEL 1
CSM.3080

PARCEL 1
CSM.3080

PARCEL 3
CSM.3080

EAST 1/4 CORNER OF SECTION 1-6-19
FOUND CONCRETE MON. W/ BRASS CAP
N = 373456.33
E = 2485040.76

SOUTHEAST CORNER OF SECTION 1-6-19
FOUND CONCRETE MON. W/ BRASS CAP
N = 370804.290
E = 2485024.270

Notes:

- Bearings are referenced to NAD 27, Wisconsin State Plane Coordinate System, South Zone, in which the South Line of the Southeast 1/4 of Section 1, Township 6 North, Range 19 East, which bears S89° 26' 44"W.
- Overhead electric easement to WEPC, NE 1/4 Section 12 (not mappable) Doc. 242005
- Overhead electric easement to Wisconsin Gas & Electric Company, NE 1/4 of Section 12, NE side of Highway (not mappable), Doc. 212667
- Overhead electric easement to Wisconsin Gas & Electric Company, SE 1/4 of Section 1, NE side of Highway (not mappable), Doc. 212969
- Overhead electric easement to Milwaukee Electric Railway and Light Company, SE 1/4 Section 1 along Springdale Road, (not mappable)

LEGEND

- FOUND IRON PIPE 1.25" OD IP (UNLESS NOTED)
- ⊕ FOUND CONCRETE MONUMENT WITH BRASS CAP
- SET 3/4" X 24" REBAR

- — — PROPERTY LINE
- — — EXISTING R/W LINE

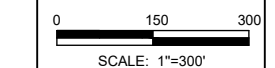

N17 W24222 Riverwood Drive, Suite 310
Waukesha, WI 53188
(262) 523-4488

CERTIFIED SURVEY MAP NO. _____

A DIVISION OF THAT PART OF THE NORTHWEST 1/4 OF THE SOUTHEAST 1/4, THE SOUTHWEST 1/4 OF THE SOUTHEAST 1/4, AND THE SOUTHEAST 1/4 OF THE SOUTHEAST 1/4 OF SECTION 1, THE NORTHWEST 1/4 OF THE NORTHEAST 1/4 AND THE NORTHEAST 1/4 OF THE NORTHEAST 1/4 OF SECTION 12 TOWNSHIP 6 NORTH, RANGE 19 EAST, IN THE CITY OF WAUKESHA, WAUKESHA COUNTY, WISCONSIN.

SURVEYOR'S CERTIFICATE
STATE OF WISCONSIN)

WAUKESHA COUNTY): ss

I, Benjamin J Larson, professional surveyor, certify:

That I have surveyed, divided and mapped a part of the Northwest 1/4 of the Southeast 1/4, the Southwest 1/4 of the Southeast 1/4, and the Southeast 1/4 of the Southeast 1/4 of Section 1, the Northwest 1/4 of the Northeast 1/4 and the Northeast 1/4 of the Northeast 1/4 of Section 12 Township 6 North, Range 19 East, in the City of Waukesha, Waukesha County, Wisconsin, which is bounded and described as follows:

COMMENCING at the South Quarter Corner of said Section 1,
Thence North 89°26'44" East along the South line of the Southeast Quarter of said Section 1, 666.65 feet to the **POINT OF BEGINNING**;
Thence North 00°13'33" West, 33.00 feet to the North right of way line of CTH D and the Southeast corner of Lot 1 of CSM 11125;
Thence North 00°13'33" West along the East line of said Lot 1 of CSM 11125, 1457.97 feet to the South line of Lot 5 of CSM 7626;
Thence North 56°27'17" East along said South line, 16.99 feet to the East line of said of CSM 7626;
Thence North 00°31'12" East along said East line, 485.22 feet;
Thence North 89°20'45" East, 299.49 feet;
Thence South 00°13'33" East, 661.96 feet to the South line of the Northwest Quarter of the Southeast Quarter of said Section 1;
Thence North 89°22'43" East along said South line, 1021.13 feet to the Northwest corner of CSM 1214;
Thence South 00°39'53" West along the West line of said CSM 1214, 401.31 feet to the Southwest corner of said CSM 1241;
Thence continuing South 00°39'53" West, 189.29 feet;
Thence South 89°20'07" East, 388.72 feet;
Thence North 0°47'14" East, 26.02 feet
Thence South 89°20'07" East, 286.49 feet to the centerline of Springdale Road and the East line of Said Section 1;
Thence South 00°21'23" West along said East line and said centerline, 296.38 feet;
Thence North 89°27'56" West along the North line of CSM 1254, 298.03 feet to the Northwest corner of said CSM 1251;
Thence South 00°05'32" West along the West line of said CSM 1254, 455.63 feet to the Southwest corner of said CSM 1251 and the South line of said Section 1;
Thence South 89°26'44" West along said South line, 960.98 feet;
Thence South 02°46'26" West, 297.69 feet to the North right of way line of CTH D;
Thence along said North right of way line and the arc of a non-tangent curve 204.83 feet to the left, said curve having a radius of 2931.28 feet, and a chord which bears North 63°58'04" West for 204.78 feet;
Thence North 58°11'13" West along said right of way line, 383.92 feet to the South line said Section 1;
Thence South 89°26'44" West along said South line, 218.33 feet **POINT OF BEGINNING**.

Contains 2,413,228 SQ FT or 55.40 acres of land more or less

That I have made the survey, land division, and map by the direction of the City of Waukesha
That the map is a correct representation of all the exterior boundaries of the land surveyed and the land division thereof made.

That I have fully complied with Chapter 236 of the Wisconsin Statutes and the subdivision regulations of the City of Waukesha in surveying, dividing and mapping the same.

Benjamin J Larson, Professional Wisconsin Land Surveyor, 3006

Date

Signature

CERTIFIED SURVEY MAP NO. _____

A DIVISION OF THAT PART OF THE NORTHWEST 1/4 OF THE SOUTHEAST 1/4, THE SOUTHWEST 1/4 OF THE SOUTHEAST 1/4, AND THE SOUTHEAST 1/4 OF THE SOUTHEAST 1/4 OF SECTION 1, THE NORTHWEST 1/4 OF THE NORTHEAST 1/4 AND THE NORTHEAST 1/4 OF THE NORTHEAST 1/4 OF SECTION 12 TOWNSHIP 6 NORTH, RANGE 19 EAST, IN THE CITY OF WAUKESHA, WAUKESHA COUNTY, WISCONSIN.

CORPORATE OWNER'S CERTIFICATE:

City of Waukesha, municipality a corporation duly organized and existing under and by virtue of the laws of the State of Wisconsin, as owner, certifies that said corporation caused the land described on this map to be surveyed, divided, mapped, and dedicated as represented on this map and in consideration of the approval of the map by the Common Council and in accordance Chapter 236 of the Wisconsin Statutes and the subdivision regulations of the City of Waukesha in surveying, dividing and mapping the same.

This agreement shall be binding on the undersigned and assigns.

In Witness Whereof, City of Waukesha has caused these presents to be signed by

_____, its President; and countersigned by _____, its Secretary, at _____, Wisconsin, this ____ day of _____, 2020.

In the presences of:

City of Waukesha
(Corporate Name)

(Witness)

(Print Name), President

(Witness)

(Print Name), Secretary

STATE OF WISCONSIN)
WAUKESHA COUNTY):SS

Personally came before me this ____ day of _____, 2020, _____ President, and _____, Secretary of the above named corporation, to me known as the person who executed the foregoing instrument, and to me known to be the President and Secretary of the corporation, and acknowledged that the executed the foregoing instrument as such officers as the deed of said corporation, by its authority.

(Notary Seal)

_____, Notary Public

State of Wisconsin
My Commission expires _____

CERTIFIED SURVEY MAP NO. _____

A DIVISION OF THAT PART OF THE NORTHWEST 1/4 OF THE SOUTHEAST 1/4, THE SOUTHWEST 1/4 OF THE SOUTHEAST 1/4, AND THE SOUTHEAST 1/4 OF THE SOUTHEAST 1/4 OF SECTION 1, THE NORTHWEST 1/4 OF THE NORTHEAST 1/4 AND THE NORTHEAST 1/4 OF THE NORTHEAST 1/4 OF SECTION 12 TOWNSHIP 6 NORTH, RANGE 19 EAST, IN THE CITY OF WAUKESHA, WAUKESHA COUNTY, WISCONSIN.

COMMON COUNCIL CERTIFICATE:

Resolved that the Certified Survey Map, in the City of Waukesha, Waukesha County, corporate owner, is hereby approved by the Common Council.

In consideration of the approval of the map by the Common Council and in accordance Chapter 236 of the Wisconsin Statutes and the subdivision regulations of the City of Waukesha in surveying, dividing and mapping the same.

All conditions have been met as of the ___ day of _____, 2020,

Date: _____ Signed _____,
Shawn N Reilly, Chariman

I hereby certify that the forgoing is true and correct copy of a resolution adopted by the Common Council of the City of Waukesha

Date: _____ Signed _____,
Gina Kozlik, City Clerk/Treasurer

CITY OF WAUKESHA PLAN COMMISSION APPROVAL CERTIFICATE:

Approved by the Plan Commission, City of Waukesha

Dated this ___ day of _____, 2020,

Signed _____,
Shawn N Reilly, Chariman

Signed _____,
Maria Pandazi, Secretary