

PROJECT INFORMATION

PROPOSED MASTER PLAN FOR:
MONTESSORI SCHOOL OF WAUKESHA
2600 SUMMIT AVENUE • WAUKESHA, WI

PROFESSIONAL SEAL

PRELIMINARY DATES

FEB. 5, 2021
FEB. 8, 2021
FEB. 19, 2021

NOT FOR CONSTRUCTION

JOB NUMBER
2053880

SHEET NUMBER

A1.2a

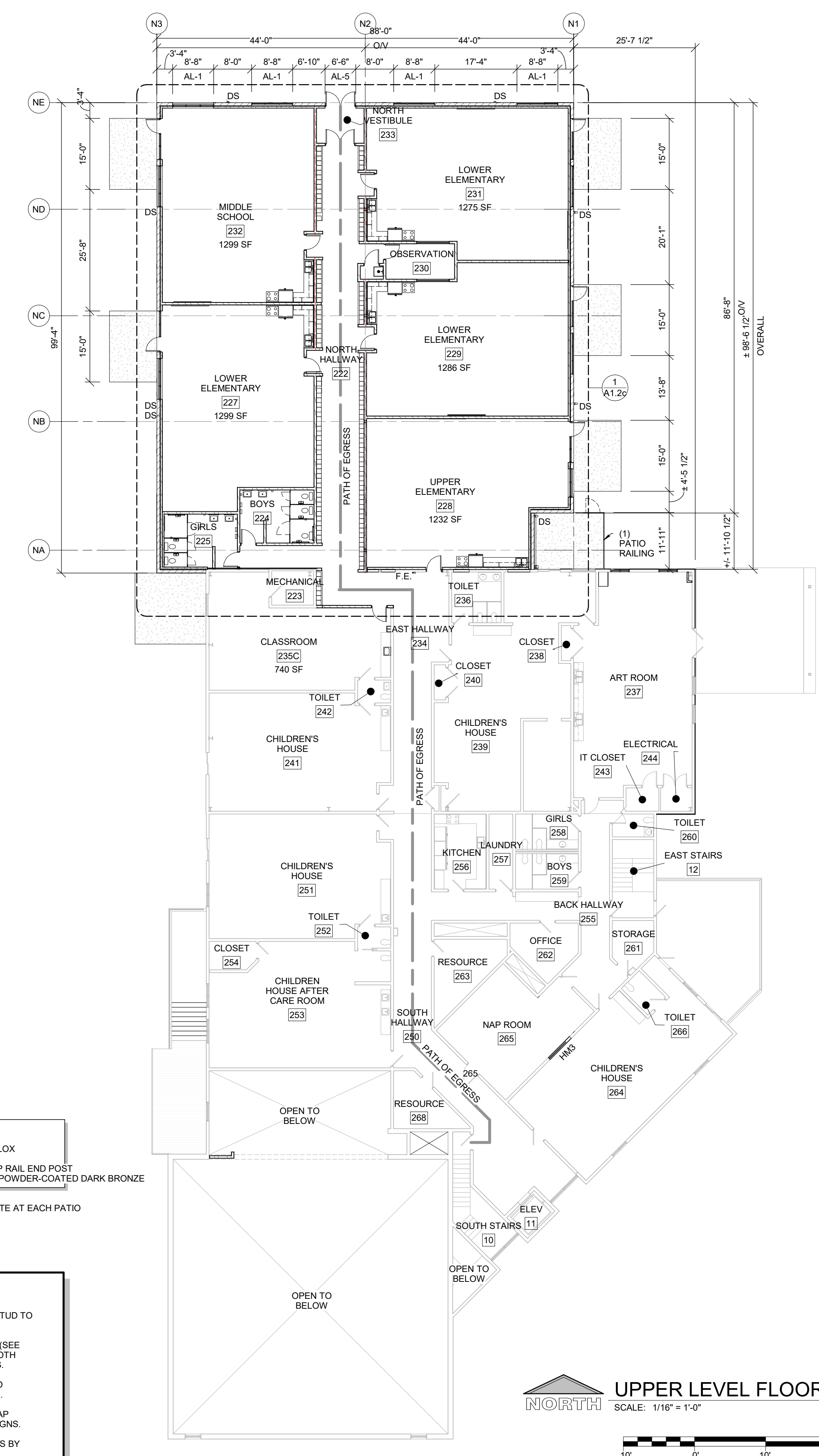

SYMBOLS LEGEND

	SEE A1 SHEETS FOR WALL TYPES
	EXIT SIGNAGE
	FIRE EXTINGUISHER w/ CABINET • SEE DETAIL 10/A5.0
	EXISTING WALL TO REMAIN
	EXISTING WALL TO BE DEMOLISHED
	STUD WALL
	CONCRETE WALL
	MASONRY VENEER 'O.V.' = OUTSIDE FACE OF VENEER
	RIGID INSULATION
SEE PLAN FOR ALL WALL WIDTHS	
	EXISTING DOOR TO REMAIN
	EXISTING DOOR TO BE DEMOLISHED
	NEW DOOR

PATIO RAILINGS
MANUFACTURER: ULTRALOX
PROFILE: MISSION
STYLE: CONTINUOUS TOP RAIL END POST
COLOR: MFR STANDARD POWDER-COATED DARK BRONZE
TOP RAIL TO BE 42" HIGH
PROVIDE (1) 36" WIDE GATE AT EACH PATIO

- GENERAL NOTES**
- ALL INTERIOR DIMENSIONS ARE FROM FACE-OF-STUD TO FACE-OF-STUD.
 - ALL INTERIOR WALLS TO BE 2x4 OR 2x6 @ 16" OC (SEE FLOOR PLAN FOR SIZE) w/ 5/8" GYPSUM BOARD BOTH SIDES - EXTEND TO BOTTOM CHORD OF TRUSSES.
 - PROVIDE 3 1/2" SOUND BATT INSULATION AROUND PERIMETER OF TOILET ROOM AND OFFICE WALLS.
 - MISCELLANEOUS HARDWARE INCLUDED: HANDICAP HARDWARE, MEN'S AND WOMEN'S REST ROOM SIGNS.
 - PROVIDE WOOD BLOCKING FOR ANY FURNISHINGS BY OWNER. (VERIFY LOCATIONS)
 - SEE A4 SHEETS FOR TYPICAL CONTROL JOINT DETAILS.
 - FINAL NUMBER AND LOCATION OF FIRE EXTINGUISHERS TO BE COORDINATED w/ FIRE MARSHALL

UPPER LEVEL FLOOR PLAN
SCALE: 1/16" = 1'-0"
NORTH

OVERALL UPPER LEVEL FLOOR PLAN