

Waukesha Parade Memorial

Richard Taylor

Introductory Narrative

I will work with you to design a memorable and meaningful Memorial for the victims and survivors of the tragic events at the Christmas Parade. Having lived in Waukesha in the 1980s, and having family with strong ties to Waukesha, I have great sympathy for those who lost their lives, those who were injured, those who lost loved ones, and all citizens of Waukesha.

The Memorial

My concept for the Memorial is to begin with seven living trees instead of six, and allow these seven living trees symbolize the over seventy people injured. These injured people are still among us, are still living, and I believe the seven living trees would serve well to pay tribute to them. I propose using cedar or arborvitae trees for their tall and stately forms, but am open to other suggestions for types of trees. The trees would serve as a backdrop to the Memorial and also as a sound barrier to St. Paul Avenue.

To pay honor to the six victims who lost their lives, I propose six abstract tree sculptures, all painted in varying shades of green. Greens are the most soothing and natural colors. Each of the six victims was an individual, and I believe the best way to pay tribute to their individuality is by creating a unique tree form for each of them. These tree-inspired sculptures would be quietly animated in their compositions, and would be celebrate the lives of the six by standing together in a show of unity and strength. They will stand out as uplifting beacons against the cedars behind them.

To further honor and remember the six victims, I propose a Medallion for each of them. Each of the six Medallions would have the victim's full name, a reproduction of their first name signature, a symbol of something appropriate in their lives, along with the words "Waukesha Strong" and the outline of a blue light. The Medallions would be made of brushed stainless steel with cut outs of letters and symbols. They would sit atop concrete cylinders which would also serve as seating.

Finally, there would be a Message Tree, two intersecting silhouettes of a tree with round holes for visitors to leave rolled papers with notes or drawings, flowers, ribbons, or any other meaningful tribute. There would also be space for lettering to honor donors and give any other information to the public deemed appropriate for the Memorial.

Materials

The six tree sculptures would be made of welded aluminum and painted with an industrial urethane. This is the best system for outdoor painted sculpture that exists. I have used this

system for decades with very good results. The “trunks” of the trees and base plates would be brushed aluminum. The benefit of using aluminum is that it will never rust. The trees would range in height from 10’ to 16’ and have a depth or thickness of 6” along the edges. The six sculptures would be permanently anchored to the tops of concrete cylinders 18” in height which could also serve as seating.

The Medallions and the Message Tree would be cut from ¼” thick stainless steel. This steel will never rust, and is maintenance free. The Medallions would be permanently anchored to the tops of concrete cylinders which could be used for seating. All concrete cylinders would have a beveled or chamfered edge.

Layout / Size

The layout I propose is roughly 45’ in width by 30’ in depth. This would contain the 7 cedar trees, 6 aluminum sculptural trees, 6 Medallions and the Message Tree. Please see the overhead view in one of the images for an illustration of the layout.

Working Together

I will work with you to modify any aspect of my proposal that you see fit to modify. I am a very collaborative person and enjoy the collaborative process. I have worked on commissioned sculptures and memorials for over 20 years with committees across the country. I have also worked with engineers, architects, landscape architects and designers in these commissions. I will have an engineer calculate the wind-loading on the sculptures and specify the appropriate anchors and size of concrete cylinders. (I have used 24” as the diameter of the concrete cylinders in the plans and this will most likely be fine with the engineer).

I can work with any contractors you may choose for concrete work, or I can suggest a contractor. My engineer would come up with the drawings for the concrete cylinders and provide them to the concrete contractor. We would also work with a nursery or landscaping service to choose and properly plant the seven trees, and you may have someone in mind to supply and plant the trees.

Victim’s Families

I will respectfully meet with the families of the victims to obtain copies of their first name signatures, and ideas for a symbol for each one, if the families are open to doing so. I see the symbols as being simple and chosen by the family for each victim. I would create the symbol in a form that is similar in style for each of the six medallions.

Budget and Timeline

I will work with you to finalize a layout in Grede Park, and that could take place this year. I would fabricate the tree sculptures, medallions and Message Tree in my studio over this winter

and have them finished and ready for installation early in Spring of 2023. If time is of the essence, it may be possible to fabricate and install later in fall of this year, but that may be rushing the process.

A preliminary budget:

Artist / Design Fee	30,000
Metal and metal cutting	20,000
Fabrication	40,000
Painting	5,000
Engineering	2,000
Delivery	1,000
Insurance	1,000
Concrete	18,000
Crane rental	1,000
Trees and Planting	12,000
	130,000

It may be possible to find donors for the trees, concrete work and crane rental. If so, the donors can be recognized on the Message Tree for their donations.

Installation

I will deliver all items to the site for installation and will coordinate it with a crane rental. I have worked with cranes many times and will have the sculptures slung for installation. I will supply the concrete contractor with templates for stainless steel rods to be set in concrete to anchor all of the sculptures. I will install the six medallions onto the cylinders. The medallions will have anchor rods welded to the backsides and will be permanently adhered to the concrete.

Main Street Memorial

One possibility is to use a variation of the Message Tree as the smaller memorial on Main St. I would work with you to redesign it to conform with the space available on Main St. if you were interested in an echo of the larger memorial on Main St.

Modifications

I am happy to work with you as a collaborator and to listen to any suggestions for changes to my design. I have worked with many committees in the past and we have always reached happy and respectful modifications in our design process.

Summary

This proposal will provide a destination for contemplation and reflection. It provides seating on both the Medallion cylinders and the cylinders which serve as bases for the six tree sculptures. The cedar trees provide some noise reduction and a quiet visual background for the tree sculptures. The quiet abstraction of the tree sculptures will provide a distinct and memorable marker for each of the victims, and will recognize them as individuals. The painted trees will also be a point of conversation for all who view them. All materials are durable and I have used them for decades in outdoor installations.

The overall statement of the Memorial is one of remembering and celebrating the lives of those who left us, and of celebrating the strength of the community despite their absence.

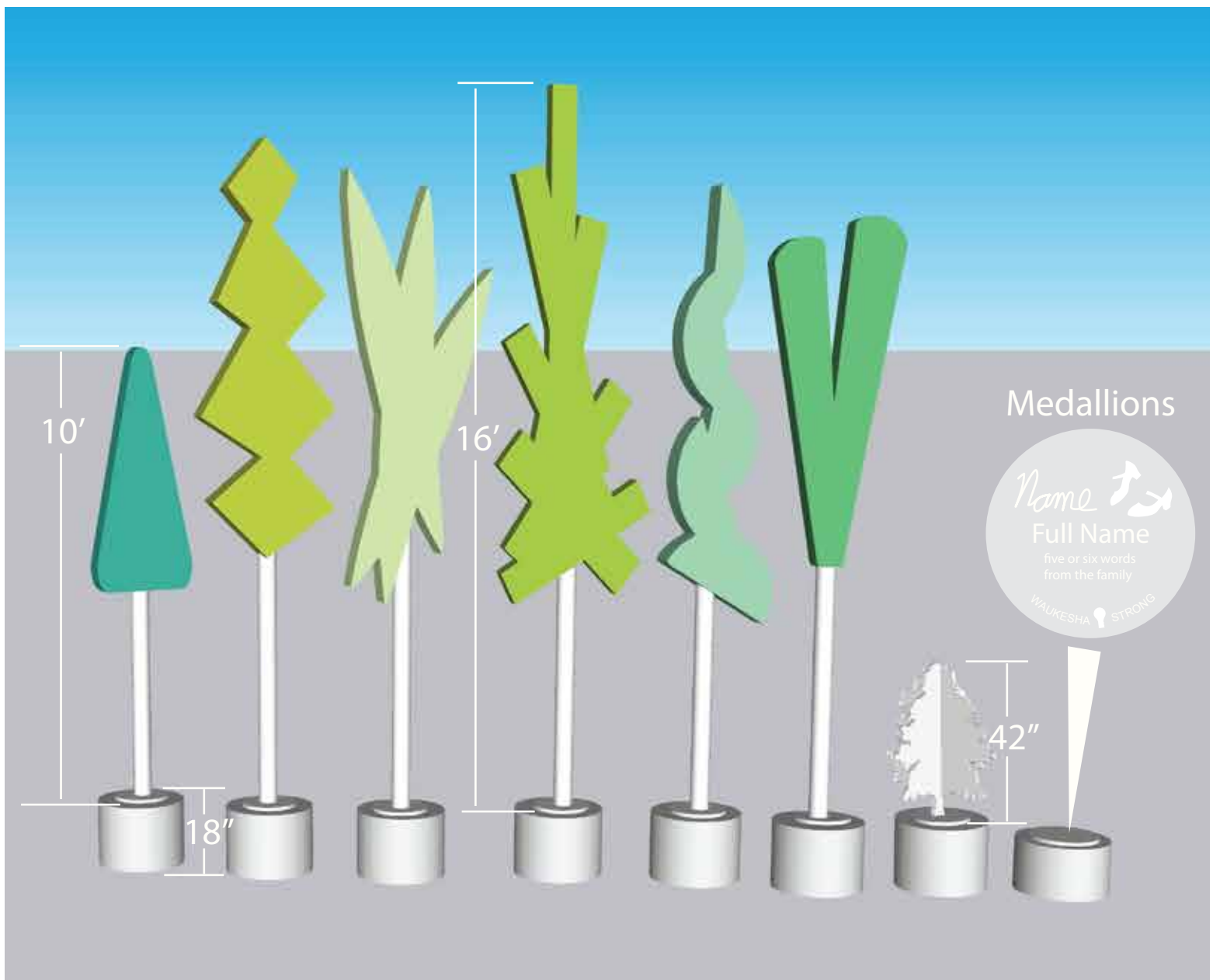

The six abstract tree sculptures would range in height from 10' to 16'. They would be placed atop 18" tall x 24" diameter concrete cylinders. The cylinder would have an angled or chamfered edge to make them comfortable for sitting. (18" is standard seating height).

The 42" tall Message Tree would be placed atop an 18" tall cylinder as shown.

The six Victim Medallions will be placed atop six cylinders varying in height (6", 8", 10", 12", 14", 16"). These will also serve as seating for visitors of all ages.

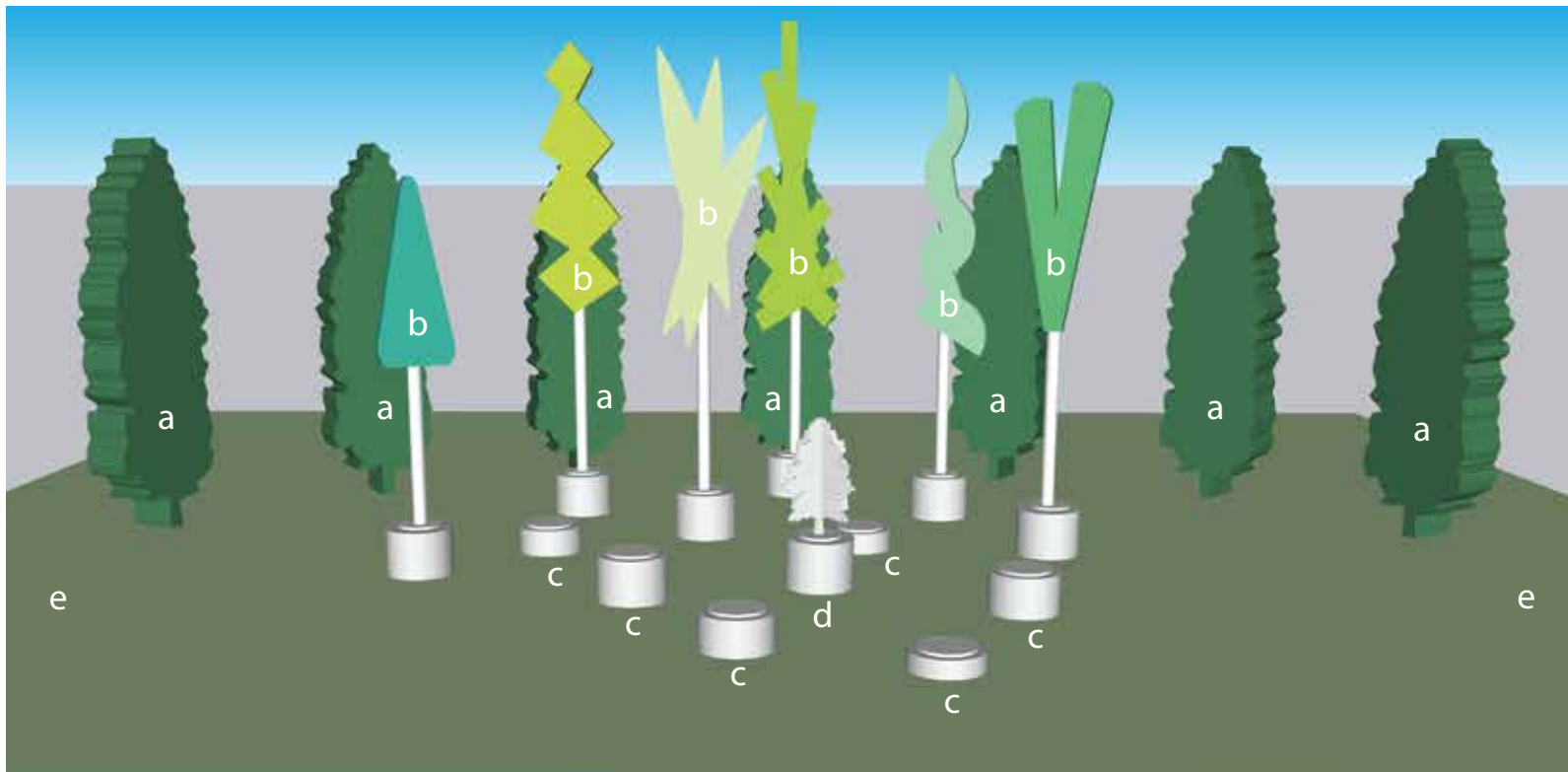

- a - cedar trees (as shown 12' in height) / sound barrier to St. Paul St.
- b - 12' tall - 16' tall tree sculptures atop 18" bases
- c - Victims medallions atop 6" - 16" bases
- d - 42" tall message tree atop 18" base
- e - siting for future additional trees, if added



Victim Medallions

There would be six medallions, each 18" in diameter, made of brushed 1/4" stainless steel. Each of these would be atop its own concrete cylinder. The cylinders would be of different heights, 6", 8", 10", 12", 14" and 16", and would provide seating for visitors of all ages.

The name in script would be from the Victim's first name signature. There would be an appropriate symbol as a memorial to the Victim, and a few words from the family in tribute. I will work with the families to gather the first-name signatures, an appropriate symbol, and words of tribute.

Waukesha Strong and a symbol or one of the 14,000 blue lights frame the bottom of each medallion.



Message Tree

This tree would stand 42" in height and be centrally located in the Memorial. It would be made of two intersecting tree silhouettes of 1/4" thick brushed stainless steel, and stand atop an 18" concrete cylinder.

Each of the two silhouettes would have 1" diameter holes on one side where visitors could roll up messages written on paper and insert them into the holes. They could also leave flowers, ribbons, or other items of honor and tribute to the victims and survivors. Volunteers could periodically remove these tributes to make space for future tributes.

On the other side of the two silhouettes would be space for lettering honoring donors and giving any other information about the Memorial deemed appropriate.



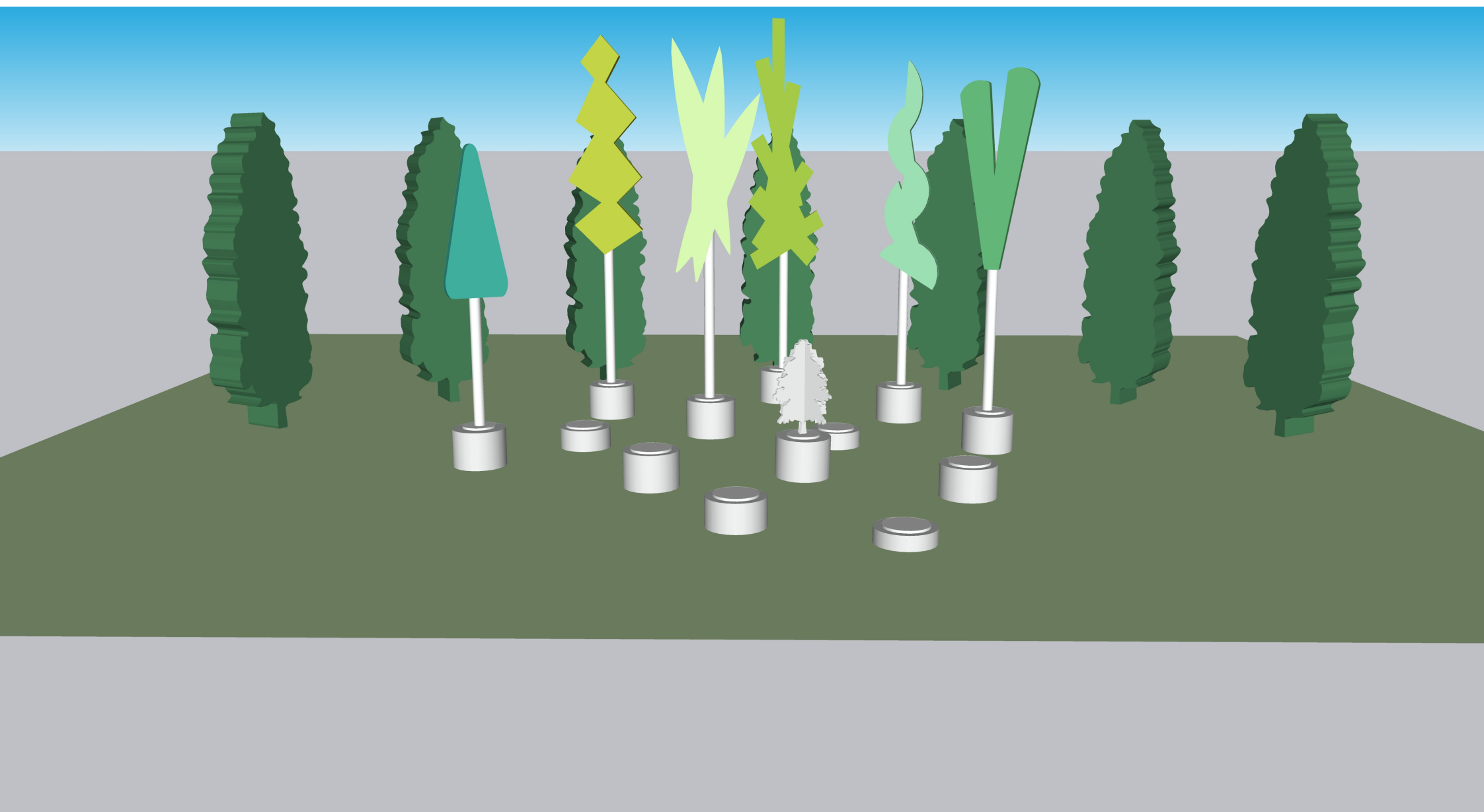







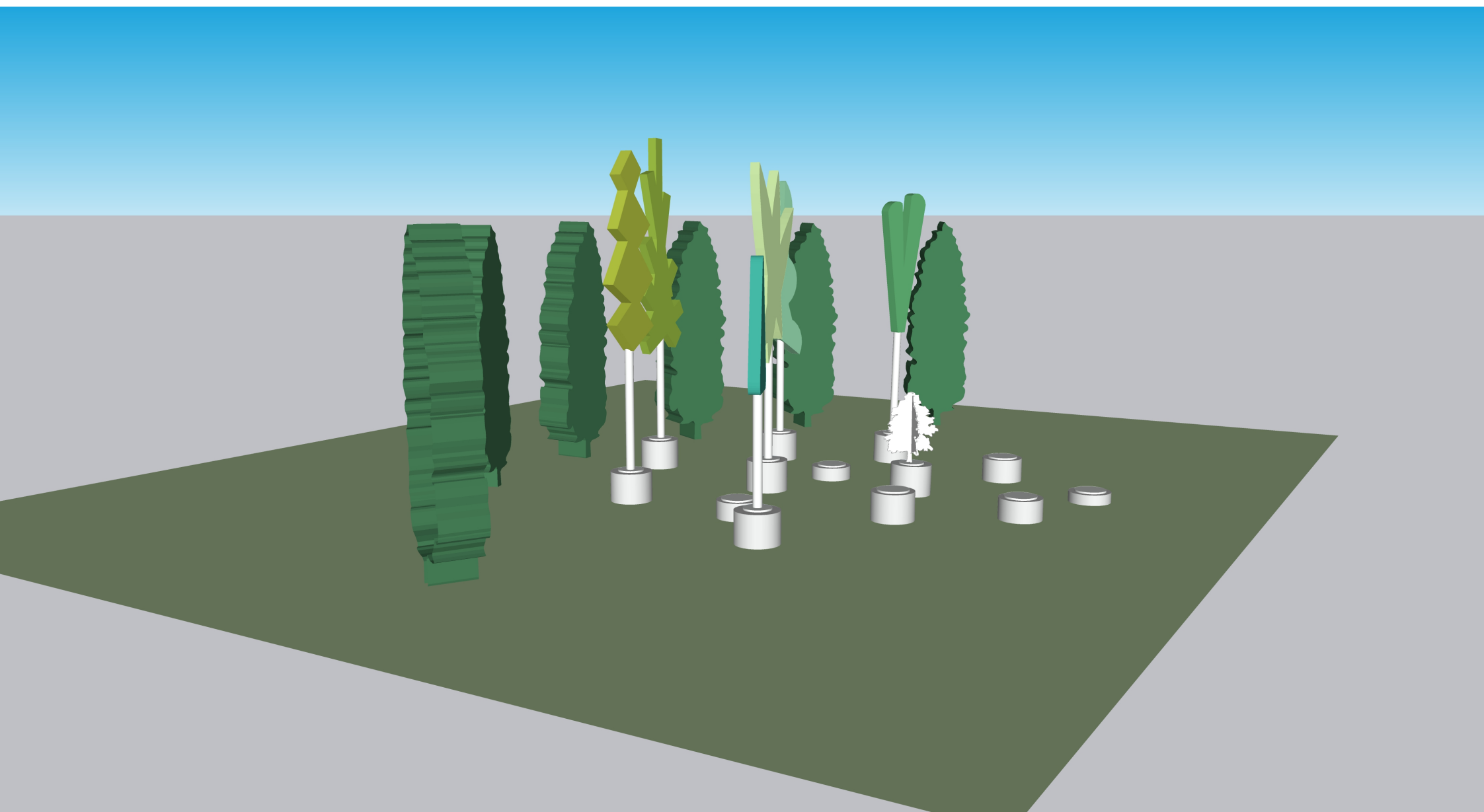



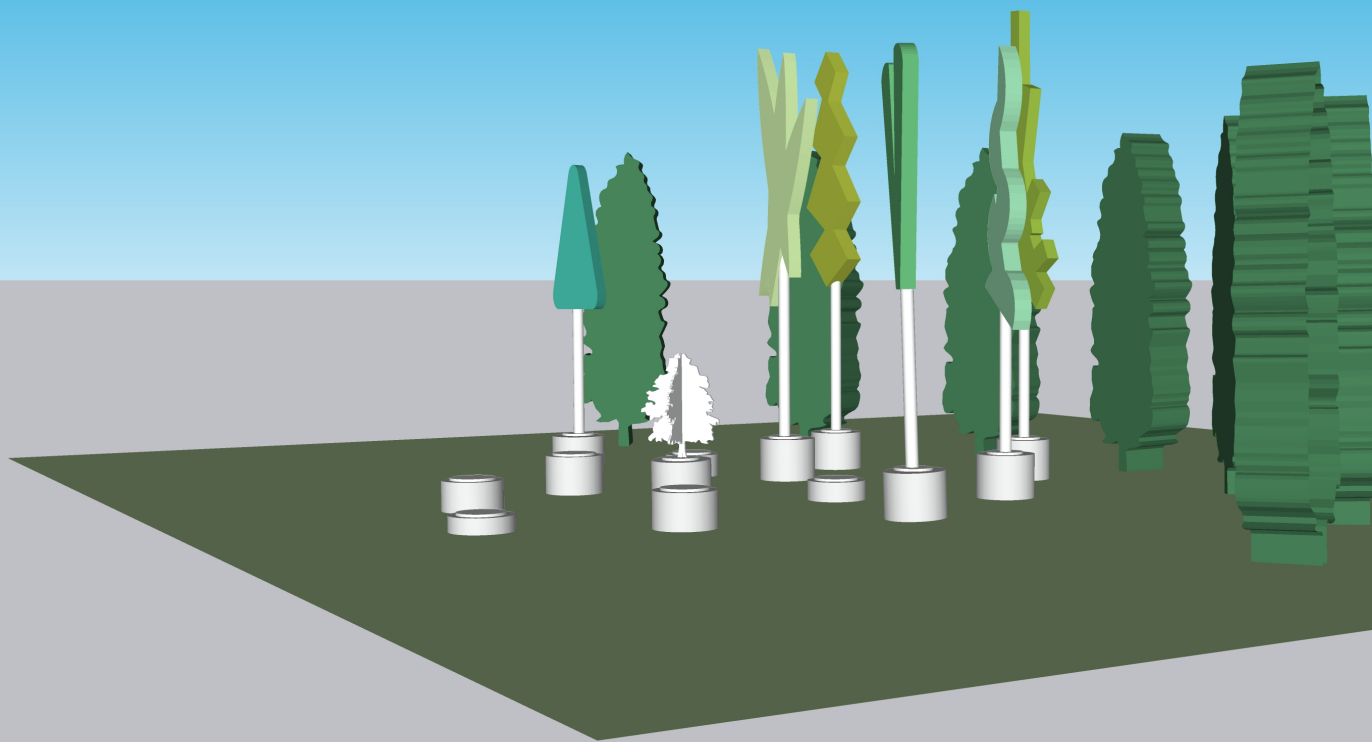



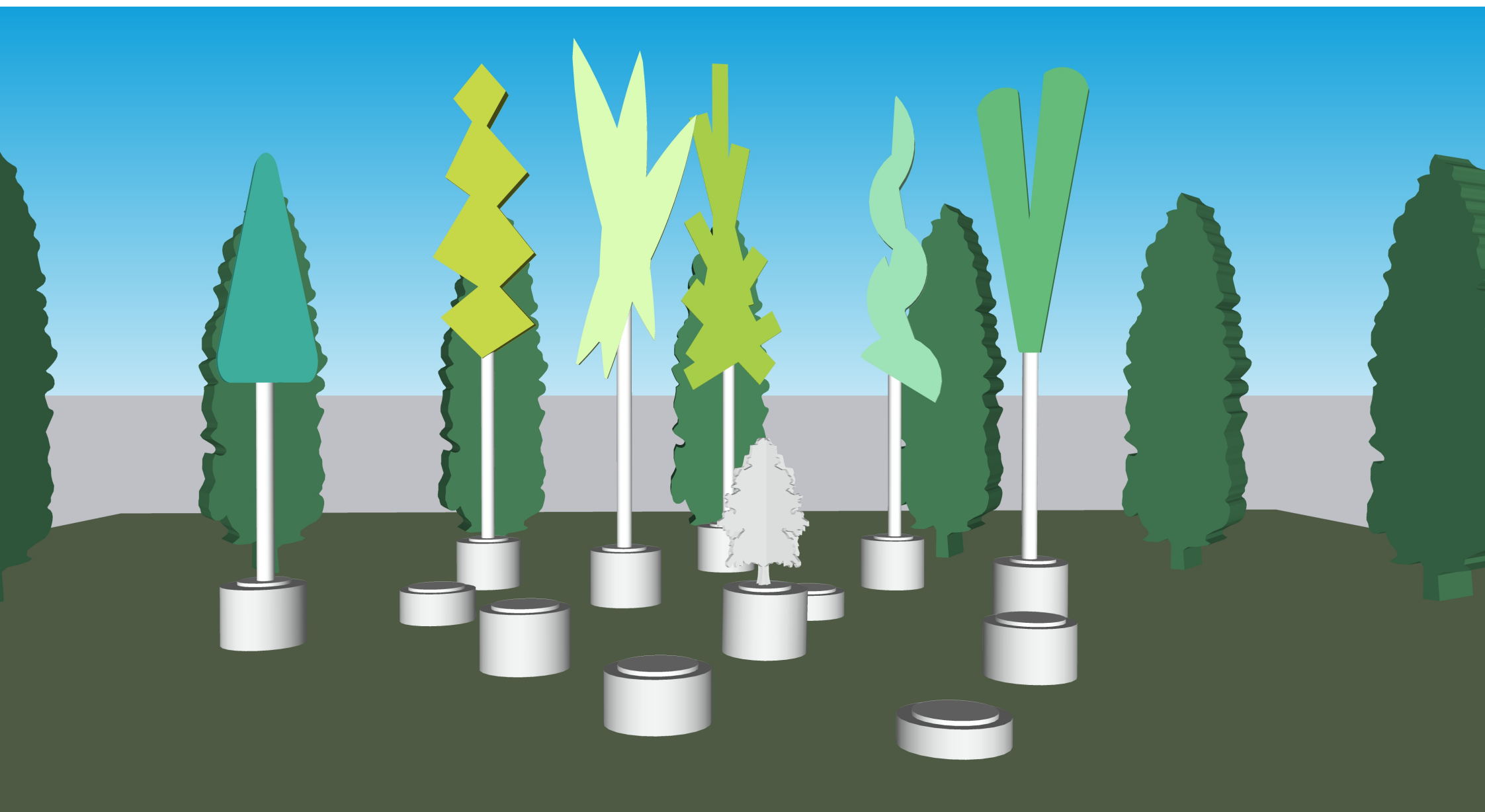

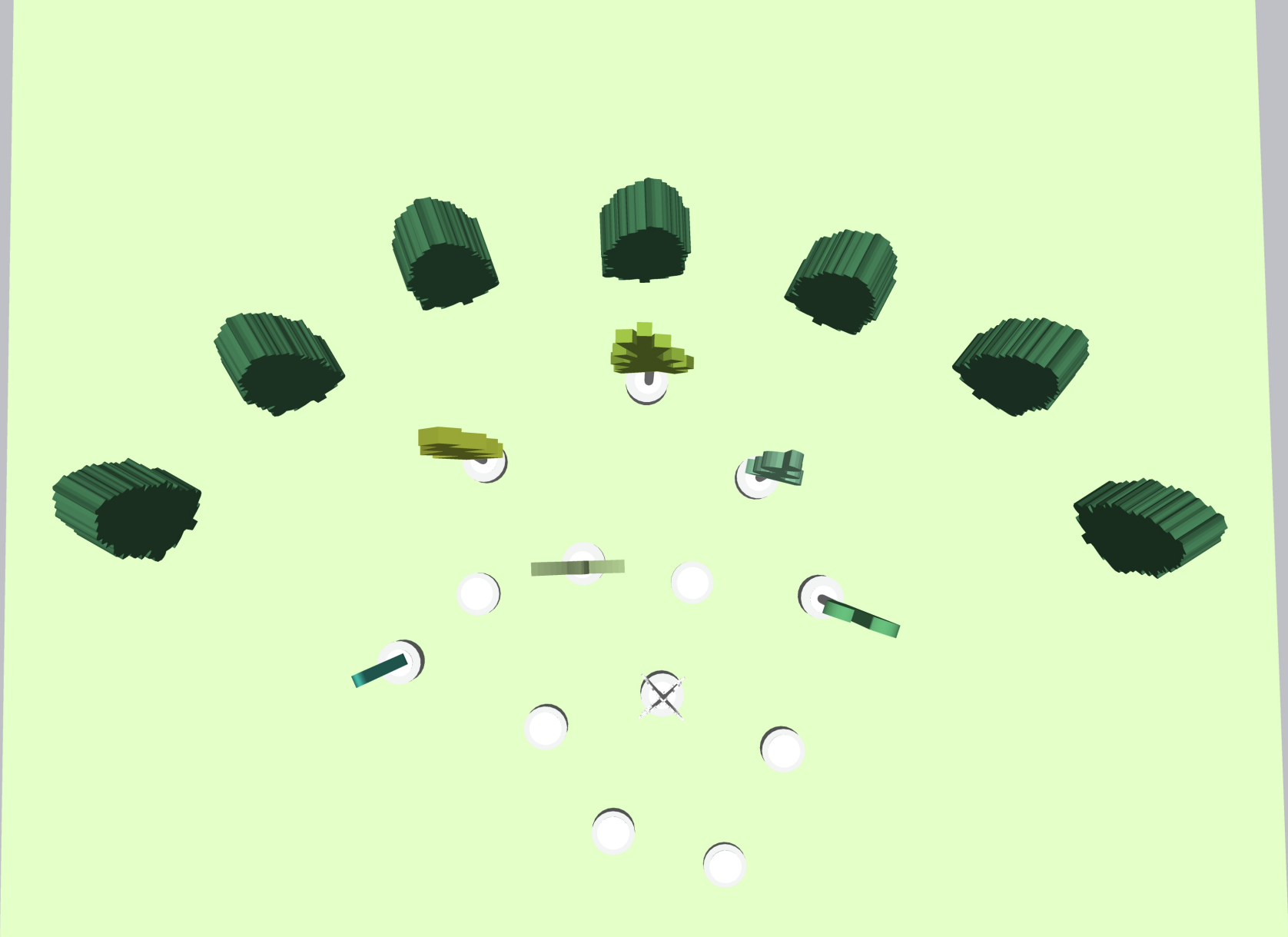



Richard Taylor
2751 N. Stowell Ave.
Milwaukee, WI 53211
414-708-3025
ricorico1031@gmail.com

References:

Robert Peschel
(414) 507-2878
1300 W. Canal Street, Milwaukee, WI 53233
rob.peschel54@gmail.com

Jeff Frank
Artistic Director, First Stage Theater of Milwaukee
325 West Walnut Street | Milwaukee, WI 53212
(414) 267-2981
jfrank@firststage.org

Mary Sharp, MD
Daughter of civil rights worker honored by sculpture at East Lansing, MI, City Hall
sharpmarymd@gmail.com
"Raising Harmony", East Lansing, MI
(517) 290-2676

Ken Leinbach
Director, Urban Ecology Center of Milwaukee
1500 E.
Park Place
Milwaukee,
WI 53211
kleinbach@urbanecologycenter.org
414-964-8505
"Trees", Urban Ecology Center, Milwaukee, WI

Jamie Speaker
President, Speaker Corporation
414-916-2111
speakerj4@aol.com
Flowing Happiness; corporate mobiles, Grafton, WI

Richard Taylor
2751 N. Stowell Avenue, Milwaukee, WI 53211-3773
414-708-3025 phone
ricorico1031@gmail.com • taylorsculpt.com

EDUCATION

1991 MFA, Painting and Drawing, University of Wisconsin, Milwaukee (UWM)
1981-84 Part-time studies, fine arts: San Diego Mesa College; San Diego City College;
University of California at San Diego
1977 BA, Art History, University of Wisconsin-Milwaukee

EMPLOYMENT

1988-Present Self-employed studio artist
2011-14 Adjunct instructor, Milwaukee Institute of Art and Design
1987-99 Artist-in-residence, Quad/Graphics, Pewaukee, WI (part-time)
1976-78 Saxophonist, Jose Martinez Orchestra

EXHIBITIONS

2021
Tory Folliard Gallery, group show
Chicago Sculpture Exhibition
2020
Chicago Sculpture Exhibition
2019
2 person show, Everyday Icons, Carroll University, Waukesha, WI; group show, MARN, Red Line
Gallery, Milwaukee, WI
2018
Tory Folliard Gallery, solo show; Cedarburg Art Museum, 2 person show, Cedarburg, WI; Idea
Gallery, group show, Egg Harbor, WI
2017
Villa Terrace Museum, Milwaukee, WI; 2 person show; Gensler Architects, Chicago, IL; group show;
Tory Folliard Gallery, Milwaukee, WI; group show
2016
Sopa Gallery, Kelowna, Canada; 2 person show; Gallery 224, Port Washington, WI; group show; John
Michael Kohler Art Center, Sheboygan, WI; group show; Tory Folliard Gallery, Milwaukee, WI; 2-
person show
2015
SFMOMA Artists Gallery, San Francisco, CA; 3 person show; Tory Folliard Gallery, Milwaukee, WI;
group show; Moberg Gallery, Des Moines, IA; group show; James Gallery, Pittsburgh, PA; group
show
2014
Sculpturesite Gallery, Sonoma, CA; group show; Tory Folliard Gallery, Milwaukee, WI; group show
Wisconsin Biennial, Museum of Wisconsin Art, group show; Gallery 224, Port Washington, WI; 3
person show
2013
"Out of the Suitcase", MIAD; group show; Coral Gables Museum, group show; Gallery IMA, Seattle,
WA; solo show
2012
Joseph Gierke Fine Art, Tulsa, OK; group show; Gallery IMA, Seattle, WA; group show; Paine
Museum of Art, Oshkosh, WI; 2 person show; Miller Art Center, Sturgeon Bay, WI; Focus on Color,
group show; Cardinal Stritch University, Glendale, WI; group show; University of Wisconsin,
Milwaukee; Continuum 2012, group show
2011
OK Harris Works of Art, New York, NY; solo show; Gallery IMA, Seattle, WA; group show; Tory
Folliard Gallery, Milwaukee, WI; group show; Art in Public Places Sculpture Exhibition; Stamford, CT
2010
KH Gallery, Chicago, IL; 2 person show; Tory Folliard Gallery, Milwaukee, WI; group show
2009

University of New England - Portland Campus; group show; Tory Folliard Gallery, Milwaukee, WI; "Off the Wall", solo show; Moberg Gallery, Des Moines, IA; Group show, Works on Paper; Walkers Point Center for the Arts, Group Show, Milwaukee, WI

2008

SOPA Gallery, Kelowna, BC, Canada; 3 person show; Tory Folliard Gallery, Milwaukee, Anniversary Show; group show; Circa Gallery, Minneapolis, MN, 2-person show; Wisconsin Museum of Art, West Bend, WI; solo show

2007

OK Harris Works of Art, New York, NY, solo show; Tory Folliard Gallery, Milwaukee, WI; 2 person show; MIAD (Milwaukee Institute of Art & Design), group show

2006

Kajima Sculpture Awards Exhibition, Tokyo, Japan; group show; Fresh Paint, Los Angeles, California; group show; Mary Bell Gallery, Chicago, IL; 2-person show; Continuum 5; Univ. of Wisconsin, Milwaukee, Inova, group show

2005

Paint on Metal, Tucson Art Museum, group show; Cardinal Stritch University, Glendale, WI; solo show; Lakeland College, Sheboygan, WI; solo show; Luckystar Gallery, Milwaukee, WI; group show

2004

Noyes Cultural Arts Center, Evanston, IL; group show; Waukesha Civic Theater, Waukesha, WI; 2-person show; Robert Kidd Gallery, Birmingham, MI, group show; 3rd Ward Sculpture Exhibition, Milwaukee, WI

2003

Sylvia Schmidt Gallery, New Orleans, group show; West Bend Art Museum, WI; group show; Wisconsin Presents, Wisconsin Lutheran College, group show; Gingrass Gallery, Milwaukee, WI, group show

2002

OK Harris Works of Art, NY, NY, solo show; Mad River, San Francisco, group show; Ira Pinto Gallery, Washington DC, group show; Navy Pier Sculpture Exhibition, Chicago, IL, curated by Dave Hickey

2001

Andrea Schwartz Gallery, San Francisco, CA, group show; Mary Bell Gallery, Chicago, group show; Europa Gallery, Hannover, Germany, group show; Nortel Networks Gallery, Santa Clara, CA, solo show; West Bend Art Museum, West Bend, WI, featured outdoor sculpture

2000

Pier Walk 2000 Sculpture Exhibition, Chicago, IL; Mary Bell Gallery, Chicago, IL, group show ; Woodlot Gallery, Sheboygan, WI, group show

1999

DeLind Gallery, Milwaukee, WI, group show

1998

Beyond the Object: Public Art, Milwaukee Institute of Art and Design

1994-96

Peltz Gallery, Milwaukee, WI, group show

1992

La Galleria Del Conte, Milwaukee, WI, group show

1991

Master's Thesis Show, University of Wisconsin-Milwaukee

1989

Aristoi Gallery, Milwaukee, WI, solo show

1988

UWM Union Gallery, Milwaukee, WI, "Really Big Shoe"

1983-84

San Diego Art Institute, group show

COMMISSIONS

Disney University, Orlando, FL

Milwaukee Road Monument, Menomonee Valley, Milwaukee, WI

550 Washington Building, Chicago, IL

All Saints Hospital, Racine, WI

Allen Bradley Corp., Milwaukee, WI

Children's Hospital, Milwaukee, WI

Curative Rehabilitation, Milwaukee, WI
Flad Architects, Madison, WI
Froedtert Memorial Lutheran Hospital, Milwaukee, WI
General Electric Medical Systems, Pewaukee, WI
Guaranty Bank, Milwaukee, WI
SC Johnson Co., Racine, WI
Kaiser Hospitals, CA
Marnell Corrao, Shreveport, LA
Mayo Clinic, Rochester, MN
Medical College of Wisconsin, Milwaukee, WI
Meijer
Milwaukee Public Central Library
Quad/Graphics, Pewaukee, WI; Sussex, WI; Lomira, WI; The Rock, GA; Saratoga Springs, NY
Rockwell International, Milwaukee, WI
Ruud Lighting, Racine, WI
St. Lukes Hospital, Milwaukee, WI
Santa Clara Valley Medical Center, Santa Clara, CA
Sutter Gould Medical Foundation, Modesto, CA
Valley Center Hospital, Santa Clara, CA

COLLECTIONS

Courtney B Vance and Angela Bassett, CA
Federal Reserve Bank of Chicago
Nieman Marcus
SPX Corporation
Visa
General Electric Medical Systems
Quad/Graphics
Rockwell International
Southwestern Illinois College, Belleville, IL
Koehler Winery, Santa Barbara, CA
Hewlett-Packard

PUBLIC ART PROJECTS / COMMISSIONS

City of Waukesha, WI
City of Beaverton, OR
City of East Lansing, MI
City of Skokie, IL
City of Dowagiac, MI
City of Wauwatosa, WI
City of Mount Vernon, IL
City of Green Bay, WI / Northeastern Wisconsin Arts Council
City of Waukesha, WI; Transit Center
City of Atlanta, GA; Fire Station
City of Beaverton, OR; City Park
University of Wisconsin, Parkside
University of Wisconsin, Whitewater
General Mitchell International Airport, Milwaukee, WI
State of Louisiana, LaSalle Building, Baton Rouge, LA

PUBLICATIONS

"Paint on Metal", Tucson Museum of Art, 2005
"Navy Pier Walk", Chicago Navy Pier Sculpture Exhibition, 2002

AWARDS

Artist of the Year, 2011; Milwaukee Arts Board
Louis Weinberg Sculpture Competition Winner, Skokie Sculpture Park, Skokie, IL; 2011
Semi-finalist, Kajima Sculpture Competition, Tokyo, Japan 2005

ART DONATED FOR GOOD CAUSES
Alzheimers Fund, Milwaukee, WI
SRAM Bikes for Africa, New York, NY
AIDS Auction Milwaukee
Art Pop, Art for AIDS, Milwaukee, WI

Richard Taylor - Public Art Commissions



People of the Road; 2019; City of Milwaukee and Friends of Hank Aaron State Trail; public art commission; 14' x 6' x 6' (5 sculptures); corten steel



Climbing Arc; 2017; City of Grafton, WI; 14' x 5' x 5'; aluminum, Imron paint



Abundant Happiness; 2016; City of Dowagiac, MI; public art purchase; 14' x 6' x 7'; aluminum, Imron paint

Richard Taylor - Public Art Commissions



Raising Harmony; 2015; City of East Lansing, MI;
public art commission; 15' x 7' x 7'; aluminum, Imron paint



Blue Sky Between Footsteps; 2014; General Mitchell
International Airport, Milwaukee, WI; public art commission;
10' x 14' x 3' (2 suspended sculptures + wall applications);
aluminum, powder coat



The Singing Sky; 2013; City of Beaverton, OR;
City Park; public art commission; 18' x 7' x 7';
aluminum, Imron paint

Richard Taylor - Public Art Commissions



My House of Feather and Stone; 2013; City of Green Bay, WI /
Northeastern Wisconsin Arts Council; public art commission;
14' x 6' x 6'; aluminum, Imron paint;



The River Sings; 2012; City of Atlanta, GA;
public art commission; 14' x 7' x 6'; aluminum, Imron paint



A Beam of Sun to Shake the Sky; 2003; Milwaukee Central Library;
14' x 5' x 6' (2 sculptures); aluminum, Imron paint, gold leaf, lighting



Life's Ribbon; 2007; City of Waukesha, WI Transit Center;
public art commission; 14' x 6' x 6' (2 sculptures)
aluminum, Imron paint;