

PROPOSED BUILDING PLAN AND
SPACE UTILIZATION

SHEET TITLE

PROPOSED ADDITION AND REMODELING:
HUSCO INTERNATIONAL INC.
2239 PEWAUKEE ROAD
CITY OF WAUKESHA, WI 53188

DRAWN: 2/22/20
CHECKED: PS/DJ/AM
DATE: 04/24/2017
SHEET: 1

PROGRAMMING
SCOPE AND
BUILDING PLAN

1 OVERALL MAIN LEVEL FLOOR PLAN
Scale: 1"=30'-0"

2 2ND LEVEL PLAN - EAST
Scale: 1"=30'-0"

3 BSMI. LEVEL PLAN - SOUTHWEST
Scale: 1"=30'-0"

4 2ND LEVEL PLAN - WEST
Scale: 1"=30'-0"

5 BSMI. LEVEL PLAN - NORTHWEST
Scale: 1"=30'-0"

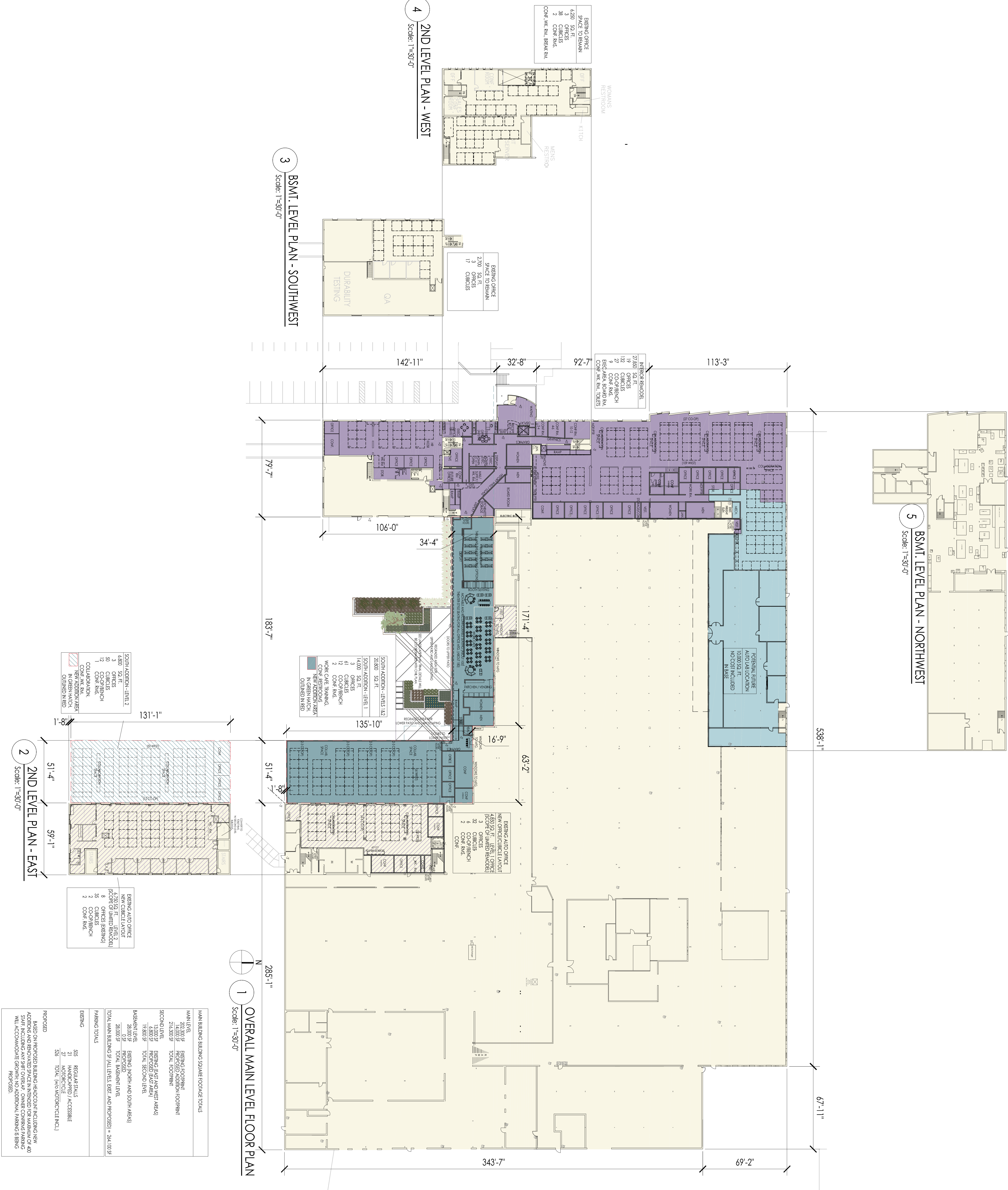

MAIN BUILDING BUILDING SQUARE FOOTAGE TOTALS

MAIN LEVEL	
202,200 SF	EXISTING FOOTPRINT
214,300 SF	PROPOSED FOOTPRINT
214,300 SF	TOTAL FOOTPRINT
SECOND LEVEL	
12,000 SF	EXISTING (EAST AND WEST AREAS)
6,800 SF	PROPOSED (EAST AREA)
19,800 SF	TOTAL SECOND LEVEL
BASEMENT LEVEL	
28,000 SF	EXISTING (NORTH AND SOUTH AREAS)
0 SF	PROPOSED
28,000 SF	TOTAL BASEMENT LEVEL
TOTAL MAIN BUILDING SF (ALL LEVELS, EXIST + PROPOSED) = 744,100 SF	
PARKING TOTALS	