

## CITY OF WAUKESHA, WISCONSIN

201 DELAFIELD STREET \* ROOM 200 \* WAUKESHA, WI 53188 \* PH: (262)524-3750 \* FAX: (262)524-3751

PERMIT NUMBER

## PERMANENT SIGN PERMIT APPLICATION

ONE APPLICATION PER SIGN

SITE ADDRESS: 421 S Grand AveTotal Number of signs applying for today: 1 Value of Sign(s) \$ 750.00FEE: \$40 min. or \$1 per sq. ft. Required in full at time of submittal. FEE IS NON-REFUNDABLE.

Location of THIS sign: \_\_\_\_\_

## Office Use Only

☐ PICTURE/Drawing/Site Plan☐ FEE☐ ELECTRICAL PERMIT

Paid: \_\_\_\_\_ Initials: \_\_\_\_\_

Permit copy will be mailed to this address

Business Name: Restaurante Casa NobleOwner Name: Nory FloresBusiness Phone: (414)-651-0006For questions call: ☐ Business ☒ Sign ContractorSign Contractor: Fastsigns of WaukeshaAddress: 1560 E. Moreland Blvd Ste FCity/State/Zip: Waukesha WI 53186Phone: 262-288-1199

IF THIS IS AREA IS LEFT EMPTY, PERMIT WILL NOT BE MAILED.

(MANDATORY FIELD; application will be returned if left blank.)

You must submit an electrical permit signed by a licensed electrician with all illuminated sign permit applications.

HAS THIS BEEN DONE? ☐ YES, Permit No. BL - - ☐ NO ☒ NOT APPLICABLE

ATTACH A COLOR PHOTO, DRAWING, AND/OR SITE PLAN. Show dimensions to scale, colors, and location of sign.

## CHECK ONE:

☐ New Sign ☐ Existing Sign ☒ Face Change Only

## TYPE OF SIGN (Circle all that apply):

☒ Wall ☐ Door ☐ Projecting ☐ Window ☐ Roof ☐ Billboard  
☐ Flat ☐ Awning ☐ Freestanding ☐ Yard ☐ Double FaceHorizontal Width of Sign 12' Vertical dimension of Sign 2'7" TOTAL Square Footage: 31 sq. ft.

If Sign is detached or projecting, please supply: Total Height \_\_\_\_\_ Clearance: \_\_\_\_\_ Setback: \_\_\_\_\_

Premise Data: Street Frontage: 46' Building or Tenant Space Width: 35' Other Street Frontage: 129.5'

## PLEASE LIST ALL EXISTING SIGNAGE ON THE BACK OF THIS SHEET.

By my signature, I state and agree, that I have carefully examined the completed application and do hereby certify that all information herein is true and correct, and I further certify that any and all work performed shall be done in accordance with the Ordinances of the City of Waukesha, and the Laws of the State of Wisconsin pertaining to the work described herein

Legal Signature Andrew Dominian Print Name ANDREW DOMINIAN Date 6/14/18

## OFFICE USE ONLY

Zoning District: B1 Gross sign area for premises: \_\_\_\_\_ Area used by other signs: \_\_\_\_\_☐ Approved Conditions (if any):☐ Must submit electrical permit within 30 days of meeting or permit shall be voided.☐ Denied Does not conform to:☐ Height ☐ Architecturally compatible ☐ Not to face R-district ☐ Clearance ☐ Area ☐ Corner Vision  
☐ Projection ☐ Avoid needless elaboration ☐ Consolidation of signs ☐ Distracting sign ☐ Setback ☐ Other

Authorized Signature \_\_\_\_\_

Date of Review \_\_\_\_\_

INCOMPLETE APPLICATIONS MAY NOT BE PROCESSED.

Review Board meets the 3<sup>rd</sup> Monday of the month at 8:15 am. DEADLINE IS THE MONDAY BEFORE THE MEETING.



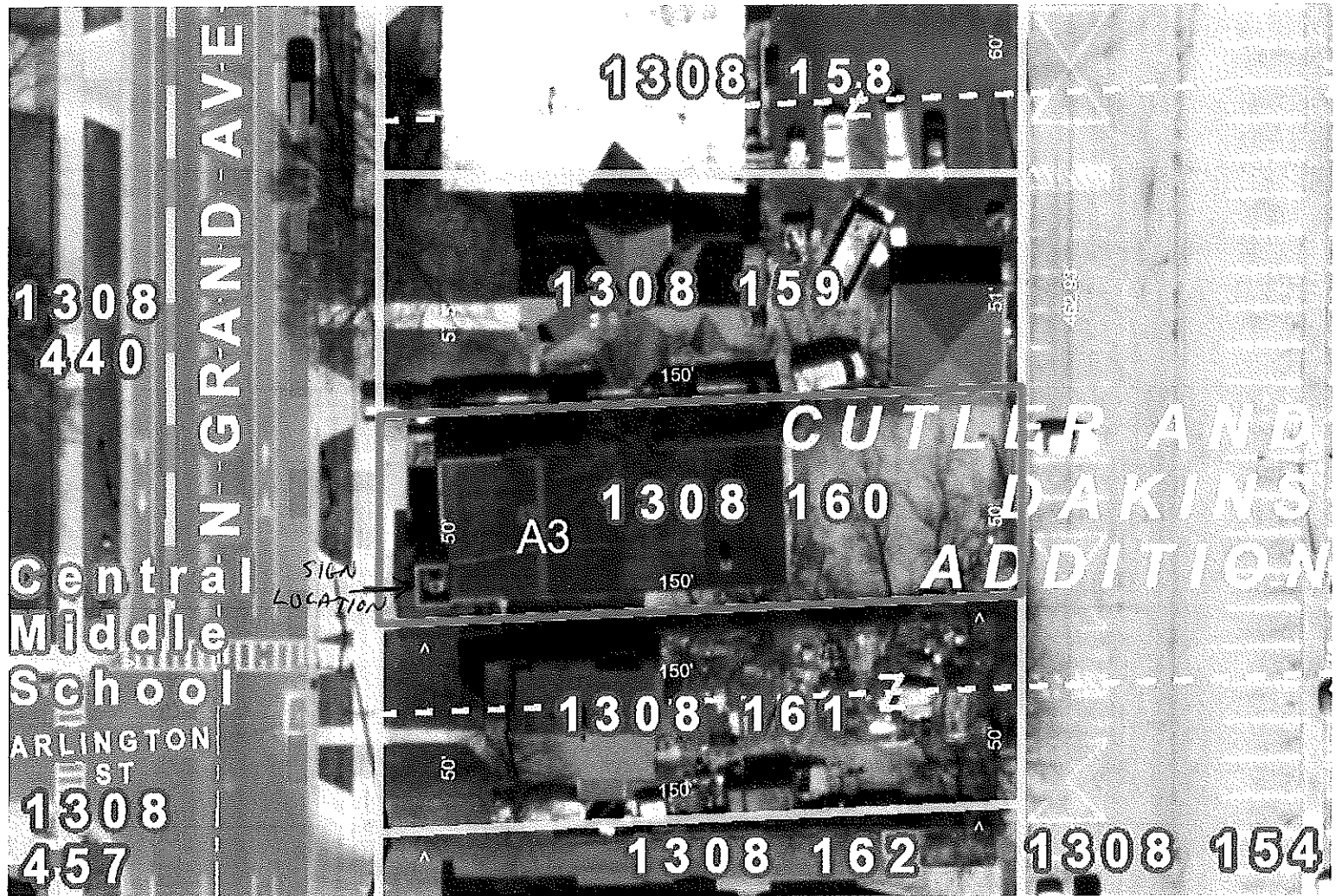

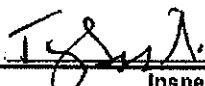
PERMIT NO: E_ELC18-00011 ON-LINE PERMIT			
<b>WAUKESHA</b> 201 Delafield St # E, WI 53188		<b>PERMIT TYPE</b> ETRAKIT ELECTRICAL COMMERCIAL	<b>APPLIED DATE</b> 6/14/2018
<b>INSPECTION REQUEST LINE</b> (262) 524-3530 OR <b>REQUEST INSPECTION</b> ON-LINE THROUGH eTRAKIT <a href="https://permits.waukesha-wi.gov/etrakit/">https://permits.waukesha-wi.gov/etrakit/</a>		<b>PERMIT SUB-TYPE</b>	<b>APPROVED DATE</b>
		<b>JOB VALUE</b> 890	<b>ISSUED DATE</b>
		<b>APN</b> 134955	
		<b>DESCRIPTION</b> Wiring sign outside front of building	
<b>PERMIT INFORMATION</b>		<b>FEE SUMMARY</b>	
<b>SITE</b>	403 N GRAND AVE WAUKESHA, WI 53186	<b>ELECTRICAL - APPLIANCES, HVAC, MOTORS, EXT LIGHTING</b>	\$0.00
<b>APPLICANT</b>	Pieper Electric Inc 5477 Westridge Ct New Berlin WI 53151	<b>ELECTRICAL - SERVICES, OUTLETS, SIGNALING, FIXTURES</b>	\$1.00
<b>OWNER</b>	JAH PROPERTIES LLC W1672 COUNTY RD F SULLIVAN WI 53178	<b>ELECTRICAL PERMIT MINIMUM</b>	\$59.00
<b>CONTRACTOR</b>	Pieper Electric Inc 5477 Westridge Ct New Berlin WI 53151	<b>Total Fees Collected:</b>	\$60.00
<small>NOTE: This job copy of this permit shall be kept on the job site to make the required entries thereon. The permit will expire if work is not started in 180 days, is abandoned, or does not receive an inspection for more than 180 days. Additional fees will be collected to renew expired permits. This is a Building Permit when properly filled out, signed and validated, and is not transferable.</small>			
<p>The undersigned hereby applies for a permit to do work herein described according to the plans and specifications filed herewith. The undersigned agrees that such work will be done in accordance with the said descriptions, plans and specifications in compliance with the building, zoning and health ordinances and all other ordinances of the City of Waukesha and with all laws and orders of the state of Wisconsin applicable to said premises.</p> <p>The undersigned further applies for a permit to occupy the premises described herein for the uses and purposes as herein set forth and in strict accordance with all the provisions of the City of Waukesha zoning and health ordinances and all other ordinances of the City of Waukesha and State of Wisconsin applicable to said premises.</p> <p>This permit is in effect for 18 months from date of issue unless work is not started within 120 days of issue date, or activity ceases for more than 120 days, after which this permit shall lapse. Double fees shall be charged if work is started before permit is issued. Work covered before inspection will be required to be totally exposed for inspection.</p>		<b>INSPECTION SUMMARY</b>	
SIGNATURE OF APPLICANT OR AGENT: 		DATE: 6-14-18	
<b>Permit Finaled Date:</b>		<b>Inspector Name:</b>	
		<b>Signature:</b>	