

CITY OF WAUKESHA, WISCONSIN
201 DELAFIELD STREET * ROOM 200 * WAUKESHA, WI 53188 * PH: (262)524-3750 * FAX: (262)524-3751

PERMIT NUMBER

PERMANENT SIGN PERMIT APPLICATION
ONE APPLICATION PER SIGN

SITE ADDRESS : 2140 W St. Paul Ave

Total Number of signs applying for today: 3 Value of Sign(s) \$
FEE: \$40 min. or \$1 per sq. ft. Required in full at time of submittal. FEE IS NON-REFUNDABLE.

Location of THIS sign: 2140 W St. Paul Ave

Office Use Only

☐ PICTURE/Drawing/Site Plan

☐ FEE

☐ ELECTRICAL PERMIT

Paid: Initials:

Business Name: Aldi Foods

Owner Name: Aldi Inc.

Business Phone: 414-570-1860

For questions call: ☐ Business ☒ Sign Contractor

Sign Contractor: Doyle Signs, Inc

Address: 232 W Interstate Road

City/State/Zip: Addison, IL 60101

Phone: 630-543-9490

IF THIS IS AREA IS LEFT EMPTY, PERMIT WILL NOT BE MAILED.

(MANDATORY FIELD; application will be returned if left blank.)
You must submit an electrical permit signed by a licensed electrician with all illuminated sign permit applications.
HAS THIS BEEN DONE? ☐ YES, Permit No. BL - - ☐ NO ☐ NOT APPLICABLE

ATTACH A COLOR PHOTO, DRAWING, AND/OR SITE PLAN. Show dimensions to scale, colors, and location of sign.

CHECK ONE:
☐ New Sign ☒ Existing Sign ☒ Face Change Only

TYPE OF SIGN (Circle all that apply):
Wall Door Projecting Window Roof Billboard
Flat Awning **Freestanding** Yard **Double Face**

Horizontal Width of Sign 24' Vertical dimension of Sign 6' TOTAL Square Footage: 144 sq. ft.

If Sign is detached or projecting, please supply: Total Height 25 Clearance: 12.5 Setback: existing

Premise Data: Street Frontage: Building or Tenant Space Width: 100' Other Street Frontage:

PLEASE LIST ALL EXISTING SIGNAGE ON THE BACK OF THIS SHEET.

By my signature, I state and agree, that I have carefully examined the completed application and do hereby certify that all information herein is true and correct, and I further certify that any and all work performed shall be done in accordance with the Ordinances of the City of Waukesha, and the Laws of the State of Wisconsin pertaining to the work described herein

Legal Signature Print Name Lisa Neal (agent) Date

OFFICE USE ONLY

Zoning District: Gross sign area for premises: Area used by other signs:

☐ Approved Conditions (if any):
☐ Must submit electrical permit within 30 days of meeting or permit shall be voided.

☐ Denied Does not conform to:

☐ Height☐ Projection

☐ Architecturally compatible☐ Avoid needless elaboration

☐ Not to face R-district☐ Consolidation of signs

☐ Clearance☐ Distracting sign

☐ Area☐ Setback

☐ Corner Vision☐ Other

Authorized Signature Date of Review

INCOMPLETE APPLICATIONS MAY NOT BE PROCESSED.

Review Board meets the 3rd Monday of the month at 8:15 am. DEADLINE IS THE MONDAY BEFORE THE MEETING.

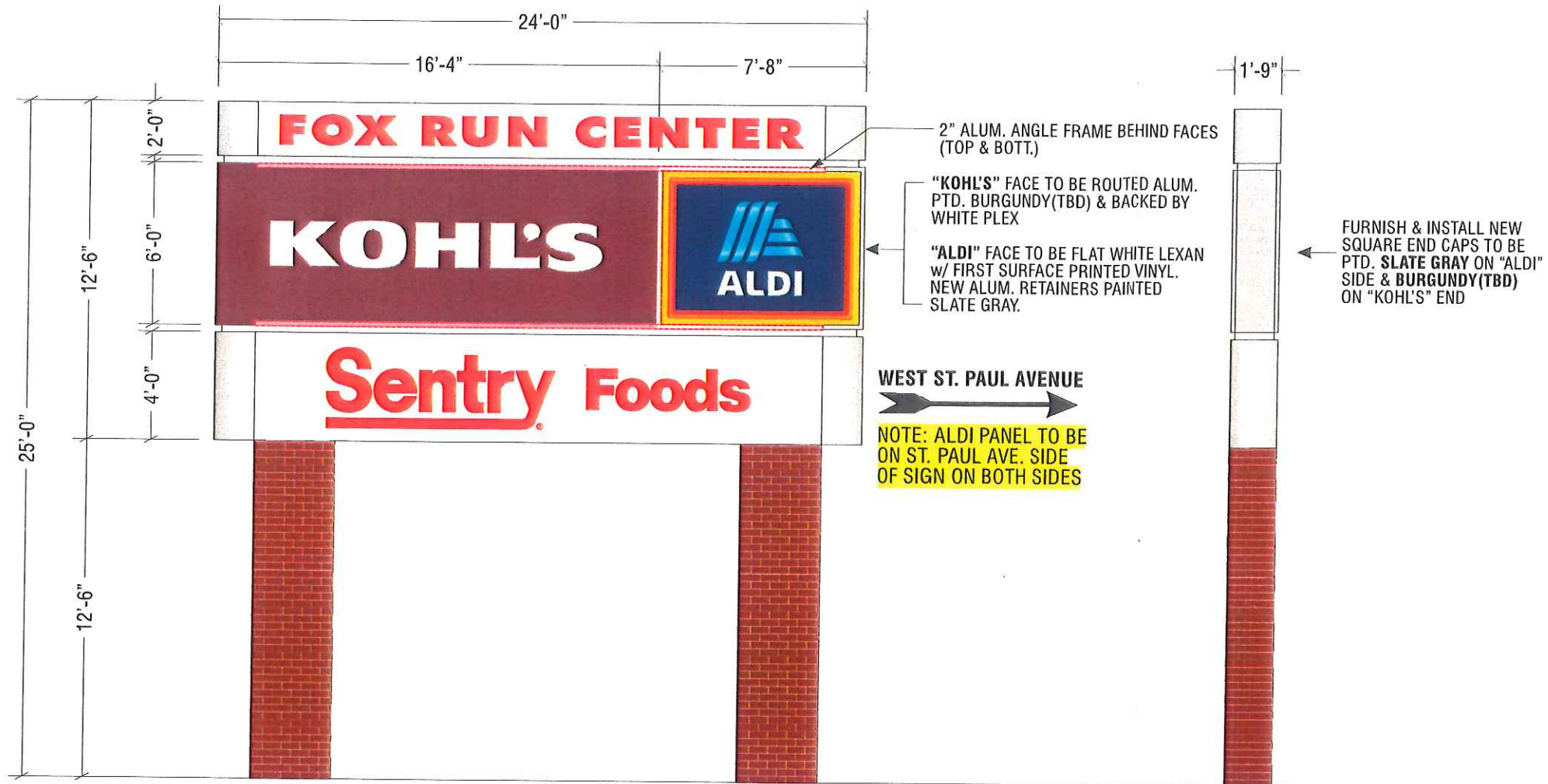

B NEW REPLACEMENT FACES & SQUARE END CAPS
SCALE: 3/16" = 1'

- EXISTING FACES WELDED TO 2" ANGLE FRAME TO BE CUT OUT
- NEW FACES TO BE SCREWED INTO EXISTING 2" ALUM. ANGLE FRAME

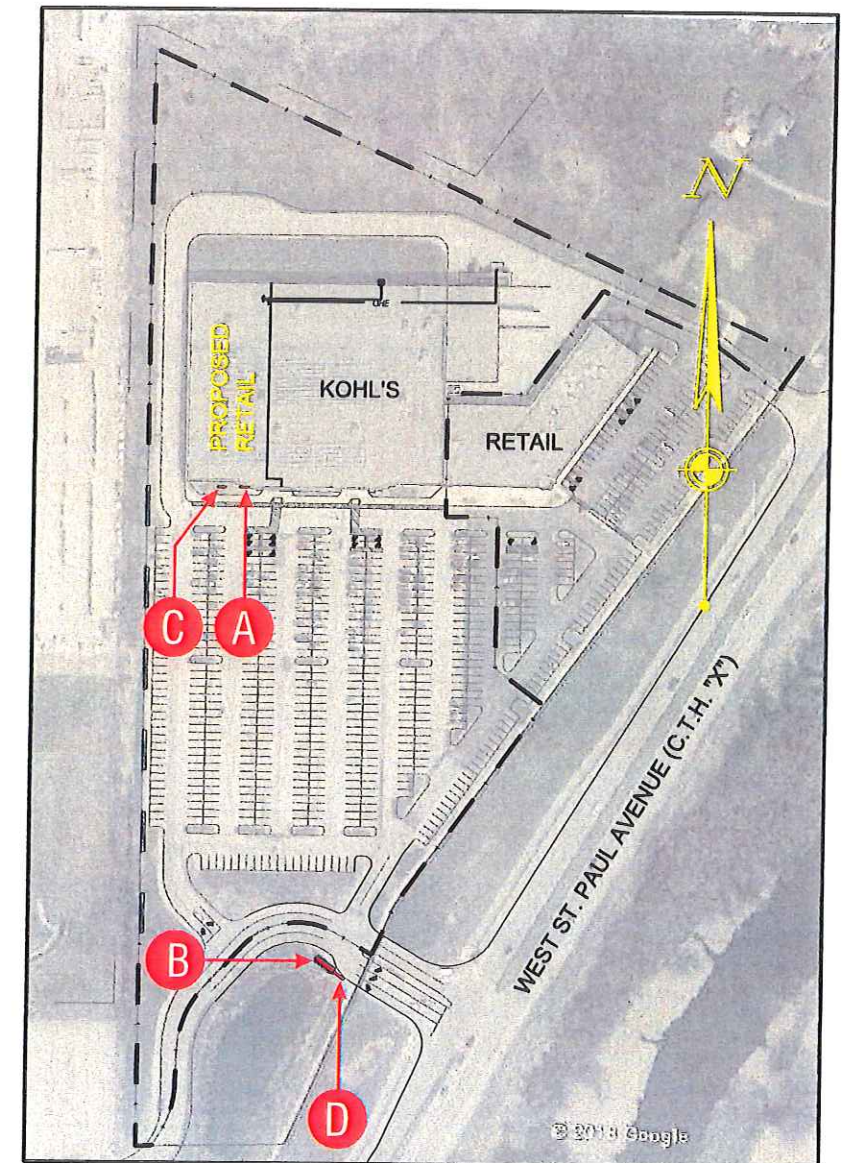

SITE MAP
N.T.S.



DATE	REVISION
5.11.18	ADD ALT. PYLON/MONUMENT OPTIONS
6.15.18	REMOVED NEW PYLON/MONUMENT OPTIONS & NEW PYLON FACE OPTIONS
7.18.18	ADDED TWO NEW ALT. PYLON FACE OPTIONS
7.19.18	REVISED ALDI PANEL LOCATION
8.20.18	ADDED SURVEY INFO & BANNER
8.20.18	ADDED 4x8 ROAD SIGN & STOREFRONT DIMENSIONS

CUSTOMER APPROVAL _____ **DATE** _____

This design is the original and unpublished work of DOYLE SIGNS, INC. and may not be reproduced, copied or exhibited in any fashion without the expressed written consent from an authorized officer of The Company. The rights to this design may be purchased.

CLIENT **ALDI**

ADDRESS WAUKESHA, WI.
WAUKESHA COUNTY

DESIGNER	DF	SALES	TD
SCALE:	NOTED	DATE:	3-15-18
DRWG. No.	# 16551	SHEET No.	2 of 3

Z:\Design\A\ALDI\W\WAUKESHA, WI\ALDI Waukesha, WI 8-20-18.cdr

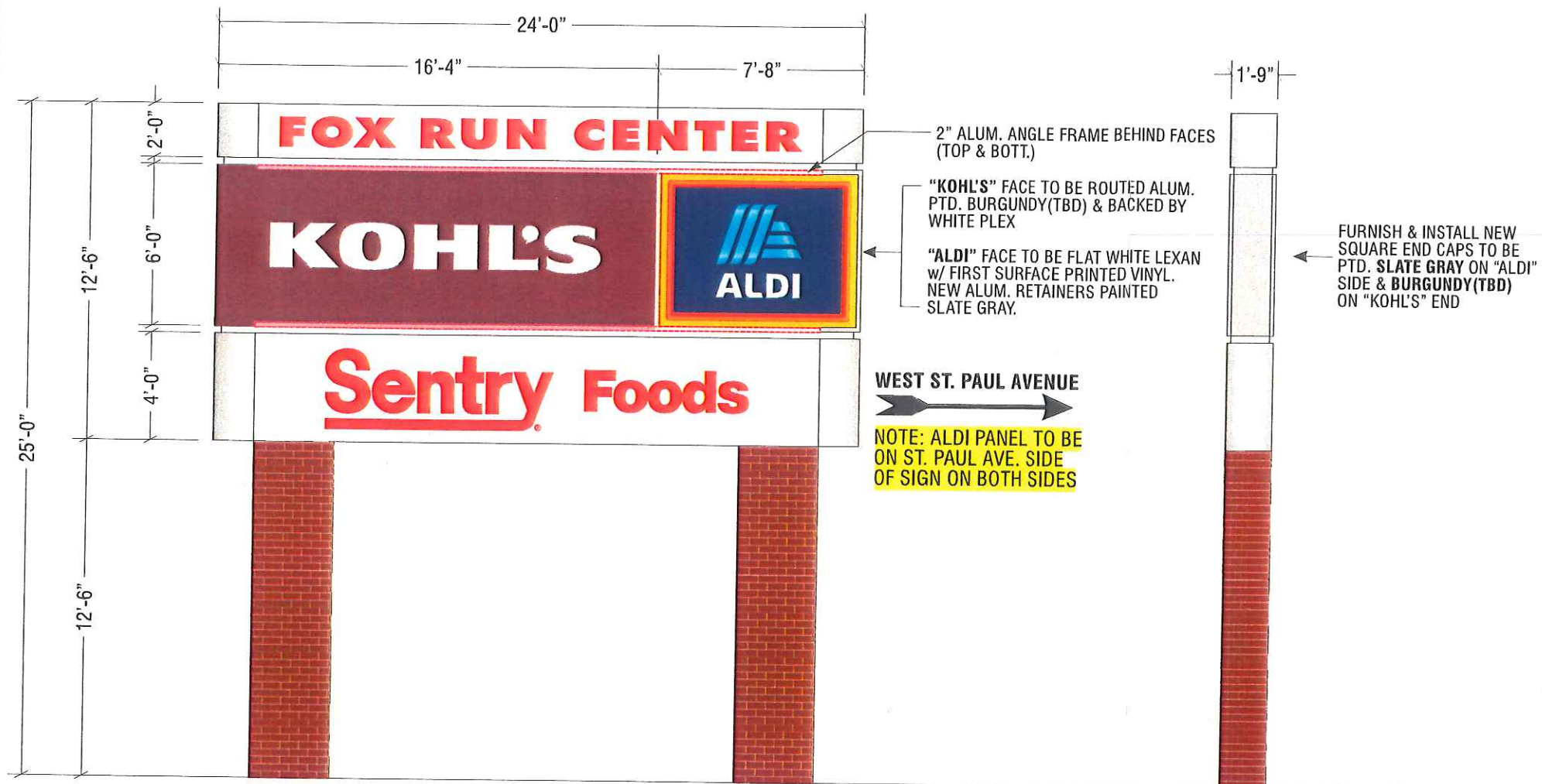

B NEW REPLACEMENT FACES & SQUARE END CAPS
SCALE: 3/16" = 1'

- EXISTING FACES WELDED TO 2" ANGLE FRAME TO BE CUT OUT
- NEW FACES TO BE SCREWED INTO EXISTING 2" ALUM. ANGLE FRAME

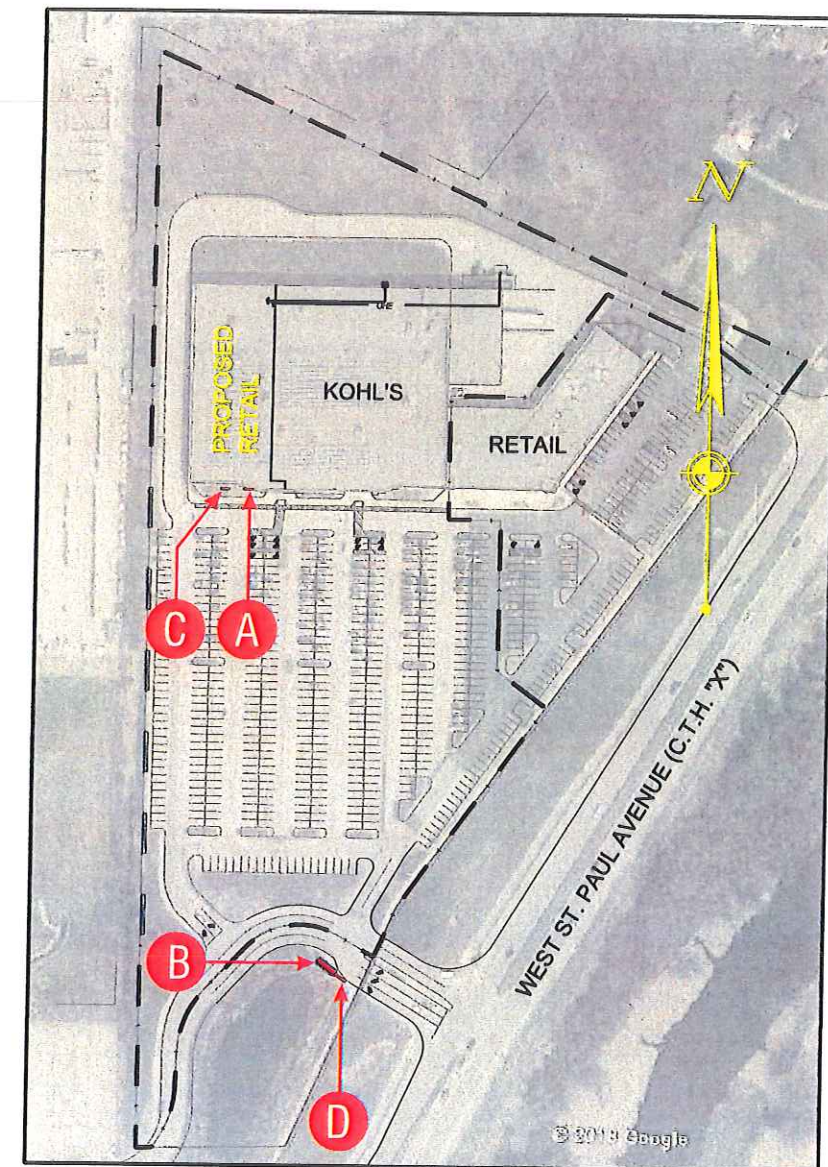

SITE MAP
N.T.S.



DATE	REVISION
5.11.18	ADD ALT. PYLON/MONUMENT OPTIONS
6.15.18	REMOVED NEW PYLON/MONUMENT OPTIONS & NEW PYLON FACE OPTIONS
7.18.18	ADDED TWO NEW ALT. PYLON FACE OPTIONS
7.19.18	REVISED ALDI PANEL LOCATION
8.20.18	ADDED SURVEY INFO & BANNER
8.20.18	ADDED 4x8 ROAD SIGN & STOREFONTS DIMENSIONS

CUSTOMER APPROVAL **DATE**

This design is the original and unpublished work of DOYLE SIGNS, INC. and may not be reproduced, copied or exhibited in any fashion without the expressed written consent from an authorized officer of The Company. The rights to this design may be purchased.

CLIENT **ALDI**

ADDRESS **WAUKESHA, WI.
WAUKESHA COUNTY**

DESIGNER **DF** **SALES** **TD**

SCALE: **NOTED** **DATE:** **3-15-18**

DRWG. No. **# 16551** **SHEET No.** **2 of 3**

Z:\Design\A\ALDI\W\WAUKESHA, WI\ALDI Waukesha, WI 8-20-18.cdr