

**HEAVY DUTY ASPHALT PAVEMENT
(TRUCK TRAFFIC AREA)**
NOT TO SCALE

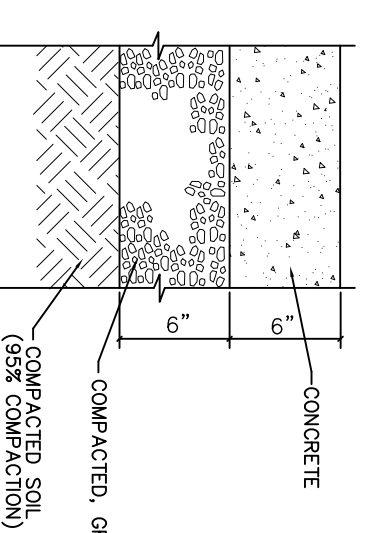

**CONCRETE PAVEMENT
(LOADING DOCKS)**
NOT TO SCALE

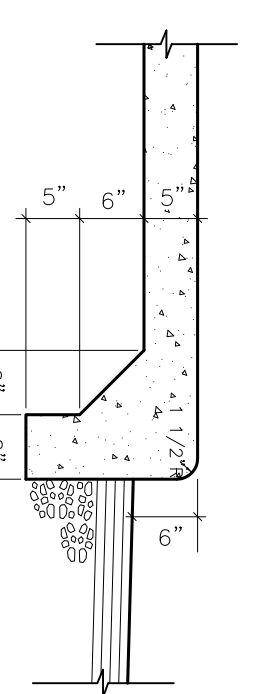

RAISED CONCRETE WALK WITH INTEGRAL CURB
NOT TO SCALE

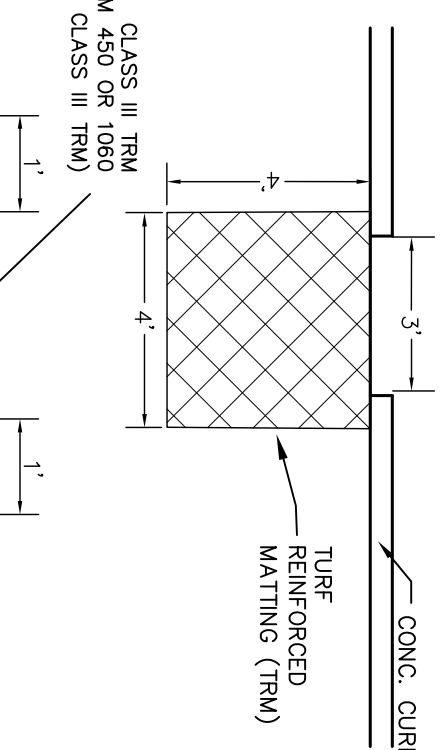

CURB CUT DETAIL
NOT TO SCALE

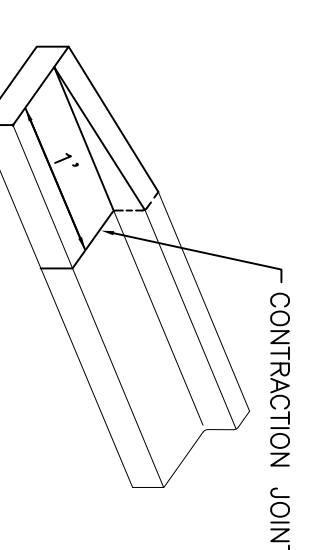

END SECTION CURB TAPER
NOT TO SCALE

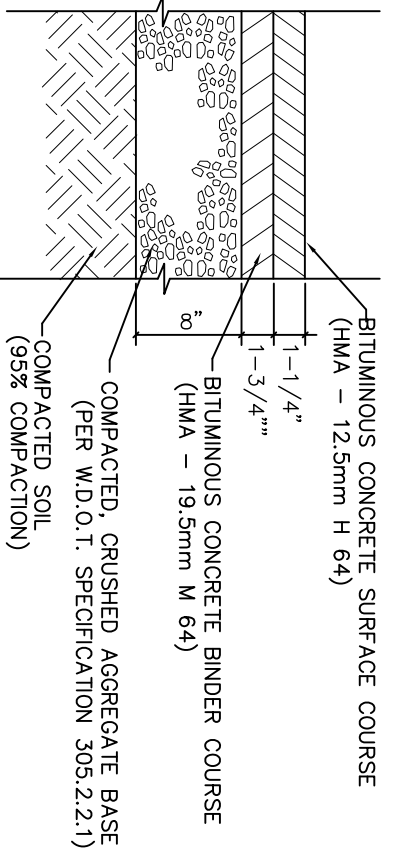

**STANDARD ASPHALT PAVEMENT
(PARKING TRAFFIC AREA)**
NOT TO SCALE

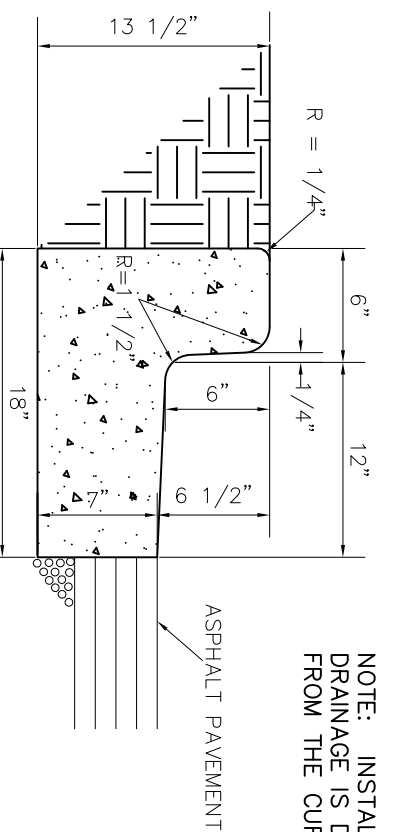

HIGH SIDE CONCRETE CURB DETAIL
NOT TO SCALE

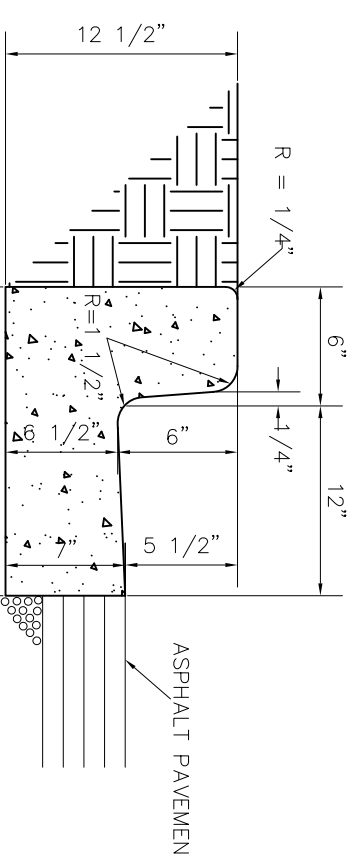

LOW SIDE CONCRETE CURB DETAIL
NOT TO SCALE

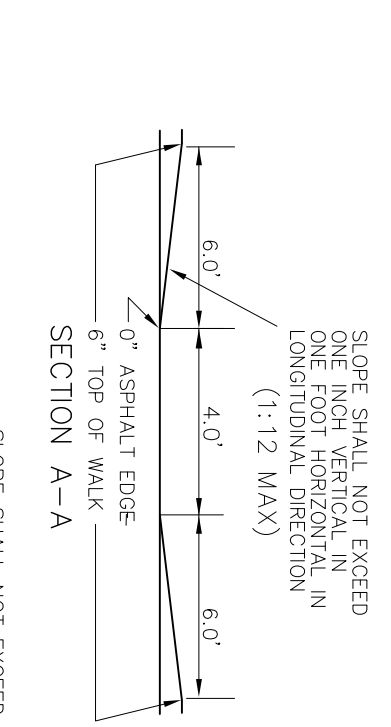

SECTION A-A

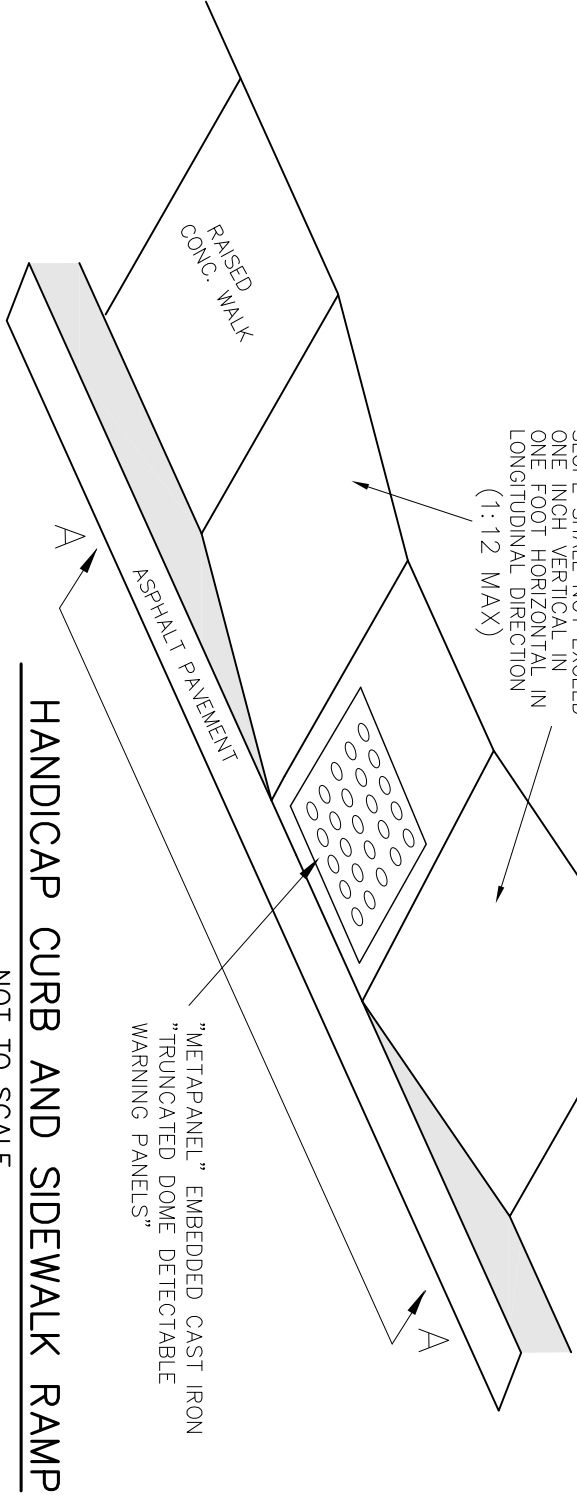

HANDICAP CURB AND SIDEWALK RAMP
NOT TO SCALE

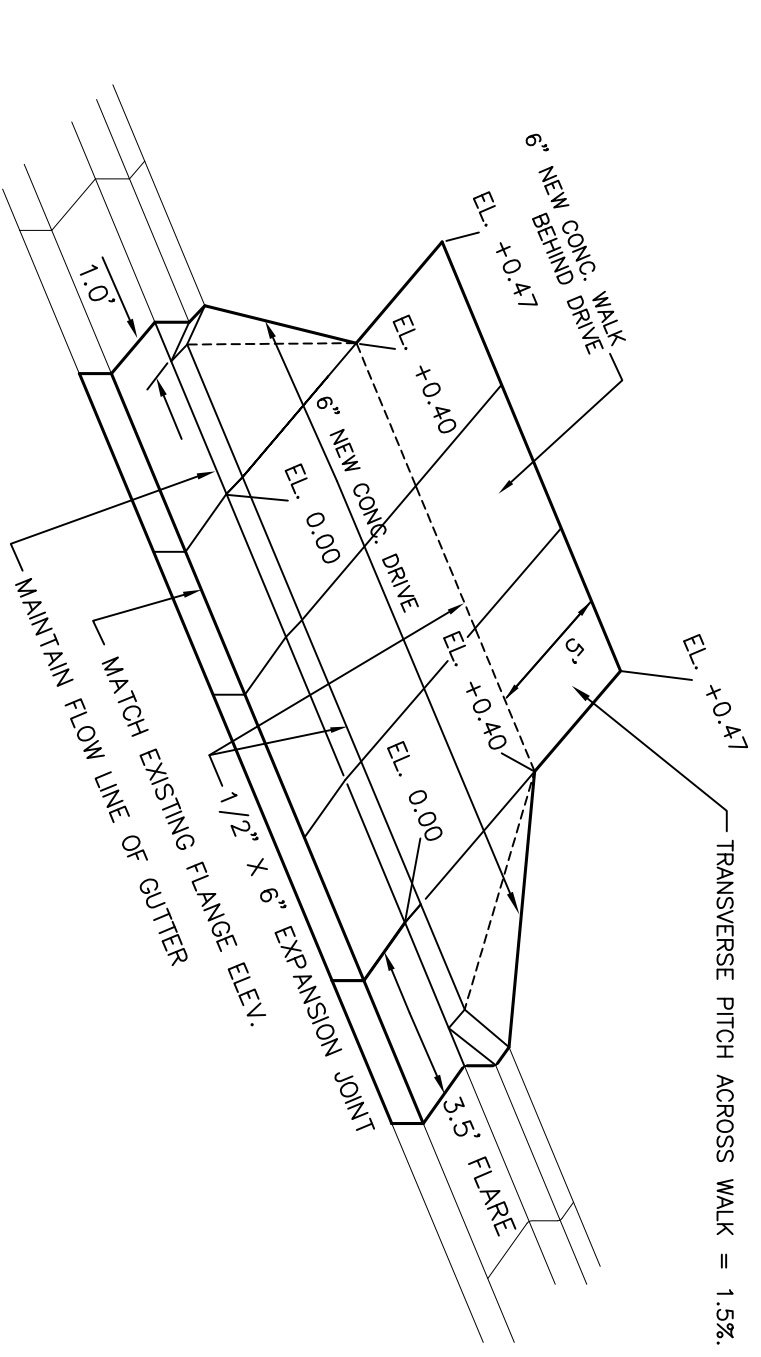

CONCRETE DRIVEWAY APPROACH
(PER ADA AND CITY OF WAUKESHA REQUIREMENTS)
NOT TO SCALE

NOTES:

1. DIMENSIONS ARE TO THE FACE OF CURB.
2. DISTURBED AREA = 120,000 S.F. (2.75 ACRES)
3. STORM WATER MANAGEMENT IS PROVIDED BY A REGIONAL OFF SITE STORM WATER POND.
4. CURRENT CITY STANDARD SPECIFICATIONS SHALL BE FOLLOWED FOR ALL WORK IN THE PUBLIC RIGHT OF WAY.
5. LIMITS OF FINAL CITY STREET PAVEMENT AND CURB AND GUTTER REMOVAL AND REPLACEMENTS TO BE MARKED BY CITY ENGINEERING STAFF IN FIELD.

SITE AREAS:

- PROPERTY AREA = 188,889 S.F. (4.309 ACRES)
- BUILDING FOOTPRINT = 36,546 S.F.
- PAVEMENT = 28,006 S.F.
- TOTAL IMPERVIOUS AREA = 74,552 S.F. (1.711 ACRES)
- GREEN SPACE = 115,333 (2.648 ACRES) 60.7%

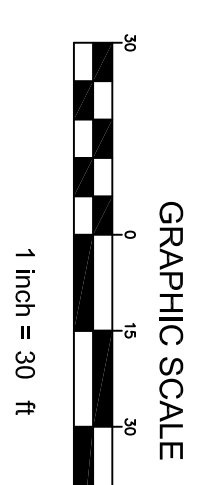
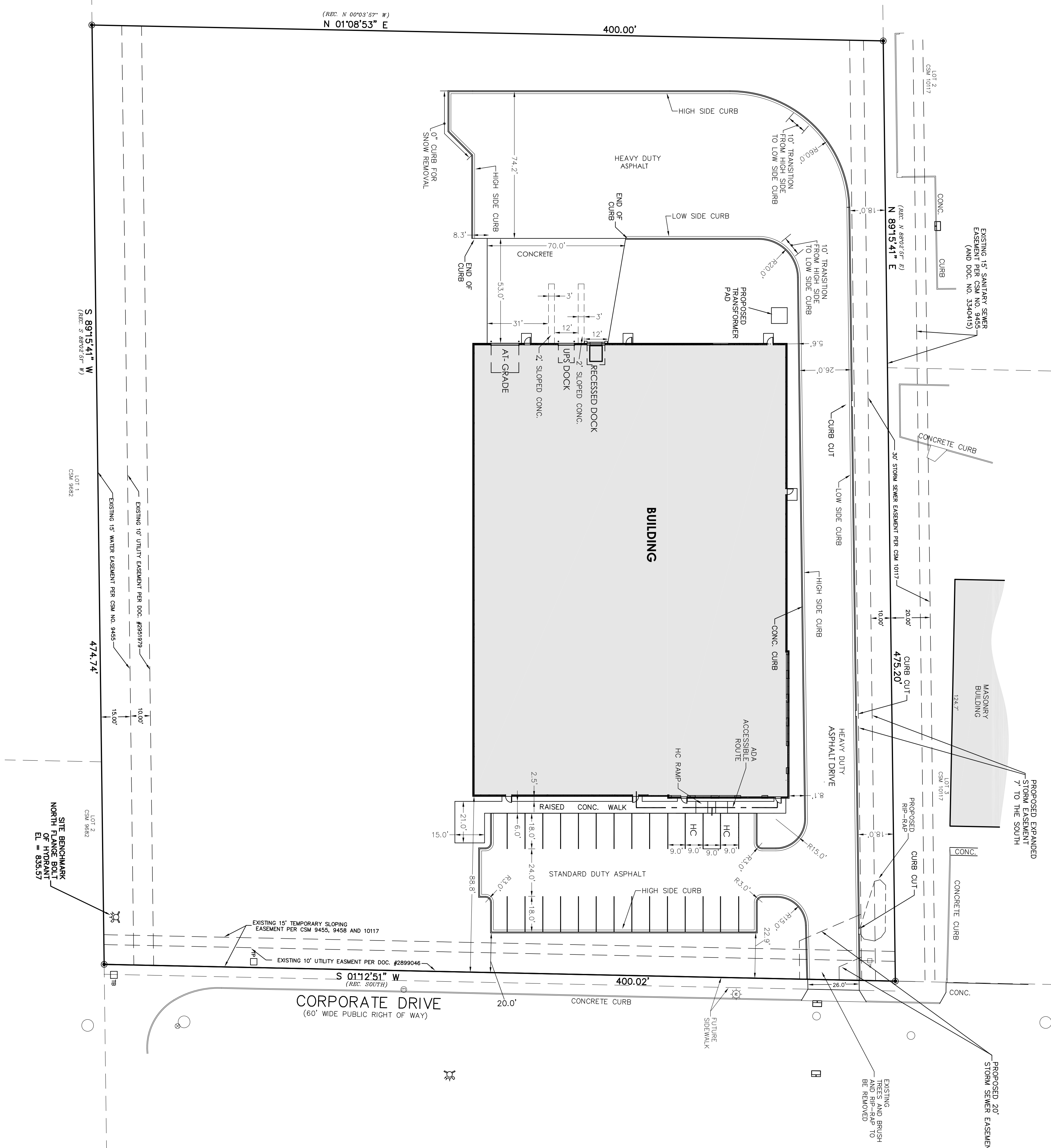

SITE PLAN

C1.0
SHEET 1 OF 4

BRELIE GEAR
CORPORATE ROAD WAUKESHA, WI

engineering
civil design and consulting
9205 W. Center Street
Milwaukee, WI 53222
PH: (414) 443-1312
www.cj-engineering.com

CJE NO.: 1841R4
JANUARY 21, 2019

Professional Engineer Seal for Christopher A. Calkins, Wisconsin License No. 10117